

D-1174 - Wesley Medical Endowment Foundation dedicates R.O.W. for Tyler Road, in an area north of 13th Street. (For arterial sidewalk installation.) By: City

12-13-83
BSTD 12-1583 100
47470

ACTION

	DATE
S/D COMMITTEE	<u>12-23-83</u>
M.A.P.C.	<u>1-13-84</u>
B.C.C./B. CO. C.	_____

17th

Cherry Hill

See Department of S/D

22-1-338

D-1174 - Wesley Medical Endowment Foundation dedicates R.O.V. for Tyler Road, in an area north of 13th Street. (For arterial sidewalk installation.) By: City Engineering.

12-13-83
Bstred 121583100
42478

ACTION

SD COMMITTEE accept DATE 12-23-83
M.A.P.C. accept 1-13-84
B.C.C./B. CO. C. _____

HR

Chas
See Report Village
of SD
83-1-22

DEDICATION REPORT AND PROGRESS

MAP No. 4949C
SEC. No. _____
TWP. No. _____
RANGE No. _____

CASE No. D - 1174

ASSOCIATED CASE NO. _____

I. OFFER TO DEDICATE: R.O.W. for Tyler Road - for arterial sidewalk installation
GENERALLY LOCATED: Tyler Road, in an area ~~north~~ ^{east side of} of ~~13th~~ ^{17th} Street.

LEGALLY DESCRIBED AS: _____

DEDICATED BY: Wesley Medical Endowment Foundation
Requested By: City Engineering
ADDRESS: 455 N. Main, 67202 PHONE _____
PURPOSE OF DEDICATION: for arterial sidewalk installation.

II. SKETCH.

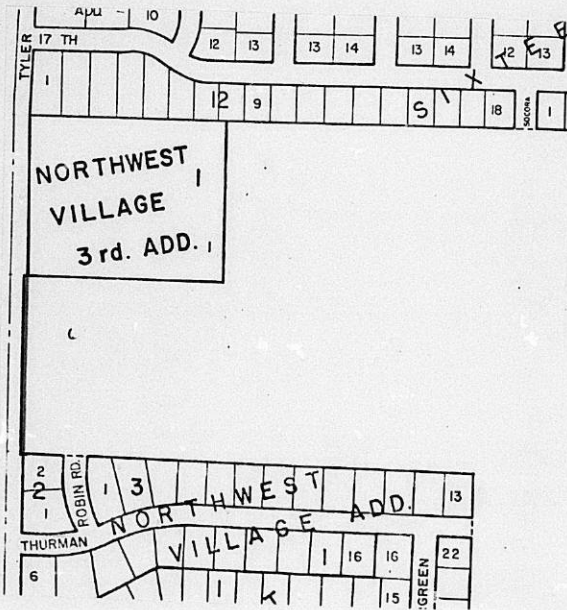

III. FILED 12-12-83
POSTED TO ATLAS _____
S/D COMM. ACTION 12-22-83 accept
M.A.P.C. ACTION 1-12-84 accept

B.C.C. ACTION _____
PLACED ON RECORD _____
CITY CLERKS No. _____

1-12-84 Larry Henry said
no need to send this dedication
to BCC if plat of Northwest
Village 4th is almost ready
for final action. If plat does
not get scheduled for BCC in
February '84, then send
dedication on to BCC. L.O.

Plat on BCC 4-3-84

DEDICATION

KNOW ALL MEN BY THESE PRESENTS:

That for and in consideration of the sum of One Dollar (\$1.00) and other good and valuable considerations, the receipt of which is hereby acknowledged, the undersigned,

Wesley Medical Endowment Foundation, a Kansas not-for-profit

corporation,

being the owner of the following described real estate in Sedgwick County, Kansas, to wit:

The East ten (10) feet of the West fifty (50) feet of the South five hundred three and one tenth (503.1) feet of the North nine hundred fifty-three and three tenths (953.3) feet of the Southwest Quarter of Section 9, Township 27, Range 1 West of the 6th P.M., Sedgwick County, Kansas.

do es hereby dedicate the above described real estate to the public for street purposes.

Executed this 7th day of December, 1983.

WESLEY MEDICAL ENDOWMENT FOUNDATION

ATTEST:

By

Duane L. Dyer, President

Evan A. Meyers
Evan Meyers, Assistant Secretary

STATE OF KANSAS)
SEDGWICK COUNTY) SS

BE IT REMEMBERED, that on this 7th day of December, 1983, before me a Notary Public in and for the said County and State came

Duane L. Dyer

President

of Wesley Medical Endowment Foundation

to me personally known to be the same person who executed the foregoing instrument and duly acknowledged the execution of the same, for and on behalf, and as the act and deed of said Corporation.

IN WITNESS WHEREOF, I have hereunto subscribed my name and affixed my official seal, the day and year last above written.

My Commission expires October 13, 1985

Linda M. Fleming
Notary Public

Linda M. Fleming

4949c

DEDICATION

D-1174

KNOW ALL MEN BY THESE PRESENTS:

That for and in consideration of the sum of One Dollar (\$1.00) and other good and valuable considerations, the receipt of which is hereby acknowledged, the undersigned, Wesley Medical Endowment Foundation, a Kansas not-for-profit corporation,

being the owner of the following described real estate in Sedgwick County, Kansas, to wit:

The East ten (10) feet of the West fifty (50) feet of the South five hundred three and one tenth (503.1) feet of the North nine hundred fifty-three and three tenths (953.3) feet of the Southwest Quarter of Section 9, Township 27, Range 1 West of the 6th P.M., Sedgwick County, Kansas.

do ES hereby dedicate the above described real estate to the public for street purposes.

Executed this 7th day of December, 1983.

WESLEY MEDICAL ENDOWMENT FOUNDATION

ATTEST:

Evan A. Meyers
Evan Meyers, Assistant Secretary

By Duane L. Dyer
Duane L. Dyer, President

STATE OF KANSAS)
SEDGWICK COUNTY) SS

BE IT REMEMBERED, that on this 7th day of December, 1983 before me a Notary Public in and for the said County and State came

Duane L. Dyer, President

of Wesley Medical Endowment Foundation

to me personally known to be the same person who executed the foregoing instrument and duly acknowledged the execution of the same, for and on behalf, and as the act and deed of said Corporation.

IN WITNESS WHEREOF, I have hereunto subscribed my name and affixed my official seal, the day and year last above written.

Linda M. Fleming
Notary Public
Linda M. Fleming

My Commission expires October 13, 1985

THE CITY OF WICHITA
OFFICE OF ENGINEERING

DATE DECEMBER 12, 1983

TO LOUISE OLIVAREZ, CURRENT PLANS - PLANNING DEPARTMENT
FROM LARRY D. HENRY, R/W & ESTIMATING ENGINEER

SUBJECT DEDICATION
1983 ARTERIAL SIDEWALK
#472 76 245 81262 000 000 001

Attached please find a dedication for placement on the Subdivision Committee Agenda for consideration at the earliest possible date. Upon approval by the City Commission, please have the City Clerk file for recording with the Register of Deeds.

I would appreciate receiving a copy of the recorded instrument from the Clerk's Office for our files.

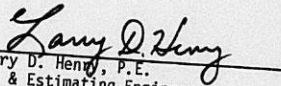
Larry D. Henry, P.E.
R/W & Estimating Engineer

/dl

Attachment

cc: Twila Nelson, City Clerk's Office

RECEIVED

DEC 12 1983

METROPOLITAN PLANNING

ROUTE _____
