

D-1184 (Assoc. N-1183) - Frank Carney, et al., dedicate a sanitary sewer easement on the east side of Rock Road 1/2 mile south of Central.

Map: 6047D

D-1184

Ⓢ

ACTION

COMMITTEE _____ DATE _____

M.A.P.C. _____

B.C.C./B.C.C.-C. accepted 1-3-84

6047D

MAP No. 6047D
 SEC. No. _____
 TWP. No. _____
 RANGE No. _____

DEDICATION REPORT AND PROGRESS

CASE No. D - 1184

ASSOCIATED CASE NO. V-1183

I. OFFER TO DEDICATE: A sanitary sewer easement
 GENERALLY LOCATED: On the east side of Rock Road 1/4 mile south of Central

LEGALLY DESCRIBED AS: _____

DEDICATED BY: Frank Carney, et al.

ADDRESS: _____

PURPOSE OF DEDICATION: _____ PHONE _____

II. SKETCH.

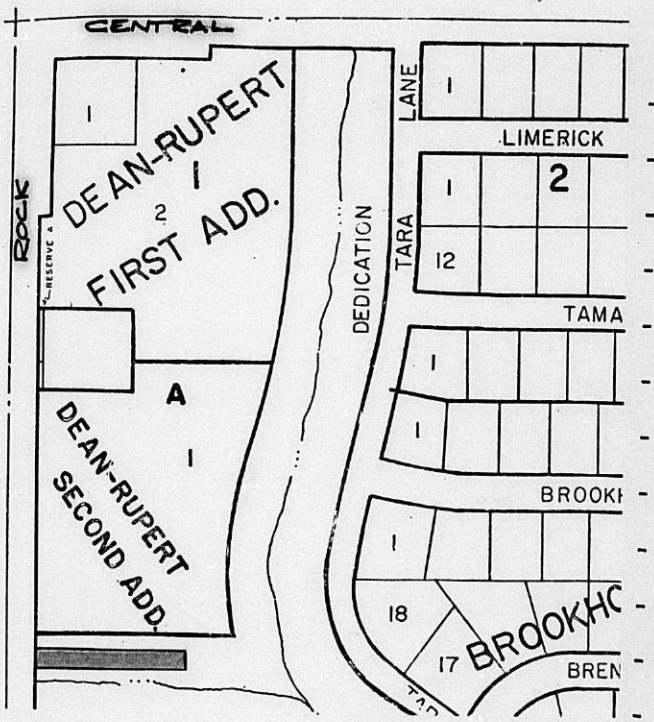

III. FILED _____
 POSTED TO ATLAS _____
 S/D COMM. ACTION _____
 M.A.P.C. ACTION _____
 B.C.C. ACTION 1-3-84 Accepted _____
 PLACED ON RECORD _____
 CITY CLERKS No. _____

Set up dedication file.
Assoc. with V-1183
Map 6047 D

Frank Carney, et al, ~~subject~~ ^{grant}
a sanitary sewer easement
generally located on the
east side of Rock Road in
~~an area~~ ^{an area} 1/4 mile south
of Central.

B.C.C. accepted 1-3-84

Mark control card [↑] and
file in closed case drawer.

EASEMENT

THIS EASEMENT made this 22nd day of December, 1983
by and between Frank L. Carney, Zenda Carney, Lindy Andeel, Stanley G. Andeel,
Gretchen Andeel, and R. Grant Gaudreau as General Partner for
Executive Park East, Ltd.
of the first part and the City of Wichita of the second part.

WITNESSETH: That the said first party, in consideration of the sum of One Dollar (\$1.00) and other valuable consideration, the receipt whereof is hereby acknowledged, do hereby grant and convey unto the said second party a perpetual right-of-way and easement for the purpose of constructing, maintaining and repairing sewer pipes and a sewer system according to the plans and specifications now on file in the office of the City Engineer of the City of Wichita, Kansas, over, along and under the following described real estate situated in Sedgwick County, Kansas, to wit:

That part of the Northwest Quarter of Section 20, Township 27 South, Range 2 East of the 6th P.M., Sedgwick County, Kansas, described as commencing at the Northwest Corner thereof; thence South 00° West, along the West line of said Northwest Quarter, 1108 feet; thence South 90° East, 50 feet to a point 28.5 feet South of the Southwest Corner of Lot 1, Block A, Dean-Rupert Second Addition to Wichita, Sedgwick County, Kansas, for a place of beginning; thence South 90° East, 273 feet; thence South 00° West, 30 feet; thence North 90° West, 273 feet; thence North 00° East, 30 feet to the place of beginning.

And said second party is hereby granted the right to enter upon said premises at any time for the purpose of constructing, operating, maintaining, and repairing such sewer and sewer system.

IN WITNESS WHEREOF: The said first party has signed these presents the day and year first written:

Frank L. Carney
FRANK L. CARNEY
Zenda Carney
ZENDA CARNEY
Lindy Andeel
LINDY ANDEEL
STATE OF KANSAS)
SEDGWICK COUNTY) SS

Stanley G. Andeel
STANLEY G. ANDEEL
Gretchen Andeel
GRETCHEN ANDEEL
R. Grant Gaudreau
R. GRANT GAUDREAU, General Partner
of Executive Park East, Ltd.

Personally appeared before me a notary public in and for the County and State of Kansas, the undersigned, Frank L. Carney, Zenda Carney, Lindy Andeel, Stanley G. Andeel, aforesaid Gretchen Andeel, and R. Grant Gaudreau, General Partner of Executive Park East, Ltd. to me personally known to be the same person who executed the foregoing instrument of writing and said person duly acknowledged the execution thereof for and on behalf of and as the act of said parties.

Dated at Wichita, Kansas, this 22nd day of December, 1983.

Alice Mostrom
Notary Public

My Commission expires _____

