

D-1196 - Central Christian Church
dedicates a utility and drainage
easement south of 29th Street
North in an area east of Rock Rd.

POSTED 4-5-84 KL

(Handwritten symbol)

ACTION

DATE

4-12-84

COMMITTEE

accept

M.A.P.C.

apps.

4-16-84

BOARD

Approved

5-1-84

650

D-1196 - Central Christian Church
dedicates a utility and drainage
easement south of 29th Street
North in an area east of Rock Rd.

POSTED 4-5-84 KL

[Handwritten mark]

ACTION

DATE

S/D COMMITTEE

accept

4-12-84

M.A.P.C.

agree

4-10-84

B.C.C.P.C.

Agreed

5-1-84

6050

DEDICATION REPORT AND PROGRESS

MAP No. 6050 D
 SEC. No. _____
 TWP. No. _____
 RANGE No. _____

CASE No. D - 1196

ASSOCIATED CASE NO. _____

I. OFFER TO DEDICATE: Utility and drainage easement.
 GENERALLY LOCATED: South of 29th Street North in an area east of Rock Road.

LEGALLY DESCRIBED AS: _____

DEDICATED BY: Central Christian Church.

ADDRESS: _____ PHONE _____
 PURPOSE OF DEDICATION: _____

II. SKETCH.

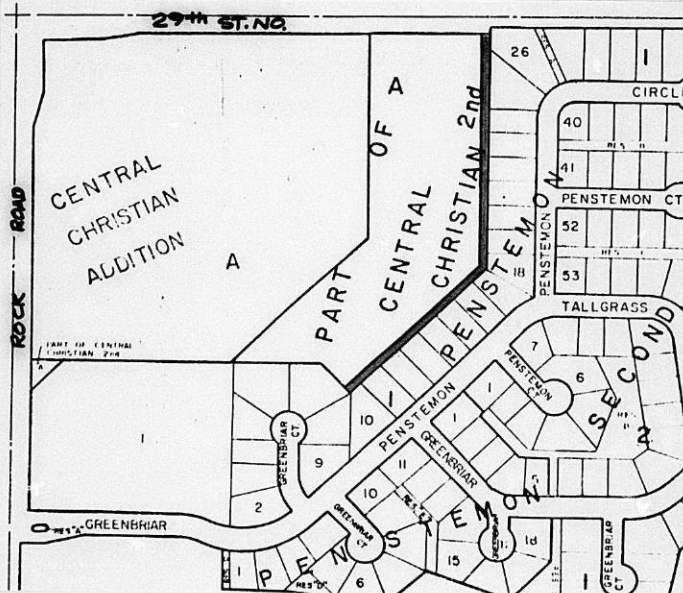

III. FILED 3-26-84
 POSTED TO ATLAS
 S/D COMM. ACTION 4-12-84 *accept*
 M.A.P.C. ACTION 4-19-84 *mpc*

B.C.C. ACTION 5-1-84 *Approved*
 PLACED ON RECORD _____
 CITY CLERKS No. _____

MAPC CASE NO. D-1196

Dedication of utility and drainage
easement

Dedicated by: Central Christian Church

Generally located

South of 29th Street North in an area
east of Rock Road.

This dedication is given for the following reason:

Storm Water Sewer 253

ACTION: Accept the dedication and instruct the City Clerk
to file the document with the Register of Deeds.

BILL RECORDING FEE TO: 468-76-245-81291-000-000-001

THE CITY OF WICHITA

OFFICE OF PLANNING DEPARTMENT
Design Division

DATE March 15, 1984

TO Louise Olivarez, Planning Department
FROM Larry D. Henry, Program Development Engineer

SUBJECT Easements for Storm Water Sewer 253

Attached is one easement for placement on the agenda for Subdivision Commission consideration.

Upon approval by the City Commission and recording with the Register of Deeds, I would appreciate a copy of the recorded instrument for our files.

Larry D. Henry
Larry D. Henry, P.E.
Program Development Engineer

LDH:JL:gf

Attachment

Prepare dedication file

Map 6050D

*Central Christian Church
grants a utility and drainage
easement. Generally located
south of 29th Street North
in an area east of Rock Road.*

S/D agenda 4-12-84

RECEIVED

D #1196

MAR 16 1984

METROPOLITAN PLANNING

ROUTE

*document placed to Mike Harding
of MKEC 3-15-84 for correction
Re-submitted to MAPD 3-26-84*

EASEMENT

THIS EASEMENT made this 5th day of March, 1984
by and between The Central Christian Church of Wichita, Kansas of the first
part and City of Wichita of the second
part.

WITNESSETH; that the said first party, in consideration of the sum of One Dollar (\$1.00) and other valuable consideration, the receipt whereof is hereby acknowledged, do hereby grant and convey unto the said second party a perpetual right of way and easement for the purpose of constructing, maintaining and repairing their Utilities and Drainage, over, along and under the following described real estate situated in Sedgwick County, Kansas, to wit:

The following is a description of a 20 foot utility and drainage easement lying in the northwest quarter of Section 5, Township 27 south, Range 2 east of the 6th P.M., more particularly described as follows:

A 20 foot strip of land parallel and westerly of the southeast and easterly lines of Central Christian Second Addition, an addition to Wichita, Sedgwick County, Kansas, also being parallel and westerly of the west line of Penstemon Second Addition from the northwest corner of Lot 10, Block 1 to the northwest corner of Lot 26, Block 1, said Penstemon Second Addition, an addition to Wichita, Sedgwick County, Kansas; containing 0.6 acres, more or less.

And said second party is hereby granted the right to enter upon said premises at any time for the purpose of constructing, operating, maintaining and repairing their Utilities and Drainage, including the right to open and excavate in any streets or ways that may be constructed on the surface of said easements, provided that upon completion of the necessities of grantee's operations the surface of such easements shall be restored as nearly as possible to its original condition.

IN WITNESS WHEREOF: The said first party has signed these presents the day and year first written.

CENTRAL CHRISTIAN CHURCH
by Ron Grover
Minister of Business Administration

STATE OF KANSAS
ss:
SEDGWICK COUNTY

Personally appeared before me a notary public in and for the County and State aforesaid came Ron Grover to me personally known to be the same person who executed the foregoing instrument of writing and said person duly acknowledged the execution thereof.

Dated at Wichita, KS this 5th day of March, 1984.



Sh. Will
Notary Public