

D-1337 - Dennis C. Glaser, et al dedicates access control on the east side of Arkansas Ave., in an area just north of 30th Street.

2451B

S/D COMMITTEE

M.A.P.C. approved 12/12/85  
B.C.C. 17 200 Approved 1/7/86

Posted 12-2-85 KE  
of 6/1

### ACTION

	DATE
S/D COMMITTEE	approved 12/5/85
M.A.P.C.	approved 12/12/85
B.C.C. in case	Approved 1/7/86

5451B

DEDICATION REPORT AND PROGRESS

MAP NO. 5451 B  
 SEC. NO. 32  
 TWP. NO. 26S  
 RANGE 1E

CASE NO.: D-1337

ASSOCIATED CASE: L/S-0664

1. OFFER TO DEDICATE: Access control.  
 GENERALLY LOCATED: On the east side of Arkansas Avenue, in an area just north of 30th Street.

LEGALLY DESCRIBED AS:

The north 58.36 feet of Lot 10, Byron Smith Addition, Sedgwick, County, Kansas, except the west 10 feet thereof for street.

DEDICATED BY: Dennis C. Glaser, et al

ADDRESS: P.O. Box 1362, 67201 PHONE \_\_\_\_\_

PURPOSE OF DEDICATION:

In connection with associated lot split (L/S-0664).

II. SKETCH.

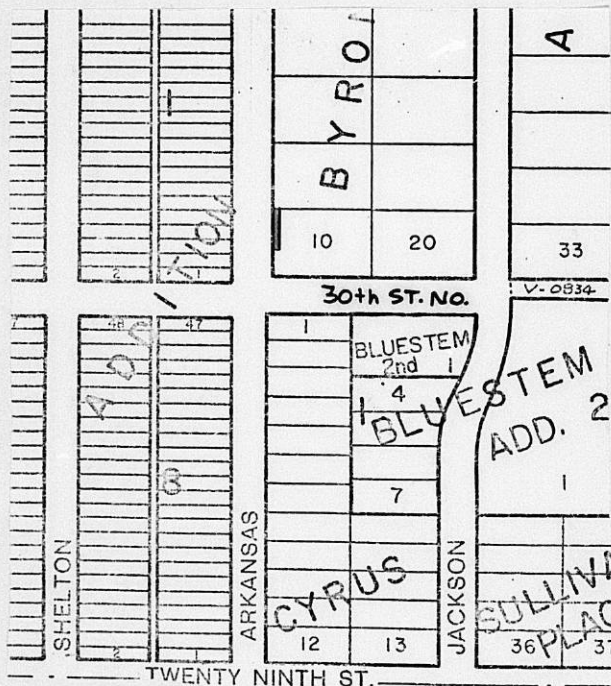

III. FILED 11/22/85  
 POSTED TO ATLAS  
 S/D COMM. ACTION 12/5/85 appr.  
 M.A.P.C. ACTION 12/12/85 appr.

B.C.C. ACTION 1-7-86 Approved  
 PLACED ON RECORD  
 CITY CLERKS NO. \_\_\_\_\_

Agenda Item # \_\_\_\_\_

City of Wichita  
City Commission Meeting  
January 7, 1986

Agenda Report # \_\_\_\_\_

TO: Mayor and City Commissioners

SUBJECT: D-1337 - DEDICATION OF ACCESS CONTROL, LOCATED ON THE  
EAST SIDE OF ARKANSAS AVENUE, IN AN AREA JUST NORTH OF  
30TH STREET.

INITIATED BY: Metropolitan Area Planning Department

AGENDA ACTION: Planning & Zoning

-----  
MAPC Recommendation: Accept the dedication.

Background: Dennis C. Glaser, et al, are dedicating access control, which is a requirement of associated lot split case (L/S-0664).

The dedication has been reviewed and approved by the Planning Commission.

Financial Considerations: Bill the recording costs to:

Dennis C. Glaser  
P. O. Box 1362  
Wichita, KS 67201

Recommendations/Actions: Accept the dedication and record document.

5451B Dennis C. Glaser, et al  
32 dedicate access control  
26S generally located on the  
1E West side of Arkansas Ave.  
in an area just north of  
30<sup>th</sup> St.

Assoc. case L/S-0664

Dennis C. Glaser  
P.O. Box 1362  
67201

For S/D 12-5-85

D-1337  
(3)

