

posted 12-1-87  
KRV

D-1488 - Cranmer Grass Farms, Inc.  
dedicates additional street right-of-  
way, located west of Maize Road and  
north of 21st Street North.

# ACTION

	DATE
S/D COMMITTEE	_____
M.A.P.C.	_____
<del>W.S.S.</del> /B. CO. C.	accepted 11/25/87

DEDICATION REPORT AND PROGRESS

MAP NO. 4750 B  
SEC. NO. 6  
TWP. NO. 27S  
RANGE 1W

CASE NO.: D-1488

ASSOCIATED CASE: CU-309

1. OFFER TO DEDICATE: Additional street right-of-way.

GENERALLY LOCATED: West of Maize Road and north of 21st Street North.

LEGALLY DESCRIBED AS:

The west 20 feet of the east 60 feet of the north 824.47 feet of the south 1169.57 feet of the southeast  $\frac{1}{4}$ , Section 6, T27S, R1W of the 6th P.M.

DEDICATED BY: Cranmer Grass Farms, Inc.

PURPOSE OF DEDICATION:

II. SKETCH.

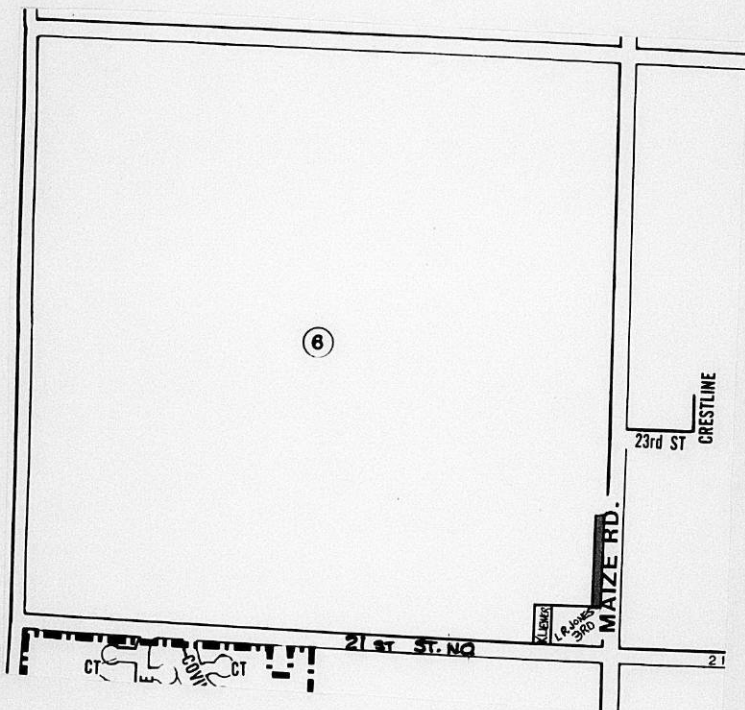

III. FILED 11/3/87  
POSTED TO ATLAS \_\_\_\_\_  
S/D COMM. ACTION \_\_\_\_\_  
M.A.P.C. ACTION \_\_\_\_\_

B.CoC. ACTION 11-25-87 accepted  
PLACED ON RECORD \_\_\_\_\_  
CITY CLERKS NO. \_\_\_\_\_

Map 4750B

Assoc w/ CU-30

BCoC accepted 11-25-87

received 11-5-87

DEDICATION

add'l r.o.w. for Thayer Rd.

KNOW ALL MEN BY THESE PRESENTS:

That for and in consideration of the sum of One Dollar (\$1.00) and other good and valuable considerations, the receipt of which is hereby acknowledged, the undersigned, Cranmer Grass Farms, Inc

being the owner of the following described real estate in Sedgwick County, Kansas, to wit:

The west 20 feet of the east 60 feet of the north 824.47 feet of the south 1169.57 feet of the southeast 1/4, Section 6, T27S, R1W of the 6th P.M.

do hereby dedicate the above described real estate to the public for Street purposes.

Executed this 3rd day of November 1987.

Cranmer Grass Farms, Inc.

David D. Cranmer  
David D. Cranmer, President

STATE OF KANSAS )  
SEDGWICK COUNTY ) ss

BE IT REMEMBERED, that on this 3rd day of November, 1987,  
came Cranmer Grass Farms, Inc., by its President, David D. Cranmer

to me personally known to be the same person who executed the foregoing instrument and duly acknowledged the execution of the same.

IN WITNESS WHEREOF, I have hereunto subscribed my name and affixed my official seal, the day and year last above written.

Submitted to the Wichita-Sedgwick County Metropolitan Area Planning Commission and the Board of Commissioners of the City of Wichita, Kansas, and approved by said Board of Commissioners of the City of Wichita, Kansas,

this \_\_\_\_\_,

\_\_\_\_\_  
City Clerk

Marshall P. Morrow  
Notary Public

My Commission Expires: 5/8/89

