

D-1496 - Capital Federal Savings & Loan Association dedicates a sanitary sewer easement, located at the northwest corner of Maize and Central.

posted 1-8-88 KX ✓

ACTION

	DATE
S/D COMMITTEE	<u>1/14/88</u>
M.A.P.C.	<u>1/21/88</u>
W.C.C./B.C.C. C.	<u>3-1-88</u>

Approved
Approved
Approved

MAP NO. 4748 B
SEC. NO. 18
TWP. NO. 27S
RANGE 1W

DEDICATION REPORT AND PROGRESS

CASE NO.: D-1496

ASSOCIATED CASE: L/S-0731

1. OFFER TO DEDICATE: Sanitary sewer easement.

GENERALLY LOCATED: At the northwest corner of Maize and Central.

LEGALLY DESCRIBED AS:

That part of Lot 1, Timber Grove Lakes, an Addition to Wichita, Kansas, described as commencing at the southeast corner thereof; thence S $86^{\circ} 38' 52''$ W, along the south line of said Lot 1, 175 feet to a deflection point in said south line; thence S $78^{\circ} 10' 47''$ W, along the south line of said Lot 1, 76.93 feet for a point of beginning; thence N 00° W, 275.99 feet; thence N $90^{\circ} 00'$ E, 261.17 feet to a point on the east line of said Lot 1; thence N $8^{\circ} 28' 13''$ W, along the east line of said Lot 1, 10.11 feet; thence S $90^{\circ} 00'$ W, 249.68 feet; thence S 00° E, 263.90 feet to a point on the south line of said Lot 1; thence S $78^{\circ} 10' 47''$ W, 10.22 feet to the point of beginning.

DEDICATED BY: Capital Federal Savings and Loan Association

PURPOSE OF DEDICATION: S

II. SKETCH.

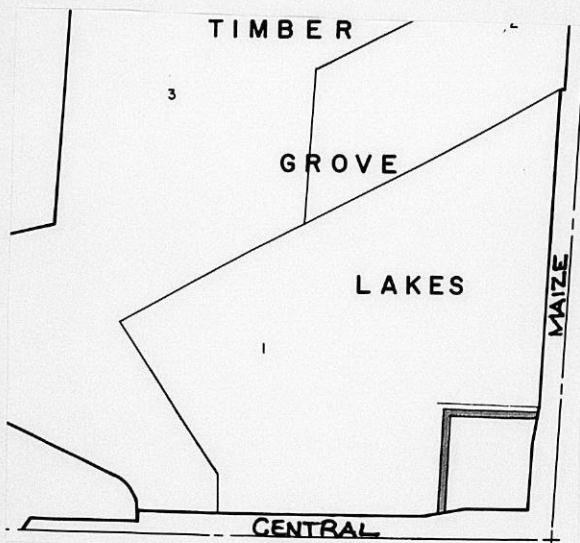

III. FILED 11/19/87
POSTED TO ATLAS
S/D COMM. ACTION 1/14/88 *app.*
M.A.P.C. ACTION 1-21-88 *app.*

B.C.C. ACTION 3-1-88 *Approved*
PLACED ON RECORD
CITY CLERKS NO.

Planning Agenda Item # _____

City of Wichita
City Council Meeting
March 1, 1988

Agenda Report # _____

TO: Mayor and City Council Members

SUBJECT: D-1496 - DEDICATION OF SANITARY SEWER EASEMENT, LOCATED
AT THE NORTHWEST CORNER OF MAIZE AND CENTRAL.

INITIATED BY: Metropolitan Area Planning Department

AGENDA ACTION: Planning

MAPC Recommendation: Accept the dedication. (unanimous)

Background: Capitol Federal Savings and Loan Association are dedicating this sanitary sewer easement to satisfy a condition of lot split approval (L/S-0731).

Financial Considerations: Bill the recording costs to:
755-68-360-50000-295-000-000

Recommendations/Actions: Accept the dedication and record document.

PL/8126/5

FORM KB-017

EASEMENT

Small project, this is
or it being created

THIS EASEMENT made this 19th day of November, 19 87,
by and between Capitol Federal Savings and Loan Association
of the first part and the City of Wichita of the second part.

WITNESSETH: That the said first party, in consideration of the sum
of One Dollar (\$1.00) and other valuable consideration, the receipt whereof
is hereby acknowledged, do hereby grant and convey unto the said second party
a perpetual right-of-way and easement for the purpose of constructing, main-
taining, and repairing sewer pipes and a sewer system, over, along and under
the following described real estate situated in Sedgwick County, Kansas, to
wit:

That part of Lot 1, Timber Grove Lakes, an Addition to
Wichita, Kansas, described as commencing at the S.E. Corner
thereof; thence S 86°38'52" W, along the south line of said
Lot 1, 175 feet to a deflection point in said south line;
thence S 78°10'47" W, along the south line of said Lot 1,
76.93 feet for a point of beginning; thence N 00° W, 275.99
feet; thence N 90°00' E, 261.17 feet to a point on the east
line of said Lot 1; thence S 8°28'13" W, along the east
line of said Lot 1, 10.11 feet; thence S 90°00' W, 249.68
feet; thence S 00° E, 263.90 feet to a point on the south
line of said Lot 1; thence S 78°10'47" W, 10.22 feet to the
point of beginning.

And said second party is hereby granted the right to enter upon said
premises at any time for the purpose of constructing, operating, maintaining,
and repairing such sewer and sewer system.

IN WITNESS WHEREOF: The said first party has signed these presents
the day and year first written.

Capitol Federal Savings and
and Loan Association

R. Joe Aleshire First Vice President
R. Joe Aleshire

STATE OF KANSAS)
SEDGWICK COUNTY) SS

Personally appeared before me a notary public in and for the County and
State aforesaid R. Joe Aleshire, First Vice President of Capitol Federal
Savings and Loan Association

to me personally known to be the same person who executed the foregoing
instrument of writing and said person duly acknowledged the execution
thereof.

Dated at Wichita, Kansas, this 19th day of November, 19 87.

Mildred E. Franz
Notary Public
Mildred E. Franz

My Commission Expires February 3, 1991

MILDRED E. FRANZ
NOTARY PUBLIC
STATE OF KANSAS