

D-1511 - East Heights United Methodist Church dedicates access control, located on the south side of Douglas, east of Crestway.

posted 5-17-88 KX ✓

**ACTION**

S/D COMMITTEE approved DATE 5/19/88

M.A.P.C.

5/19/88

United Methodist  
ess control, lo-  
de of Douglas,

# ACTION

	DATE
S/D COMMITTEE	<u>5/19/88</u>
M.A.P.C.	<u>5/26/88</u>
W.C.C./ <del>B-CO-C</del>	<u>6/21/88</u>

MAP NO. 5747 B  
SEC. NO. 23  
TWP. NO. 27S  
RANGE 1E

DEDICATION REPORT AND PROGRESS

CASE NO.: D-1511

ASSOCIATED CASE: 1/S-0740

- I. OFFER TO DEDICATE: Access control.  
GENERALLY LOCATED: On the south side of Douglas, east of Crestway.

LEGALLY DESCRIBED AS:

Lot 1, except the east 150 feet thereof, Highland Park Addition, Wichita, Sedgwick County, Kansas.

DEDICATED BY: East Heights United Methodist Church

PURPOSE OF DEDICATION:

II. SKETCH.

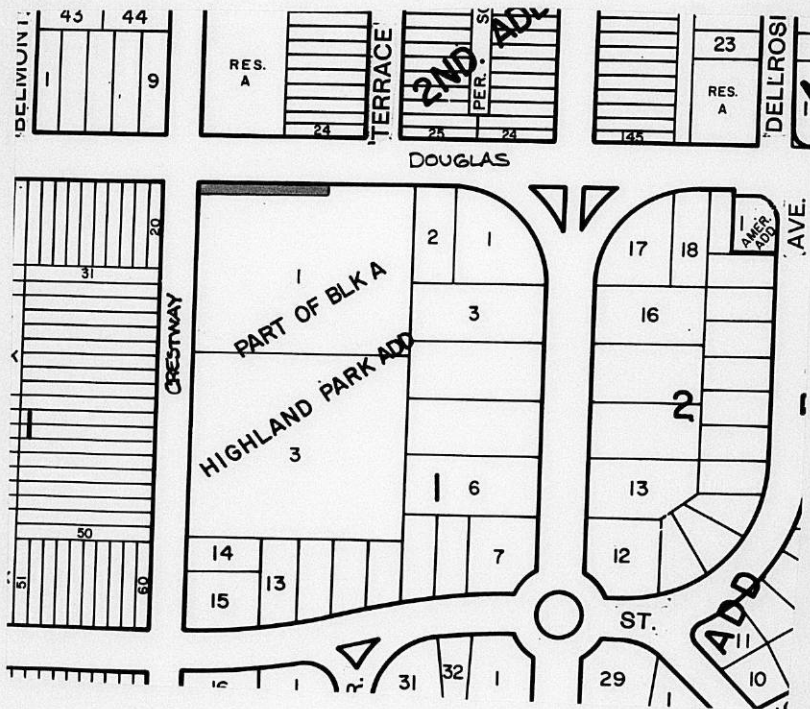

III. FILED 4/29/88  
POSTED TO ATLAS  
S/D COMM. ACTION 5/19/88 *Approved*  
M.A.P.C. ACTION 5/26/88 *Approved*

B.C.C. ACTION 6/21/88 *Approved*  
PLACED ON RECORD  
CITY CLERKS NO.

Planning Agenda Item # \_\_\_\_\_

City of Wichita  
City Council Meeting  
June 21, 1988

Agenda Report # \_\_\_\_\_

TO: Mayor and City Council Members

SUBJECT: D-1511 - DEDICATION OF ACCESS CONTROL TO DOUGLAS AVENUE,  
LOCATED ON THE SOUTH SIDE OF DOUGLAS, EAST OF CRESTWAY.

INITIATED BY: Metropolitan Area Planning Department

AGENDA ACTION: Planning

-----  
MAPC Recommendation: Accept the dedication. (unanimous)

Background: East Heights United Methodist Church is dedicating "access control except for one opening" to Douglas Avenue to meet a requirement of a lot split (L/S-0740).

Financial Considerations: Bill the recording costs to:  
755-68-360-50000-295-000-000

Recommendations/Actions: Accept the dedication and record document.

PL/8679/5

DECLARATION OF ABUTTER'S RIGHTS

KNOW ALL MEN BY THESE PRESENTS:

That for and in consideration of the sum of One Dollar (\$1.00) and other good and valuable considerations, the receipt of which is hereby acknowledged, the undersigned East Heights United Methodist Church being the owner(s) of the following described real estate in Sedgwick County, Kansas, to wit: Lot 1, except the east 150 feet thereof, Highland Park Addition, Wichita, Sedgwick County, Kansas;

do hereby transfer and convey to the City of Wichita, Kansas, all abutter's rights of access, ingress and egress to said property from or to Douglas over and across the north line of the above-described property; to have and to hold the same forever; provided, however, that said property shall have access to Douglas at one location(s). It being understood that this conveyance is a covenant running with the land and prohibits all subsequent owners thereof and all members of the public from entering upon said property from Douglas, except at the one permitted location(s).

Executed this 29th day of April, 1988.

East Heights United Methodist Church

By Clinton Engstrand Chairman, Board of Trustees

State of Kansas ) ss Sedgwick County)

BE IT REMEMBERED, that on this 29th day of April, 1988, before me a notary public in and for the said County and State, came Clinton Engstrand to me personally known to be the same person(s) who executed the foregoing instrument and duly acknowledged the execution of the same.

IN WITNESS WHEREOF, I have hereunto subscribed my name and affixed my official seal, the day and year last above written.



Diana L. McCartney Notary Public

My Commission Expires: 11-18-90