

D-1530- J.W. Russell, Pamela Elaine
Russell-Dorothy Marie Matthew, dedi-
cate St. right-of-way no side of 13th
1/2 mile west of 119th St. West

Posted 8-19-88 KCB
Bie

ACTION

DATE

6/27

S/D COMMITTEE

M.A.P.C.

~~W.C.B.~~ CO. C.

accepted 7/6/88

DEDICATION REPORT AND PROGRESS

MAP NO. 4649 B&C
 SEC. NO. 12
 TWP. NO. 27S
 RANGE 2W

CASE NO.: D-1530
 ASSOCIATED CASE: _____

1. OFFER TO DEDICATE: Street right-of-way
 GENERALLY LOCATED: north side of 13th approximately 1/2 mile west of 119th Street West

LEGALLY DESCRIBED AS:

The south 50 feet of the SE 1/4 of Section 12, T27S, R2W of the 6th Principal Meridian in Sedgwick County, Kansas lying west to the Centerline of Cowskin Creek, said Centerline being located 1273.94 feet East of the Southwest corner of said SE 1/4, containing 1.46 acres more or less.

DEDICATED BY: J.W. Russell, Pamela Elaine Russell, Dorothy Marie Matthew

ADDRESS: _____ PHONE _____
 PURPOSE OF DEDICATION: _____
 Requirement of CU - 316

II. SKETCH.

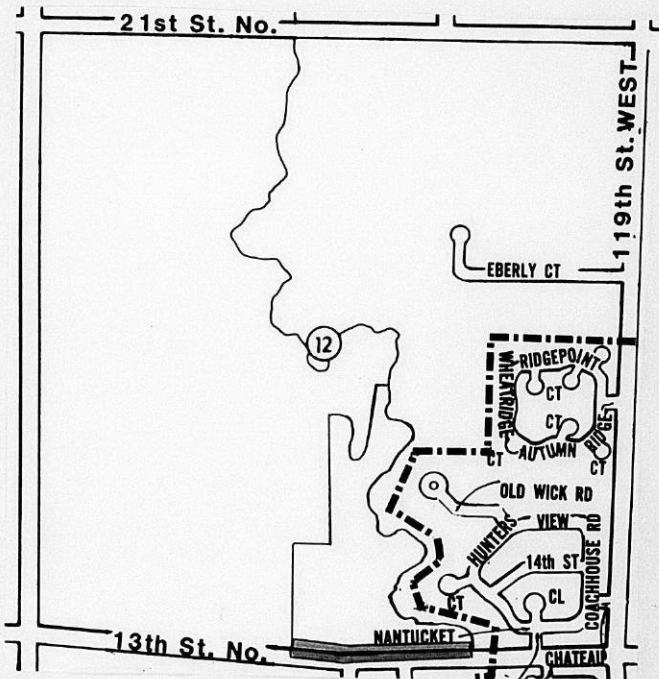

III. FILED 7/1/88
 POSTED TO ATLAS _____
 S/D COMM. ACTION _____
 M.A.P.C. ACTION _____
 B.C.C. ACTION 7/6/88 Accepted _____
 PLACED ON RECORD _____
 CITY CLERKS NO. _____

8-18-88

Prepare dedication file :

Map # : 4649 B+C
Sec : 13
Twp : 27S
Range : 2W

D-1530

Offer to dedicate : street r.o.w.

Generally located : north side of 13th
approx. 1/2-mile west of 119th St. West

Dedicated by : J.W. Russell
Pamela Elaine Russell
Dorothy Marie Matthew

Purpose : Requirement of CU-316

Filed : July 1, 1988
BOC Action : 7-6-88 accepted

Give file to Graphics to post

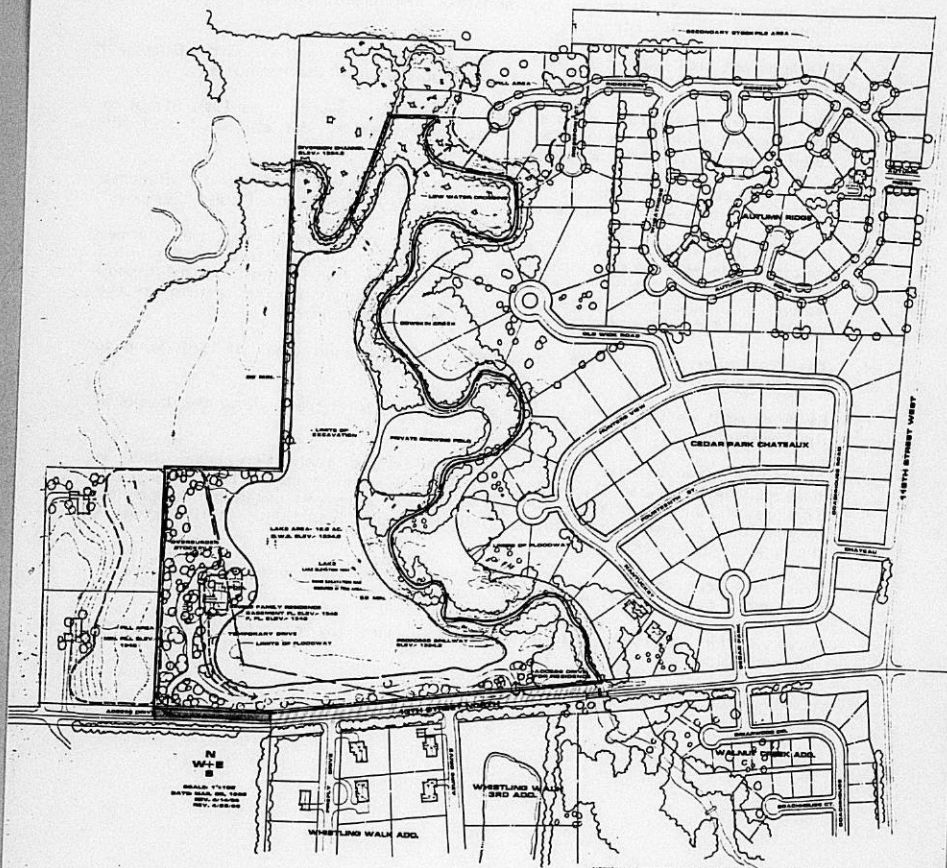

OPERATIONS PLAN
JAY RUSSELL RESIDENCE



dedication by P.E. Russell, J.W. Russell, + D.M. Matthew
dedication by P.E. Russell & J.W. Russell

CU-316

DEDICATION DEED

STATE OF KANSAS } SS
SEDGWICK COUNTY }
FILED FOR RECORD AT
12:30 P. M.

KNOWN ALL MEN BY THESE PRESENTS:

That for and in consideration of the sum of One Dollar (\$1.00) and other good and valuable considerations, the receipt of which is hereby acknowledged, the undersigned, J. W. RUSSELL AND PAT KETTLER REGISTER OF DEEDS

PAMELA ELAINE RUSSELL AND

DOROTHY MARIE MATTHEW

*Pat Kettler
Deputy*

being the owner 5 of the following described real estate in Sedgwick County, Kansas, to wit:
THE SOUTH 50 FEET OF THE EAST 434.7 FEET OF THE SW1/4 OF SECTION 12, T27S, R2W OF THE 6TH PRINCIPAL MERIDIAN IN SEDGWICK COUNTY, KANSAS CONTAINING 0.50 ACRES MORE OR LESS.

MICROFILMED
OF RECORD

Do hereby dedicate the above described real estate to the public for street or road purposes.

Executed this 17TH day of JUNE, 1988.

Pamela Elaine Russell
PAMELA ELAINE RUSSELL
J. W. Russell
J. W. RUSSELL
Dorothy Marie Matthew
DOROTHY MARIE MATTHEW

STATE OF KANSAS }
SEDGWICK COUNTY } SS

BE IT REMEMBERED, That on this 17TH day of JUNE, 1988, before me a Notary Public in and for the said County and State came PAMELA ELAINE RUSSELL AND J. W. RUSSELL

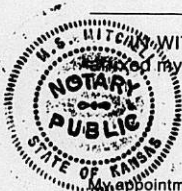

WITNESS WHEREOF, I have hereunto subscribed my name and placed my Notarial Seal, on day and year last above written.

M. S. Mitchell
M. S. MITCHELL
NOTARY PUBLIC

My appointment expires 12-21-89

SUBMITTED TO THE OFFICE OF COUNTY ENGINEER AND THE BOARD OF COUNTY COMMISSIONERS FOR APPROVAL ON July 6, 1988.

APPROVED BY

David C. Spears
DAVID C. SPEARS

DIRECTOR, BUREAU OF PUBLIC SERVICES/
COUNTY ENGINEER

Mark F. Schroeder
MARK F. SCHROEDER

CHAIRMAN

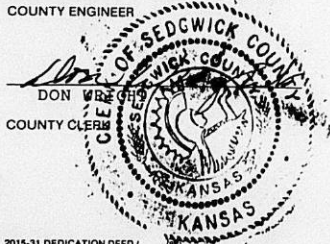

DON WRIGHT
COUNTY CLERK

ENTERED ON
TRANSFER RECORD
JUL 7 1988
DON WRIGHT
COUNTY CLERK

025 H

county clerk

STATE OF KANSAS)
SEDGWICK COUNTY) SS

I hereby certify that on this 1ST day of JULY, 19 88 ;
before me the undersigned, a Notary Public in and for the County and
State aforesaid, came DOROTHY MARIE MATTHEW
to me personally known to be the same person, who signed and executed
the above and foregoing instrument and duly acknowledged the execution
of the same.

WITNESS my hand and Notary Seal on the day and date last above written.

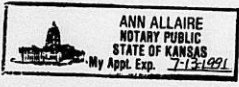

Ann Allaire
NOTARY PUBLIC ANN ALLAIRE

My Appointment expires July 13, 1991

DEDICATION DEED

MICROFILMED
OF RECORD

KNOWN ALL MEN BY THESE PRESENTS:

STATE OF KANSAS } ss
SEDGWICK COUNTY }
FILED FOR RECORD AT
2:30 P.M.

That for and in consideration of the sum of One Dollar (\$1.00) and other good and valuable considerations, the receipt of which is hereby acknowledged, the undersigned, J. W. RUSSELL AND

PAMELA ELAINE RUSSELL

PAT KETTLER
REGISTER OF DEEDS

Pat Kettler Deputy

being the owner S of the following described real estate in Sedgwick County, Kansas, to wit:

THE SOUTH 50 FEET OF THE SE 1/4 OF SECTION 12, T27S, R2W OF THE 6TH PRINCIPAL MERIDIAN IN SEDGWICK COUNTY, KANSAS LYING WEST TO THE CENTERLINE OF COWSKIN CREEK, SAID CENTERLINE BEING LOCATED 1273.94 FEET EAST OF THE WOUTHWEST CORNER OF SAID SE 1/4, CONTAINING 1.46 ACRES MORE OR LESS.

Do hereby dedicate the above described real estate to the public for street or road purposes.

Executed this 17TH day of JUNE, 19 88

Pamela Elaine Russell
PAMELA ELAINE RUSSELL
J. W. Russell
J. W. RUSSELL

STATE OF KANSAS } ss
SEDGWICK COUNTY }

BE IT REMEMBERED, That on this 17TH day of JUNE, 19 88, before me a Notary Public in and for the said County and State came PAMELA ELAINE RUSSELL AND J. W. RUSSELL

IN WITNESS WHEREOF, I have hereunto subscribed my name and affixed my Notarial Seal, on day and year last above written.

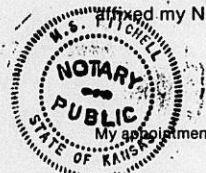

M. S. Mitchell
MARK S. MITCHELL
NOTARY PUBLIC
M. S. MITCHELL

SUBMITTED TO THE OFFICE OF COUNTY ENGINEER AND THE BOARD OF COUNTY COMMISSIONERS FOR APPROVAL ON July 6, 1988

APPROVED BY

David C. Spears
DAVID C. SPEARS

DIRECTOR, BUREAU OF PUBLIC SERVICES/
COUNTY ENGINEER

Mark F. Schroeder
MARK F. SCHROEDER

CHAIRMAN



ENTERED ON
TRANSFER RECORD
JUL 7 1988
DON WRIGHT
COUNTY CLERK

County Clerk

624