

D-1550 - Shoney's Inc. dedicates a utility easement south of Kellogg and west of Webb Rd.

U
DATED 1-19-89

KAC

ACTION

DATE 1/26/89

BY COMMITTEE accept

DATE 2/2/89

BY CAPC approved

DATE 2/14/89

BY REC'D P.C. approved

Map No. 6046A
Sec. 29
Twp. 27S
Range 2E
Dist.No. _____

DEDICATION REPORT AND PROGRESS

CASE No: D-1550
ASSOCIATED CASE: L/S 0756

I. Offer to Dedicate: Utility Easement
Generally Located: In a general area south of Kellogg and West of Webb Rd.

Legally Described As:

Beginning at a point on the East line of Lot 1, "Davis-Moore Addition", Wichita, Kansas, at an assumed bearing of South 0°00' West, a distance of 135.21 feet from the most Easterly Northeast corner of said Lot; thence continuing South 0°00' West on said East line 20 feet; thence South 90°00' West 20 feet; thence North 0°00' East 20 feet; thence North 90°00' East 20 feet to the Point of Beginning.

Dedicated By: Shoney's Inc.

Address: _____

Purpose of Dedication: _____ Phone: _____

To provide additional easement for or required sanitary sewer line as required by L/S-0756.

II. Sketch.

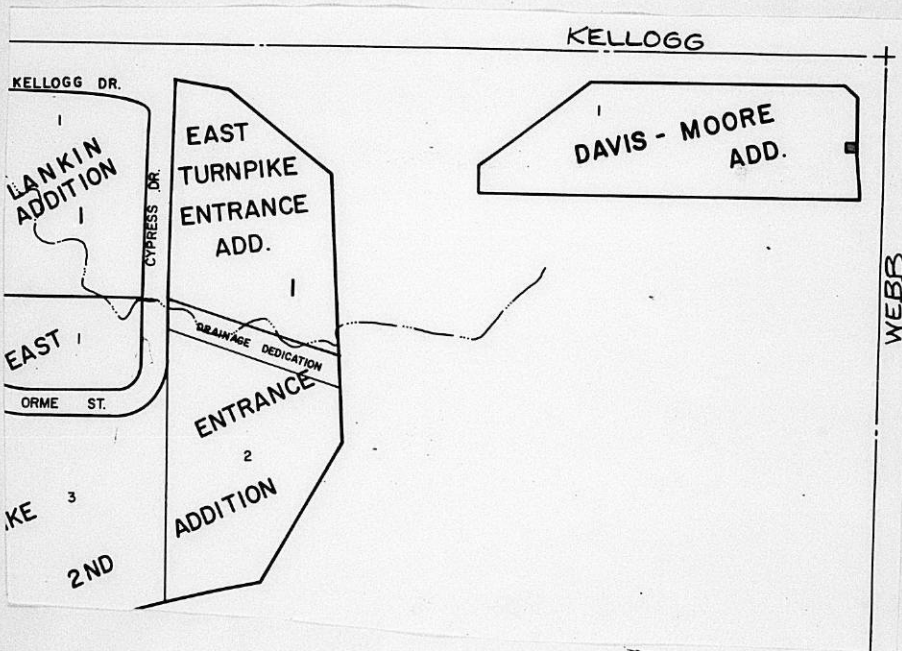

III. Filed _____
Posted to Atlas _____
S/D Comm. Action 1/26/89 approved W.C.C. Action 2/14/89 approved
M.A.P.C. Action 2/12/89 approved Placed on Record _____
City Clerks No. _____

Planning Agenda Item # _____

City of Wichita
City Council Meeting
February 14, 1989

Agenda Report # _____

TO: Mayor and City Council Members

SUBJECT: D-1550, DEDICATION OF A UTILITY EASEMENT, LOCATED SOUTH OF KELLOGG AND WEST OF WEBB ROAD

INITIATED BY: Metropolitan Area Planning Department

AGENDA ACTION: Planning

MAPC Recommendation: Accept the dedication.

Background: This utility easement was a requirement of an approved lot split (L/S-0756) and was obtained in order to provide for the extension of sanitary sewer to the building site. The dedication has been reviewed and approved by the Planning Commission.

Financial Considerations: Bill the recording costs to:
300210-9030.

Recommendations/Action: Accept the dedication and record document.

EASEMENT

THIS EASEMENT made this 15th day of September, 1988 by and between Shoney's, Inc. of the first part and the City of Wichita, of the second part.

WITNESSETH: That the said first party, in consideration of the sum of One Dollar (\$1.00) and other valuable consideration, the receipt whereof is hereby acknowledged, does hereby grant and convey unto the said second party a perpetual right-of-way and easement for the purpose of constructing, maintaining, and repairing sewer and all other public utilities, over, along and under the following described real estate situated in Sedgwick County, Kansas, to wit:

BEGINNING at a point on the East line of Lot 1, "DAVIS-MOORE ADDITION", Wichita, Kansas, at an assumed bearing of South 0°00' West, a distance of 135.21 feet from the most Easterly Northeast corner of said Lot; thence continuing South 0°00' West on said East line 20 feet; thence South 90°00' West 20 feet; thence North 0°00' East 20 feet; thence North 90°00' East 20 feet to the **POINT OF BEGINNING**.

And said second party is hereby granted the right to enter upon said premises at any time for the purpose of constructing, operating, maintaining, and repairing such sewer and all other public utilities.

IN WITNESS WHEREOF: The said first party has signed these presents the day and year first written.

SHONEY'S, INC.

J. M. Grout, V.P.
J. M. Grout, Vice-President

STATE OF TENNESSEE)
Davidson COUNTY) ss

BE IT REMEMBERED, that on this 15th day of September, 1988, before me a Notary Public in and for said County and State, came J. M. Grout Vice President of Shoney's, Inc., to me personally known to be the same persons who executed the foregoing instrument of writing and duly acknowledged the execution of the same. In testimony whereof I have hereunto set my hand and affixed my notarial seal the day and year above written.

Susann B. Shearon
Notary Public

My Appointment Expires: 11-12-89



My Commission Expires Nov. 12, 1989