

POSTED 2-2-80 KCC

Bic

D-1551 - Bernard Patrick dedicates a utility easement located in an area on the south side of Nottingham Circ. E. of Porter

ACTION

	DATE
S/D COMMITTEE	<u>2/23/89</u>
M.A.P.C.	<u>3/21/89</u>
W.C.C./B-GO. C.	<u>4/19/89</u>

Approved

approved

Approved

5352

Map No. 5352B
Sec. 30
Twp. 26S
Range 1E
Dist.No.

DEDICATION REPORT AND PROGRESS

CASE No: D-1551
ASSOCIATED CASE: L/S-0759

I. Offer to Dedicate: Utility Easement
Generally Located: In an area on the south side of Nottingham Circle
East of Porter

Legally Described As:

From the Southwest corner of Lot 14, Sherwood Glen Fifth Addition, Wichita, Kansas; Thence N 00 13' 30" E along the West line of said Lot 14, 48.62 feet; Thence N 67 58' 40" E, 10.00 feet to the point of beginning, said point of beginning being the northeast corner of an existing 10' utility easement; Thence N 67 58' 40" E, parallel with the south line of said lot 14, 73.61 feet; Thence S 22 01' 20" E, 10.00 feet to a point on the north line of Phillips pipeline easement; Thence S 67 58' 40" W along the north line of Phillips pipeline easement, 73.61 feet; Thence N 22 01' 20" W, 10.00 feet to the point of beginning.
Dedicated By: Bernard J. Patrick

Address: 3925 N. St. Clair, Wichita 67204 Phone: _____
Purpose of Dedication: _____

II. Sketch.

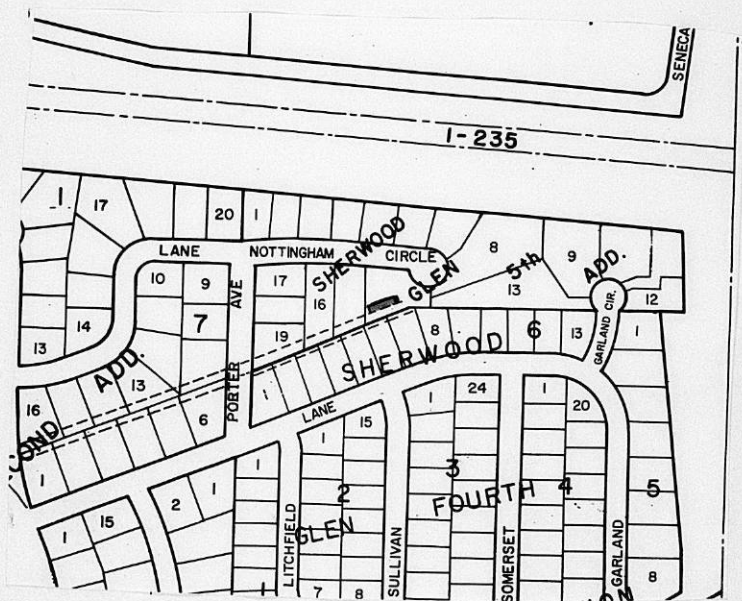

III. Filed _____
Posted to Atlas 1/23/89 W.C.C. Action 4/18/89 *Approved*
S/D Comm. Action 2/23/89 *Approved* Placed on Record _____
M.A.P.C. Action 3/2/89 City Clerks No. _____

Planning Agenda Item # _____

City of Wichita
City Council Meeting
April 18, 1989

Agenda Report # _____

TO: Mayor and City Council Members

SUBJECT: D-1551 - DEDICATION OF UTILITY EASEMENT, IN AN AREA ON THE SOUTH SIDE OF NOTTINGHAM CIRCLE AND EAST OF PORTER

INITIATED BY: Metropolitan Area Planning Department

AGENDA ACTION: Planning

MAPC Recommendation: Accept the dedication.

Background: This dedication was a requirement of an approved lot split (L/S-0759). It provides for an extension of a sanitary sewer lateral required for one of the building sites created. The dedication has been reviewed and approved by the Planning Commission.

Financial Considerations: Bill the recording costs to:
150029-2909

Recommendations/Action: Accept the dedication and record document.

OK

EASEMENT

THIS EASEMENT made this 23rd day of January, 1989, by and between Bernard J. Patrick of the first part and the City of Wichita, of the second part.

WITNESSETH: That the said first party, in consideration of the sum of One Dollar (\$1.00) and other valuable consideration, the receipt whereof is hereby acknowledged, does hereby grant and convey unto the said second party a perpetual right-of-way and easement for the purpose of constructing, maintaining, and repairing sewer and all other public utilities, over, along and under the following described real estate situated in Sedgwick County, Kansas, to wit:

From the Southwest corner of Lot 14, Sherwood Glen Fifth Addition, Wichita, Kansas; Thence N 00 13' 30" E along the West line of said Lot 14, 48.62 feet; Thence N 67 58' 40" E, 10.00 feet to the point of beginning, said point of beginning being the northeast corner of an existing 10' utility easement; Thence N 67 58' 40" E, parallel with the south line of said lot 14, 73.61 feet; Thence S 22 01' 20" E, 10.00 feet to a point on the north line of Phillips pipeline easement; Thence S 67 58' 40" W along the north line of Phillips pipeline easement, 73.61 feet; Thence N 22 01' 20" W, 10.00 feet to the point of beginning.

And said second party is hereby granted the right to enter upon said premises at any time for the purpose of constructing, operating, maintaining, and repairing such sewer and all other public utilities.

IN WITNESS WHEREOF: The said first party has signed these presents the day and year first written.

Bernard J. Patrick

Bernard J. Patrick

3925 N. St. Clair

Wichita, Kansas 67204

STATE OF KANSAS)
SEDGWICK COUNTY) ss

Be it remembered that on this 23rd day of January, 1989, before me, a notary public in and for said County and State, came Bernard J. Patrick to me personally known to be the same person(s) who executed the foregoing instrument of writing and duly acknowledged the execution of same. In testimony whereof, I have hereunto set my hand and affixed my notarial seal the day and year above written.

SEAL

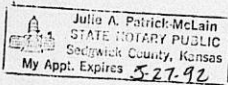

Julie A. Patrick-McLain
Notary Public

My Commission expires: 5-27-92