

Bic

D-1554 - Rodger's Enterprises dedicates utility easement N. of Harry and W of the Kansas Turnpike.

ACTION

S/D COMMITTEE Approved ^{DATE} 2/23/89

M.A.P.C. approved 3/2/89

W.C.C./B.CO.C. Approved 4/8/89

59A6B

D-1554 - Rodger's Enterprises dedicates utility easement N. of Harry and W of the Kansas Turnpike.

ACTION

DATE
2/23/89

Approved

S/D COMMITTEE

3/2/89

approved

M.A.P.C.

4/8/89

Approved

W.C.C./B.C.C.

59A6B

RECEIVED 2-16-89

Map No. 5946B
Sec. 30
Twp. 27S
Range 2E
Dist.No. _____

DEDICATION REPORT AND PROGRESS

CASE No: D-1554
ASSOCIATED CASE: L/S 0758

I. Offer to Dedicate: Utility Easement
Generally Located: In a general area north of Harry and West of the Kansas turnpike.

Legally Described As:
The west 10.00 feet of Lot 2, Block 1, Spring Lake, an addition to Wichita, Sedgwick County, Kansas.

Dedicated By: Rodger's Enterprises
Address: _____ Phone: _____
Purpose of Dedication: _____

II. Sketch.

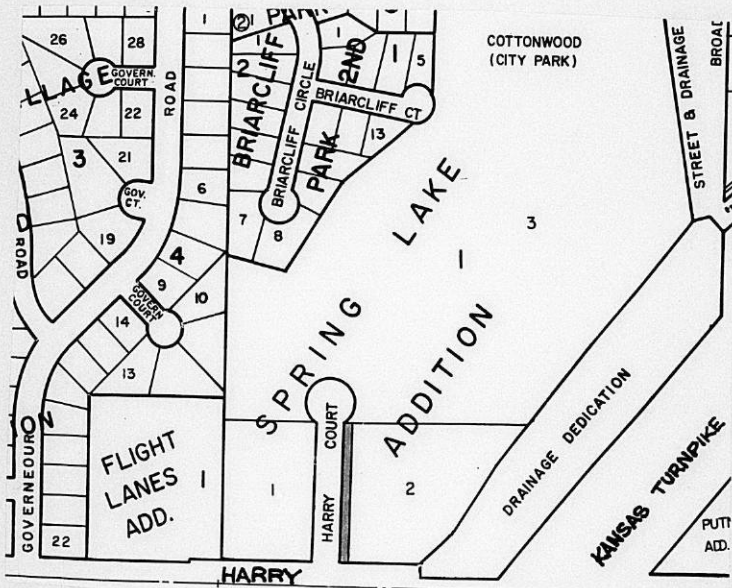

III. Filed 1-5-89
Posted to Atlas _____
S/D Comm. Action 2-23-89 Approved
M.A.P.C. Action 3/2/89
W.C.C. Action 4/18/89 Approved
Placed on Record _____
City Clerks No. _____

Planning Agenda Item # _____

City of Wichita
City Council Meeting
April 18, 1989

Agenda Report # _____

TO: Mayor and City Council Members

SUBJECT: D-1554 - DEDICATION OF UTILITY EASEMENT, IN AN AREA NORTH OF HARRY AND WEST OF THE KANSAS TURNPIKE

INITIATED BY: Metropolitan Area Planning Department

AGENDA ACTION: Planning

MAPC Recommendation: Accept the dedication.

Background: This dedication was a requirement of an approved lot split (L/S-0758). It provides for an extension of a sanitary sewer lateral required for one of the building sites created. The dedication has been reviewed and approved by the Planning Commission.

Financial Considerations: Bill the recording costs to:
150029-2909.

Recommendations/Action: Accept the dedication and record document.

EASEMENT

THIS EASEMENT made this 5 day of Jan, 1988, by and between Rodger's Enterprises, Inc. of the first part and the City of Wichita of the second part.

WITNESSETH: that the said first party, in consideration of the sum of One Dollar (\$1.00) and other valuable consideration, the receipt whereof is hereby acknowledged, do hereby grant and convey unto the said second party a perpetual right of way and easement for the purpose of constructing, maintaining and repairing their utilities, over, along and under the following described real estate situated in Sedgwick County, Kansas, to wit:

The West 10.00 feet of Lot 2, Block 1, Spring Lake, an addition to Wichita, Sedgwick County, Kansas.

And said second party is hereby granted the right to enter upon said premises at any time for the purpose of constructing, operating, maintaining and repairing their utilities.

IN WITNESS WHEREOF: The said first party has signed these presents the day and year first written.

Rodger's Enterprises, Inc.

By: [Signature]
Keith L. Anderson, President

STATE OF KANSAS
ss:
SEDGWICK COUNTY

Personally appeared before me a notary public in and for the County and State aforesaid came Keith L. Anderson, President of Rodger's Enterprises, Inc., to me personally known to be the same person who executed the foregoing instrument of writing and said person duly acknowledged the execution thereof.

Dated at Wichita this 5th day of January, 1988.

Nancy J. Bertram
Notary Public

My Appointment Expires: 6-22-89

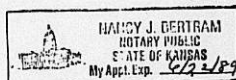

For SD Meeting 2/23/89
Dedication
Associated Case 450788
Map No. 5946B
Sec. 30
Twp 27S
Rng. 2E

Rodger's Enterprises,
dedicate a utility easement
located in a general
area N. of Harry and
West of the Kansas
Turnpike.