

ACTION

	DATE
SID COMMITTEE	
M.A.P.C.	
W.C.C.B. CO. C.	

64. of C4319 1/19/89

" " 3/1/89

D-1561 - Emprise Bank dedicates street right-of-way located on the south side of 37th St., in an area W. of Ridge Rd.

POSTED 3-14-89 KX

Bic

ACTION

SID COMMITTEE	DATE
M.A.P.C.	1/19/89
W.G.G.H.B. CO. C.	3/1/89

D-1561 -
right-of-
of 37th

Map No. 4951A
Sec. 33
Twp. 26S
Range 1W
Dist.No.

DEDICATION REPORT AND PROGRESS

CASE No: D-1561
ASSOCIATED CASE:

I. Offer to Dedicate: Street Right-of-way

Generally Located: On the south side of 37th Street, in an area west of Ridge Road.

Legally Described As:

The north fifty (50) feet of the east thirty (30) acres of the west 1/2 of the northeast quarter of Section 33, Township 26 S, Range 1 West of the 6th P.M., Sedgwick County, Kansas, lying north of the Missouri Pacific Railroad right-of-way.

Dedicated By: American Bank & Trust Co. Now By Merger: Emprise Bank

Address:

Phone:

Purpose of Dedication:

II. Sketch:

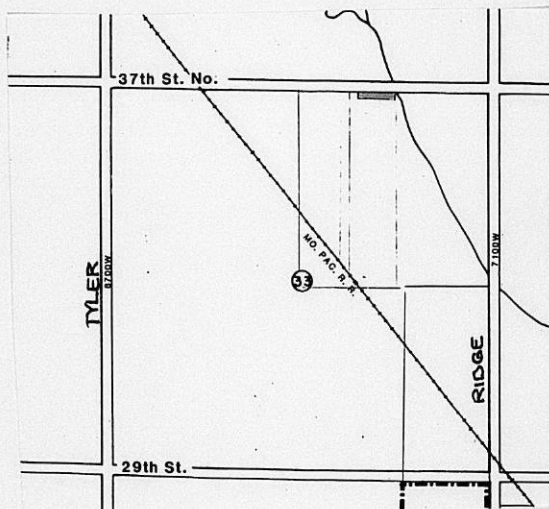

III. Filed 2/2/89
Posted to Atlas _____
S/D Comm. Action N/A
M.A.P.C. Action 1/19/89

W.C.C. Action _____
Bd. Co. Comm 3/1/89
Placed on Record _____
City Clerks No. _____

KNOWN ALL MEN BY THESE PRESENTS:

That for and in consideration of the sum of One Dollar (\$1.00) and other good and valuable considerations, the receipt of which is hereby-acknowledged, the undersigned,

UNITED AMERICAN BANK & TRUST CO. NOW BY MERGER: EMPRISE BANK

being the owner _____ of the following described real estate in Sedgwick County, Kansas, to wit:

THE NORTH FIFTY (50) FEET OF THE EAST THIRTY (30) ACRES OF THE WEST 1/2 OF THE NORTHEAST QUARTER OF SECTION 33, TOWNSHIP 26 SOUTH, RANGE 1 WEST OF THE 6th P.M., SEDGWICK COUNTY, KANSAS, LYING NORTH OF THE MISSOURI PACIFIC RAILROAD RIGHT-OF-WAY.

Do hereby dedicate the above described real estate to the public for street or road purposes.

Executed this 2nd day of February, 1989.

ENTERED ON
TRANSFER RECORD
MAR 6 1989
DON WRIGHT
COUNTY CLERK

Kenneth A. Waegener
Kenneth A. Waegener,
Sr. Vice President

United American Bank & Trust Co.
~~now by Merger: Emprise Bank~~

STATE OF KANSAS }
SEDGWICK COUNTY } ss

BE IT REMEMBERED, That on this 2nd day of February, 1989, before me a Notary Public in and for the said County and State came Kenneth A. Waegener, Sr. Vice President of United American Bank & Trust Co., now by merger: Emprise Bank

IN WITNESS WHEREOF, I have hereunto subscribed my name and affixed my Notarial Seal, on day and year last above written.

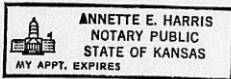

Annette E. Harris
Annette E. Harris
NOTARY PUBLIC

My appointment expires 12-11-92

SUBMITTED TO THE OFFICE OF COUNTY ENGINEER AND THE BOARD OF COUNTY COMMISSIONERS FOR APPROVAL ON 3-1-89

APPROVED BY

David C. Spears
David C. Spears

DIRECTOR, BUREAU OF PUBLIC SERVICES/
COUNTY ENGINEER

Paul W. Hancock
Paul W. Hancock
CHAIRMAN, Sedgwick County Board
of Commissioners

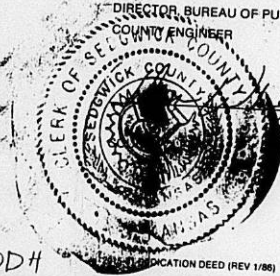

Don Wright
DON WRIGHT,
Sedgwick County Clerk

STATE OF KANSAS } ss
SEDGWICK COUNTY }
FILED FOR RECORD AT
8:00 AM

MAR 6 09 0997387
PAT KETTLER
REGISTER OF DEEDS

MICROFILMED
OF RECORD

Ed Reed Deputy

ODH

DEDICATION DEED (REV 1/86)

COUNTY CLERK