

POSTED 5-2-89 KL

Bill

D-1572 - Woodlawn Development Co.,
dedicates a drainage easement located
north of 32nd St. N. and W. of Rock
Rd.

6961B

ACTION

	DATE
S/D COMMITTEE	3/23/89
M.A.P.C.	3/30/89
W.C.C./B.C.C.	5/8/89

Approved

Approved

Approved

Map No. 5951B
 Sec. 31
 Twp. 26S
 Range 2E
 Dist.No.

DEDICATION REPORT AND PROGRESS

CASE No: D-1572
 ASSOCIATED CASE: V-1594

- I. Offer to Dedicate: Drainage Easement
Generally Located: North of 32nd St. No. & West of Rock Rd.

Legally Described As:

A tract of land lying in Lot 1, Block 1, KILLARNEY PLAZA THRID, an addition to Wichita, Sedgwick County, Kansas, more particularly described as follows:

Beginning at the Northwest corner of said Lot 1, Block 1; thence following the North line of said Lot 1, Block 1, N89°03'14"E, 583.04 feet; thence S75°12'39"E, 184.37 feet; thence N89°03'14"E, 354.72 feet to the northeast corner of said Lot 1, Block 1; thence S0°55'48"E, 70.00 feet; thence S89°03'14"W, 216.90 feet; thence N75°12'39"W, 331.85 feet; thence S89°03'14"W, 578.88 feet to a point on the West line of said Lot 1, Block 1; thence N0°58'47"W, 30.00 feet to the point of beginning.

Dedicated By: Woodlawn Development Co.

Address: _____ Phone: _____
Purpose of Dedication: _____

II. Sketch:

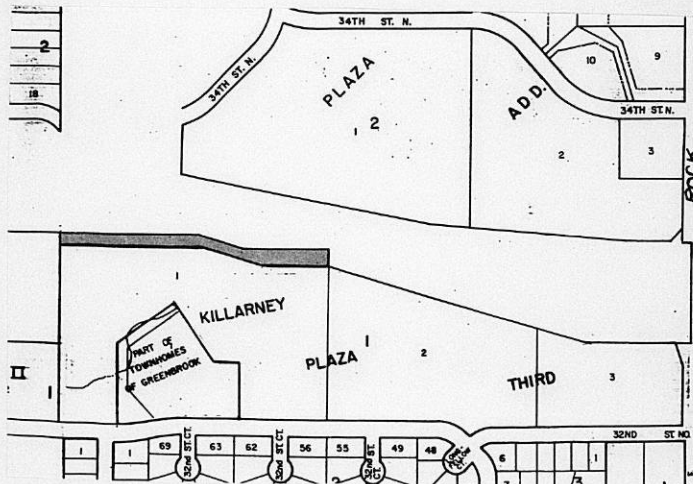

III. Filed 2/22/89
 Posted to Atlas _____
 S/D Comm. Action N/A _____
 M.A.P.C. Action _____
 W.C.C. Action 5/9/89 Copeland _____
 Placed on Record _____
 City Clerks No. _____

DRAINAGE EASEMENT

THIS EASEMENT made this 22 day of February, 1989, by and between Woodlawn Development Company, a Kansas general partnership of the first part and City of Wichita, Kansas, of the second part.

WITNESSETH: that the said first party, in consideration of the sum of One Dollar (\$1.00) and other valuable consideration, the receipt whereof is hereby acknowledged, do hereby grant and convey unto the said second party a perpetual right of way and easement for the purpose of construction, maintaining and repairing their storm sewer and fence along and under the following described real estate situated in Sedgwick County, Kansas, to wit:

A tract of land lying in Lot 1, Block 1, KILLARNEY PLAZA THIRD, an addition to Wichita, Sedgwick County, Kansas, more particularly described as follows:

Beginning at the Northwest corner of said Lot 1, Block 1; thence following the North line of said Lot 1, Block 1, N 89° 03' 14" E, 583.04 feet; thence S 75° 12' 39" E, 184.37 feet; thence N 89° 03' 14" E, 354.72 feet to the Northeast corner of said Lot 1, Block 1; thence S 0° 55' 48" E, 70.00 feet; thence S 89° 03' 14" W, 216.90 feet; thence N 75° 12' 39" W, 331.85 feet; thence S 89° 03' 14" W, 578.88 feet to a point on the West line of said Lot 1, Block 1; thence N 0° 58' 47" W, 30.00 feet to the point of beginning.

And said second party is hereby granted the right to enter upon said premises at any time for the purpose of constructing, operating, maintaining and repairing their storm sewer.

IN WITNESS WHEREOF: The said first party has signed these presents the day and year first written.

WOODLAWN DEVELOPMENT COMPANY
a Kansas general partnership

By: George D. Sherman
George D. Sherman, Vice-President
American Diversified Real Estate, Inc.
general partner

STATE OF KANSAS
ss.
SEDGWICK COUNTY

Personally appeared before me a notary public in and for the County and State aforesaid came George D. Sherman, Vice-President, American Diversified Real Estate, Inc. general partner with Woodlawn Development Company, a Kansas general partnership, to me personally known to be the same person who executed the foregoing instrument of writing and said person duly acknowledged the execution thereof.

Dated at Wichita this 22 day of February, 1989.

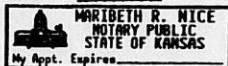

Maribeth R. Nice
Notary Public

My Appointment Expires: 2/3/93

SND 76

DRAINAGE EASEMENT

THIS EASEMENT made this 22 day of February, 1989,
by and between Woodlawn Development Company, a Kansas general partnership
of the first part and City of Wichita, Kansas, of the second part.

WITNESSETH: that the said first party, in consideration of the sum
of One Dollar (\$1.00) and other valuable consideration, the receipt
whereof is hereby acknowledged, do hereby grant and convey unto the said
second party a perpetual right of way and easement for the purpose of
construction, maintaining and repairing their storm sewer and fence along
and under the following described real estate situated in Sedgwick County,
Kansas, to wit:

A tract of land lying in Lot 1, Block 1, KILLARNEY PLAZA THIRD,
an addition to Wichita, Sedgwick County, Kansas, more
particularly described as follows:

Beginning at the Northwest corner of said Lot 1, Block 1; thence
following the North line of said Lot 1, Block 1, N 89° 03' 14"
E, 583.04 feet; thence S 75° 12' 39" E, 184.37 feet; thence N
89° 03' 14" E, 354.72 feet to the Northeast corner of said Lot
1, Block 1; thence S 0° 55' 48" E, 70.00 feet; thence S 89° 03'
14" W, 216.90 feet; thence N 75° 12' 39" W, 331.85 feet; thence
S 89° 03' 14" W, 578.88 feet to a point on the West line of said
Lot 1, Block 1; thence N 0° 58' 47" W, 30.00 feet to the point
of beginning.

And said second party is hereby granted the right to enter upon said
premises at any time for the purpose of constructing, operating,
maintaining and repairing their storm sewer.

IN WITNESS WHEREOF: The said first party has signed these presents
the day and year first written.

WOODLAWN DEVELOPMENT COMPANY
a Kansas general partnership

By: George D. Sherman
George D. Sherman, Vice-President
American Diversified Real Estate, Inc.
general partner

STATE OF KANSAS
ss.
SEDGWICK COUNTY

Personally appeared before me a notary public in and for the County
and State aforesaid came George D. Sherman, Vice-President, American
Diversified Real Estate, Inc. general partner with Woodlawn Development
Company, a Kansas general partnership, to me personally known to be the
same person who executed the foregoing instrument of writing and said
person duly acknowledged the execution thereof.

Dated at Wichita this 22 day of February, 1989.



Maribeth R. Nice
Notary Public

My Appointment Expires: 2/3/93