

ACTION

DATE

S/D COMMITTEE

~~_____~~
~~_____~~

M.A.P.C.

~~_____~~
Agreement of SP 8-21
Thursday 15th (del)

W.C.C. | ~~E.C.C.~~ C.

5/23/89

Approved

D-1578 - Good Shepherd Episcopal Church dedicates a utility easement located in an area northeast of 19th St. N. & Westridge.

GA9D

POSTED 5-12-89 KLB

Bill

ACTION

DATE

S/D COMMITTEE

~~_____~~

M.A.P.C.

W.C.C. / ~~E.C.C.~~ C.

Agreement of S/D 6-21
Thompson and S/D 6-21

5/23/89

Approved

Map No. 5249D
 Sec. 12
 Twp. 27S
 Range 1W
 Dist.No.

DEDICATION REPORT AND PROGRESS

CASE No: D-1578
 ASSOCIATED CASE: S/D 89-21

Thunderbird 5th Add

- I. Offer to Dedicate: Utility Easement
Generally Located: In an area northeast of 19th St. West and Westridge.

Legally Described As:

A utility easement in Lot 12 Scenic Heights Wichita, Kansas, Described as: Beginning at a point in the east line and 120.02 feet north of the southeast corner of said Lot 12; thence west parallel to the south line of said Lot 12 bearing N90°00'00"W a distance of 196.27 feet; thence bearing N1°01'14"W a distance of 76.79 feet; thence bearing S88°58'46"W a distance of 15.00 feet; thence bearing N1°01'14"W a distance of 10.00 feet; thence bearing N88°58'46"E a distance of 20.00 feet; thence bearing S1°01'14"E a distance of 76.88 feet; thence bearing N90°00'00"E a distance of 171.26 feet; thence bearing N1°03'39"W a distance of 39.63 feet; thence bearing N88°56'21"E a distance of 20.00 feet to a point in the east line of said Lot 12; thence along said east line bearing S1°03'39"E a distance of 50.00 feet to the point of beginning.

Dedicated By: Good Shepherd Episcopal Church

Address: _____ Phone: _____
Purpose of Dedication:

Requirement of Thunderbird 5th Addition

II. Sketch:

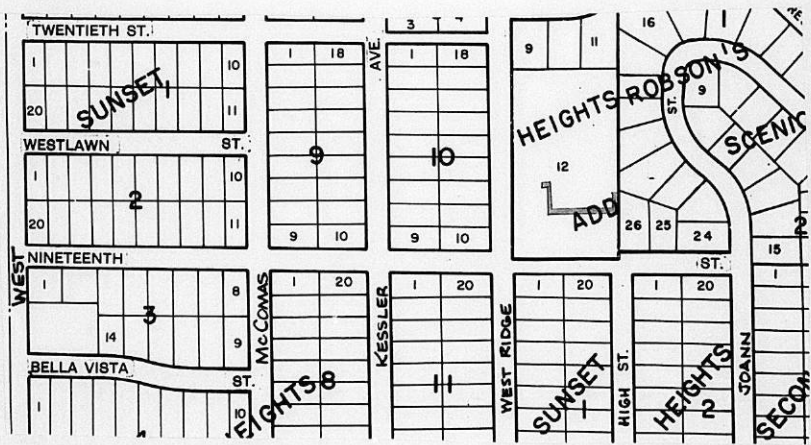

III. Filed 5/1/89
 Posted to Atlas _____
 S/D Comm. Action N/A
 M.A.P.C. Action _____
 W.C.C. Action 5/23/89 Approved
 Placed on Record _____
 City Clerks No. _____

Thunderbird 5th Plot

EASEMENT

THIS EASEMENT made this 1st day of May, 1989,
by and between Good Shepherd Episcopal Church Wichita, Kansas, Inc.
of the first part and the City of Wichita, of the second part.

WITNESSETH: That the said first party, in consideration of the sum of One Dollar (\$1.00) and other valuable consideration, the receipt whereof is hereby acknowledged, do hereby grant and convey unto the said second party a perpetual right of way and easement for the purpose of constructing, maintaining, and repairing all public utilities, over, along and under the following described real estate situated in Sedgwick County, Kansas, to wit:

A UTILITY EASEMENT IN LOT 12 SCENIC HEIGHTS WICHITA, KANSAS, DESCRIBED AS: BEGINNING AT A POINT IN THE EAST LINE AND 120.02 FEET NORTH OF THE SE CORNER OF SAID LOT 12; THENCE WEST PARALLLEL TO THE SOUTH LINE OF SAID LOT 12 BEARING N90°00'00"W A DISTANCE OF 196.27 FEET; THENCE BEARING N1°01'14"W A DISTANCE OF 76.79 FEET; THENCE BEARING S88°58'46"W A DISTANCE OF 15.00 FEET; THENCE BEARING N1°01'14"W A DISTANCE OF 10.00 FEET; THENCE BEARING N88°58'46"E A DISTANCE OF 20.00 FEET; THENCE BEARING S1°01'14"E A DISTANCE OF 76.88 FEET; THENCE BEARING N90°00'00"E A DISTANCE OF 171.26 FEET; THENCE BEARING N1°03'39"W A DISTANCE OF 39.63 FEET; THENCE BEARING N88°56'21"E A DISTANCE OF 20.00 FEET TO A POINT IN THE EAST LINE OF SAID LOT 12; THENCE ALONG SAID EAST LINE BEARING S1°03'39"E A DISTANCE OF 50.00 FEET TO THE POINT OF BEGINNING.

And said second party is hereby granted the right to enter upon said premises at any time for the purpose of constructing, operating, maintaining, and repairing said public utilities.

IN WITNESS WHEREOF: The said first party has signed these presents the day and year first written.

GOOD SHEPHERD EPISCOPAL CHURCH

WICHITA, KANSAS, INC.

Robert W. Harvey
THE VERY REVEREND ROBERT W. HARVEY

STATE OF KANSAS) SS
SEDGWICK COUNTY)

Personally appeared before me a notary public in and for the County and State aforesaid the very reverend Robert W. Harvey

to me personally known to be the same person who executed the foregoing instrument of writing and said person duly acknowledged the execution thereof.

Dated at Wichita, Kansas, this 1st day of May, 1989.

Gary L. Wiley
Notary Public

(My Commission expires 1-3-1993)

