

D-1590 - Woodlawn Development Co.
dedicates a utility easement located
on both sides of 32nd St. No. in an
area east of Rock Rd. & N. of 29th N.

POSTED 1-11-90
KCC

Bic

ACTION

S/D COMMITTEE	DATE
M.A.P.C.	
W.C.C./B CC C. approval as cond. of V-1634	12/5/84

6081C

Map No. 6051C
Sec. 32
Twp. 26S
Range 2E
Dist.No. 2

DEDICATION REPORT AND PROGRESS

CASE No: D-1590
ASSOCIATED CASE: V-1634

- I. Offer to Dedicate: Utility Easement
Generally Located: On both sides of 32nd St. No. in an area east of Rock Rd. and north of 29th.

Legally Described As:

The west 5 feet of the east 10 feet of Lot 4, Block 2, and the west 10 feet of the east 53 feet of Lot 3, Block 1, Mediterranean Plaza, an addition to Wichita, Sedgwick County, Kansas.

Dedicated By: Woodlawn Development

Address:

Phone:

Purpose of Dedication:

II. Sketch:

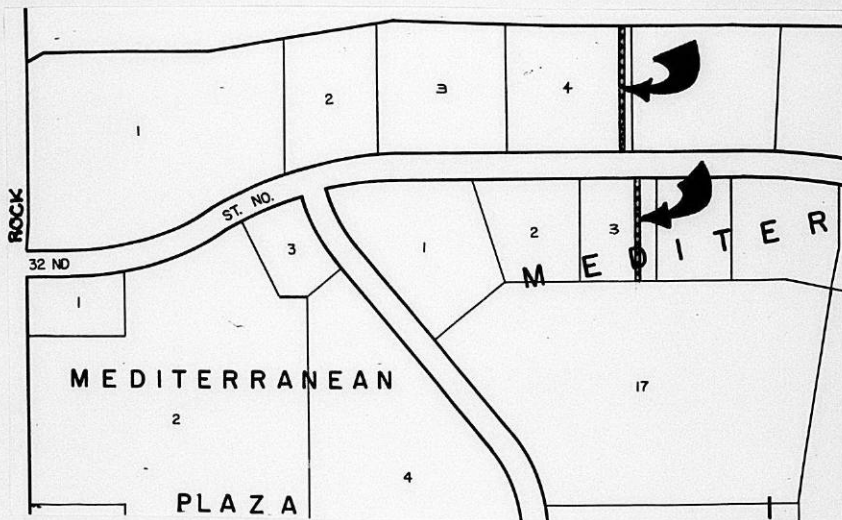

III. Filed 11/6/89
Posted to Atlas _____
S/D Comm. Action N/A _____
M.A.P.C. Action _____
W.C.C. Action _____
Placed on Record _____
City Clerks No. _____

Approved / Accepted By City Council

This DEC 5 1989

UTILITY EASEMENT

THIS EASEMENT made this 6TH day of NOVEMBER, 1989, by and between Woodlawn Development Company of the first part and City of Wichita, Kansas, of the second part.

WITNESSETH: that the said first party, in consideration of the sum of One Dollar (\$1.00) and other valuable consideration, the receipt whereof is hereby acknowledged, do hereby grant and convey unto the said second party a perpetual right of way and easement for the purpose of construction, maintaining and repairing their utilities, along and under the following described real estate situated in Sedgwick County, Kansas, to wit:

The West 5.00 feet of the East 10.00 feet of Lot 4, Block 2, and the West 10.00 feet of the East 53.00 feet of Lot 3, Block 1, MEDITERRANEAN PLAZA, an addition to Wichita, Sedgwick County, Kansas.

And said second party is hereby granted the right to enter upon said premises at any time for the purpose of constructing, operating, maintaining and repairing their utilities.

IN WITNESS WHEREOF: The said first party has signed these presents the day and year first written.

STATE OF KANSAS } SS
SEDCWICK COUNTY }
FILED FOR RECORD AT

8-00 AM

Dec 28 89 1044768

PAT KETTLER
REGISTER OF DEEDS

WOODLAWN DEVELOPMENT COMPANY

By: George Sherman
George Sherman, Vice-President
American Diversified Real Estate, Inc.
a general partner

STATE OF KANSAS

ss.

Ed Reed
Deputy

SEDCWICK COUNTY

Personally appeared before me a notary public in and for the County and State aforesaid came George Sherman, Vice-President, American Diversified Real Estate, Inc., a general partner for Woodlawn Development Company, to me personally known to be the same person who executed the foregoing instrument of writing and said person duly acknowledged the execution thereof.

Dated at Wichita this 6th day of November, 1989.

TAMMY R. DENNY
NOTARY PUBLIC
STATE OF KANSAS
My Appl. Exp. 5-11-93

Tammy R. Denny
Notary Public TAMMY R. DENNY

My Appointment Expires: 5-17-93

IPY

V-1634

D⁹⁰ Woodlawn Development
Company finds a utility
ensemble, located on both
sides of 32nd St. No. in an area
E. of Rock Road and No. of 29th
St. No.

Map 6051 C
Sec 32
Twp 26 S
Rng. 2 E
Dist No. 2

~~NO~~
~~SLIP DATE~~

Assoc. W/ V-1634

UTILITY EASEMENT

THIS EASEMENT made this 6TH day of NOVEMBER, 1989, by and between Woodlawn Development Company of the first part and City of Wichita, Kansas, of the second part.

WITNESSETH: that the said first party, in consideration of the sum of One Dollar (\$1.00) and other valuable consideration, the receipt whereof is hereby acknowledged, do hereby grant and convey unto the said second party a perpetual right of way and easement for the purpose of construction, maintaining and repairing their utilities, along and under the following described real estate situated in Sedgwick County, Kansas, to wit:

The West 5.00 feet of the East 10.00 feet of Lot 4, Block 2, and the West 10.00 feet of the East 53.00 feet of Lot 3, Block 1, MEDITERRANEAN PLAZA, an addition to Wichita, Sedgwick County, Kansas.

And said second party is hereby granted the right to enter upon said premises at any time for the purpose of constructing, operating, maintaining and repairing their utilities.

IN WITNESS WHEREOF: The said first party has signed these presents the day and year first written.

WOODLAWN DEVELOPMENT COMPANY

By: George Sherman

George Sherman, Vice-President
American Diversified Real Estate, Inc.
a general partner

STATE OF KANSAS

ss.

SEDGWICK COUNTY

Personally appeared before me a notary public in and for the County and State aforesaid came George Sherman, Vice-President, American Diversified Real Estate, Inc., a general partner for Woodlawn Development Company, to me personally known to be the same person who executed the foregoing instrument of writing and said person duly acknowledged the execution thereof.

Dated at Wichita this 6th day of November, 1989.

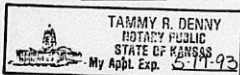

Tammy R. Denny
Notary Public

My Appointment Expires: 5-17-93