

M.A.P.C. Appraisal of La 5-21-81
condemnation
B.C.C./B.CO. C. Appraisal on 6-16-81
Recommendation

DP-17 - E-NAMU - COMMERCIAL C. OF
APPENDED FILE #1 - In the north
side of Kellogg, between Webb and
Bonnie Brae

POSTED

5-1-81

ACTION

COMMITTEE	DATE
M.A.P.C. <i>Approved as to conditions</i>	<i>5-21-81</i>
B.C.C./B. CO. C. <i>Approved as recommended</i>	<i>6-16-81</i>

Map No. 6047B
Sec. _____
Twp. _____
Range _____

DATA SHEET
COMMUNITY UNIT PLAN

AMENDED FILE #1
DP - 15
Filed 4-28-81

Associated
Case: _____

APPLICATION REQUEST: Approval of proposed Amendment to the
K-MART
~~(Residential)~~ (Commercial) Community Unit Plan.

1. Applicant East Wichita Partner % Waldorf Assoc. Att-John D. Martin
Address P.O. Box 27416, Houston, Tx. 77027 Phone 713-621-0700
2. Agent Baughman Company, P.A. Att. William L. Korber
Address 330 Laura, 67211 Phone 262-7271
3. General Location: On the north side of Kellogg, between Webb and
Bonnie Brae. Address _____
4. Proposed Use: _____

AREA DATA:

1. Acres: 14.9 (IRREGULAR) _____ ft. by _____ ft.)
2. Existing Zoning "LC" Proposed Zoning _____
3. Area (is) (is not) platted. _____ Addition

HISTORY

PROCEDURE DATA

1. MAPC Meeting:

Date	Action
<u>5-21-81</u>	<u>Approved sub to conditions</u>

2. Governing Body

Date	Action
<u>6-16-81</u>	<u>Approved as recommended</u>

NOTES:

Letter and memo concerning the pro area DP 13 file #1

LOS ANGELES COUNTY
REGISTERED PROFESSIONAL
LAND SURVEYOR
No. 2153C
J. W. ANDERSON, TRULOCK & SHOFF, CPAs
U.S.A.

Shoff
No. 2153C

CASE FILE

WICHITA-SEDGWICK COUNTY
METROPOLITAN AREA PLANNING COMMISSION
CITY HALL, TENTH FLOOR, 455 NORTH MAIN STREET
WICHITA, KANSAS 67202

May 7, 1981

NOTICE TO ADJOINING PROPERTY OWNERS:

NOTICE IS HEREBY GIVEN that on Thursday, May 21, 1981, said meeting beginning at 1:30 p.m., the Wichita-Sedgwick County Metropolitan Area Planning Commission, in the City Commission Meeting Room, City Hall, First Floor, 455 North Main Street, Wichita, Kansas, will consider an application for amendment to the K-MART COMMERCIAL COMMUNITY UNIT PLAN, for property legally described as follows:

DP-15 - Lot 1, Wiedemann Addition, Sedgwick County, Kansas. Generally located on the North side of Kellogg, in an area West of Webb Road.

The Development Plan of this area, originally approved on April 19, 1966, has been resubmitted as required under the Community Unit Plan provisions of Section 28.04.190 of the City Zoning Ordinance of the City of Wichita. The Development Plan is on file in the Planning Department Office, Tenth Floor, City Hall, 455 North Main, Wichita, Kansas, and is available for public information and review.

The revised Development Plan now on file proposes the following general amendments to the approved plan:

1. Reduction of the 300 foot building setback line along Kellogg in Parcel 1 to permit the construction of a restaurant.
2. Deletion of a drainage dedication along the west side of the C.U.P. and recomputation of maximum building coverage and floor area.
3. Minor changes to the plan to reflect current standards and requirements for building setback lines, floor area, and other information relating to future development.

The hearing of the proposed amendments to this Development Plan, as provided in Section 28.04.190 of the City Zoning Ordinance of the City of Wichita, is to be held and the same will there be discussed and considered by said Wichita-Sedgwick County Metropolitan Area Planning Commission. Those persons interested in this matter will be heard at that time.

The Citizens Participation Organization (CPO) neighborhood council will consider this case in the immediate future for the purpose of making a formal recommendation to the MAPC and BCC. If you have an interest in this case, you are encouraged to express your opinions at your CPO Council meeting. The date, time and location of the CPO meeting may be obtained by calling 268-4516.

Additional information concerning this case may be obtained from the Planning Department, 10th Floor, City Hall, or by calling 268-4421.

Robert A. Lakin
Secretary

Map No. 6047B
Sec. _____
Twp. _____
Range _____

DATA SHEET
COMMUNITY UNIT PLAN

AMENDED FILE #1
DP - 15
Filed 4-28-81
Associated Case: _____

APPLICATION REQUEST: Approval of proposed Amendment to the
K-MART
~~Business Center~~ (Commercial) Community Unit Plan.

1. Applicant East Wichita Partner % Waldorf Assoc. Att-John D. Martin
Address P.O. Box 27416, Houston, Tx. 77027 Phone 713-621-0700
2. Agent Baughman Company, P.A. Att. William L. Korber
Address 330 Laura, 67211 Phone 262-7271
3. General Location: On the north side of Kellogg, between Webb and Bonnie Brae. Address _____
4. Proposed Use: _____

- AREA DATA:
1. Acres: 14.9 (600 (IRREGULAR) ft. by 1080 ft.)
 2. Existing Zoning: "LC"
 3. Land Use: East _____ South _____
West _____ North _____
 4. Sketch Plan Land Use is for: _____
 5. Present Land Use is for: _____
 6. Area (is) (is not) platted. _____

PHOTO DATA: Taken by _____ Date _____ Time _____

DP-15

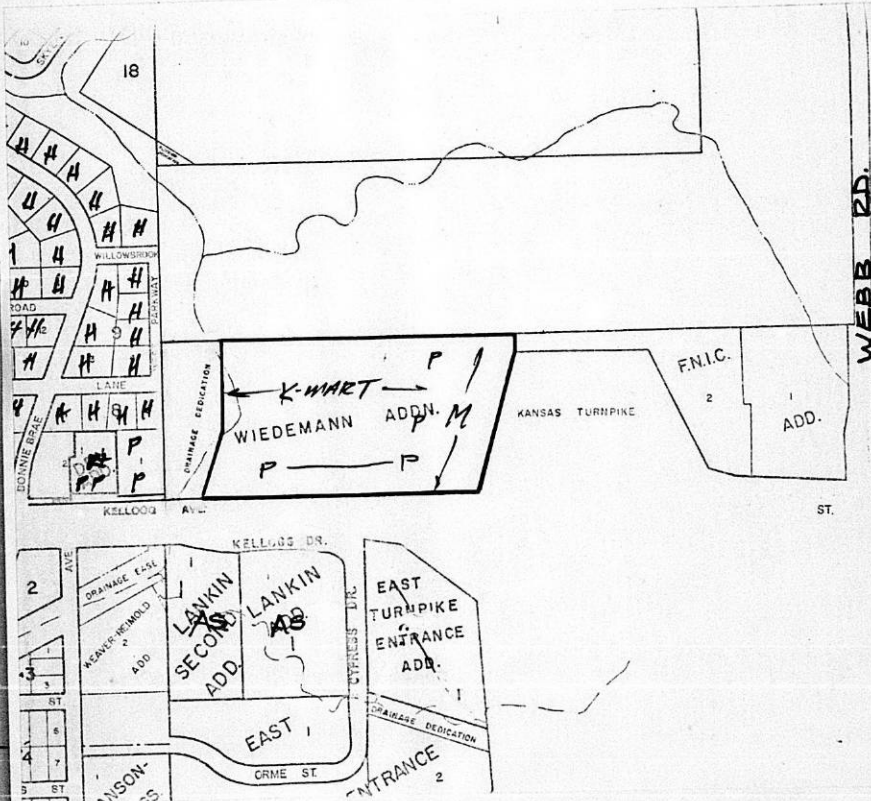

PICTURE SHEET

July 8, 1981

Robert B. Feldner, Superintendent of Central Inspection
Jack H. Galbraith, Chief Planner

DP-15 - K-Mart Commercial C.U.P. Generally located on the north side of Kellogg, between Webb Road and Bonnie Brae.

The Board of City Commissioners on June 16, 1981, considered the above captioned C.U.P. Their action was to approve the C.U.P. subject to the following conditions:

- a. Prior to the issuance of a building permit on Parcel 1 the missing plant materials for the landscape strip along the west boundary of Parcel 1 shall be replanted in accordance with the approved landscape plan.
- b. The development of this property shall proceed in accordance with the development plan as recommended for approval by the Planning Commission and approved by the governing body, and any substantial deviation of the plan, as determined by the Superintendent of Central Inspection and the Director of Planning, shall constitute a violation of the building permit authorizing construction of the proposed development.
- c. Any major changes in this development plan shall be resubmitted to the Planning Commission and to the City Commission for its consideration.
- d. The transfer of title of all or any portion of the land included within the Community Unit Plan does not constitute a termination of the plan or any portion thereof, but said plan shall run with the land for commercial development and be binding upon the present owners, their successors and assigns, unless amended.

Please note that prior to the issuance of any building permits, and in accordance with condition "a" above, the missing plant materials must be replaced.

Attached for your information and files are two approved copies of the C.U.P. If you have any questions concerning this matter, please contact our office.

Jack H. Galbraith
Chief Planner

JHG:ADC:el
Attachments

RECOMMENDATION FROM METROPOLITAN AREA PLANNING COMMISSION TO
BOARD OF CITY COMMISSIONERSREQUEST FOR APPROVAL OF AN AMENDMENT
TO THE COMMERCIAL COMMUNITY UNIT PLAN

CASE NO. DP-15

CONSIDERED BY MAPC: 5-21-81

REQUEST FOR: Approval of an amendment to the K-Mart
Commercial Community Unit Plan

REASON FOR REQUEST (AS PROVIDED BY APPLICANT):

None stated.

GENERAL LOCATION: On the north side of Kellogg, between Webb and
Bonnie Brae.

LEGAL DESCRIPTION:

Lot 1, Wiedemann Addition, Sedgwick County, Kansas.

APPLICANT: East Wichita Partner, c/o Waldorf Association, P. o. Box
27416, Houston, Tx.

AGENT FOR APPLICANT: Bill Korber, Baughman Company, 330 Laura.

PROTESTORS (LIST AGENT) IF ANY: None

SURROUNDING ZONING: North, "AA"; East, "LC"; South, "LC" & "C"; West,
"AA" & "LC".LAND USE: Existing, Retail sales & motel; North, Undeveloped; East,
Kansas Turnpike; South, Auto Sales; West, Drainage, parking & single-family.CPO RECOMMENDATION: CPO Council Area "H" recommended 7-0 that the
amendment be approved.

PLANNING COMMISSION RECOMMENDATION:

That this application be approved subject to conditions as shown in the
attached excerpt from Planning Commission minutes of May 21, 1981.
Bayouth moved, Gardner seconded and it carried unanimously. Cazal and
Martens were not present. Lofton was absent.

ACTION: 1. Concur with the findings of fact of the Metropolitan Area
Planning Commission and approve the Community Unit Plan subject to the
recommended conditions; or
2. Return the application to the Metropolitan Area Planning
Commission for its reconsideration. The City Commission states the
following reasons for its action.

EXCERPT FROM PLANNING COMMISSION MINUTES OF MAY 21, 1981

6. Case No. DP-15 - East Wichita Partner requests approval of an amendment to the K-Mart Commercial Community Unit Plan for Lot 1, Wiedemann Addition, Sedgwick County, Kansas. Generally located on the north side of Kellogg, in an area west of Webb Road.

GALBRAITH pointed out land use, zoning, and showed slides of the general area. He reviewed the following staff report:

COMMENTS:

1. The following should be considered by the Planning Commission in making findings of fact:

In compliance with Section 28.04.190 of the Code of the City of Wichita, an application has been submitted requesting approval of an amendment to the existing K-Mart Commercial C.U.P. generally located on the north side of Kellogg between Webb Road and Bonnie Brae. The proposed amendment would reduce a portion of the existing 300 foot building setback line along Kellogg to 90 feet. Several minor changes have been made to the plan and text to reflect administrative adjustments and to bring the plan up-to-date. Building setback lines, floor area, building height and other information is shown on the plan.

2. The building setback line reduction is being requested so that a restaurant can be constructed in Parcel 1 of this C.U.P. Staff feels that the proposed amendment is appropriate and will not adversely affect adjoining property. The landscaping along the west boundary is generally in good condition, however, there are approximately ten trees missing. The missing plant materials should be replaced prior to the issuance of any building permit on Parcel 1.
3. Should the Planning Commission determine that the proposed amendments are appropriate the following are recommended conditions of approval:
 - a. Prior to the issuance of a building permit on Parcel 1 the missing plant materials for the landscape strip along the west boundary of Parcel 1 shall be replanted in accordance with the approved landscape plan.
 - b. The development of this property shall proceed in accordance with the development plan as recommended for approval by the Planning Commission and approved by the governing body, and any substantial deviation of the plan, as determined by the Superintendent of Central Inspection and the Director of Planning, shall constitute a violation of the building permit authorizing construction of the proposed development.
 - c. Any major changes in this development plan shall be resubmitted to the Planning Commission and to the City Commission for its consideration.
 - d. The transfer of title of all or any portion of the land included within the Community Unit Plan does not constitute a termination of the plan or any portion thereof, but said plan shall run with the land for commercial development and be binding upon the present owners, their successors and assigns, unless amended.

GALBRAITH stated that the staff recommended approval of the application. CPO Council Area "H" recommended 7-0 that the amendment be approved.

There was no one present in opposition to the application.

BILL KORBER, surveyor, representing the applicant, was present.

MOTION: Having considered the factors as contained in Policy Statement No. 10; taking into account the commercial nature of the neighborhood; the commercial uses and zoning to the east and south; the suitability of the subject property for development with a restaurant; and considering the recommendation of approval by staff; I move that we recommend to the governing body that this application be approved subject to the following conditions:

- a. Prior to the issuance of a building permit on Parcel 1 the missing plant materials for the landscape strip along the west boundary of Parcel 1 shall be replanted in accordance with the approved landscape plan.
- b. The development of this property shall proceed in accordance with the development plan as recommended for approval by the Planning Commission and approved by the governing body, and any substantial deviation of the plan, as determined by the Superintendent of Central Inspection and the Director of Planning, shall constitute a violation of the building permit authorizing construction of the proposed development.
- c. Any major changes in this development plan shall be resubmitted to the Planning Commission and to the City Commission for its consideration.
- d. The transfer of title of all or any portion of the land included within the Community Unit Plan does not constitute a termination of the plan or any portion thereof, but said plan shall run with the land for commercial development and be binding upon the present owners, their successors and assigns, unless amended.

Bayouth moved, Gardner seconded and it carried unanimously. Cazal and Martens were not present. Lofton was absent.

May 22, 1981

William L. Korber
Baughman Company, P.A.
330 Laura
Wichita, Kansas 67211

Re: Case No. DP-15 - Amendment to
K-Mart Commercial C.U.P. -
Located on the north side of
Kellogg between Webb & Bonnie
Brae

Dear Mr. Korber:

At its regular meeting on May 21, 1981, the Metropolitan Area Planning Commission considered the above-captioned request. The action of the Planning Commission was to recommend that this application be approved subject to the following conditions:

- a. Prior to the issuance of a building permit on Parcel 1 the missing plant materials for the landscape strip along the west boundary of Parcel 1 shall be replanted in accordance with the approved landscape plan.
- b. The development of this property shall proceed in accordance with the development plan as recommended for approval by the Planning Commission and approved by the governing body, and any substantial deviation of the plan, as determined by the Superintendent of Central Inspection and the Director of Planning, shall constitute a violation of the building permit authorizing construction of the proposed development.
- c. Any major changes in this development plan shall be resubmitted to the Planning Commission and to the City Commission for its consideration.
- d. The transfer of title of all or any portion of the land included within the Community Unit Plan does not constitute a termination of the plan or any portion there-

of, but said plan shall run with the land for commercial development and be binding upon the present owners, their successors and assigns, unless amended.

Please submit 10 copies of the C.U.P. to our office by June 5 so that subject case can be scheduled for consideration by the Board of City Commission on June 16. The meeting will be held in the City Commission Meeting Room, First Floor, City Hall, 455 North Main, Wichita, Kansas. We would remind you that Planning items are considered after all other matters of business.

If you have any questions concerning this matter, please contact our office.

Sincerely yours,

Jack H. Galbraith
Chief Planner

JHG:sad

cc: East Wichita Partners, % Waldorf Associates, Attn. John D. Martin,
P. O. Box 27416, Houston, Texas 77027

THE CITY OF WICHITA
OFFICE OF CITIZEN PARTICIPATION

DATE May 20, 1981

TO Jack Galbraith, Chief Planner, Current Plans

FROM Bill Morris, Administrative Aide III

SUBJECT DP-15: North Side of Kellogg,
West of Webb Road

CPO Council "H" considered the captioned case on May 18. The Council voted 7-0 to recommend approval of the proposed C.U.P. amendments.

The applicant and agent were present to give their views on the case. No citizens were present in opposition. It was the Council's opinion that the proposed restaurant on Parcel 1 is appropriate land use because of the adjoining commercial uses and its proximity to Kellogg.

The Council expressed concern about the wording of the notice to property owners regarding the deletion of the drainage dedication from the C.U.P. It was recommended that the wording more clearly indicate that the drainage dedication is being eliminated from the C.U.P. only, and will continue as a separate legal requirement on the property.

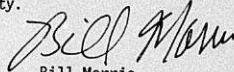

Bill Morris
Administrative Aide III

RECEIVED

MAY 21 1981

METROPOLITAN PLANNING

ROUTE

WICHITA-SEDGWICK COUNTY
METROPOLITAN AREA PLANNING DEPARTMENT

MAPC HEARING DATE: 5-21-81

Case No. DP-15 Request: Approval of an amendment
to the K-Mart Commercial
C.U.P.

Location: On the north side of Kellogg, between Webb & Bonnie Brae.

Acres: 14.5 Size: 600' x 1080' (irregular)

	<u>Land Use</u>	<u>Zoning</u>
Existing	Retail sales & motel	"LC"
North	Undeveloped	"AA"
East	Kansas Turnpike	"LC"
South	Auto Sales	"LC" & "C"
West	Drainage, parking & single-family	"AA" & "LC"

Existing right-of-ways are adequate Platted: Yes

History:

Z-0762	"AA" to "LC"			
DP-15		3-17-66	MAPC	Approve
		4-19-66	BCC	Approve
DP-15		8-04-66	MAPC	Approve
		9-06-66	BCC	Approve

COMMENTS:

1. The following should be considered by the Planning Commission in making findings of fact:

In compliance with Section 28.04.190 of the Code of the City of Wichita an application has been submitted requesting approval of an amendment to the existing K-Mart Commercial C.U.P. generally located on the north side of Kellogg between Webb Road and Bonnie Brae. The proposed amendment would reduce a portion of the existing 300 foot building setback line along Kellogg to 90 feet. Several minor changes have been made to the plan and text to reflect administrative adjustments and to bring the plan up-to-date. Building setback lines, floor area, building height and other information is shown on the plan.

2. The building setback line reduction is being requested so that a restaurant can be constructed in Parcel 1 of this C.U.P. Staff feels that the proposed amendment is appropriate and will not adversely affect adjoining property. The landscaping along the west boundary is generally in good condition, however, there are approximately ten trees missing. The missing plant materials should be replaced prior to the issuance of any building permit on Parcel 1.
3. Should the Planning Commission determine that the proposed amendments are appropriate the following are recommended conditions of approval:

Page 2
DP-15
MAPC AGENDA
5-21-61

- a. Prior to the issuance of a building permit on Parcel 1 the missing plant materials for the landscape strip along the west boundary of Parcel 1 shall be replanted in accordance with the approved landscape plan.
- b. The development of this property shall proceed in accordance with the development plan as recommended for approval by the Planning Commission and approved by the governing body, and any substantial deviation of the plan, as determined by the Superintendent of Central Inspection and the Director of Planning, shall constitute a violation of the building permit authorizing construction of the proposed development.
- c. Any major changes in this development plan shall be resubmitted to the Planning Commission and to the City Commission for its consideration.
- d. The transfer of title of all or any portion of the land included within the Community Unit Plan does not constitute a termination of the plan or any portion thereof, but said plan shall run with the land for commercial development and be binding upon the present owners, their successors and assigns, unless amended.

DP-15 - 62 - "Notice to Adjoining Property Owners" mailed 5-7-81 for
the MAPC meeting for 5-21-81

1	Including map to CPO Office
1	" " to "NEIGHBORS"
—	
64	TOTAL

WICHITA-SEDGWICK COUNTY
METROPOLITAN AREA PLANNING COMMISSION
CITY HALL, TENTH FLOOR, 455 NORTH MAIN STREET
WICHITA, KANSAS 67202

May 7, 1981

NOTICE TO ADJOINING PROPERTY OWNERS:

NOTICE IS HEREBY GIVEN that on Thursday, May 21, 1981, said meeting beginning at 1:30 p.m., the Wichita-Sedgwick County Metropolitan Area Planning Commission, in the City Commission Meeting Room, City Hall, First Floor, 455 North Main Street, Wichita, Kansas, will consider an application for amendment to the K-MART COMMERCIAL COMMUNITY UNIT PLAN, for property legally described as follows:

DP-15 - Lot 1, Wiedemann Addition, Sedgwick County, Kansas. Generally located on the North side of Kellogg, in an area West of Webb Road.

The Development Plan of this area, originally approved on April 19, 1966, has been resubmitted as required under the Community Unit Plan provisions of Section 20.04.190 of the City Zoning Ordinance of the City of Wichita. The Development Plan is on file in the Planning Department Office, Tenth Floor, City Hall, 455 North Main, Wichita, Kansas, and is available for public information and review.

The revised Development Plan now on file proposes the following general amendments to the approved plan:

1. Reduction of the 300 foot building setback line along Kellogg in Parcel 1 to permit the construction of a restaurant.
2. Deletion of a drainage dedication along the west side of the C.U.P. and recomputation of maximum building coverage and floor area.
3. Minor changes to the plan to reflect current standards and requirements for building setback lines, floor area, and other information relating to future development.

The hearing of the proposed amendments to this Development Plan, as provided in Section 20.04.190 of the City Zoning Ordinance of the City of Wichita, is to be held and the same will there be discussed and considered by said Wichita-Sedgwick County Metropolitan Area Planning Commission. Those persons interested in this matter will be heard at that time.

The Citizens Participation Organization (CPO) neighborhood council will consider this case in the immediate future for the purpose of making a formal recommendation to the MAPC and BCC. If you have an interest in this case, you are encouraged to express your opinions at your CPO Council meeting. The date, time and location of the CPO meeting may be obtained by calling 268-4316.

Additional information concerning this case may be obtained from the Planning Department, 10th Floor, City Hall, or by calling 268-4421.

Robert A. Lakin
Secretary

April 21, 1981

Paul Graves, Chief Engineer
Mike Lindebak, Program Development Engineer
Robert B. Feldner, Superintendent of Central Inspection

Arthur D. Chambers, Senior Planner

DP-15 - Furr's 201 (formerly K-Mart) Commercial C.U.P.
Generally located on the north side of Kellogg in an
area west of Webb Road.

We have received a proposed amendment to the above captioned
C.U.P. A copy is attached for your review and comment. The
building setback lines have been decreased to allow the con-
struction of an additional building in the area as shown on
the plan. We would appreciate receiving any comments you
might have by Wednesday, April 29, 1981.

If you have any questions, please call.

Arthur D. Chambers
Senior Planner

ADC:e1

Attachment

may 21st
DP-15
6047B

APPLICATION FOR COMMUNITY UNIT PLAN
(PLANNED RESIDENTIAL OR COMMERCIAL DEVELOPMENT)
FOR PROPERTY LOCATED WITHIN THE LIMITS OF THE
CITY OF WICHITA, KANSAS

This is an application for a Community Unit Plan - Planned Development. The form must be completed and filed at the Planning Department, Room 402, City Building Annex, 104 South Main, Wichita, Kansas, in accordance with directions on the accompanying instruction sheet. AN INCOMPLETE APPLICATION CANNOT BE ACCEPTED.

R-Mart amended
File #1

I. Name of applicant or applicants and/or their agent or agents.

a. Applicant East Wichita Partners & Waldorf Assoc. Att-John D. Martin

Address P.O. Box 27416, Houston, Tx. 77027 Phone 713-621-0700

Agent Baughman Company, P.A. Att. William L. Korber

Address 330 Laura, Wichita, Ks 67211 Phone 262-7271

b. Applicant _____

Address _____ Phone _____

Agent _____

Address _____ Phone _____

c. Applicant _____

Address _____ Phone _____

Agent _____

Address _____ Phone _____

(Use separate sheet if necessary for names of additional applicants)

II.A The applicant hereby requests Community Unit Plan approval on property zoned L.C. and legally described as Lot(s)

_____, Block(s) 1

Check → Widemann Addition.

Wiedemann (If appropriate, metes and bounds description may be provided in the space below or on an attached sheet.)

N AA
S LCC
E IC (RTA)
W AA & LC

II.B There are 14.9 acres (round to nearest tenth) in the above described property.

III. This property is located at (address) 8600 E. Kellogg.

The general location is (use appropriate section)

a. at the _____ corner of _____

and _____; or

b. on the north side of Kellogg (Ave.,

Street) between Webb (Ave., Street) and

Bonnie Brae (Ave., Street).

IV. I (we), the applicant(s), acknowledge receipt of the instruction sheet explaining the method of submitting this application. I (we) realize that this application cannot be processed unless it is completely filled in and accompanied by a current abstractor's certificate as required in the instruction sheet.

William L. Korber

By William L. Korber
Authorized Agent (if any)

By _____
Authorized Agent (if any)

By _____
Authorized Agent (if any)

By _____
Authorized Agent (if any)

V. OFFICE USE ONLY

This application was received at the Planning Department at

130 (AM, PM) on April 28, 1981 (Day, Month,

Year). It has been checked and found to be complete and accom-

panied by required documents and the appropriate fee of

\$ 200.

Arthur J. [Signature] Name
City Planner Title

STATEMENT OF OWNERSHIP

STATE OF KANSAS)
) SS
 SEDGWICK COUNTY)

The undersigned duly bonded and qualified abstractor within and for the County and State aforesaid, does hereby certify:

That we have examined the records in the office of the Register of Deeds of Sedgwick County, Kansas, with reference to the ownership of the following property in Sedgwick County, Kansas viz:

Record Owners within 1000 feet of:
 Lot 1, WIEDEMAN ADDITION, Sedgwick County, Kansas.



And from such examination find that the owners thereof are as set opposite the description of the property below, viz: (Addresses as given are furnished as a service and not certified.)

<u>DESCRIPTIONS</u>	<u>ADDITION</u>	<u>NAME</u>
Beginning at the Southeast Corner of Lot 1; thence Northeasterly 549.21 feet; thence Northerly 72.59 feet; thence West 321.92 feet; thence South 602.5 feet; thence East 177.23 feet to the point of beginning,	WIEDEMAN	Kelway Inc. ✓ 1007 East 2nd Wichita, Kansas 67214
Lot 1, except beginning at the Southeast Corner; thence Northeasterly 549.21 feet; thence Northerly 72.59 feet; thence West 321.92 feet; thence South 602.5 feet; thence East 177.23 feet to beginning,	WIEDEMAN	East Wichita Partners ✓ %G. Craig Lord Four Penn Center Plaza Philadelphia, PA 19103



<u>DESCRIPTIONS</u>	<u>ADDITION</u>	<u>NAME</u>
Lot 5, Block 7,	BONNIE BRAE	Clark V. & Regina J. Britton ✓ 8307 Peach Tree Lane Wichita, Kansas 67207
Lot 6, Block 7,	BONNIE BRAE	E. S. & Phyllis Breckill ✓ 8315 Peach Tree Lane Wichita, Kansas 67207
Lot 7, Block 7, <i>X</i>	BONNIE BRAE	Charles B. & Hazel G. Myers <i>Resent to R.R. #6 Highway</i> <i>Ret. wooden add.</i> ✓ 8321 Peach Tree Lane Wichita, Kansas 67207
Lot 8, Block 7,	BONNIE BRAE	Paul L. & Dorothy Cook ✓ 405 Bonnie Brae Street Wichita, Kansas 67207
Lot 1, Block 8,	BONNIE BRAE	Union National Bank, Trustee for Cy L. Finley and Jane P. Finley ✓ 420 East Bonnie Brae St. Wichita, Kansas 67207
Lot 2, Block 8,	BONNIE BRAE	Steve M. & Ronda S. Longan ✓ 8407 Peach Tree Lane Wichita, Kansas 67207
Lot 3, Block 8,	BONNIE BRAE	Douglas J. & Carolyn S. Moshier ✓ 8415 Peach Tree Lane Wichita, Kansas 67207
Lot 4, Block 8,	BONNIE BRAE	Doyle E. & Jeanne S. Meade ✓ 8421 Peach Tree Lane Wichita, Kansas 67207
Lot 1, Block 9,	BONNIE BRAE	John E. & Janice A. Havel ✓ 302 Bonnie Brae Street Wichita, Kansas 67207
Lot 2, Block 9,	BONNIE BRAE	Nolan H. & Sylvia L. Jackson ✓ 308 Bonnie Brae Street Wichita, Kansas 67207
Lot 3, Block 9,	BONNIE BRAE	Marvin Edward & Mildred Mae Elliott ✓ 8404 Peach Tree Lane Wichita, Kansas 67207
Lot 4, Block 9,	BONNIE BRAE	Leo J. & Carolyn K. Johnson ✓ 8418 Peach Tree Lane Wichita, Kansas 67207



<u>DESCRIPTIONS</u>	<u>ADDITION</u>	<u>NAME</u>
Lot 5, Block 9,	BONNIE BRAE	Charles & Emma Jean Evenson ✓ 315 South West Parkway Wichita, Kansas 67207
Lot 6, Block 9,	BONNIE BRAE	Leonard R. & Kathleen Dennis ✓ 307 South West Parkway Wichita, Kansas 67207
Lot 7, Block 9,	BONNIE BRAE	Howard G. & Virginia Leikvold ✓ 8417 Willowbrook Wichita, Kansas 67207
Lot 8, Block 10,	BONNIE BRAE	Lavis P. & Lois M. Latimer ✓ 8308 Peach Tree Lane Wichita, Kansas 67207
Lot 9, Block 10,	BONNIE BRAE	Alma E. Hass ✓ 8314 Peach Tree Lane Wichita, Kansas 67207
Lot 10, Block 10,	BONNIE BRAE	Kenneth G. & Betty L. Fuson ✓ 8320 Peach Tree Lane Wichita, Kansas 67207
Lot 11, Block 10,	BONNIE BRAE	Raymond H. & Susan Rutherford ✓ 8326 Peach Tree Lane Wichita, Kansas 67207
Lot 12, Block 10,	BONNIE BRAE	Donald F. & Mary J. Scherer ✓ 8327 Willowbrook Road Wichita, Kansas 67207
Lot 13, Block 10,	BONNIE BRAE	Howard A. & Vera V. McFarland ✓ 8321 Willowbrook Road Wichita, Kansas 67207
Lot 14, Block 10,	BONNIE BRAE	H. Lindley & Margaret C. Cox ✓ 8315 Willowbrook Road Wichita, Kansas 67207
Lot 15, Block 10,	BONNIE BRAE	Max J. & Jacqueline M. Herzel ✓ 8307 Willowbrook Road Wichita, Kansas 67207
Lot 8, Block 12,	BONNIE BRAE	Laurence & Velma Thomason ✓ 245 Lochinvar Drive Wichita, Kansas 67207



*Resent RR 26 Haywards
Ret. - no order and - 6760*

<u>DESCRIPTIONS</u>	<u>ADDITION</u>	<u>NAME</u>
Lot 9, Block 12,	BONNIE BRAE	George B. & Doris Wills ✓ 239 Lochinvar Drive Wichita, Kansas 67207
Lot 7, Block 13,	BONNIE BRAE	Thomas R. & Margaret ✓ Shockey 238 Lochinvar Drive Wichita, Kansas 67207
Lot 8, Block 13,	BONNIE BRAE	Howard R. & Maxine ✓ Tuttle 244 Lochinvar Drive Wichita, Kansas 67207
Lot 9, Block 13,	BONNIE BRAE	A. W. & Kathryn J. ✓ Walker 250 Lochinvar Drive Wichita, Kansas 67207
Lot 10, Block 13,	BONNIE BRAE	Robert C. & Rita L. ✓ Schoepel 256 Lochinvar Drive Wichita, Kansas 67207
Lot 11, Block 13,	BONNIE BRAE	David W. & Catherine H. ✓ Boyles 263 Bonnie Brae Street Wichita, Kansas 67207
Lot 12, Block 13,	BONNIE BRAE	Larry G. & Doris E. Bell ✓ 257 Bonnie Brae Street Wichita, Kansas 67207
Lot 13, Block 13,	BONNIE BRAE	Richard A. & Marcille ✓ Wohlgenuth 251 Bonnie Brae Street Wichita, Kansas 67207
Lot 14, Block 13,	BONNIE BRAE	Robert C. & Marjorie M. ✓ Faris 245 Bonnie Brae Street Wichita, Kansas 67207
Lot 15, Block 13,	BONNIE BRAE	William R. & Doris Jean ✓ Futo 239 Bonnie Brae Street Wichita, Kansas 67207
Lot 16, Block 15,	BONNIE BRAE	Albert L. & Marguerite E. ✓ Gosman 244 Bonnie Brae Street Wichita, Kansas 67207
Lot 17, Block 15,	BONNIE BRAE	Dale E. & Dorothy A. ✓ Schoenlefer 250 Bonnie Brae Street Wichita, Kansas 67207



<u>DESCRIPTIONS</u>	<u>ADDITION</u>	<u>NAME</u>
Lot 18, Block 15,	BONNIE BRAE	Norman G. & Betty J. Neugebauer ✓ 256 Bonnie Brae Street Wichita, Kansas 67207
Lot 19, Block 15,	BONNIE BRAE	Rick & Cynthia Hill ✓ 262 Bonnie Brae Street Wichita, Kansas 67207
Lot 20, Block 15,	BONNIE BRAE	Leslie Ralph & Carrie Gilstrap ✓ 268 Bonnie Brae Street Wichita, Kansas 67207
Lot 21, Block 15,	BONNIE BRAE	Doyle C. & Naida M. Haberly ✓ 8416 Willowbrook Road Wichita, Kansas 67207
Lot 1,	DRY	J. R. & Verda S. Dry and J. R. Dry, Jr. X ADDRESS UNKNOWN
Lots 1 and 2,	WEAVER-REIMOLD	Executive Inn Inv. ✓ 8401 East Kellogg Wichita, Kansas 67207
Lot 1, Block 1,	LANKIN	Arthur Lankin D 953 South Greenwich Wichita, Kansas 67207
Lot 1, Block 1,	LANKIN 2ND	Arthur & Kathleen Lankin D 953 South Greenwich Wichita, Kansas 67207
Lot 1,	EAST TURNPIKE ENTRANCE	Seldin Development & Management Co. ✓ 13057 West Center Road Omaha, Nebraska 68144
Lots 1, 2 and 3,	EAST TURNPIKE ENTRANCE 2ND	University Mall Inc. Resident Agent ✓ Wm. P. Higgins 209 East William Wichita, Kansas 67202
Lot 1,	RUTH	United Life & Accident Ins. Co. ✓ 2 White Street Concord, N. Hampshire 03301
All of Lot 2, except the East 174.4 feet; and except the North 100 feet,	RUTH	Texaco, Inc. ✓ 1515 West 22nd Street Oak Brook, Illinois 60521



<u>DESCRIPTIONS</u>	<u>ADDITION</u>	<u>NAME</u>
Beginning 174.4 feet West and 150 feet North of the Southeast Corner of Lot 2, for a point of beginning; thence West to East line of Bonnie Brae Street, thence Northeasterly along the East line of Bonnie Brae Street to the Northwest Corner of Lot 2; thence East to a point which is 155.4 feet West of the Northeast Corner of said Lot; thence South 92 feet; thence West to point of beginning,	RUTH	C. L. & Jane Finley ✓ James N. Sample 420 East Bonnie Brae St. Wichita, Kansas 67207
The North 100 feet of Lot 3, except the West 155 feet,	RUTH	Donald R. Dreiske Arthur H. Bailey ✓ 8300 East Kellogg Wichita, Kansas 67207
Lot 3, except the West 155 feet and except the North 100 feet,	RUTH	✓ Gary K. Edminster 8330 East Kellogg Wichita, Kansas 67207
The West 155 feet of the North 100 feet of Lot 3,	RUTH	✓ Pacific Motels % Arthur H. Bailey, et al 8300 East Kellogg Wichita, Kansas 67207
Lot 2,	FNIC	✓ First National Bank Main & Douglas Wichita, Kansas 67202
Lots 1 and 2,	R.V.C.	✓ Residence Venture Corp. J. P. DeBoer-President 240 North Rock Road, Suite 200 Wichita, Kansas 67206
Lot One (1), except beginning on the West line of said Lot 1 at a point 430.43 feet North of the Southwest Corner of said Lot; thence North 0° 10' 04" West on said West line a distance of 300 feet to a corner in said West line; thence North 73° 19' 49" East on the Westerly line of said Lot 1 a distance of 125.63 feet to a corner in said Westerly line; thence North 65° 21' 40" East on the Westerly line of said Lot 1 a distance of 32.62 feet; thence South 23° 05' 55" West a distance of 380.11 feet to the point of beginning, and Cont'd on next page	PHI	X City of Wichita 455 North Main Wichita, Kansas 67202



DESCRIPTIONS

ADDITION

NAME

except beginning at the Northwest Corner of said Lot 1; thence South 0° 09' 01" East on the West line of said Lot 1 a distance of 389.26 feet to a corner in said West line of said Lot; thence North 65° 21' 40" East a distance of 109.88 feet; thence North 0° 09' 01" West a distance of 343.48 feet, more or less, to the North line of said Lot 1; thence South 89° 58' 59" West on said North line a distance of 100 feet to the point of beginning,

PHI

X City of Wichita
455 North Main
Wichita, Kansas 67202

Southeast Quarter except the Northwest Quarter and except the South half of the South half and except the West 23 Acres of the Northeast Quarter and except beginning on the North line of Lot 1, Wiedemann Addition, 120 feet East of the West line of the Southeast Quarter; thence North 6 feet; thence East 906 feet; thence South 6 feet; thence West 906 feet to beginning, Section 20, Township 27 South, Range 2 East,

✓ Mary M. Maxwell
2381 Algonquin Road
Schenectady, New York
12309

Block 2, except beginning at the Northwest Corner; thence Southwesterly 75 feet; thence Easterly to a point 120 feet South of the Northeast Corner; thence North to Northeast Corner; thence West 151.66 feet to beginning,

SUNNY-BROOK

✓ William A. Hays
John W. Hill
Russell C. Knotts
% H & K Food Corp.
2575 Ferris Road
Columbus, Ohio 43224

Beginning at the Northwest Corner of Block 2; thence Southwest 75 feet; thence Easterly to a point 120 feet South of the Northeast Corner of Block 2; thence North 120 feet; thence West to beginning,

SUNNY-BROOK

✓ Socony Mobil Oil Co.
P.O. Box 900
Dallas, Texas 78421



DESCRIPTIONS

ADDITION

NAME

Beginning 147 feet North-
westerly of the South-
east Corner of Block 18,
thence Northeast 101.51
feet; thence East 87 feet;
thence North 222 feet;
thence West 75 feet; thence
Southwest 108.11 feet;
thence Southwest to the
Southwest Corner, Block 18;
thence Southeast to
beginning, except
Townhouse Units B-1, B-2,
C-1 and C-2,

BONNIE BRAE

Cloister Homeowners Assn.
%Spines Real Estate Dev.
✓ 525 Fourth Financial
Center
Wichita, Kansas 67202

A tract of land located
in Block 18, being more
particularly described
as follows: Beginning at
the Southerly corner of
said Block 18, on the
Southwesterly line of said
Block 18, with an assumed
bearing of North 55° 59' 34"
West, a distance of 147.00
feet; thence North 19° 46'
15" East, a distance of
101.51 feet; thence North
89° 49' 56" East, a distance
of 87.00 feet; thence South
0° 10' 04" East, a distance
of 178.00 feet to the point
of beginning, except those
portions of said tract on
which residences A-1 and A-2
are herein described,

BONNIE BRAE

✓ Cloister Homeowners Assn.
%Spines Real Estate Dev.
525 Fourth Financial
Center
Wichita, Kansas 67202



Townhouse Unit A-2 in
"The Cloister", a Townhouse
Development,

Bill B. & Wanda M.
Spencer
✓ 8631 Killarney Place
Wichita, Kansas 67206

Townhouse Unit A-1 in
"The Cloister", a Townhouse
Development,

H. James & Betty B.
Menehan
✓ 1038 Lawrence Court
Wichita, Kansas 67206

The South 198 feet of the
North 850.34 feet of the
West half of the East 20
Acres of the Northwest
Quarter of Section 29,
Township 27 South, Range
2 East,

Executive Inn Inc.
✓ Property Address:
8401 East Orme
Wichita, Kansas 67207
✓ P.O. Box 1598
Topeka, Kansas 66601

Lots 1, 2, 3 and 4,
except the South 186
feet of Lot 4, Block
1,

REPLAT OF BLOCK 1,
SUNNY-BROOK

William Levitt
(Lease) General Real
Estate Shares
✓ 3150 Republic Boulevard
Toledo, Ohio 43615
Property Address:
8401 E. Kellogg
Wichita, Kansas
67207



<u>DESCRIPTIONS</u>	<u>ADDITION</u>	<u>NAME</u>
Beginning 652.34 feet South of the Northeast Corner of the Northwest Quarter; thence South 198 feet; thence West 165 feet; thence North 198 feet; thence East to beginning in the Northwest Quarter in Section 29, Township 27 South, Range 2 East.		Executive Inn Inc. Property Address: 8401 East Orme ^{E KELLOGG} Wichita, Kansas 67207 P.O. Box 1598 Topeka, Kansas 66601
Lot 1 and the North 3 feet of Lot 2, Block 3,	SUNNYBROOK	Charles W. & Darlene F. Melton 535 Eastern Avenue Wichita, Kansas 67207
Lot 2 except the North 3 feet, Block 3,	SUNNYBROOK	Donald W. & Naine Cullom 341 Eastern Avenue Wichita, Kansas 67207
Lots 3 and 5, Block 3,	SUNNYBROOK	Administrator of Veterans Affairs 901 George Washington Drive Wichita, Kansas 67211
Lot 4, Block 3,	SUNNYBROOK	Doris L. Miller 8328 East Orme Wichita, Kansas 67207
East 64 feet of Lot 6, Block 3,	SUNNYBROOK	Frank Manning and Audie Cupp ADDRESS UNKNOWN
Lot 4, Block 4,	SUNNYBROOK	Betty Lou Partridge 8327 East Orme Wichita, Kansas 67207
Lot 5, Block 4,	SUNNYBROOK	George E. Rathbun 8333 East Orme Wichita, Kansas 67207
Lot 6, Block 4,	SUNNYBROOK	James B. & Avis E. Craig 8339 East Orme Wichita, Kansas 67207
Lot 1,	MANSON-CUMMINGS	Arthur W. Viner and Thomas G. Davis, Jr., Trustees of Third I.C.M. Realty ADDRESS UNKNOWN



-10-

Dated at Wichita, Kansas, this 1st day of April, 1981 at
7:00 A.M.

FIDELITY TITLE COMPANY, INC.

By

C. E. Bud Keddler
Vice President

Tracer No. 54488



Fidelity  **Title**
COMPANY, INC.

FORM 20 71

PAYMENT NOTICE
City of Wichita

Bldg.	Use of Str.	Code Bks	Copies
Elec	Elev. Insp.	Has Moving	Lic.
Mech	Boiler Insp.	Pav. Cuts	Cert.
Plbg	Exam Fees	Sewer	Elev.
Signs	Plan Rev. (P.W.)	Cement	M.S.P.
	Planning		

DESCRIPTION AMOUNT

NAME

ADDRESS

FUND DUE DATE

COMMENTS

DATE BY

*

This DP File
Has a Large Drawing
On 35mm Microfilm.

Roll #1

*