

RECOMMENDATION FROM METROPOLITAN AREA PLANNING COMMISSION TO
BOARD OF CITY COMMISSIONERS

REQUEST FOR VACATION

CASE NO. V- 1191

CONSIDERED BY:

SUBDIVISION COMMITTEE: 5-26-83

PLANNING COMMISSION: 6-2-83

REQUEST FOR VACATION OF: portion of platted setback

LOCATION: southwest corner of Parkridge and Mark Allen

LEGALLY DESCRIBED AS:

The west ten feet of the platted 25-foot building setback from Parkridge on Lot 1, Block 16, Westlink Nineteenth Addition, Wichita, Sedgwick County, Kansas.

REASON FOR REQUEST: need for additional space to accomodate a new house

NAME OF APPLICANT: Thurman W. Smith

REPRESENTATIVE FOR APPLICANT: Gary Wiley
Professional Engineering Consultants
1440 E. English, 67211

PROTESTORS, IF ANY: None

PLANNING COMMISSION RECOMMENDATION:

Approve the vacation subject to all proceedings being without cost to the City, County, or any utility company.

Gardner moved, Goebel seconded and it carried unanimously.
One vacancy.

ATTACHMENTS: Ordinance Approved as to form by the Department of Law

ACTION: Approve the request as recommended by the Metropolitan Area Planning Commission and place the Ordinance on its first reading.

(97457) (Published in The Daily Record June 24, 1983)

ORDINANCE NO. 38-374

AN ORDINANCE VACATING A PORTION OF THE PLATTED BUILDING SETBACK FROM PARKRIDGE ON LOT 1, BLOCK 16, WESTLINK NINETEENTH ADDITION, WICHITA, SEDGWICK COUNTY, KANSAS.

BE IT ORDAINED BY THE GOVERNING BODY OF THE CITY OF WICHITA, KANSAS:

SECTION 1. That the building setback described as follows to-wit:

The west ten feet of the platted 25-foot building setback from Parkridge on Lot 1, Block 16, Westlink Nineteenth Addition, Wichita, Sedgwick County, Kansas (MAPC NO. V-1191);

be and the same is hereby vacated in accordance with K.S.A. 13-443, subject, however, to the concurrence in such vacation by the Board of County Commissioners as by law provided.

SECTION 2. That it is hereby recommended to the Board of County Commissioners of Sedgwick County, Kansas, that said above described building setback be vacated by said Board in case a proper petition is filed under the provisions of K.S.A. 12-504, 12-505 and K.S.A. 12-506.

SECTION 3. That this Ordinance shall be in force and take effect from and after its passage and publication once in the official city paper.

PASSED AND APPROVED at Wichita, Kansas this 21ST day of June, 1983.

ATTEST:

Margalee Wright, Mayor

Donald C. Gisick, City Clerk

(SEAL)

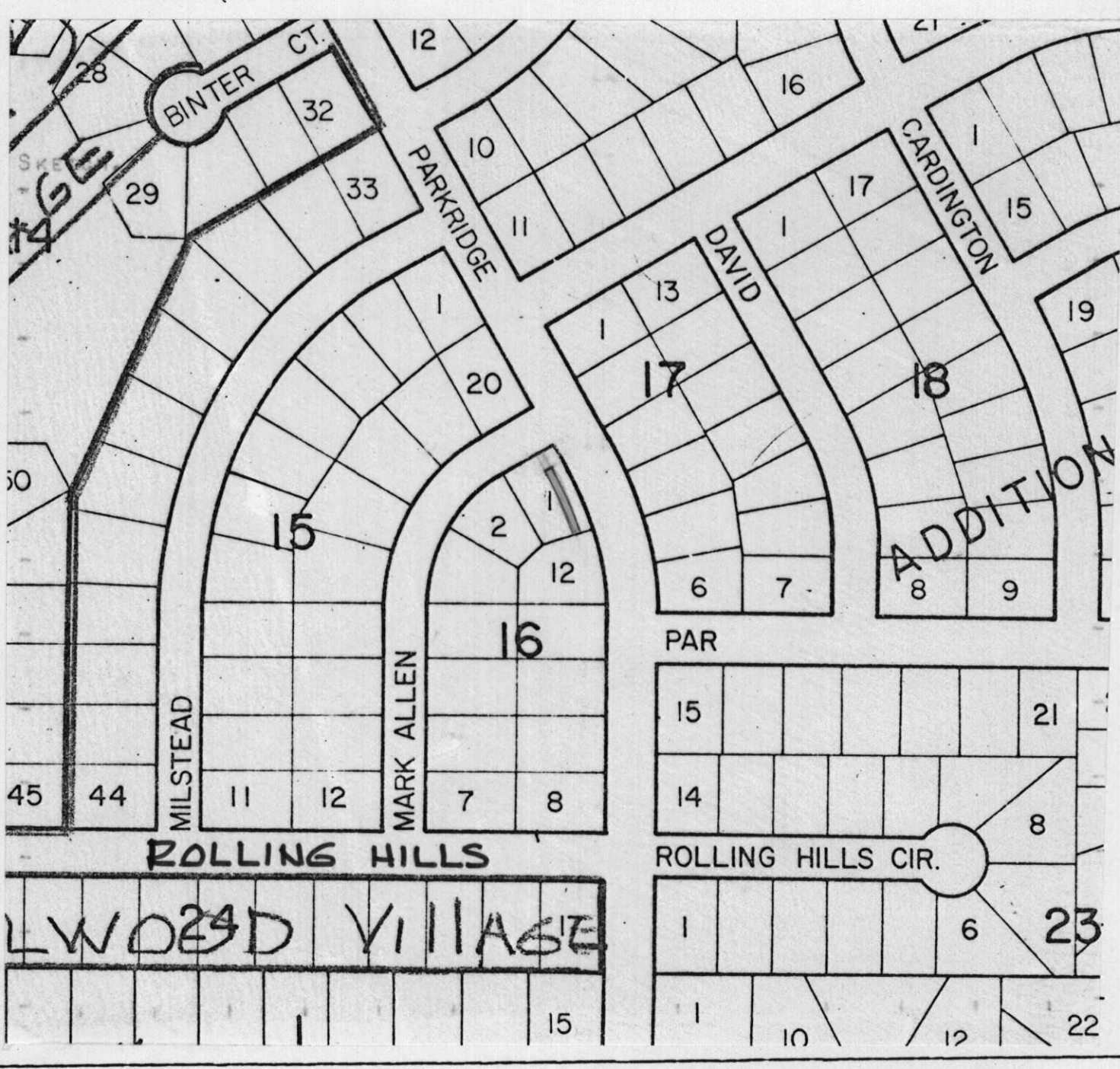

BINTER CT.

SKE
GE

28
29

MILSTEAD

MARK ALLEN

ROLLING HILLS

LW 23D VILLAGE

PARKRIDGE

DAVID

CARDINGTON

ADDITION

PAR

ROLLING HILLS CIR.

50

45

44

11

12

7

8

15

21

14

8

1

6

23

1

10

12

22

12

32

33

10

11

16

17

15

1

2

12

1

2

12

17

13

18

19

15

16

6

7

8

9

15