

City of Wichita  
City Council Meeting  
September 13, 1988

Agenda Report # \_\_\_\_\_

TO: Mayor and City Council Members

SUBJECT: Public Hearing V-1553 - REQUEST TO VACATE THE PLATTED MINIMUM BUILDING PAD ELEVATION ON SEVERAL LOTS LOCATED IN AN AREA WEST OF NANTUCKET AND NORTH OF 13TH STREET NORTH (District #5).

INITIATED BY: Metropolitan Area Planning Department

AGENDA ACTION: Planning

-----  
Staff Recommendation: Approve plat. *Vacation*

MAPC Recommendation: Approve plat. (unanimous)

Background: This vacation case has been requested in order to reduce the platted minimum building pad elevation on several lots by 2 feet. This reduction is supported by the City Engineer and is in agreement with the flood management ordinance. The Vacation Order retains a new pad elevation of .339 mean sea level. The vacation request has been reviewed and approved by the Planning Commission, subject to conditions.

Legal Considerations: The City Clerk needs to certify as to proper notification and no filing of written protest.

Recommendations/Action: Close public hearing; approve vacation; authorize the Mayor to sign the Vacation Order; and record certified copy of Order, recording costs to be billed to:

755-68-360-50000-295-000-000.

BEFORE THE CITY COUNCIL OF THE CITY OF WICHITA, SEDGWICK COUNTY, KANSAS

IN THE MATTER OF THE VACATION OF A PLATTED MINIMUM BUILDING PAD ELEVATION. GENERALLY LOCATED WEST OF NANTUCKET AND NORTH OF 13TH STREET NORTH (V-1553). MORE FULLY DESCRIBED BELOW

Approved / Accepted By City Council This SEP 13 1988

MICROFILMED OF RECORD

STATE OF KANSAS ) SS SEDGWICK COUNTY ) FILED FOR RECORD AT 8:00 AM

Oct 3 88 0972663

VACATION ORDER

PAT [unclear]

Ed Rea Deputy

NOW on this 13th day of September, 1988, comes on for hearing the petition for vacation filed by J. F. Careswell, et. al., praying for the vacation of the following described platted minimum building pad elevation, to-wit:

The platted minimum building pad elevation of 1341 mean sea level on Lots 12, 13, 15, 16, 17, 18 and 19, Block A, Cedar Park Chateaux, Sedgwick County, Kansas.

The City Council, after being duly and fully informed as to fully understand the true nature of this petition and the propriety of granting the same, makes the following findings:

- 1. That due and legal notice has been given by publication as required by law, by publication in the Daily Record of notice of this vacation proceeding for consecutive weeks on AUG 31 1988 SEP 7 1988
2. No private rights will be injured or endangered by the vacation of the above-described platted minimum building pad elevation, and the public will suffer no loss or inconvenience thereby.
3. In justice to the petitioner(s), the prayer of the petition ought to be granted.
4. No written objection to said vacation has been filed with the City Clerk by any owner or adjoining owner who would be a proper party to the petition.
5. A minimum building pad elevation of 1,339 mean sea level is hereby retained.
6. The vacation of the platted minimum building pad elevation described herein should be approved.

IT IS, THEREFORE, BY THE CITY COUNCIL, on this 13th day of September, 1988, ordered that the above-described platted minimum building pad elevation is hereby vacated. IT IS FURTHER ORDERED that the City Clerk shall certify a copy of this order to the Register of Deeds of Sedgwick County

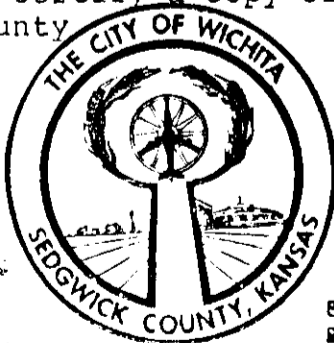

Skeets L. Winkler VICE MAYOR

ATTEST THE CITY OF WICHITA Dale E. Rea, Deputy City Clerk

State of Kansas ) Sedgwick County ) ss I, Dale E. Rea, Deputy City Clerk of the City of Wichita, Kansas, hereby certify that the document to which this is affixed is a true and correct copy of the original on file in the office the the City Clerk. Given under my hand and seal of the City of Wichita this SEP 19 1988 Dale E. Rea Deputy City Clerk

Approved as to Form: Thomas Powell, Director of Law

City Clerk

5.00

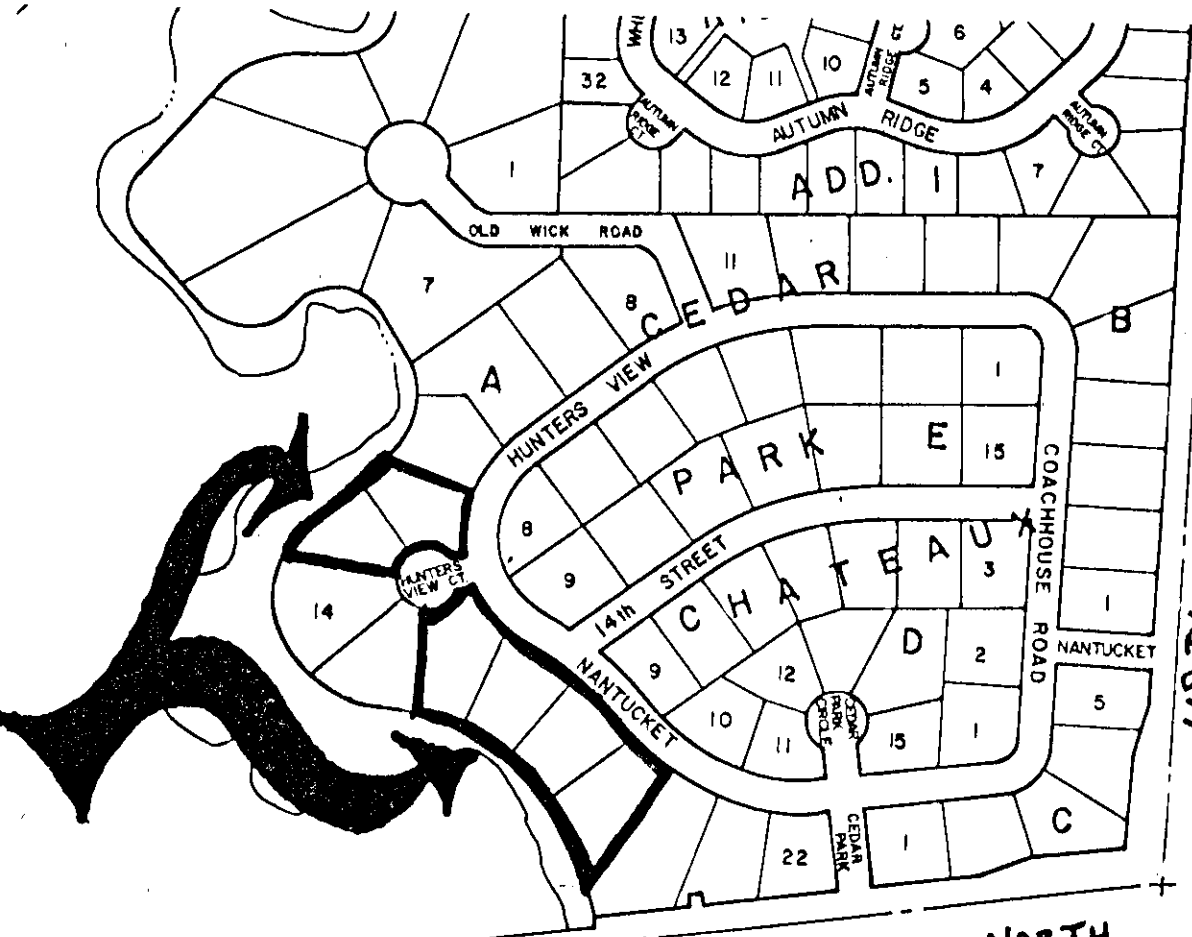

15W 1937LS R2 611

13TH STREET NORTH