

City of Wichita
City Council Meeting
July 19, 1988

Agenda Report # _____

TO: Mayor and City Council Members

SUBJECT: V-1544 - REQUEST TO VACATE A PLATTED DRAINAGE EASEMENT,
LOCATED ON THE EAST SIDE OF LINDEN, IN AN AREA NORTH
OF CENTRAL. (District #2)

INITIATED BY: Metropolitan Area Planning Department

AGENDA ACTION: Planning

Staff Recommendation: Approve vacation of drainage easement.

MAPC Recommendation: Approve vacation of drainage easement. (unanimous)

Background: The applicant is the owner of both lots involved in this vacation case and desires to build a dwelling unit across the common lot line. The City Engineer's Office has verified that the drainage easement is not needed for existing or future drainage improvements. The vacation request has been reviewed and approved by the Planning Commission, subject to conditions.

Legal Considerations: The City Clerk needs to certify as to proper notification and no filing of written protest.

Recommendations/Action: Close public hearing; approve vacation; authorize the Mayor to sign the Vacation Order; and record certified copy of Order, recording costs to be billed to:

755-68-360-50000-295-000-000

Approved / Accepted By City Council

JUL 19 1988

BEFORE THE CITY COUNCIL OF THE STATE OF KANSAS)
CITY OF WICHITA, SEDGWICK COUNTY, KANSAS) ss

FILED FOR RECORD AT
8:00 AM

IN THE MATTER OF THE VACATION OF A PLATTED)
DRAINAGE EASEMENT.)

GENERALLY LOCATED EAST OF LINDEN, IN AN)
AREA NORTH OF CENTRAL. (V-1544))

MORE FULLY DESCRIBED BELOW)

AUG 3 08 0961886

PAT KETTLER
REGISTER OF DEEDS

*Ed Reed
Deputy*

MICROFILMED
OF RECORD

VACATION ORDER

NOW on this 19th day of July, 1988, comes on for hearing the petition for vacation filed by Joseph P. Galichia, praying for the vacation of the following described platted drainage easement, to-wit:

The platted 20.00-foot drainage easement centered on the lot line common to Lots 2 and 3, Block 2, Woodland Estates, an addition to Wichita, Sedgwick County, Kansas. (V-1544)

The City Council, after being duly and fully informed as to fully understand the true nature of this petition and the propriety of granting the same, makes the following findings:

1. That due and legal notice has been given by publication as required by law, by publication in the Daily Record of notice of this vacation proceeding for consecutive weeks on JUL 6 1988 JUL 13 1988.
2. No private rights will be injured or endangered by the vacation of the above-described drainage easement, and the public will suffer no loss or inconvenience thereby.
3. In justice to the petitioner(s) the prayer of the petition ought to be granted.
4. No written objection to said vacation has been filed with the City Clerk by any owner or adjoining owner who would be a proper party to the petition.
5. The vacation of the drainage easement described herein should be approved.

IT IS, THEREFORE, BY THE CITY COUNCIL, on this 19th day of July, 1988, ordered that the above-described drainage easement is hereby vacated. IT IS FURTHER ORDERED that the City Clerk shall certify a copy of this order to the Register of Deeds of Sedgwick County.

ATTEST:

for Dale E. Rea
Dale E. Rea, Deputy City Clerk

Sheldon Kamen
Sheldon Kamen, Mayor

Approved as to Form:

Thomas Powell
Thomas Powell, Director of Law

State of Kansas)
Sedgwick County)
City of Wichita)
DALE E. REA, Deputy City Clerk of the City of Wichita, Kansas, hereby certifies that the document to which this is affixed is a true and correct copy of the original on file in the office of the City Clerk. Given under my hand and seal of the City of Wichita on AUG 1 1988.
Dale E. Rea
Deputy City Clerk

5.00 CA

PL/8764/5

city clerk

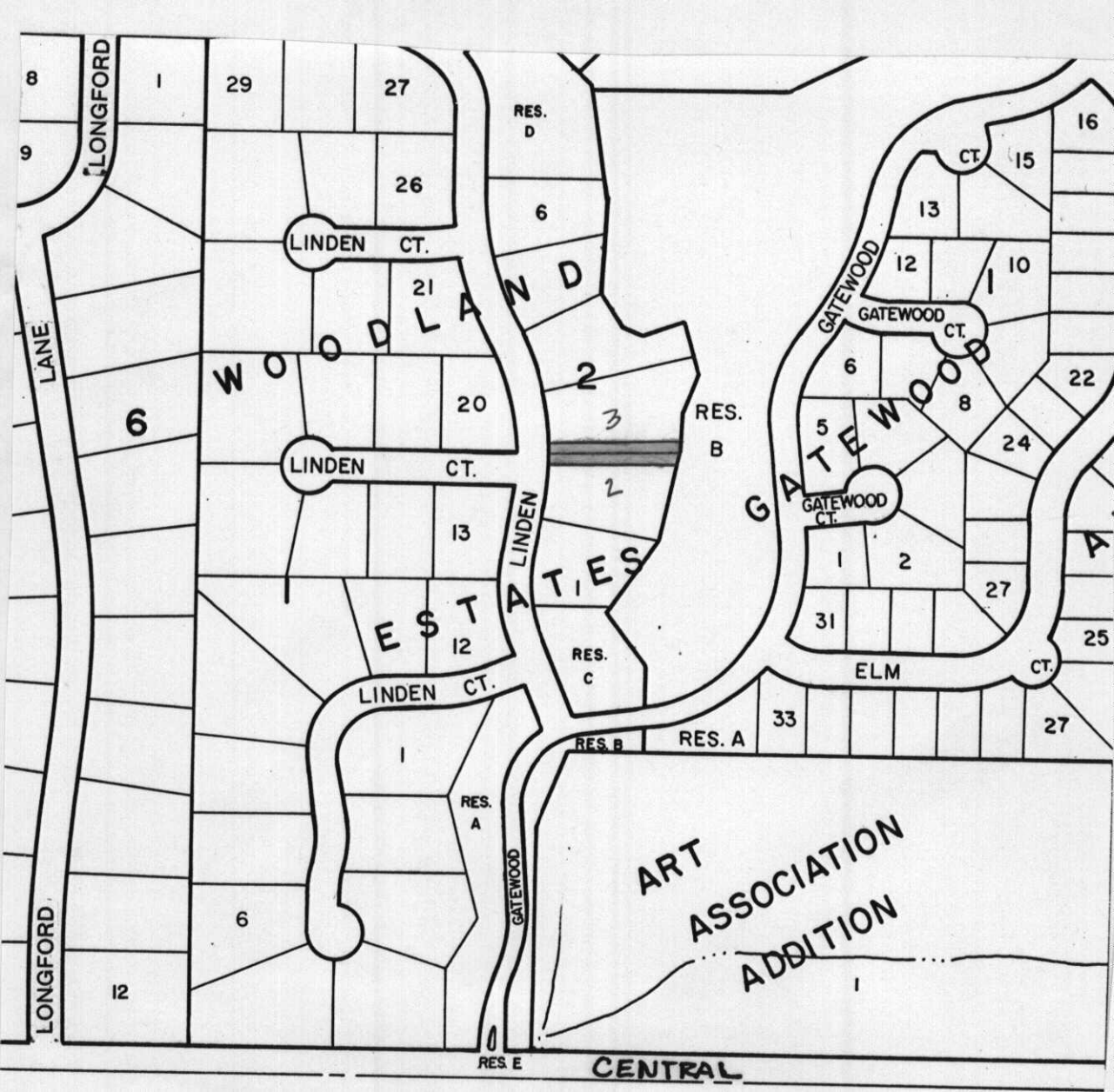

8

9

1

29

27

RES. D

26

6

LINDEN CT.

21

WOODLAND

20

2

3

RES. B

6

LINDEN CT.

2

13

GATEWOOD CT.

5

8

24

ESTATES

12

RES. C

GATEWOOD CT.

1

2

27

LINDEN CT.

31

ELM CT.

25

RES. B

RES. A

33

27

RES. A

ART ASSOCIATION ADDITION

LANE

LONGFORD

LONGFORD

LINDEN

GATEWOOD

RES. E

CENTRAL

12

6

16

CT.

15

13

12

10

GATEWOOD CT.

6

22

A

25

27

CT.

16

15

13

12

10

GATEWOOD CT.

6

22

A

25

27

CT.

16

15

13

12

10

GATEWOOD CT.

6

22

A

25

27

CT.