

City of Wichita  
City Council Meeting  
June 21, 1988

Agenda Report # \_\_\_\_\_

TO: Mayor and City Council Members

SUBJECT: PUBLIC HEARING V-1540 - REQUEST TO VACATE PORTIONS OF TWO  
PLATTED UTILITY EASEMENTS, LOCATED IN AN AREA NORTH OF  
21ST STREET NORTH AND WEST OF RIDGE ROAD. (District #5)

INITIATED BY: Metropolitan Area Planning Department

AGENDA ACTION: Planning

-----  
Staff Recommendation: Approve vacation of utility easements.

MAPC Recommendation: Approve vacation of utility easements. (unanimous)

Background: The owners of the subject lots desire to build dwelling units across the lot lines upon which the utility easements are centered. The City Engineer's Office and the Utility Advisory Committee has verified that the portions of the two easements requested for vacation are not needed for existing or future utility lines. The vacation request has been reviewed and approved by the Planning Commission, subject to conditions.

Legal Considerations: The City Clerk needs to certify as to proper notification and no filing of written protest.

Recommendations/Action: Close public hearing; approve vacation; authorize the Mayor to sign the Vacation Order; and record certified copy of Order, recording costs to be billed to:

755-68-360-50000-295-000-000

BEFORE THE CITY COUNCIL OF THE CITY OF WICHITA, SEDGWICK COUNTY, KANSAS

IN THE MATTER OF THE VACATION OF PORTIONS OF PLATTED UTILITY EASEMENTS.

) Approved / Accepted By City Council  
) This JUN 21 1988

GENERALLY LOCATED IN AN AREA NORTH OF 21ST STREET NORTH AND WEST OF RIDGE ROAD. (V-1540)

MORE FULLY DESCRIBED BELOW

MICROFILMED OF RECORD

STATE OF KANSAS } SS  
SEDGWICK COUNTY }  
FILED FOR RECORD AT  
8:00 AM

JUN 30 88 0955520

PAT KETTLER  
REGISTER OF DEEDS

VACATION ORDER  
*Ed Rea Deputy*

NOW on this 21st day of June, 1988, comes on for hearing the petition for vacation filed by Reflection Ridge, Inc., praying for the vacation of the following described portions of platted utility easements, to-wit:

The north 5 feet of Lot 7 and the south 5 feet of Lot 8, except the west 10 feet and the east 15 feet thereof; together with the south 5 feet of Lot 21 and the north 5 feet of Lot 22, except the west 15 feet and the east 10 feet thereof, all in Block 1, Reflection Ridge, an addition to Wichita, Sedgwick County, Kansas. (V-1540)

The City Council, after being duly and fully informed as to fully understand the true nature of this petition and the propriety of granting the same, makes the following findings:

1. That due and legal notice has been given by publication as required by law, by publication in the Daily Record of notice of this vacation proceeding for consecutive weeks on JUNE 8, 15, 1988.
2. No private rights will be injured or endangered by the vacation of the above-described utility easements, and the public will suffer no loss or inconvenience thereby.
3. In justice to the petitioner(s) the prayer of the petition ought to be granted.
4. No written objection to said vacation has been filed with the City Clerk by any owner or adjoining owner who would be a proper party to the petition.
5. The vacation of the utility easements described herein should be approved.

IT IS, THEREFORE, BY THE CITY COUNCIL, on this 21st day of June, 1988, ordered that the above-described utility easements are hereby vacated. IT IS FURTHER ORDERED that the City Clerk shall certify a copy of this order to the Register of Deeds of Sedgwick County.



ATTEST:

*Dale E. Rea*  
Dale E. Rea, Deputy City Clerk

*S. Kamen*  
Sheldon Kamen, Mayor

State of Kansas )  
Sedgwick County ) ss  
City of Wichita )  
I, DALE E. REA Deputy City Clerk of the City of Wichita, Kansas, hereby certify that the document to which this is affixed is a true and correct copy of the original on file in the office the the City Clerk. Given under my hand and seal of the City of Wichita, this JUN 28 1988  
*Dale E. Rea* Deputy City Clerk

Approved as to Form:  
*Thomas R. Powell by ggr*  
Thomas Powell, Director of Law

5.00 CA

city clerk

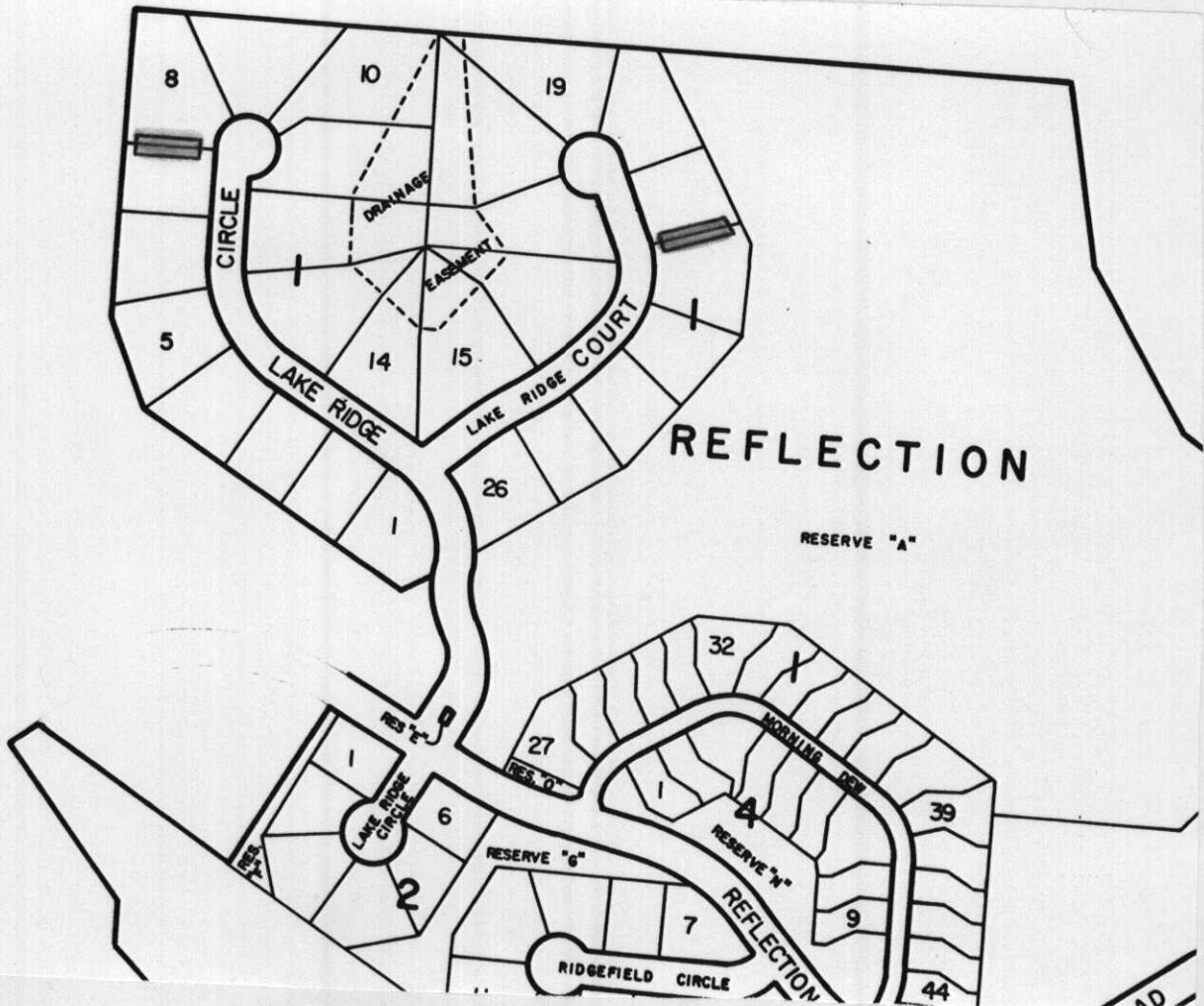

# REFLECTION

RESERVE "A"

CIRCLE

LAKE RIDGE

LAKE RIDGE COURT

DRAINAGE  
EASEMENT

LAKE RIDGE  
CIRCLE

RESERVE "6"

RESERVE "7"

RIDGEFIELD  
CIRCLE

MORNING  
DEW

REFLECTION