

WICHITA — SEDGWICK COUNTY

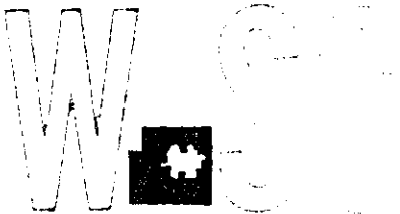

METROPOLITAN AREA PLANNING
DEPARTMENT

CITY HALL — TENTH FLOOR
455 NORTH MAIN STREET
WICHITA, KANSAS 67202-1688
(316) 268-4561

October 12, 1990

Bill Korber
Baughman Company
315 Ellis
Wichita, KS 67211

Re: V-1684 - Request to Vacate Utility Easement

Dear Bill:

At the October 11, 1990 meeting of the Metropolitan Area Planning Commission, the above-referenced vacation request was approved subject to the conditions recommended by the Subdivision Committee and stated in our October 5, 1990 letter. This case will be scheduled for final public hearing before the Wichita City Council after all conditions in our letter of October 5, 1990 have been completed.

If you have any questions about this matter, please call.

Sincerely,

A handwritten signature in cursive script that reads "Kandace A. Jones".

Kandace A. Jones
Associate Planner

cc: M.G. Enterprises Inc., 5215 W. Central, Wichita, 67212
Mike Lindebak, City Engineer

FILE COPY

WICHITA -- SEDGWICK COUNTY



METROPOLITAN AREA PLANNING
DEPARTMENT

CITY HALL -- TENTH FLOOR
455 NORTH MAIN STREET
WICHITA, KANSAS 67202-1688
(316) 268-4561

October 5, 1990

Bill Korber
Baughman Company
315 Ellis
Wichita, KS 67211

Re: V-1684 - Request to Vacate Utility Easement

Dear Bill:

At the regular meeting of the Subdivision Committee of the Metropolitan Area Planning Commission, Thursday, October 4, 1990, the above-captioned vacation request was considered. The action of the Committee was to recommend that this vacation be approved subject to:

- A. Any relocation of utilities necessitated by this vacation shall be at the sole expense of the applicant.
- B. The applicant is advised that the existing petition for a sanitary sewer relocation required with the Cherry Orchard 3rd Addition can be used to relocate and rebuild a manhole required by this vacation.
- C. Prior to this case being scheduled for City Council review the applicant shall make arrangements with Southwestern Bell Telephone for the relocation of its facilities within this easement. The applicant shall submit a letter, from Southwestern Bell, indicating that satisfactory arrangements have been made for this relocation.

This matter will be forwarded to the Planning Commission for its consideration on Thursday, October 11, 1990 at 1:30 p.m.

If you have any questions, please call.

Sincerely,

Kandace A. Jones

Kandace A. Jones
Associate Planner

cc: M.G. Enterprises Inc., 5215 W. Central, Wichita, 67212
Mike Lindebak, City Engineer

FILE COPY

October 11, 1990

STAFF REPORT

CASE NUMBER: V-1684 - REQUEST TO VACATE UTILITY EASEMENT

OWNER/APPLICANT: M.G. Enterprises, Inc., 5215 W. Central,
Wichita, KS 67212

AGENT: Baughman Co., 315 Ellis, Wichita, KS 67211

LEGAL DESCRIPTION: The 10 foot by 20 foot utility easement adjacent to the south line of Lot 1, Cherry Orchard 3rd Addition, Wichita, Kansas

LOCATION: South of Central, East of Hoover, between Elder and Doris

REASON FOR REQUEST: To construct a building

SITE SIZE: 10 x 20 = 200 sq. ft.

CURRENT ZONING: "LC" (Light Commercial)

VICINITY MAP:

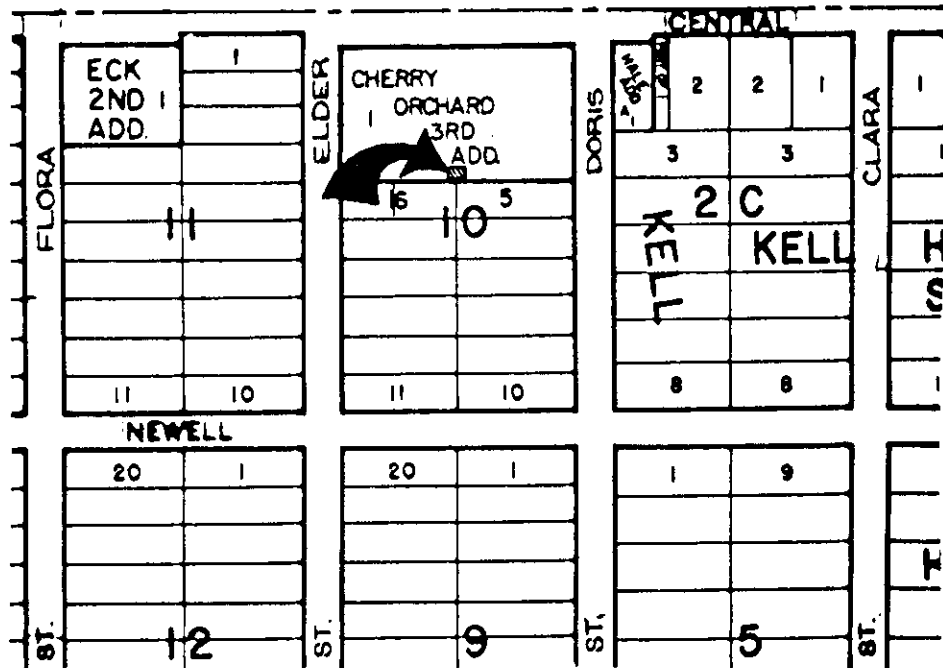

STAFF COMMENTS:

Approve the vacation, subject to the following conditions:

- A. Any relocation of utilities necessitated by this vacation shall be at the sole expense of the applicant.
- B. The applicant is advised that the existing petition for a sanitary sewer relocation required with the Cherry Orchard 3rd Addition can be used to relocate and rebuild a manhole required by this vacation.
- C. Prior to this case being scheduled for City Council review the applicant shall make arrangements with Southwestern Bell Telephone for the relocation of its facilities within this easement. The applicant shall submit a letter, from Southwestern Bell, indicating that satisfactory arrangements have been made for this relocation.