



FILE COPY

Wichita-Sedgwick County Metropolitan Area Planning Department

January 10, 2002

MKEC Engineering Consultants, Inc.
41 N Webb Road
Wichita KS 67206

RE: SUB 2001-128 MINNEHA ELEMENTARY SCHOOL ADDITION

At the regular meeting of the Metropolitan Area Planning Commission on January 10, 2002, the above captioned plat was considered. The action of the Planning Commission was to approve the plat as recommended by the Subdivision Committee subject to the conditions stated in our letter dated January 3, 2002:

In addition to complying with those conditions, it is necessary that you meet the following requirements before this plat can be forwarded to the City Council and/or County Commission for consideration:

1. Submission of the fully completed and signed tracing of the subdivision, along with four (4) copies, to the Metropolitan Area Planning Department.
2. Submission of a check, made out to the Register of Deeds, covering the costs of any documents to be recorded as a requirement of platting.
3. Subdivision Regulations now require a detailed Lot Grading Plan be submitted to Engineering prior to the tracing being released. This applies to all multi-lot, residential developments.
4. Submission of a disk to the Planning Department detailing the final plat in digital format in Autocad. This will be used by the City and County GIS Departments.

If you have any questions concerning this matter, please call.

A handwritten signature in cursive script that reads 'Neil Evan Strahl'.

Neil Evan Strahl, Senior Planner
Current Plans Division

NES:vyr

Enclosure: Marked Copy of Plat

Copies to: USD 259, Attn: Joe Hoover, 201 N Water, Wichita KS 67202
Minneha Township, Bob Shrum, 39 Via Roma, Wichita KS 67230
Mike Lindebak, City Engineering, Mail Stop (1-71)
Jim Weber, PE-Director, Sewer Operations & Maintenance Department, Bureau of Public Services, 1144 S. Seneca, Wichita, KS 67213



FILE COPY

Wichita-Sedgwick County Metropolitan Area Planning Department

January 4, 2002

MKEC ENGINEERING CONSULTANTS, INC.
41 N WEBB ROAD
WICHITA KS 67206

RE: SUB 2001-128 MINNEHA ELEMENTARY SCHOOL ADDITION

At the regular meeting of the Subdivision Committee of the Metropolitan Area Planning Commission on Thursday, January 3, the above captioned plat was considered. The action of the Committee was to approve the final plat, subject to the following:

STAFF COMMENTS:

- A. Municipal services are available to serve the site. City Engineering needs to comment on the need for guarantees or easements. No guarantees are required.
- B. If improvements are guaranteed by petition, a notarized certificate listing the petitions shall be submitted to the Planning Department for recording.
- C. City Engineering needs to comment on the status of the applicant's drainage plan. The drainage plan is approved.
- D. The plat proposes four access openings along Webb. Distances should be shown for all segments of access control. The access controls are approved.
- E. The applicant shall guarantee the closure of any driveway openings located in areas of complete access control or that exceed the number of allowed openings.
- F. The applicant shall submit an avigational easement covering all of the subject plat and a restrictive covenant assuring that adequate construction methods will be used to minimize the effects of noise pollution in the habitable structures constructed on subject property.
- G. The Applicant is reminded that a platting binder is required with the final plat. Approval of this plat will be subject to submittal of this binder and any relevant conditions found by such a review.
- H. The plat's text shall include language that a drainage plan has been developed for the plat and that all drainage easements, rights-of-way, or reserves shall remain at established

City Hall • 10th Floor • 455 North Main • Wichita, Kansas 67202-1688

T 316.268.4421 F 316.268.4390

www.wichitagov.org

SUB2001-128 MINNEHA ELEMENTARY SCHOOL ADDITION

January 4, 2002

Page 2

grades or as modified with the approval of the applicable City or County Engineer, and unobstructed to allow for the conveyance of stormwater.

- I. The applicant shall install or guarantee the installation of all utilities and facilities which are applicable and described in Article 8 of the MAPC Subdivision Regulations. (Water service and fire hydrants required by Article 8 for fire protection shall be as per the direction and approval of the Chief of the Fire Department.)
- J. The applicant's engineer is advised that the Register of Deeds is requiring the name(s) of the notary public, who acknowledges the signatures on this plat, to be printed beneath the notary's signature.
- K. To receive mail delivery without delay, and to avoid unnecessary expense, the applicant is advised of the necessity to meet with the U.S. Postal Service Growth Management Coordinator (Phone 316-946-4556) prior to development of the plat so that the type of delivery, and the tentative mailbox locations can be determined.
- L. The applicant is advised that various State and Federal requirements (specifically but not limited to the Army Corps of Engineers, Kanopolis Project Office, Rt. 1, Box 317, Valley Center, KS 67147) for the control of soil and wind erosion and the protection of wetlands may impact how this site can be developed. It is the applicant's responsibility to contact all appropriate agencies to determine any such requirements.
- M. The owner of the subdivision should be aware of the fact that the development of any subdivision greater than five (5) acres in size may require an NPDES Storm Water Discharge Permit from the Kansas Department of Health and Environment in Topeka. Further, on all construction sites, the City of Wichita requires that best management practices be used to reduce pollutant loadings in storm water runoffs.
- N. Perimeter closure computations shall be submitted with the final plat tracing.
- O. Recording of the plat within thirty (30) days after approval by the City Council and/or County Commission.
- P. The representatives from the utility companies should be prepared to comment on the need for any additional utility easements to be platted on this property.
- Q. The applicant is reminded that a disk shall be submitted with the final plat tracing to the Planning Department detailing this plat in digital format in AutoCAD. This will be used by the City and County GIS Department.

If this plat requires the guaranteeing of improvements, a list of the five methods which have been adopted as being acceptable is available through the Planning Department. Certificates, which are required if petitions are submitted, and forms for the bond and Irrevocable Letter of Credit are also available from this office.

This case will be forwarded to the Planning Commission on Thursday, January 10, 2002, at 1:30 p.m.

The enclosed "marked" copy of the plat is for your information and files.

STAFF REPORT
(One-Step Final Plat)

CASE NUMBER: SUB 2001-128 – MINNEHA ELEMENTARY SCHOOL ADDITION

OWNER/APPLICANT: USD 259, Attn: Joe Hoover, 201 N. Water, Wichita, KS 67202

SURVEYOR/ENGINEER: MKEC Engineering Consultants, Inc., 411 N. Webb Road, Wichita, KS 67206

LOCATION: West side of Webb, North of Central

SITE SIZE: 15 Acres

NUMBER OF LOTS

Residential:	1
Office:	
Commercial:	
Industrial:	
Total:	<u>1</u>

MINIMUM LOT AREA: 15 Acres

CURRENT ZONING: SF-5, Single-Family Residential

PROPOSED ZONING: Same

VICINITY MAP

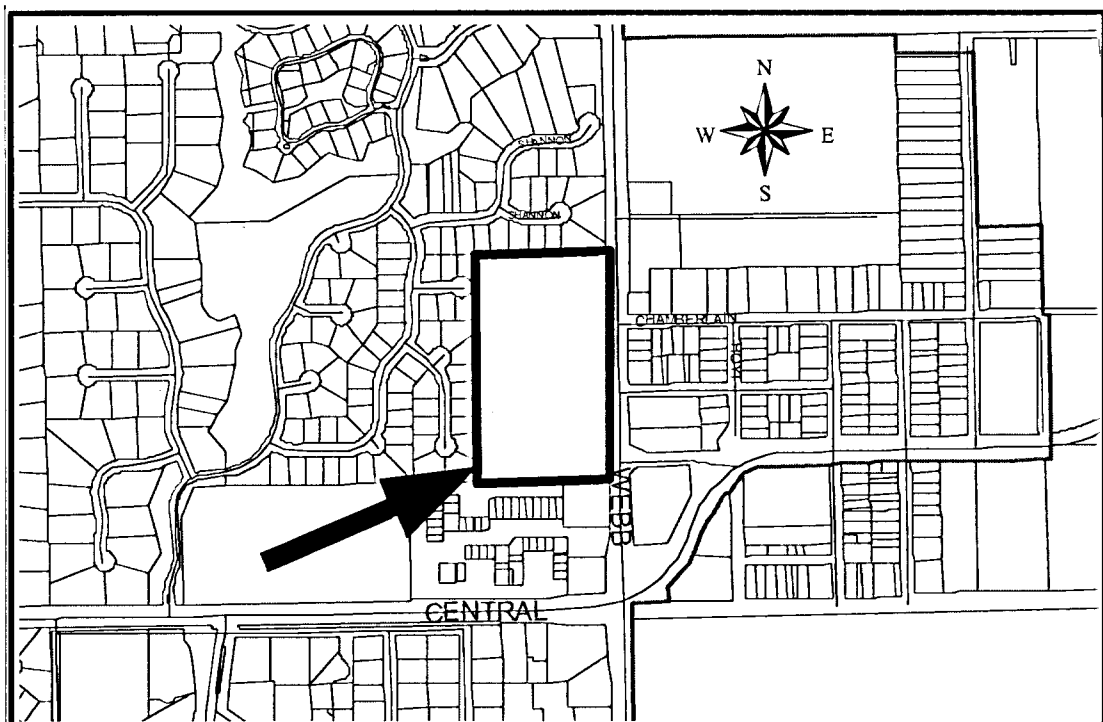

SUB 2001-128 – One-Step Final Plat of MINNEHA ELEMENTARY SCHOOL
ADDITION
January 10, 2002 - Page 2

STAFF COMMENTS:

- A. Municipal services are available to serve the site. **City Engineering** needs to comment on the need for guarantees or easements. *No guarantees are required.*
- B. If improvements are guaranteed by petition, a notarized certificate listing the petitions shall be submitted to the Planning Department for recording.
- C. **City Engineering** needs to comment on the status of the applicant's drainage plan. *The drainage plan is approved.*
- D. The plat proposes four access openings along Webb. Distances should be shown for all segments of access control. *The access controls are approved.*
- E. The applicant shall guarantee the closure of any driveway openings located in areas of complete access control or that exceed the number of allowed openings.
- F. The applicant shall submit an avigational easement covering all of the subject plat and a restrictive covenant assuring that adequate construction methods will be used to minimize the effects of noise pollution in the habitable structures constructed on subject property.
- G. The Applicant is reminded that a platting binder is required with the final plat. Approval of this plat will be subject to submittal of this binder and any relevant conditions found by such a review.
- H. The platator's text shall include language that a drainage plan has been developed for the plat and that all drainage easements, rights-of-way, or reserves shall remain at established grades or as modified with the approval of the applicable City or County Engineer, and unobstructed to allow for the conveyance of stormwater.
- I. The applicant shall install or guarantee the installation of all utilities and facilities which are applicable and described in Article 8 of the MAPC Subdivision Regulations. (Water service and fire hydrants required by Article 8 for fire protection shall be as per the direction and approval of the Chief of the Fire Department.)
- J. The applicant's engineer is advised that the Register of Deeds is requiring the name(s) of the notary public, who acknowledges the signatures on this plat, to be printed beneath the notary's signature.
- K. To receive mail delivery without delay, and to avoid unnecessary expense, the applicant is advised of the necessity to meet with the U.S. Postal Service Growth Management Coordinator (Phone 316-946-4556) prior to development of the plat so that the type of delivery, and the tentative mailbox locations can be determined.
- L. The applicant is advised that various State and Federal requirements (specifically but not limited to the Army Corps of Engineers, Kanopolis Project Office, Rt. 1, Box 317, Valley Center, KS 67147) for the control of soil and wind erosion and the protection of wetlands may impact how this site can be developed. It is the applicant's responsibility to contact all appropriate agencies to determine any such requirements.

SUB 2001-128 – One-Step Final Plat of MINNEHA ELEMENTARY SCHOOL
ADDITION

January 10, 2002 - Page 3

- M. The owner of the subdivision should be aware of the fact that the development of any subdivision greater than five (5) acres in size may require an NPDES Storm Water Discharge Permit from the Kansas Department of Health and Environment in Topeka. Further, on all construction sites, the City of Wichita requires that best management practices be used to reduce pollutant loadings in storm water runoffs.
- N. Perimeter closure computations shall be submitted with the final plat tracing.
- O. Recording of the plat within thirty (30) days after approval by the City Council and/or County Commission.
- P. The representatives from the utility companies should be prepared to comment on the need for any additional utility easements to be platted on this property.
- Q. The applicant is reminded that a disk shall be submitted with the final plat tracing to the Planning Department detailing this plat in digital format in AutoCAD. This will be used by the City and County GIS Department.