

AN ORDINANCE CHANGING THE ZONING CLASSIFICATIONS OR DISTRICTS OF CERTAIN LANDS LOCATED IN THE CITY OF WICHITA, KANSAS, UNDER THE AUTHORITY GRANTED BY THE WICHITA-SEDGWICK COUNTY UNIFIED ZONING CODE, SECTION V-C, AS ADOPTED BY SECTION 28.04.010, AS AMENDED.

BE IT ORDAINED BY THE GOVERNING BODY
OF THE CITY OF WICHITA, KANSAS.

SECTION 1. That having received a recommendation from the Planning Commission, and proper notice having been given and hearing held as provided by law and under authority and subject to the provisions of The Wichita-Sedgwick County Unified Zoning Code, Section V-C, as adopted by Section 28.04.010, as amended, the zoning classification or districts of the lands legally described hereby are changed as follows:

Case No. ZON2013-00036

Amendment to Protective Overlay #267 to remove the off-site sign exclusion in GC General Commercial (GC) zoning on approximately 10 acres described as:

Lot 1, Block A, Absolute Natural Stone Addition to Wichita, Sedgwick County, Kansas.

SUBJECT TO THE AMENDED PROTECTIVE OVERLAY #267:

1. The transfer of title on all or any portion of the land included in the development does not constitute a termination of the PO or any portion thereof, but said PO shall run with the land for development and be binding upon present land owners, their successors and assigns and their lessees unless amended.
2. If multiple ownership is anticipated an owners association agreement providing for the maintenance of reserves, open spaces, internal drives, parking areas, drainage improvements, etc, shall be filed with the plat of the area.
3. Certain development requirements including, but not limited to, drainage, access, easements, and road improvements (including guarantees and dedication of right-of-way) shall be determined at the time platting.
4. Prior to publishing the ordinance making the zone change official, the applicant shall provide a revised PO site plan drawing for review and consideration of approval by the Planning Director. The revised PO site plan drawing shall include all provisions to the approved PO. The site shall be developed and operated in conformance with the approved PO site plan and other applicable regulations unless specifically modified by this PO.
5. The uses allowed within this PO shall be confined to those listed within the parcel descriptions. Any additional uses will require an adjustment or an amendment to this PO. Any cutting of stone shall be done indoors.
6. A 35 foot building setback shall be required along the perimeter of the subject site. No trash receptacles, parking, lighting, outdoor storage or any structure will be allowed in the setbacks. The setbacks will be shown on the PO site plan drawing.
7. Screening per UZC CUP requirements and landscaping per the Landscape Ordinance shall be installed. All existing landscaping located within the 35-foot setbacks shall remain. A landscape prepared by a licensed Kansas Landscape Architect will be submitted for approval prior to issuance of certificate of occupancy and shall comply with the Landscape Ordinance. If all required screening or landscaping is not installed prior to occupancy, a financial guarantee shall be provided for the necessary screening, landscaping and watering equipment. A landscape plan shall include how the landscaping shall be maintained. All planting must be done within a year of approval by the governing body.
8. Up to 20-foot tall (including the base) pole lighting standards are allowed. Light poles shall be of the same color and design and shall have cut-off fixtures which direct light away from any abutting or adjacent properties that are in a residential zoning district. All lights on buildings will be directed down and away from residential development.
9. All trash dumpsters and loading dock areas will have solid screening around them.
10. Roof top mechanical equipment shall be screened from ground level view, per Wichita – Sedgwick County Unified Zoning Code
11. No outside speakers/amplification

12. All off street parking and parking areas shall have a surface in accordance with the Wichita – Sedgwick County Unified Zoning Code.
13. A vehicular and pedestrian circulation plan shall be prepared for review and approval and will include cross lot access.
14. No occupancy permits will be issued until the site is serviced by municipal water and sewer.
15. All proposed new utilities will be installed underground.
16. All drives and access thorough the site will be surfaced per the standards of the City of Wichita. Fire must approve circulation and all fire lanes must remain clear.
17. All buildings/structures must meet City Codes and permitting requirements. All buildings will be of similar materials and design.
18. Signs: All signs must be a monument type as permitted in the General Commercial (“GC”) zoning district. No portable or flashing signs (unless telling the time, temperature or other public messages) shall be permitted on the subject property. No building signs shall be permitted along the face of any building that abuts a residential zoning district. Wall display signs are limited to 25% of the wall area. Each parcel is allowed at least one free standing 170-sqaure foot sign per arterial frontage. One off-site sign is permitted, to be placed outside of right-of-way where it will not impede planned Kellogg improvements and will not require relocation. The off-site sign is limited to 10 by 40 feet in size and 30 feet in height, and shall conform to the approved site plan and elevation drawings. The off-site sign shall conform to all Sign Code requirements.
19. All outside storage of sand and dirt shall have three sided walls or fences to prevent the wind from blowing these materials around and from the site.
20. If the Zoning Administrator finds that there is a violation of any of the provisions of the Protective Overlay, the Zoning Administrator, in addition to enforcing the other remedies set forth in Article VIII of the Unified Zoning Code, may, with the concurrence of the Planning Director, declare that the zoning is null and void.
21. All uses permitted by right in the GC district are permitted.
22. The following development standards shall apply:
 Maximum Building Height = 35 feet
 Maximum Coverage = 30%
 Maximum Gross Floor Area = 35%

SECTION 2. That upon the taking effect of this ordinance, the above zoning changes shall be entered and shown on the "Official Zoning Map" previously adopted by reference, and said official zoning map is hereby reincorporated as a part of the Wichita -Sedgwick County Unified Zoning Code as amended.

SECTION 3. That this Ordinance shall take effect and be in force from and after its adoption and publication in the official City paper.

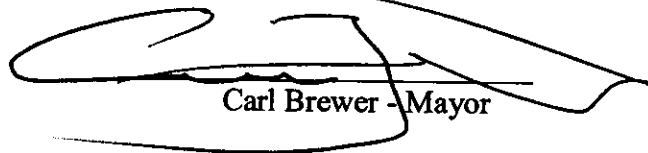
Carl Brewer -Mayor

ATTEST:

Karen Sublett, City Clerk



Approved as to form: 
Gary E. Rebenstorf, City Attorney

**City of Wichita
City Council Meeting
January 7, 2014**

TO: Mayor and City Council

SUBJECT: ZON2013-00036 – Amendment to Protective Overlay #267 to remove the off-site sign exclusion in GC General Commercial zoning, generally located south of Kellogg and one-quarter mile west of 127th Street East (12225 E. Kellogg). (District II).

INITIATED BY: Metropolitan Area Planning Department *JLS
DKL*

AGENDA: Planning (Consent)

MAPC Recommendation: The MAPC recommended approval of the request (8-1-1).

DAB Recommendation: District Advisory Board II recommended approval of the request (unanimous).

MAPD Staff Recommendation: Metropolitan Area Planning Department staff recommended approval of the request.

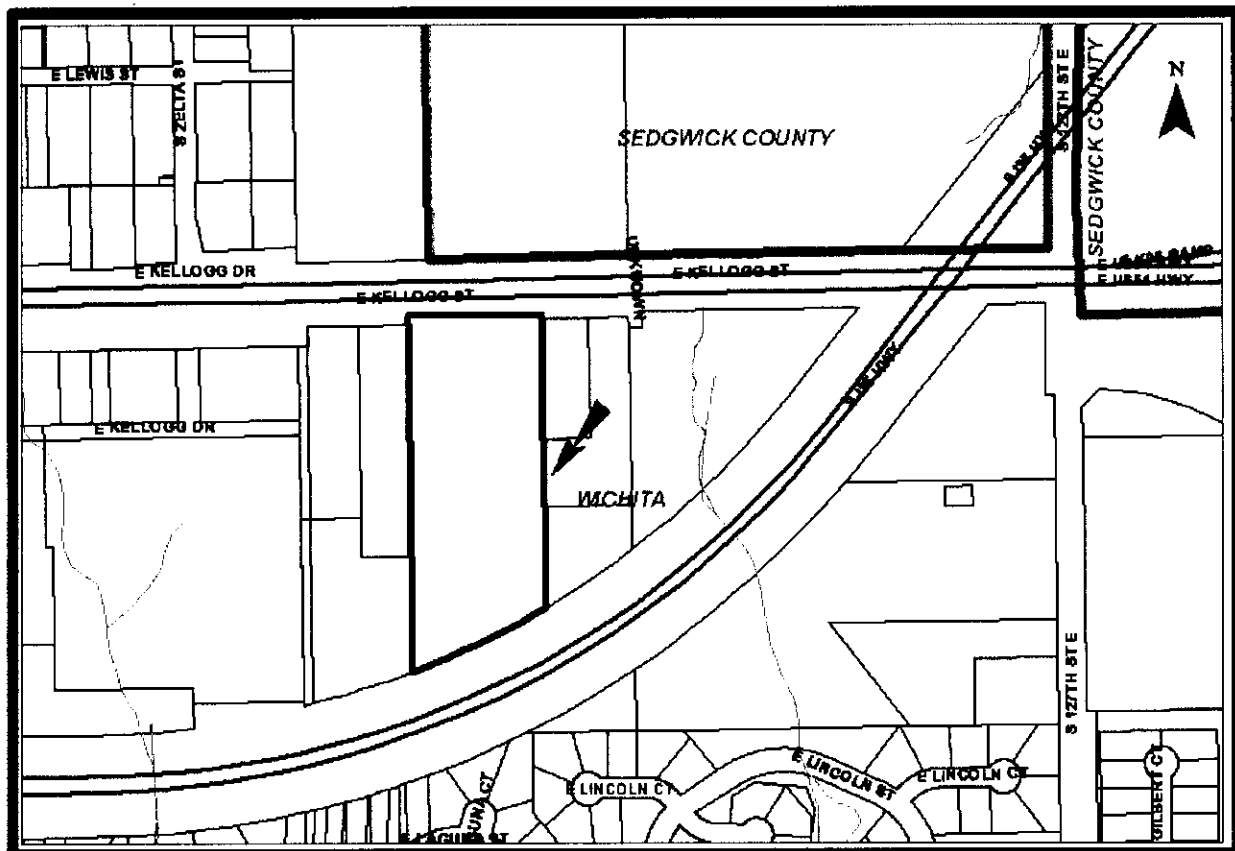

Background: The applicant seeks an amendment to Protective Overlay (PO) #267 on GC General Commercial (GC) zoned property located south of Kellogg and one-quarter mile west of 127th Street East. Provision No. 18 of PO #267 states “No off-site signs, unless approved by the MAPC or the governing body after a review of the proposed sign.” The applicant now seeks MAPC approval for a 30-foot tall, 10 by 40-foot LED billboard off-site sign; see the attached site plan. The applicant will place the sign outside of right-of-way where it will not impede planned Kellogg improvements and will not require relocation.

The Sign Code (Section 24.04.185.q) defines a “Sign, Off-site” as a sign delivering a message or advertising other than the name, occupation or nature of the activities conducted on the premises or the products sold or manufactured thereon. The code recognizes two types of off-site billboards: Off-site junior billboard (Section 24.04.185.s) is an off-site sign with any sign face equal to or less than three hundred square feet in area, and not exceeding thirty feet in total height above adjoining grade. An off-site standard billboard (Section 24.04.185.t) is an off-site sign with any sign face greater than three hundred square feet in area, but not exceeding fourteen feet in height and forty-eight feet in length, plus any allowed extensions. The applicant’s proposed 10 by 40-foot sign is classified as an off-site standard billboard. Off-site billboard signs may also contain an electronic message center that utilize computer generated messages or some other electronic means of changing copy. The off-site sign location and specifications appear to meet all other Sign Code requirements for an off-site sign at this location.

This site was rezoned from SF-5 Single-family Residential (SF-5) and LC Limited Commercial to GC, subject to PO #267, in 2012 (ZON2012-00005). In the 2012 rezoning, the applicant chose to do a PO in lieu of a Community Unit Plan (CUP). The GC zoning request was to accommodate a stone cutting business, consistent with the Zoning Code definition for construction sales and services. Properties abutting the east and west sides of the site are zoned GC. East of the site is a warehouse/retail use and a wireless communication tower approved by CON2000-54. West of the site is a self-storage warehouse development. Further west is retail development in CUP DP-196, the One Kellogg Place Commercial Community Unit Plan. North of the site, across Kellogg, is unplatted, SF-5 zoned property; staff anticipates this SF-5 zoned Kellogg frontage to rezone for future non-residential uses. South of the site is the applicant’s remaining GC zoned property and the Kansas Turnpike.

Analysis: District Advisory Board (DAB) II heard the rezone request on December 2, 2013, and unanimously recommended approval. No citizens spoke at the DAB hearing on this request.

The Metropolitan Area Planning Commission (MAPC) heard the request on December, 2013. No citizens spoke at the MAPC hearing and no protests were filed on this request. The MAPC voted (8-1-1) to recommend approval of the following amended language in Protective Overlay #267:

“One off-site sign is permitted, to be placed outside of right-of-way where it will not impede planned Kellogg improvements and will not require relocation. The off-site sign is limited to 10 by 40 feet in size and 30 feet in height, and shall conform to the approved site plan and elevation drawings. The off-site sign shall conform to all Sign Code requirements.”

Financial Considerations: Approval of this request will not create any financial obligations for the City.

Legal Considerations: The Law Department has reviewed and approved the ordinance as to form.

Recommendation/Actions: It is recommended that the City Council adopt the findings of the MAPC and approve the amendment to Protective Overlay #267, place the ordinance on first reading and authorize the Mayor to sign the ordinance (simple majority vote required).

Attachments:

- Ordinance
- MAPC minutes

