

- 3) Effect on public health, safety or welfare: There will be no encroachment into public utility easements or right-of-way; therefore, there should not be a negative impact on the public health, safety or welfare nor will properties or improvements in the vicinity be materially injured.

Our signatures below indicate that a Sign Code Adjustment to reduce the spacing between signs from 150 feet to 140 feet on the aforementioned property is hereby granted, subject to the following conditions:

- 1) The two existing ground signs on the subject property shall conform to locations shown on the approved site plan and shall be spaced a minimum of 140 feet apart.
- 2) If the Zoning Administrator finds that there is a violation of any of the conditions of the Zoning Adjustment, the Zoning Administrator, in addition to enforcing the other remedies set forth in the Unified Zoning Code, may, with the concurrence of the Planning Director, declare that the Zoning Adjustment is null and void.

The "Development Application" sign should now be removed from the property.

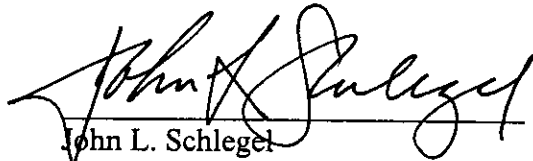

John L. Schlegel
Planning Director

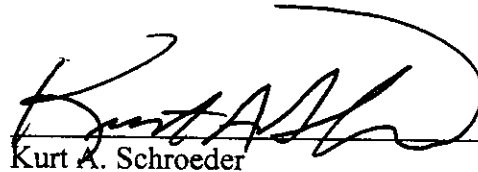

Kurt A. Schroeder
Superintendent of Central Inspection

Enclosure

cc: Stewart Annis, Sign-A-Rama, 4403 Rangeline Rd., Joplin, MO 64804
Kurt Schroeder, Office of Central Inspection
Paul Hays, Office of Central Inspection
Randy Sparkman, Office of Central Inspection
J. R. Cox, Office of Central Inspection



FILE COPY

Wichita-Sedgwick County Metropolitan Area Planning Department

May 12, 2004

Daniel Tevis
3833 Dusty Rd.
Derby, KS 67037

RE: BZA2004-00037: Sign Code Adjustment to reduce the spacing between signs from 150 feet to 140 feet.

Legal Description: The south 460 feet of the east 202.855 feet of the SE ¼ of Sec. 26-27-1E, excluding road right-of-way. Located at the northwest corner of Harry and Oliver (1519 S. Oliver).

Dear Mr. Tevis:

We have reviewed your request for a Sign Code Adjustment to reduce the spacing between signs on the aforementioned property. From reviewing your application, we understand that two existing signs on the subject property are located 140 apart and that you received a permit to replace one of the signs based on a drawing that indicated the signs met the 150-foot spacing requirement. Upon inspection it was determined that the signs are actually 140 feet apart; therefore, you have requested an adjustment to reduce the required spacing between signs to 140 feet to validate the permit issued for replacing one of the signs.

Section 24.04.251.2.a. of the Sign Code allows an adjustment to reduce the minimum allowed distance required between signs by up to one-third when the three conditions required by Section 24.04.251.6. of the Sign Code are met. We find that reducing the distance between signs as proposed meets the three conditions required by Section 24.04.251.6. of the Sign Code as set out below:

- 1) Impact on existing uses in surrounding areas: Signs at the current 140-foot spacing have existed on the subject property for years with no apparent negative impacts on existing uses in surrounding areas. Permitting a sign replacement by allowing an adjustment to permit the current sign spacing should not change the impact of the signs on surrounding areas.
- 2) Compatibility with existing or permitted uses on abutting sites: Permitting the current 140-foot spacing to remain should not reduce the compatibility of the signs with surrounding uses.

Locate signs and street name (Refer to Ordinances 24.04.200 - [driveways] & 24.04.220 [T
ctions]). Include all existing sign locations, distances, separations, square footages, etc.)

FAILURE TO SHOW ALL REQUIRED MEASUREMENTS AND INFORMATION SHALL BE CAUSE TO REJECT THIS
PERMIT APPLICATION

Please number the signs to match information on front

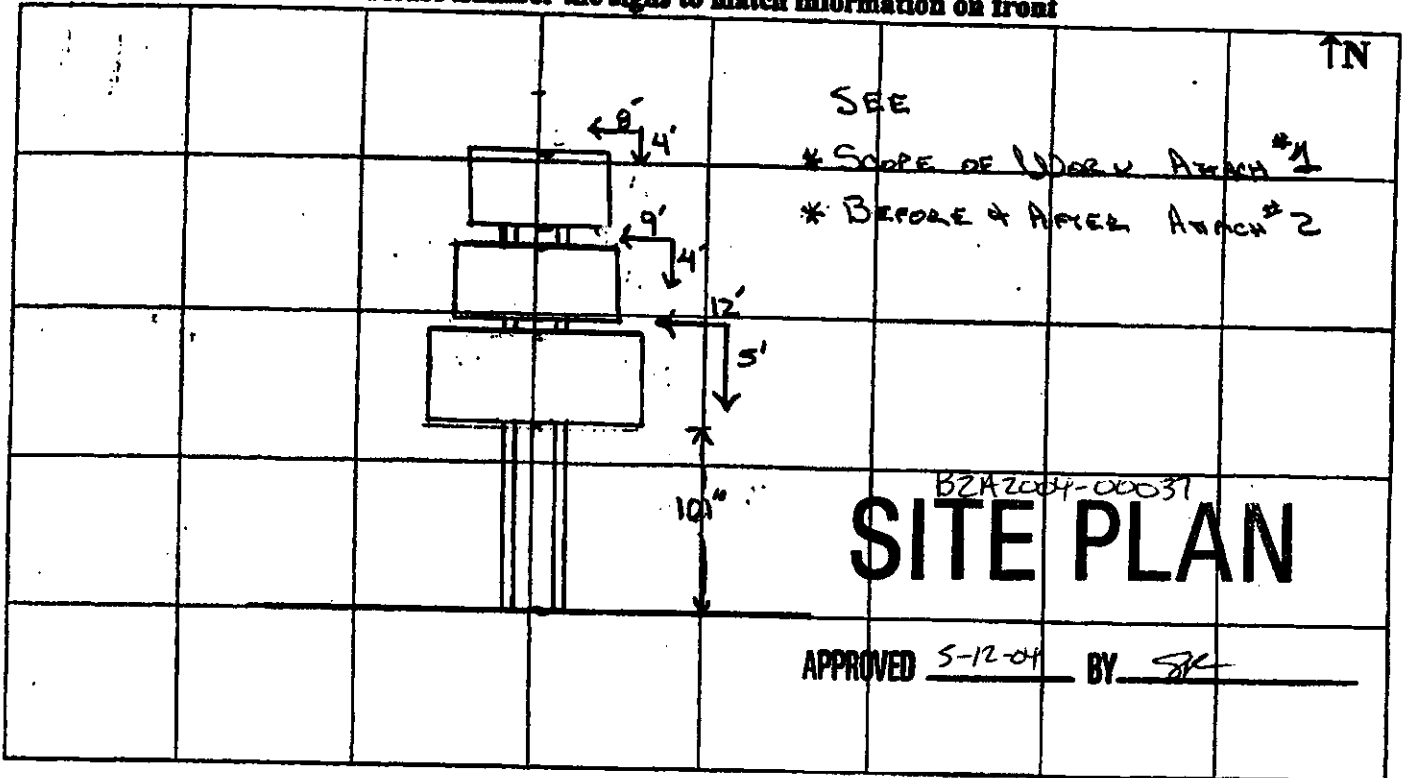

Sign Design (dimensions, height from ground to lower edge of sign)

Scale: _____

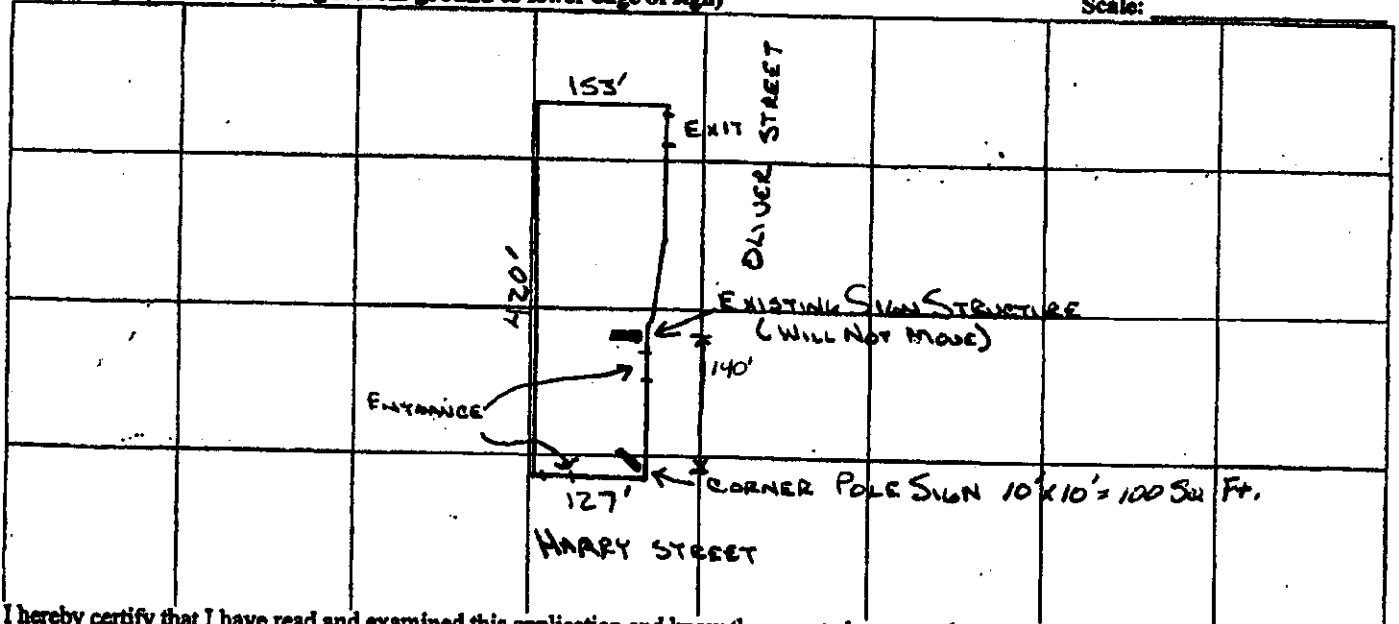

I hereby certify that I have read and examined this application and know the same to be true and correct. All provisions of laws and ordinances governing this type of work will be complied with whether specified herein or not. The granting of a permit does not presume to give authority to violate or cancel the provisions of any other federal, state, or local law regulating construction or the performance of construction.

Signature Ronald [Signature]

Date 12-11-03

OFFICE USE ONLY

Final Inspection by _____

Date _____