

- 3) Effect on public health, safety or welfare: There will be no encroachment into public utility easements or right-of-way; therefore, there should not be a negative impact on the public health, safety or welfare nor will properties or improvements in the vicinity be materially injured.

Our signatures below indicate that a Sign Code Adjustment to permit an electronic message sign for a church on the aforementioned property is hereby granted, subject to the following conditions:

- 1) The sign shall be limited to 53 square feet in total area, with no more than 22 square feet for an internally-illuminated, red-light only electronic message sign. The sign shall be of a design that is in substantial conformance with the approved elevation rendering.
- 2) No flashing or moving images or text shall be displayed on the sign. The message displayed on the sign may change, but it shall not change more than once every 10 seconds.
- 3) Portable signage shall not be permitted on the subject property.
- 4) The existing pole sign on the subject property shall be removed within 30 days of the installation of the electronic message sign allowed by this adjustment.
- 5) If the Zoning Administrator finds that there is a violation of any of the conditions of the Zoning Adjustment, the Zoning Administrator, in addition to enforcing the other remedies set forth in the Unified Zoning Code, may, with the concurrence of the Planning Director, declare that the Zoning Adjustment is null and void.

The development application sign should now be removed from the property.

John L. Schlegel
Planning Director

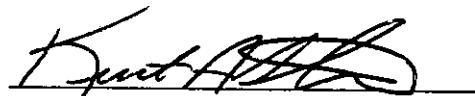
Kurt A. Schroeder
Superintendent of Central Inspection

cc: Randy Kubik, Sign-A-Rama, 362 Country Acres, Wichita, KS 67212
Kurt Schroeder, Office of Central Inspection
Paul Hays, Office of Central Inspection
Randy Sparkman, Office of Central Inspection
J.R. Cox, Office of Central Inspection



FILE COPY

Wichita-Sedgwick County Metropolitan Area Planning Department

April 9, 2004

Ralph Green
Wichita Unity Church
2160 N. Oliver
Wichita, KS 67208

RE: BZA2004-00024: Sign Code Adjustment to permit an electronic message sign for a church on property zoned "SF-5" Single-Family Residential.

Legal Description: Lot 1, Truth Addition, Wichita, Sedgwick County, Kansas. Located at the southeast corner of 21st St. N. and Oliver (2160 N. Oliver).

Dear Mr. Green:

We have reviewed your request for a Sign Code Adjustment to permit an electronic message sign for a church on the aforementioned property. From reviewing your application, we understand that you propose to construct a 53 square-foot monument sign. Since the church hosts numerous events, you propose a 22 square-foot electronic message sign to relay messages regarding multiple events on a single sign.

Section 24.04.251.2.i. of the Sign Code allows an adjustment to allow an electronic message sign for institutional uses located in a residential zoning district when the three conditions required by Section 24.04.251.6. of the Sign Code are met. We find that allowing the electronic message sign as proposed meets the three conditions required by Section 24.04.251.6. of the Sign Code as set out below:

- 1) Impact on existing uses in surrounding areas: Existing uses in surrounding areas are primarily commercial and institutional. Residential uses are located northwest of the proposed sign, and the sign is angled as to not be directly visible from nearby residential uses. Therefore, the proposed electronic message sign not have negative impacts on existing residential uses in the area.
- 2) Compatibility with existing or permitted uses on abutting sites: Adding electronic message capability to the sign should not reduce compatibility of the sign with surrounding uses, as the sign will not be permitted to flash or display moving images or text and will be limited to a single-color display.

Site Plan: Locate signs and street name (Refer to Ordinances 24.04.200 - [driveways] & 24.04.220 [T] [intersections]). Include all existing sign locations, distances, separations, square footages, etc.)

FAILURE TO SHOW ALL REQUIRED MEASUREMENTS AND INFORMATION SHALL BE CAUSE TO REJECT THIS PERMIT APPLICATION

Please number the signs to match information on front

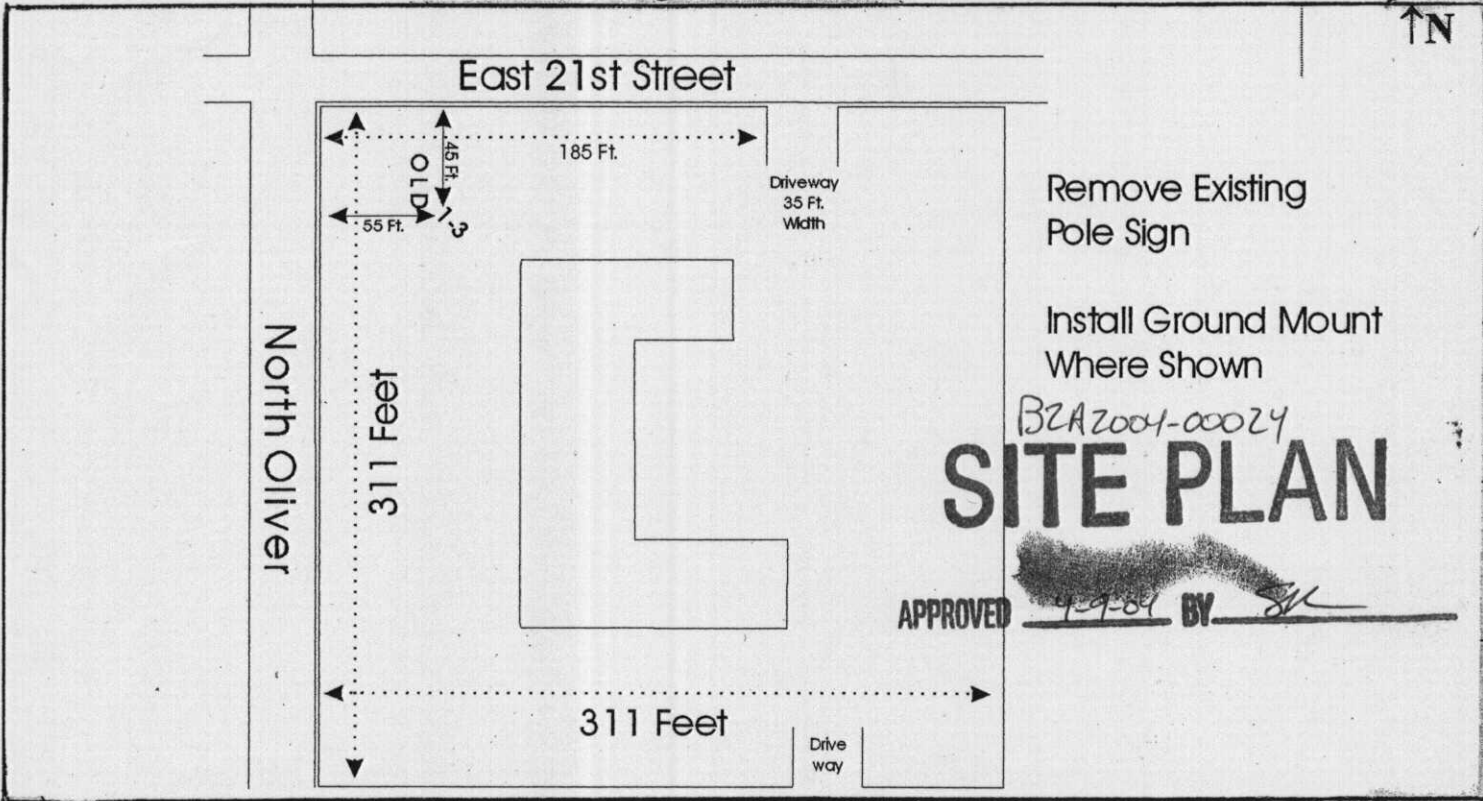

Sign Design (dimensions, height from ground to lower edge of sign)

Scale: _____

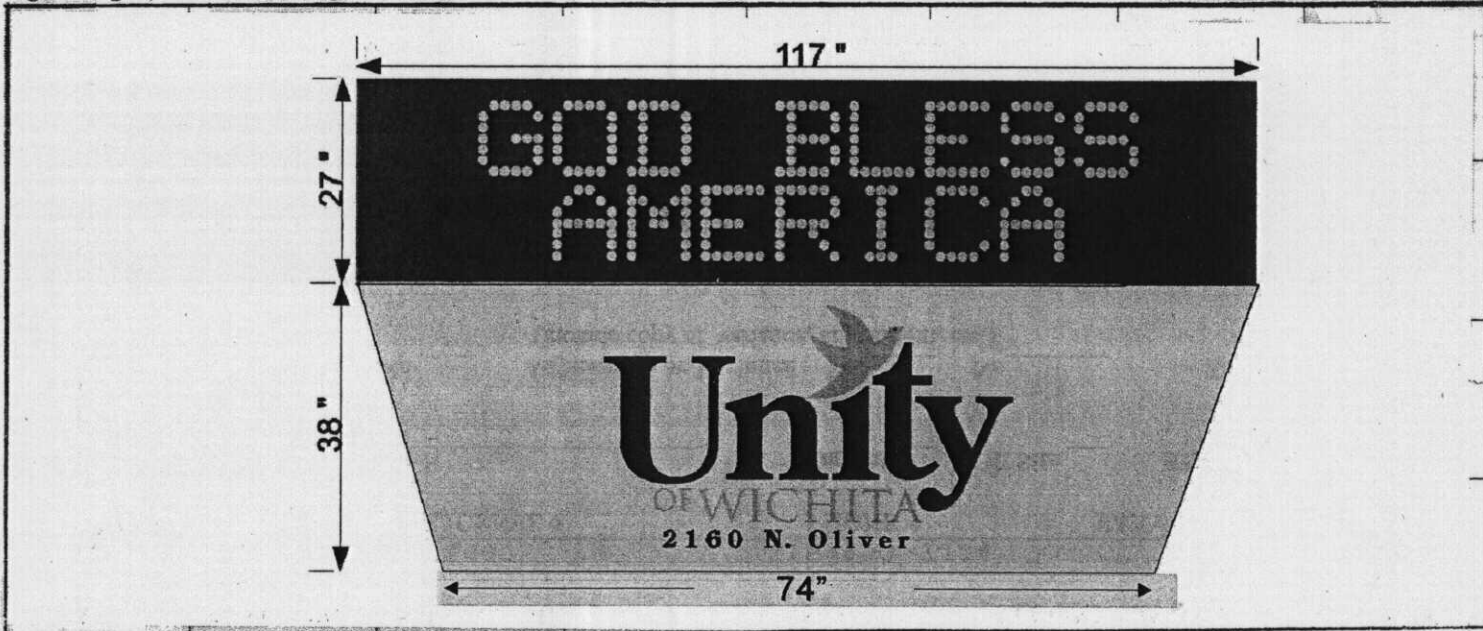

I hereby certify that I have read and examined this application and know the same to be true and correct. All provisions of laws and ordinances governing this type of work **will be complied with whether specified herein or not.** The granting of a permit does not presume to give authority to violate or cancel the provisions of any other federal, state, or local law regulating construction or the performance of construction.

Signature Rand W. Kuhn

Date 23 MAR 04

OFFICE USE ONLY

Section by _____

Date _____