

OCA150006 BID 37529-009 CID #76383
Published in The Wichita Eagle on Nov 9, 2006
ORDINANCE NO. 47-278

AN ORDINANCE CHANGING THE ZONING CLASSIFICATIONS OR DISTRICTS OF CERTAIN LANDS LOCATED IN THE CITY OF WICHITA, KANSAS, UNDER THE AUTHORITY GRANTED BY THE WICHITA-SEDGWICK COUNTY UNIFIED ZONING CODE, SECTION V-C, AS ADOPTED BY SECTION 28.04.010, AS AMENDED.

BE IT ORDAINED BY THE GOVERNING BODY
OF THE CITY OF WICHITA, KANSAS.

SECTION 1. That having received a recommendation from the Planning Commission, and proper notice having been given and hearing held as provided by law and under authority and subject to the provisions of The Wichita-Sedgwick County Unified Zoning Code, Section V-C, as adopted by Section 28.04.010, as amended, the zoning classification or districts of the lands legally described hereby are changed as follows:

Case No. ZON2006-00034

Request for zone change from "SF-5" Single-family Residential to "GI" General Industrial on property described as:

A tract of land lying within a portion of Section 26, Township 29 South, Range 4 West of the 6th P.M., Sedgwick County, Kansas EXCEPT the east 1396 feet of the south 537 feet AND EXCEPT for that part designated as road rights of way, said tract being described as:

The West 200 feet of the Southeast Quarter of said Section 26, TOGETHER WITH, the North 600 feet of the West 500 feet of said Southeast Quarter.

TOGETHER WITH

The East 500 feet of the Southwest Quarter of said Section 26.

TOGETHER WITH

The South 600 feet of the East 500 feet of the Northwest Quarter of said Section 26.

TOGETHER WITH

The South 600 feet of the West 500 feet of the Northeast Quarter of said Section 26.

Generally located north of 111th Street South and one-half mile west of 327th Street West.

SECTION 2. That upon the taking effect of this ordinance, the above zoning changes shall be entered and shown on the "Official Zoning Map" previously adopted by reference, and said official zoning map is hereby reincorporated as a part of the Wichita -Sedgwick County Unified Zoning Code as amended.

Done

SECTION 3. That this Ordinance shall take effect and be in force from and after its adoption and publication in the official City paper.

ADOPTED AT WICHITA, KANSAS, 11-7-06

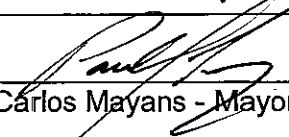
for

Carlos Mayans - Mayor

VICE MAYOR
~~Paul Gray~~

ATTEST:



Karen Sublett, City Clerk



(SEAL)

Approved as to form:



Gary E. Rebenstorf, City Attorney

Owners: City of Wichita
 455 N. Main
 Wichita, KS 67202
 556 ACRES +/-

Use: Agricultural Production
 NO STRUCTURES

ZONED "RR" **UNPLATTED**

60.95 ACRES +/-
PROPOSED ZONED "GI"
 w/ CU

W. 343th ST.

W. 327th ST.

UNPLATTED
ZONED "RR"
 Owners: City of Wichita
 455 N. Main
 Wichita, KS 67202
 Use: Agricultural Production
 NO STRUCTURES

UNPLATTED
ZONED "RR"
 Owners: City of Wichita
 455 N. Main
 Wichita, KS 67202
 Use: Agricultural Production
 NO STRUCTURES

"GI" General Commercial with a conditional use permit allowing Hazardous Operations, for the placement of a municipal safety operation.

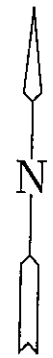
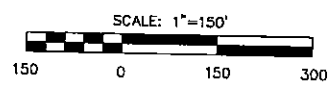
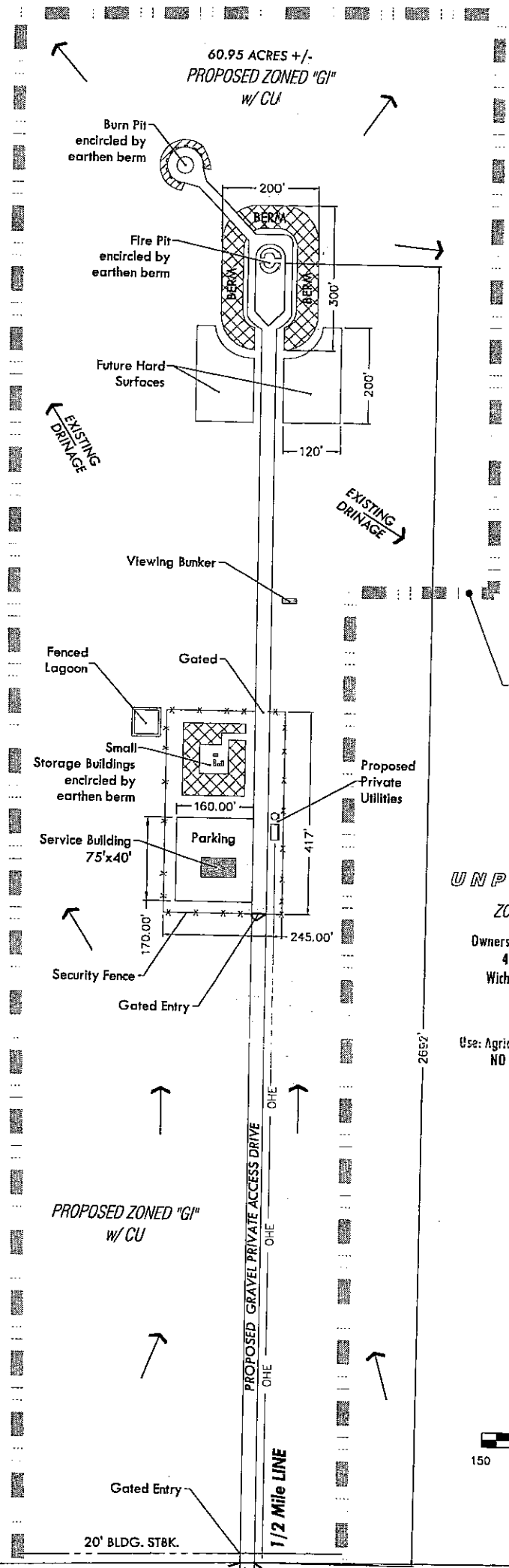

METES AND BOUNDS DESCRIPTION

A tract of land lying within a portion of Section 26, Township 29 South, Range 4 West of the 6th Principal Meridian, EXCEPT, the east 1396 feet of the south 537 feet, AND EXCEPT, for that part designated as road rights of way, said tract being described as:

The west 200 feet of the Southeast Quarter of said Section 26, TOGETHER WITH, the north 600 feet of the west 500 feet of said Southeast Quarter.

TOGETHER WITH,

The east 500 feet of the Southwest Quarter of said Section 26.

TOGETHER WITH,

The south 600 feet of the east 500 feet of the Northwest Quarter of said Section 26.

TOGETHER WITH,

The south 600 feet of the west 500 feet of the Northeast Quarter of said Section 26.

MKEC
 ENGINEERING
 CONSULTANTS, INC.

411 N. WEBB ROAD
 WICHITA, KS. 67206
 316 - 684 - 9600

EXPLOSIVE ORDNANCE DISPOSAL FACILITY
 PROJECT NAME
SITE PLAN FOR
CONDITIONAL USE PERMIT
 SHEET TITLE

BDL DESIGN BY.	CMJ DRAWN BY.	BDL CHECKED BY.
AUGUST 2006 DATE	06530 JOB NO.	1 / 1 SHEET OF

MAIN

Use: Agricultural Production
 NO STRUCTURES
UNPLATTED
ZONED "RR"
 Owners: Tangeman, James H. & Sandra G. Trust
 #14 1400 N Gatewood
 Wichita, KS 67206

Use: Agricultural Production
 NO STRUCTURES
UNPLATTED
ZONED "RR"
 Owners: Casner, Donald L. ETUX
 24500 W. K-42 HWY
 Viola, KS 67149