



Wichita-Sedgwick County Metropolitan Area Planning Department

April 23, 2007

Jacki White
Steve and Jacki Redd
459 W 9th Street N
Wichita, KS 67203

Re: BZA2007-21: Zoning Adjustment to reduce the side setback for an attached garage from 6 feet to 4.8 feet in TF-3 Two-family Residential zoning.

Lots 108 and 110 Greiffenstein's 7th Addition to Wichita, Sedgwick County, Kansas. Generally located south of West 9th Street and west of Waco (459 W 9th Street N).

Dear Applicants,

We have reviewed your request for a Zoning Adjustment to reduce the side setback for an attached garage on the aforementioned property. From reviewing the application, we understand that you desire to construct a garage addition within 4.8 feet of the side property line, a 1.2 foot encroachment into the required 6 foot side building setback for the TF-3 Two-family Residential zoning district. Therefore, you have requested an adjustment to reduce the required setback.

Section V-1.2.c. of the Unified Zoning Code allows the side setback to be reduced by 20% when the provisions of that section and the Zoning Adjustment Criteria of Section V-1.6. are met. We find that the reduction of the side setback as proposed meets the provisions of Section V-1.2.a. and the four criteria required by Section V-1.6. as set out below:

- 1) Impact on safety and convenience of vehicular and pedestrian circulation: The setback encroachment should have no impact on the safety and convenience of vehicular and pedestrian circulation in the vicinity as no public right-of-way is affected.
- 2) Impact on existing uses in surrounding areas: There should be no negative impact on the existing uses in surrounding areas as a result of the setback reduction, provided that sufficient separation between buildings is maintained. The side setback reduction is within allowable limits.
- 3) Compatibility with existing or permitted uses on abutting sites: The attached garage is compatible with existing and permitted uses on abutting sites, the encroachment into the side setback should not reduce compatibility with abutting and adjacent sites.

- 4) Effect on public health, safety or welfare: There will be no encroachment into public utility easements or right-of-way. Therefore, there should be no negative impact on the public health, safety or welfare nor will properties or improvements in the vicinity be materially injured.

Our signatures below indicate that a Zoning Adjustment to reduce the side setback for the aforementioned property from 6 feet to 4.8 feet is hereby granted, subject to the following conditions:

- 1) The site shall be developed in general conformance with the approved site plan.
- 2) The site shall be developed in conformance with all applicable codes, including but not limited to building, fire, and health codes.
- 3) The setback reduction shall apply only to the side setback as illustrated on the approved site plan. All other structures or additions on the subject property shall conform to the setbacks permitted by the Unified Zoning Code unless a separate Zoning Adjustment or Variance is granted.
- 4) If the Zoning Administrator finds that there is a violation of any of the conditions of the Zoning Adjustment, the Zoning Administrator, in addition to enforcing the other remedies set forth in the Unified Zoning Code, may, with the concurrence of the Planning Director, declare that the Zoning Adjustment is null and void.

The "Development Application" sign should now be removed from the property.

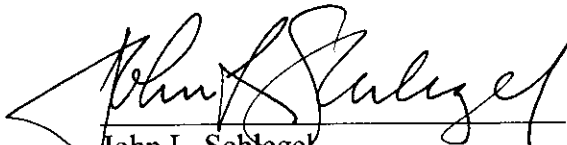

John L. Schlegel
Planning Director

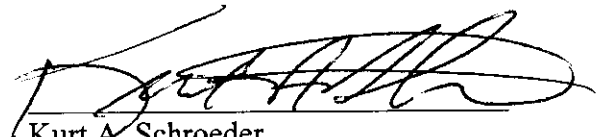

Kurt A. Schroeder
Superintendent of Central Inspection

Enclosure

cc: Kurt Schroeder, OCI
Mike Gable, OCI

EXHIBIT FOR PROPOSED GARAGE

LEGAL DESCRIPTION: Lots 108 and 110 On 9th Street, Greiffensteins Seventh Addition, Wichita, Kansas.



9TH STREET NORTH

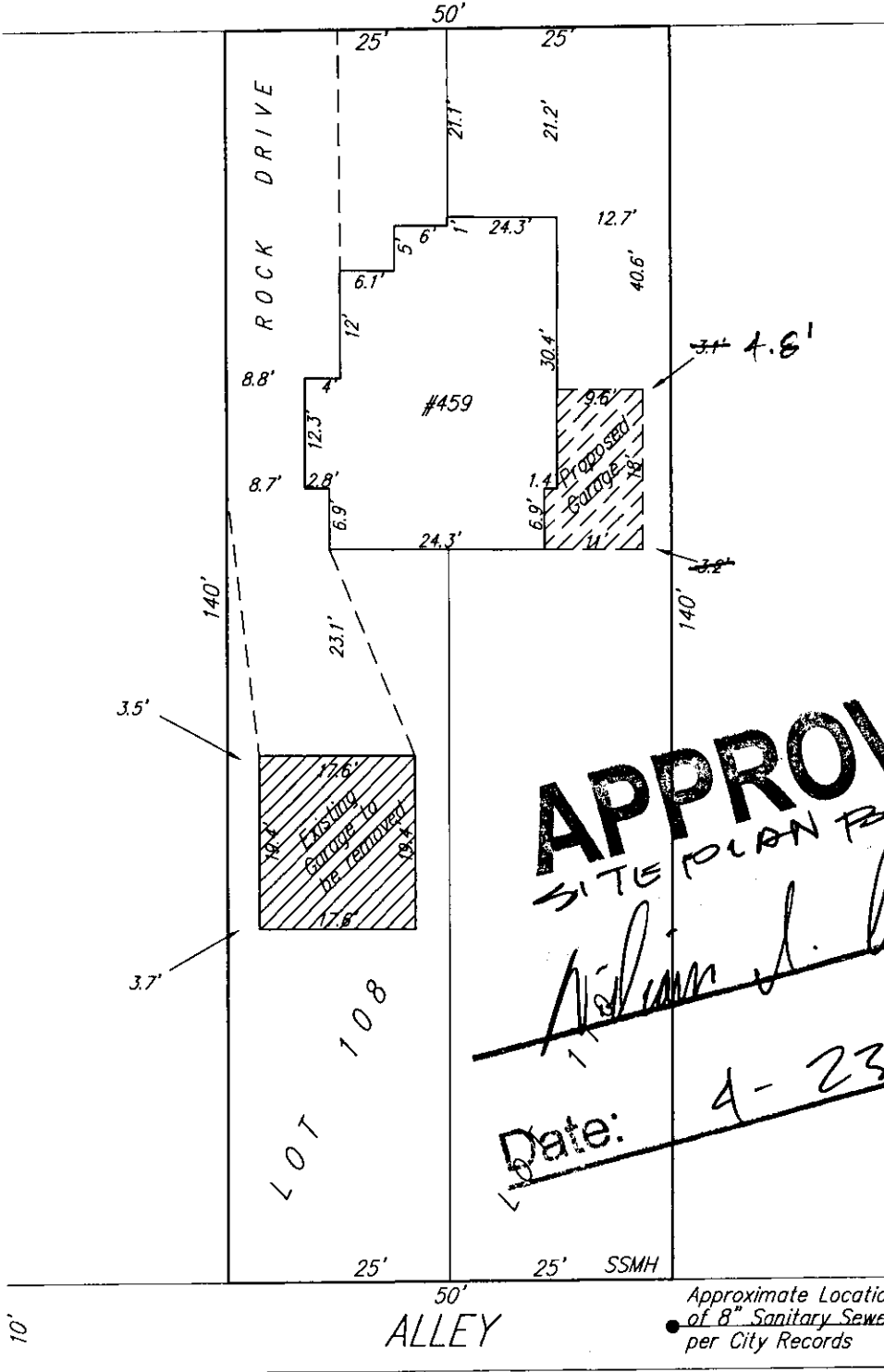

APPROVED
SITE PLAN BZA 2007-21

William J. Van Dine

Date: 4-23-07

Approximate Location
of 8" Sanitary Sewer
per City Records