

# FINAL PLAT

# CORNEJO EAST SECOND ADDITION

## AN ADDITION TO WICHITA, SEDGWICK COUNTY, KANSAS

### CERTIFICATE OF SURVEY

I, Gregory J. Allison, a registered land surveyor in Kansas, do hereby certify that I have been in responsible charge of surveying and platting of "CORNEJO EAST SECOND ADDITION", an addition to Wichita, Sedgwick County, Kansas, into Lots and, a Block, the same being accurately set forth in the accompanying plat and described herein:

A replat of a contiguous tract of land lying within all of "CORNEJO EAST ADDITION", to Wichita, Sedgwick County, Kansas, AND all of "FAMILY GOLF CENTER ADDITION", an addition to Wichita, Sedgwick County, Kansas, EXCEPT, that part of Lot 1, Block 1, said "FAMILY GOLF CENTER ADDITION", being described as commencing at the western most southwest corner of said Lot 1, thence N00°00'00"W, along the west line of said Lot 1, 366.91 feet for a point of beginning, thence continuing N00°00'00"W, along the west line of said Lot 1, 148.00 feet; thence S89°59'21"E, 200.00 feet; thence S00°00'00"E, 148.00 feet; thence N89°59'21"W, 200.00 feet to the point of beginning, said contiguous tract of land being more particularly described as follows: BEGINNING at northwest corner of said Family Golf Center Addition, thence along the north line of said addition, N89°58'55"E, 1264.52 feet to the northeast corner of said addition; thence along the east line of said addition being coincident with the east line of the Northwest Quarter of the Southeast Quarter, Section 16, Township 27 South, Range 2 East, of the 6th Principal Meridian, and being coincident with the west line of Lynch Addition to Travel Air City, Sedgwick County, Kansas, S00°00'54"W, 1077.63 feet to the southeast corner of said Family Golf Center Addition being coincident with the northeast corner of the south half of the south 15 acres of the Northwest Quarter of said Southwest Quarter; thence along the southerly line of said Family Golf Center Addition being coincident with the north line of said south half of the south 15 acres, S89°55'35"W, 899.20 feet to the northeast corner of Cornejo East Addition; thence along the east line of said Cornejo East Addition, S00°04'11"W, 211.77 feet to the southeast corner of said Cornejo East Addition; thence along the south line of said Cornejo East Addition S89°55'35"W, 364.79 feet to the Southwest corner of said Cornejo East Addition; thence along the westerly lines of said Cornejo East and Family Golf Center additions N00°00'00"W, 461.92 feet to the southwest corner of said exception to Lot 1, Block 1, Family Golf Center Addition; thence along the south line of said exception to Lot 1, N90°00'00"E, 200.00 feet to the southeast corner of said exception to Lot 1; thence along the east line of said exception to Lot 1, N00°01'35"W, 148.08 feet to the northeast corner of said exception to Lot 1; thence along the north line of said exception to Lot 1, N90°00'00"W, 199.93 feet to the northwest corner of said exception to Lot 1 being coincident with the west line of said Family Golf Center Addition; thence along said west line N00°00'00"W, 680.62 feet to the POINT OF BEGINNING.

All reserves, streets, utility easements, building setbacks, access controls, together with that portion of a utility easement recorded on Film 2371, Page 1050, together with any and all public dedications within the above described property are hereby vacated and replated by virtue of K.S.A. 12-512(b).

This replat corrects the platted boundaries. I hereby certify that the details of this plat are correct to the best of my knowledge and belief this 7th day of April, 2007.

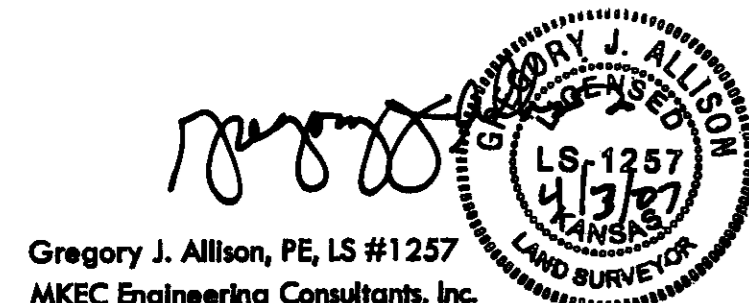

Gregory J. Allison, PE, LS #1257  
MKEC Engineering Consultants, Inc.  
411 North Webb Road  
Wichita, Kansas 67206

Know all men by these presents that we the undersigned property owners of the land above set forth in the Registered Land Surveyor's Certificate, have caused the same to be surveyed and platted into Lots and, a Block, the same to be known as "CORNEJO EAST SECOND ADDITION", an addition to Wichita, Sedgwick County, Kansas.

Easements for the construction and maintenance of public utilities, as indicated on the accompanying plat are hereby granted to the public. Lot 3 indicates two private easement, one to Westar Energy Inc. and the other to Oneok Inc., these private easements are not dedicated to the public; as such they can be released privately.

The wall easement is platted for the construction and maintenance of a private wall, utilities may cross the wall easement.

The access controls are hereby dedicated to and for the use of the public.

All abutters right to access to or from Webb Road over and across the West line of "CORNEJO EAST SECOND ADDITION", are hereby granted to the appropriate governing body, as indicated hereon the face of the plat (1/2).

A drainage plan has been developed for this plat drainage easements, rights-of-way, or reserves shall remain at established grades or as modified with the approval of the applicable City or County Engineer, and unobstructed to allow for the conveyance of storm water.

### OWNER'S CERTIFICATE

As to Lots 3, 4 (Ramcor), and 5, Block 1

TRIPLE J OF WICHITA, LLC, a Kansas limited liability company  
and  
RAMCOR, LLC, a Kansas limited liability company

 Manager  
Ronald J. Cornejo, Manager

STATE OF KANSAS, SEDGWICK COUNTY) ss:

This instrument was acknowledged before me on this 5th day of April, 2007, Ronald J. Cornejo, Manager, Triple J of Wichita, LLC, a Kansas limited liability company, and Manager, Ramcor, LLC, a Kansas limited liability company.

IN WITNESS WHEREOF, I have hereunto set my hand and affixed my official seal, the day and year last above written.

 Notary Public  
Lisa Kay Baggett, Notary Public

My Term Expires: 02-06-11

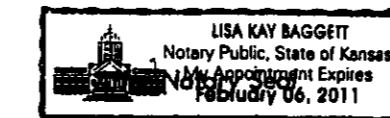

As to Lot 1, Block 1

NNN Retail All Star Wichita LLC, a Delaware limited liability company  
by CDECRE, Inc., an Illinois corporation, sole member  
of: CDECRE, LLC, a Delaware limited liability company,  
its successor in interest

 Vice President  
Miriam Golden, Vice President

STATE OF Illinois, Cook COUNTY) ss:

This instrument was acknowledged before me on this 16th day of May, 2007, Miriam Golden, Vice President, CDECRE, Inc., an Illinois corporation, sole member, NNN Retail All Star Wichita LLC, a Delaware limited liability company.

IN WITNESS WHEREOF, I have hereunto set my hand and affixed my official seal, the day and year last above written.

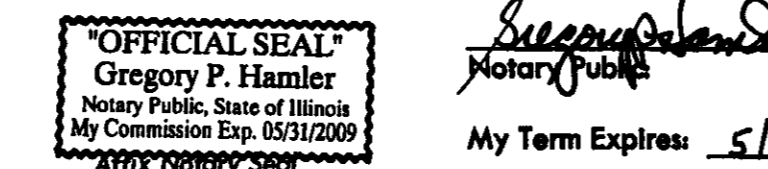
 Notary Public  
Gregory P. Hamler, Notary Public

My Term Expires: 5/31/09

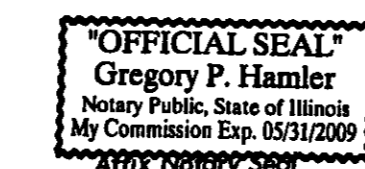

As to Lot 2, Block 1

U Stor of Corpus Christi, LLC, a Kansas limited liability company

 Member  
Maurice L. Sheets, Member

STATE OF Kansas, Sedgwick COUNTY) ss:

This instrument was acknowledged before me on this 9th day of April, 2007, Maurice L. Sheets, Member, U Stor of Corpus Christi, LLC, a Kansas limited liability company.

IN WITNESS WHEREOF, I have hereunto set my hand and affixed my official seal, the day and year last above written.

 Notary Public  
Lisa Kay Baggett, Notary Public

My Term Expires: 02-06-11

Affix Notary Seal



### MORTGAGE CERTIFICATE

We, INTRUST Bank, N.A. holders of a mortgage on a portion of the above described property, do hereby consent to the plat of "CORNEJO EAST SECOND ADDITION."

INTRUST Bank, N.A.

 Senior Vice President  
Gail A. Johnson, Senior Vice President

STATE OF KANSAS, SEDGWICK COUNTY) ss:

This instrument was acknowledged before me on this 16th day of April, 2007, by Gail A. Johnson, Senior Vice President, INTRUST Bank, N.A.

IN WITNESS WHEREOF, I have hereunto set my hand and affixed my official seal, the day and year last above written.

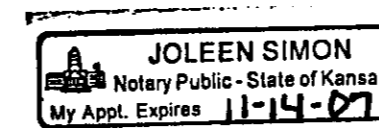
 Notary Public  
Joleen Simon, Notary Public

Affix Notary Seal

 Notary Public  
Joleen Simon, Notary Public

My Term Expires: 11-14-07

### PLANNING COMMISSION CERTIFICATE

This plat of "CORNEJO EAST SECOND ADDITION" has been submitted to and approved by the Wichita-Sedgwick County Metropolitan Area Planning Commission, Wichita, Kansas.

Dated this \_\_\_ day of \_\_\_, 2007

WICHITA-SEDGWICK COUNTY METROPOLITAN AREA PLANNING COMMISSION

 Chair  
Darrell A. Downing, Chair

Attest: \_\_\_\_\_ Secretary  
John L. Schlegel, Secretary

AFFIX SEAL

### GOVERNING BODY CERTIFICATE

The dedications shown on this plat are hereby accepted and this plat is hereby approved by the governing body of the City of Wichita, Kansas.

Dated this \_\_\_ day of \_\_\_, 2007

At the direction of the City Council.

 Mayor  
Carl Brewer, Mayor

Attest: \_\_\_\_\_ City Clerk  
Karen Sublett, City Clerk

AFFIX SEAL

### TRANSFER RECORD

STATE OF KANSAS, SEDGWICK COUNTY) ss:

Entered on transfer record this \_\_\_ day of \_\_\_, 2007

\_\_\_\_\_, County Clerk  
Don Brace, County Clerk

AFFIX SEAL

### REGISTER OF DEEDS CERTIFICATE

This is to certify that this instrument was filed for record in the Register of Deeds office this \_\_\_ day of \_\_\_, 2007, at \_\_\_ o'clock \_\_\_ M; and is duly recorded.

\_\_\_\_\_, Register of Deeds  
Bill Meek, Register of Deeds

Attest: \_\_\_\_\_ Deputy  
Tonya E. Buckingham, Deputy

AFFIX SEAL

### COUNTY SURVEYOR

Reviewed in accordance with K.S.A. 58-2005 on this \_\_\_ day of \_\_\_, 2007.

\_\_\_\_\_, Deputy County Surveyor  
Tricia L. Robello, LS #1246  
Deputy County Surveyor  
Sedgwick County, Kansas

# CORNEJO EAST SECOND ADDITION

## AN ADDITION TO WICHITA, SEDGWICK COUNTY, KANSAS

5/18/07  
Sub. 2007-06

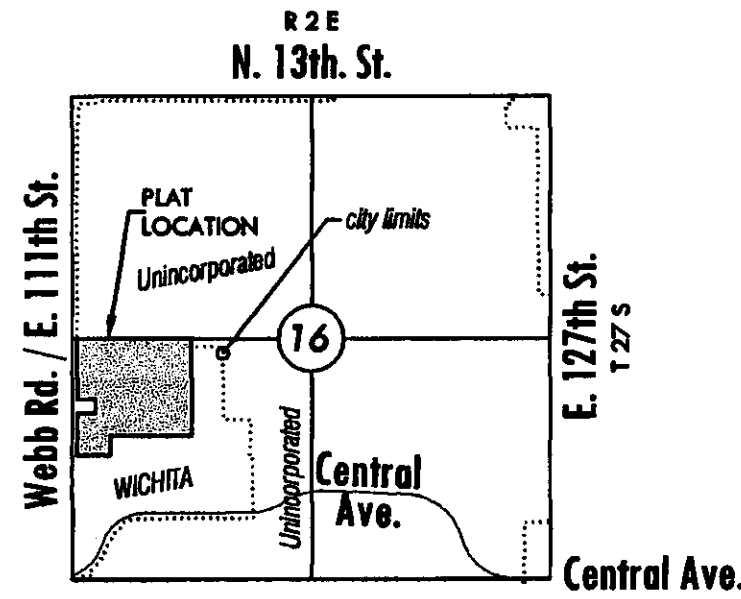

VICINITY MAP

NW. cor., Sec. 16, T27S, R2E, 6th P.M. Fnd. Chiseled "4"

W. 1/4 cor., Sec. 16, T27S, R2E, 6th P.M. Fnd. 1/2" rebar w/ Baughman id cap

NE corner, NW 1/4, SW 1/4, Sec. 16, T27S, R2E, 6th P.M. Fnd. 1/2" rebar

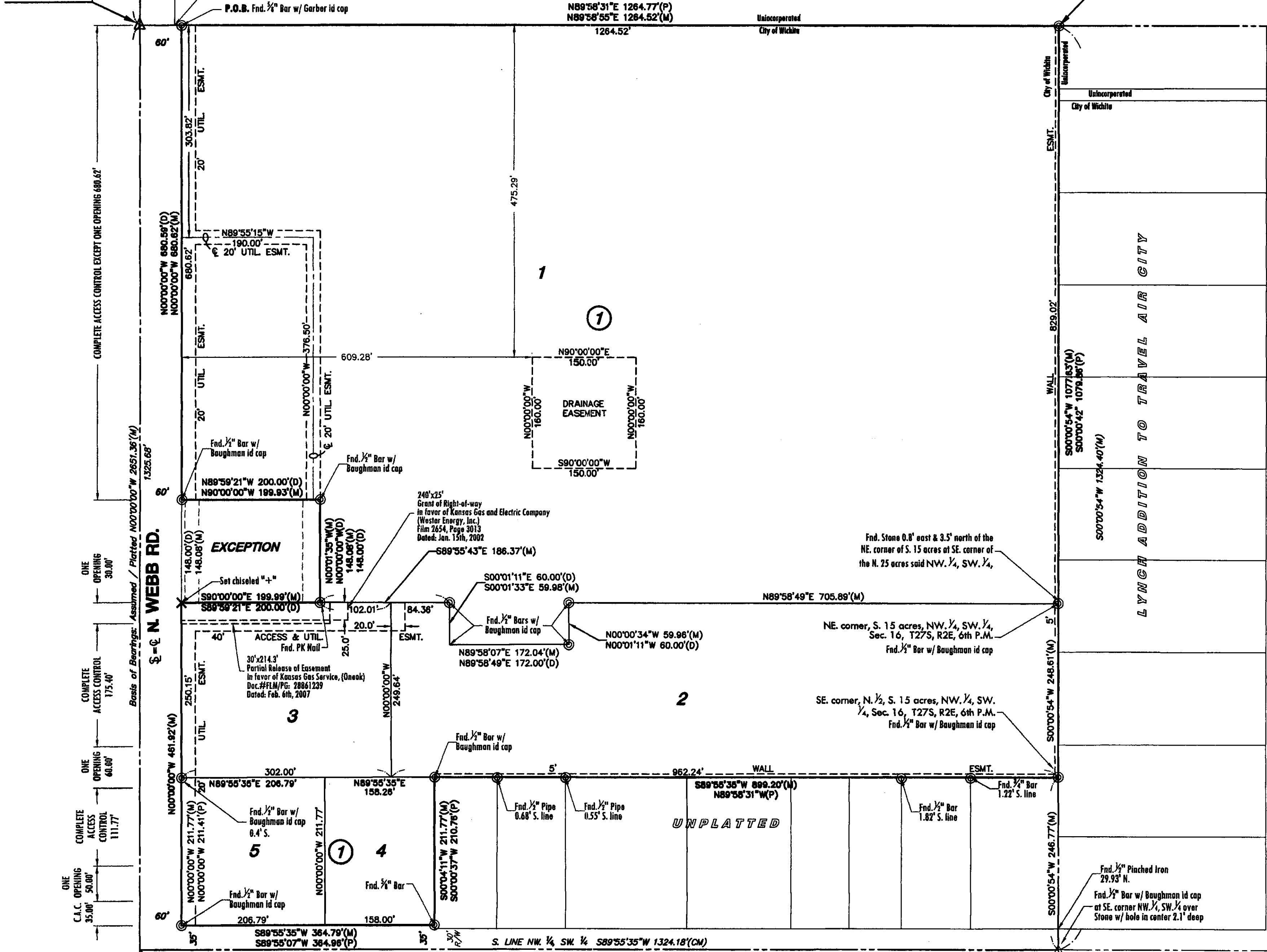

SW. corner, Sec. 16, T27S, R2E, 6th P.M. Fnd. "4" cut

UNPLATTED

UNPLATTED

UNPLATTED

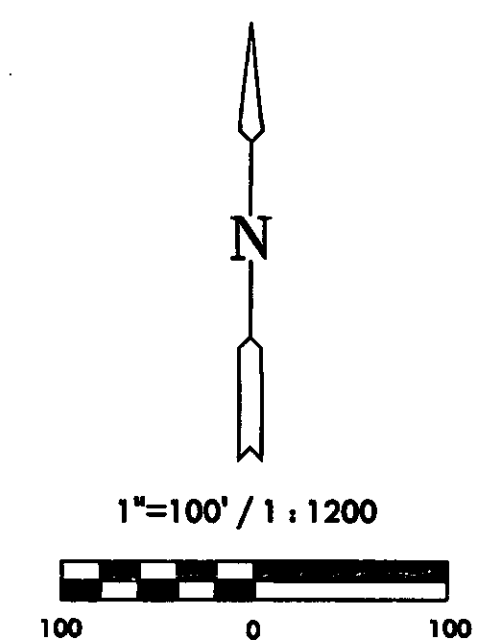

Basis of Bearings: Assumed / Platted bearing of N00°00'00"W along the west line of SW 1/4, Sec. 16, T27S, R2E, 6th P.M.

### LEGEND

- Date of Survey: January, 2007
- ▲ = Section Corner Monument Found
- ⊙ = Found Survey Monument
- See annotation
- X = Set "4" cut
- (CM) = Calculated from measured
- (M) = Measured
- (P) = Platted
- (D) = Described
- 1 = Lot Number
- ⑦ = Block Number

GREGORY J. ALLIARD  
LICENSED  
LS-1267  
SURVEYOR  
4/17/07

**MKEC**  
ENGINEERING  
CONSULTANTS, INC.

411 N. WEBB ROAD  
WICHITA, KS. 67206  
316-684-9600