



Wichita-Sedgwick County Metropolitan Area Planning Department

April 21, 2008

Mennonite Housing c/o Lou Confessori
2154 N Topeka
Wichita, KS 67214

Re: BZA2008-15: Zoning Adjustment to reduce the street side setback by 20% from 15 feet to 12 feet in TF-3 zoning for a single-family residence.

Lots 141 and north 20 feet Lot 143, Tyler now Grove Logan Addition, Sedgwick County, Kansas. Generally located west of Grove and south of 14th Street North (1457 N. Grove).

Dear Applicant,

We have reviewed your request for a Zoning Adjustment to reduce the street side setback for a residence on the aforementioned property. From reviewing the application, we understand that you desire to construct a residence within 12 feet of the side property line, a 3 foot encroachment into the required 15 foot street side building setback for the TF-3 zoning district. Therefore, you have requested an adjustment to reduce the required setback.

Section V-I.2.c. of the Unified Zoning Code allows the side setback to be reduced by 20% when the provisions of that section and the Zoning Adjustment Criteria of Section V-I.6. are met. We find that the reduction of the side setback as proposed meets the provisions of Section V-I.2.a. and the four criteria required by Section V-1.6. as set out below:

- 1) Impact on safety and convenience of vehicular and pedestrian circulation: The setback encroachment should have no impact on the safety and convenience of vehicular and pedestrian circulation in the vicinity as no public right-of-way is affected, nor is traffic visibility affected.
- 2) Impact on existing uses in surrounding areas: There should be no negative impact on the existing uses in surrounding areas as a result of the setback reduction, provided that sufficient separation between buildings is maintained. The side setback reduction is within allowable limits.
- 3) Compatibility with existing or permitted uses on abutting sites: The proposed residence is compatible with existing and permitted uses on abutting sites; the encroachment into the street side setback should not reduce compatibility with abutting and adjacent sites.
- 4) Effect on public health, safety or welfare: There will be no encroachment into public utility easements or right-of-way. Therefore, there should be no negative impact on the

City Hall • 10th Floor • 455 North Main • Wichita, Kansas 67202-1688

T 316.268.4421 F 316.268.4390

www.wichita.gov

public health, safety or welfare nor will properties or improvements in the vicinity be materially injured.

Our signatures below indicate that a Zoning Adjustment to reduce the street side setback for the aforementioned property from 15 feet to 12 feet is hereby granted, subject to the following conditions:

- 1) The site shall be developed in general conformance with the approved site plan.
- 2) The site shall be developed in conformance with all applicable codes, including but not limited to building, fire, and health codes.
- 3) The setback reduction shall apply only to the street side setback as illustrated on the approved site plan. All other structures or additions on the subject property shall conform to the setbacks permitted by the Unified Zoning Code unless a separate Zoning Adjustment or Variance is granted.
- 4) If the Zoning Administrator finds that there is a violation of any of the conditions of the Zoning Adjustment, the Zoning Administrator, in addition to enforcing the other remedies set forth in the Unified Zoning Code, may, with the concurrence of the Planning Director, declare that the Zoning Adjustment is null and void.

The "Development Application" sign should now be removed from the property.

John L. Schlegel
Planning Director

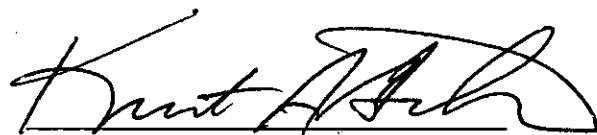
Kurt A. Schroeder
Superintendent of Central Inspection

Enclosure

cc: Kurt Schroeder, OCI
Mike Gable, OCI
Lavonta Williams, District I, mailstop 1-13

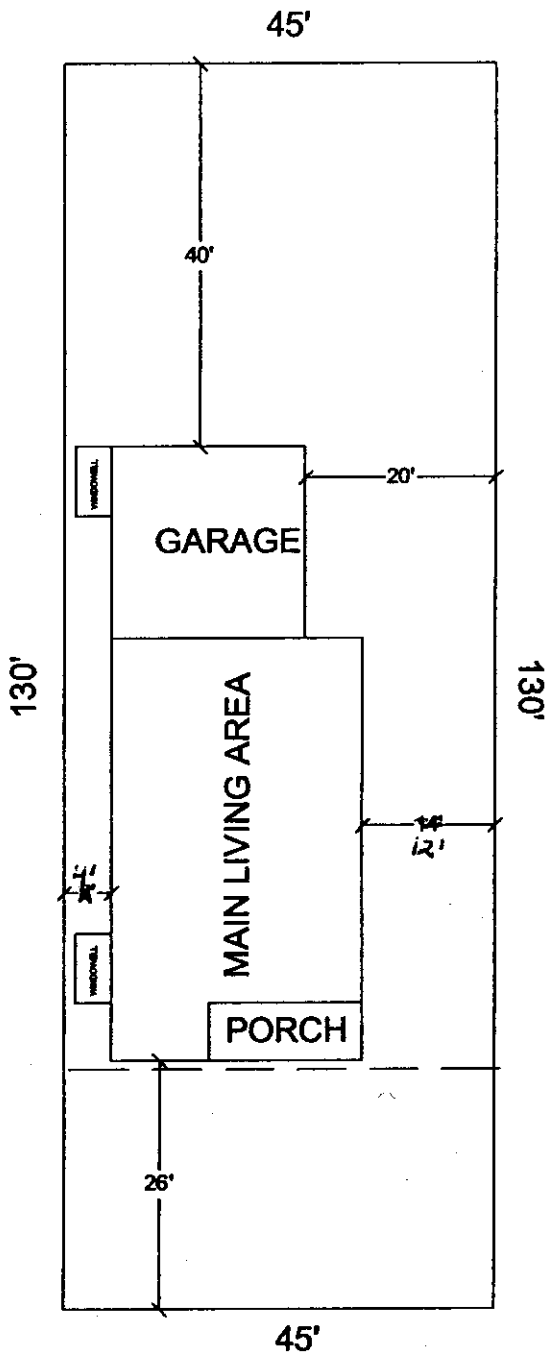

NORTH

APPROVED

STATE PLAN BAA 2008-15

[Handwritten Signature]

Date: 4-21-08

SCALE: 1 INCH = 20 FEET

1457 N. GROVE