



**Wichita-Sedgwick County Metropolitan Area Planning Department**

December 20, 2007

Michael Casamento  
1819 S Meridian  
Wichita, KS 67213

Garrett Addison  
Smith Construction  
PO Box 13213  
Wichita, KS 67213

Re: **BZA2007-73**: Zoning Adjustment to reduce the parking requirement from 36 to 29 spaces, in LI zoning, generally located east of Meridian and south of Esther (1819 S Meridian).

**Legal Description**: Lots 2 and 3 Meridian Industrial Park Addition to Wichita, Sedgwick County, Kansas.

Dear Applicants,

We have reviewed your Zoning Adjustment request to reduce the parking requirement on the above-referenced property. From reviewing your application we understand that you propose to expand the manufacturing facility on the site by 12,865 square feet. Your plan indicates 29 parking spaces, a 20% reduction of the 36 spaces required by the Unified Zoning Code (UZC).

Sec. V-I.2.i. of the Unified Zoning Code allows an adjustment to reduce the parking requirement by up to 25% for additions when the conditions required by Sec. V-I.6. of the Code are met. We find that the reduction of the parking requirement as proposed meets the four conditions required by Sec. V-I.6. of the Code as set out below:

- 1) **Impact on safety and convenience of vehicular and pedestrian circulation**: The proposed reduction in parking requirement should have no detrimental impact on the safety and convenience of vehicular and pedestrian circulation in the vicinity of the application area. Sufficient parking should be available for the anticipated need, and the parking does not interfere with public right-of-way.

- 2) Impact on existing uses in surrounding areas: The proposed reduction in parking should not impact existing uses in surrounding areas, as all parking for this project should be adequately provided on the site.
- 3) Compatibility with existing or permitted uses on abutting sites: A reduction of 20% of the parking requirement should not compromise existing or permitted uses on abutting sites, as all parking for this project should be adequately provided on the site.
- 4) Effect on public health, safety or welfare: There will be no encroachment into public right of way or utility easements; therefore there should be no impact on the public's safety, health or welfare.

Our signatures below indicate that an administrative adjustment to reduce parking by 20%, from 36 to 29 spaces is hereby granted for the aforementioned property subject to the following conditions:

- 1) The site shall be developed in general conformance with the approved site plan.
- 2) All other standards of the Unified Zoning Code shall be met, unless an additional adjustment or variance is approved.
- 3) The parking area shall be paved and marked.
- 4) If the Zoning Administrator finds that there is a violation of any of the conditions of the Zoning Adjustment, the Zoning Administrator, in addition to enforcing the other remedies set forth in the Unified Zoning Code, may, with the concurrence of the Planning Director, declare the Zoning Adjustment null and void.

The "Development Application" sign should now be removed from the property.

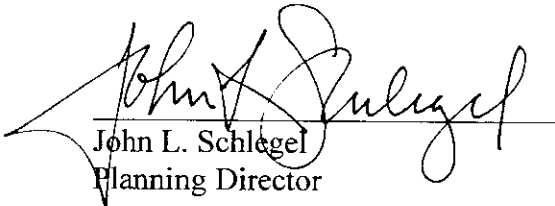
  
John L. Schlegel  
Planning Director

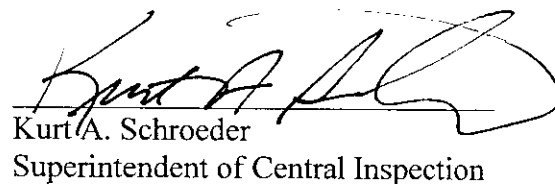
  
Kurt A. Schroeder  
Superintendent of Central Inspection

Enclosure

cc: Kurt Schroeder, OCI  
Paul Hays, OCI  
Paul Gray, WCC IV, Mail Stop 1-13

3214 2007-73

Am. ...

12-20-07

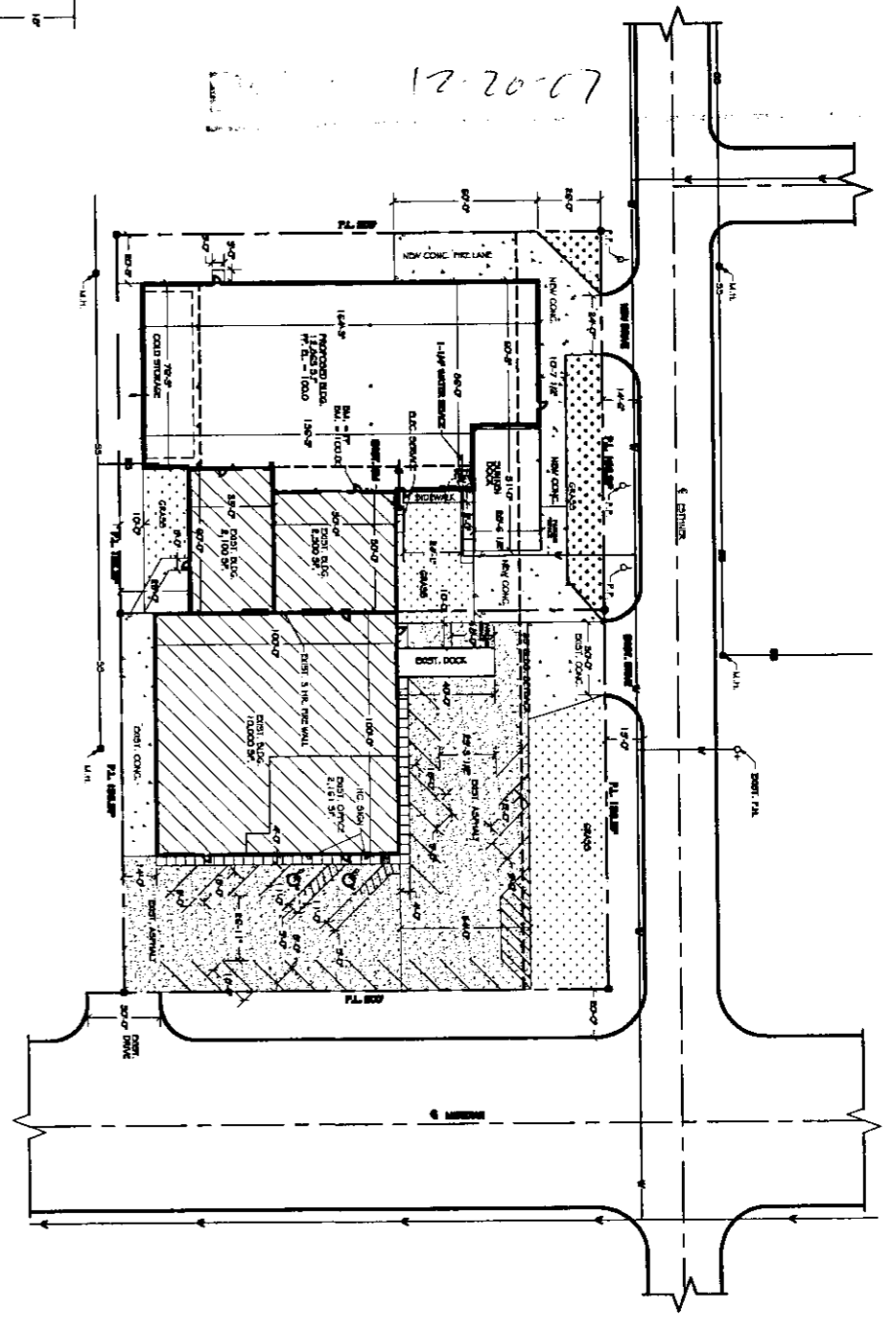
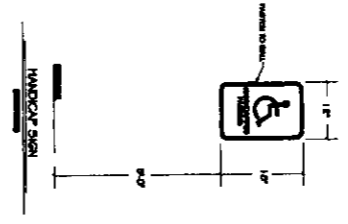

**SITE PLAN**

LEGAL DESCRIPTION:  
PROJECTED MAP, L.A. 444, 20  
APPROVED BY THE BOARD OF SUPERVISORS, COUNTY OF LOS ANGELES, CALIFORNIA, 12/18/07.

SA-1



**BLEND-TECH**  
www.blend-tech.com

**SMITH**  
ARCHITECTS AND ENGINEERS, INC.  
1000 WEST 10TH STREET, SUITE 200  
LOS ANGELES, CA 90015  
TEL: 213-480-1000  
FAX: 213-480-1001  
www.smith-architects.com