

GENERAL NOTES

- THE CONTRACTOR SHALL COMPLY WITH ALL APPLICABLE SAFETY REGULATIONS. ALL CONSTRUCTION SHALL BE COMPLETED FOLLOWING CURRENT CITY STANDARD SPECIFICATIONS AND SPECIAL PROVISIONS.
- CONTRACTOR WILL BE REQUIRED TO PROVIDE NOTICE TO UTILITY COMPANIES A MINIMUM OF SEVENTY-TWO (72) HOURS PRIOR TO ANY EXCAVATION, AS FOLLOWS:

KANSAS ONE-CALL 687-2470

THE CONTRACTOR MUST NOTIFY THE FOLLOWING IN CASE OF AN EMERGENCY:

AT&T	1-316-246-8464
BLACK HILLS ENERGY (GAS)	1-800-694-8989
CITY OF WICHITA WATER & SEWER	1-316-219-8921
CITY OF WICHITA STORMWATER	1-316-268-4090
CITY OF WICHITA TRAFFIC	1-316-268-4034
COX COMMUNICATIONS	1-888-249-3530
KANSAS GAS SERVICE	1-888-482-4950
EVERGY	1-800-544-4857

- UTILITY SERVICE LINES, POLES, ETC. ARE TO BE ADJUSTED AS NECESSARY BY OTHERS PRIOR TO CONSTRUCTION UNLESS THE PLANS SPECIFICALLY CALL FOR THEIR ADJUSTMENT BY THE CONTRACTOR OR UNLESS THE PLANS SPECIFICALLY IDENTIFY A UTILITY TO BE ADJUSTED BY ITS OWNER DURING CONSTRUCTION. EXISTING UTILITIES AND THEIR LOCATION, AS SHOWN ON THE PLANS, REPRESENT THE BEST INFORMATION OBTAINABLE FOR DESIGN. THE CONTRACTOR WILL BE REQUIRED TO WORK AROUND EXISTING UTILITIES WITHIN THE RIGHT-OF-WAY WHICH DO NOT CONFLICT WITH PROPOSED CONSTRUCTION.

- RUBBLE FROM THE REMOVAL OF MISCELLANEOUS STRUCTURES AND EXCESS EXCAVATION WHICH IS TO BE WASTED SHALL BE DISPOSED OF ON SITES TO BE PROVIDED BY THE CONTRACTOR. THESE SITES SHALL BE APPROVED BY THE ENGINEER AS TO SUITABILITY, APPEARANCE AND SITE LOCATION. LOCATIONS, IN THE OPINION OF THE ENGINEER, THAT WILL LEAVE AN UNSIGHTLY APPEARANCE WILL NOT BE APPROVED. ALL DISPOSAL SITES MUST BE APPROVED BY THE KANSAS DEPARTMENT OF HEALTH AND ENVIRONMENT. MATERIAL EITHER STOCKPILED OR DISPOSED OF IN A FLOOD PLAIN WILL REQUIRE A KANSAS STATE BOARD OF AGRICULTURE PERMIT. ANY MATERIAL DUMPED IN WATERS OF THE UNITED STATES OR WETLANDS IS SUBJECT TO U.S. CORPS OF ENGINEERS PERMITTING REGULATIONS. ANY MATERIAL BURIED OR STOCKPILED BEYOND APPROVED CONSTRUCTION LIMITS WILL REQUIRE ADDITIONAL ARCHAEOLOGICAL INVESTIGATIONS UNLESS BURIED IN A PREVIOUSLY APPROVED BORROW LOCATION.

- TREES AND SHRUBS IN PUBLIC RIGHT-OF-WAY WHICH ARE IN DIRECT CONFLICT WITH PROPOSED NEW CONSTRUCTION SHALL BE REMOVED BY THE CONTRACTOR WITH THE CITY ENGINEER'S APPROVAL. TREES AND SHRUBS WHICH ARE NOT IN DIRECT CONFLICT WITH PROPOSED NEW CONSTRUCTION SHALL BE SAVED AND PROTECTED FROM DAMAGE.

- THE CONTRACTOR SHALL GIVE ALL PROPERTY OWNERS AND/OR TENANTS OF DEVELOPED PROPERTY ABUTTING THE CONSTRUCTION OF THIS PROJECT A MINIMUM OF TEN (10) DAYS NOTICE PRIOR TO START OF CONSTRUCTION.

- THE CONTRACTOR SHALL BE RESPONSIBLE FOR PRESERVING PROPERTY IRONS. THE CONTRACTOR WILL BE REQUIRED TO RE-ESTABLISH ANY PROPERTY IRONS WHICH ARE DAMAGED OR DESTROYED BY HIS CONSTRUCTION OPERATIONS. SUCH IRONS SHALL BE RE-ESTABLISHED BY A LICENSED LAND SURVEYOR IN ACCORDANCE WITH STATE LAWS.

- IF TRAFFIC WILL BE IMPACTED BY CONSTRUCTION, A TRAFFIC CONTROL PLAN MUST BE SUBMITTED AND APPROVED BY THE CITY TRAFFIC ENGINEER AT traffic@wichita.gov BEFORE CONSTRUCTION CAN BEGIN. THE CONTRACTOR SHALL BE RESPONSIBLE FOR ALL TRAFFIC CONTROL MEASURES TO FACILITATE CONSTRUCTION. ALL CONSTRUCTION ZONE MARKINGS AND SIGNAGE SHALL CONFORM TO THE LATEST VERSION OF THE MANUAL ON UNIFORM TRAFFIC CONTROL DEVICES (MUTCD) AS PUBLISHED BY THE US DEPT. OF TRANSPORTATION, FEDERAL HIGHWAY ADMINISTRATION. ALL COSTS ASSOCIATED WITH CONSTRUCTION MARKINGS AND SIGNAGE SHALL BE THE CONTRACTOR'S RESPONSIBILITY.

- THE CONTRACTOR SHALL NOTIFY THE INSPECTING ENGINEER AND DAWNITA REINHARDT AT 650-0740 WITH THE CITY OF WICHITA WITH THE ANTICIPATED CONSTRUCTION START DATE AND NOTIFY THEM OF PROJECT COMPLETION, STAKING AND INSPECTION FOR THIS PROJECT WILL BE THE RESPONSIBILITY OF THE CONTRACTOR.

- EXISTING UTILITIES AND THEIR LOCATION, AS SHOWN ON THE PLANS REPRESENT THE BEST INFORMATION OBTAINABLE FOR DESIGN. LOCATION INFORMATION HAS BEEN OBTAINED FROM THE VARIOUS COMPANIES AND IS EITHER FROM COMPANY UTILITY DRAWINGS OR COMPANY PROVIDED FIELD LOCATIONS. THE PLAN LOCATIONS SHOWN ARE NOT GUARANTEED. ADDITIONAL EXISTING UTILITIES MAY ALSO BE ENCOUNTERED.

- ALL TRAFFIC CONTROL DEVICES IN THE WORK ZONE (INCLUDING MARKINGS AND SIGNS) AND THEIR INSTALLATION AND MAINTENANCE SHALL COMPLY WITH THE LATEST EDITION OF THE MANUAL ON UNIFORM TRAFFIC CONTROL DEVICES (MUTCD). ALL TRAFFIC CONTROL DEVICES IN THE TRAVELED WAY OR CLEAR ZONE SHALL BE CRASHWORTHY (NCHRP REPORT 350 OR MASH COMPLIANT).
https://safety.fhwa.dot.gov/roadway_dept/countermeasures/reduce_crash_severity/

- ALL CONSTRUCTION EQUIPMENT, INCLUDING VEHICLES, MATERIALS, AND DEBRIS, SHALL BE STORED OUTSIDE OF THE CLEAR ZONE. WHERE THIS CANNOT BE ACHIEVED THE CONTRACTOR SHALL PLACE APPROPRIATE SIGNS, OBJECT IDENTIFIERS, AND/OR BARRICADES IN COMPLIANCE WITH MUTCD.

- EXCEPT WHEN REQUIRED FOR SAFETY, TRAFFIC CONTROL SHALL NOT BLOCK ANY LANES OR SIDEWALKS WHEN WORK IS NOT BEING PERFORMED.

- DETECTABLE WARNING PAVERS ARE SUBSIDIARY TO "CONCRETE SIDEWALK 8".

- SIDEWALK GRADES SHALL MATCH EXISTING SIDEWALKS AND EXISTING RAILROAD CROSSING PANELS. SIDEWALK SLOPES SHALL NOT EXCEED 5% GRADE. SIDEWALK CROSS SLOPE SHALL NOT EXCEED 2% GRADE.

- PLACE WALKWAY BALLAST IN A MANNER THAT DOES NOT CREATE PONDING. BALLAST BID AS "CRUSHED ROCK HOOKUP". PLAN QUANTITY OF BALLAST IS BASED ON THE SQUARE YARDAGE SHOWN IN THE PLANS.

- A TWO-FOOT WIDE ASPHALT STRIP SHALL BE CONSTRUCTED BETWEEN CONSTRUCTED SIDEWALK AND RAILROAD CROSSING PANELS AS SHOWN. ASPHALT STRIPS SHALL BE 8" THICK AND SHALL USE PG 64-22 ASPHALT CEMENT FOR THE FULL THICKNESS WITH BC-1 AND SC-1 MIX DESIGNS FOR BASE AND SURFACE ASPHALT, RESPECTIVELY. THE CONTRACTOR MAY SUBSTITUTE AN ALTERNATIVE GRADE OF ASPHALT THAT COMPLIES WITH OR EXCEEDS THE UPPER AND LOWER GRADE DESIGNATION FOR THE GRADE SPECIFIED. SUCH SUBSTITUTIONS REQUIRE ADVANCED APPROVAL BY THE ENGINEER AND ANY ADDITIONAL COST WILL BE THE RESPONSIBILITY OF THE CONTRACTOR.

- CONTRACTOR SHALL COORDINATE WITH UPRR, BNSF AND WTARR AND ATTAIN ALL APPLICABLE RIGHT-OF-ENTRY AGREEMENTS AND ATTAIN NECESSARY INSURANCE AS REQUIRED BY THE RAILROADS.

RECAPITULATION OF QUANTITIES		
BID ITEM DESCRIPTION	QUANTITY	UNIT
SITE CLEARING	1	LS
CONSTRUCTION STAKING	1	LS
CONCRETE SIDEWALK 8"	1223	SF
AC PAVEMENT 8"	16	SY
CRUSHED ROCK HOOKUP	251	SY
MH ADJUSTED	1	EA
BMP BACK OF CURB PROTECTION	152	LF
TRAFFIC CONTROL	1	LS
SITE RESTORATION	1	LS

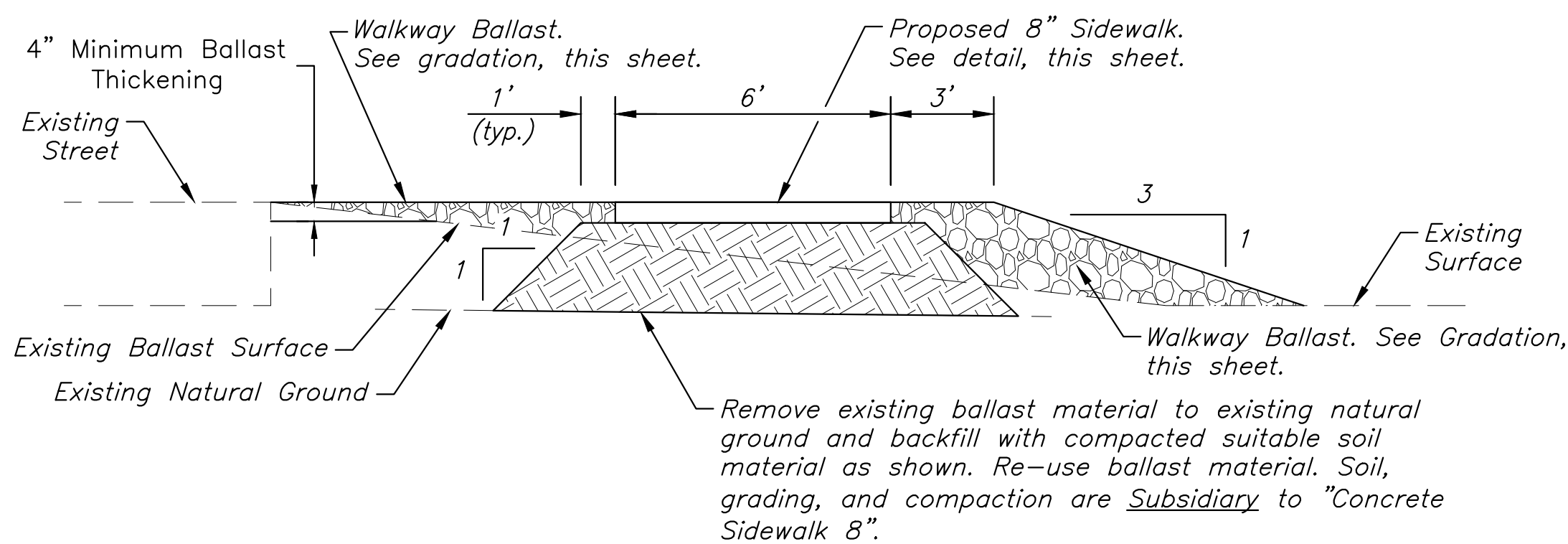

SIDEWALK SECTION

NOMINAL BALLAST SIZE PERCENT PASSING (BY WEIGHT)											
SIZE NO.	SQ. OPENING	2 1/2"	2"	1 3/4"	1 1/2"	1 1/4"	1"	3/4"	1/2"	3/8"	NO. 4
CLASS 2	1"-3/8"				100		90-100	40-75	15-35	0-15	0-5

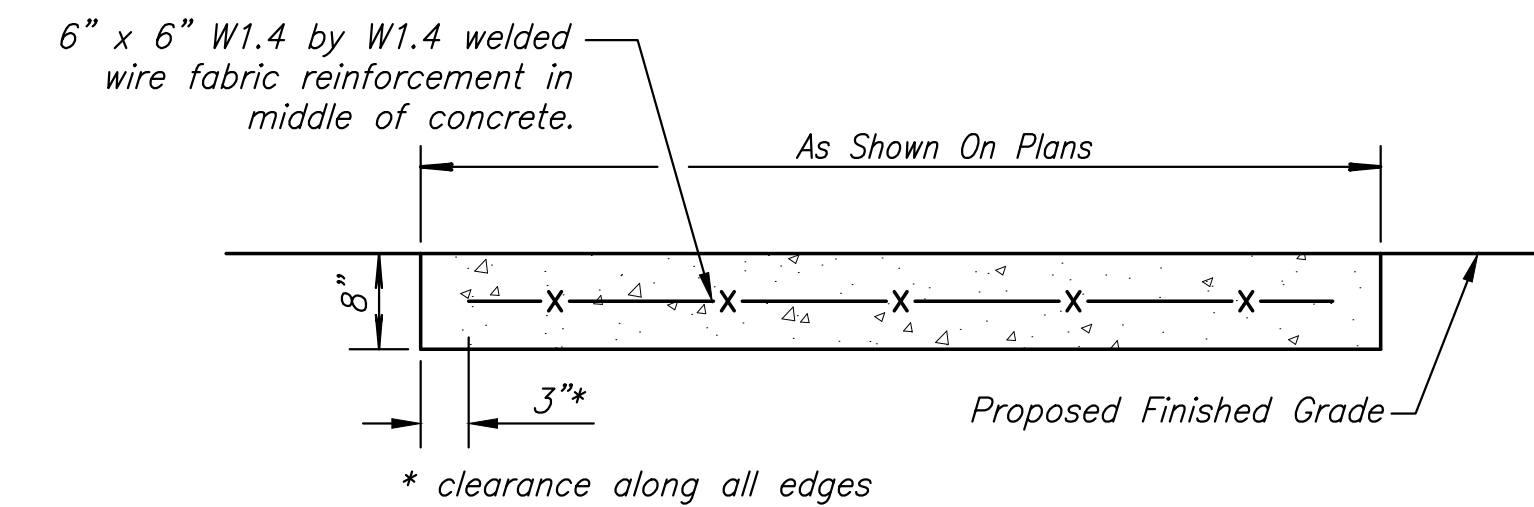

CONCRETE SIDEWALK 8" (REINF.)

Reinforcing is subsidiary to "Concrete Sidewalk 8" (Reinf.)"

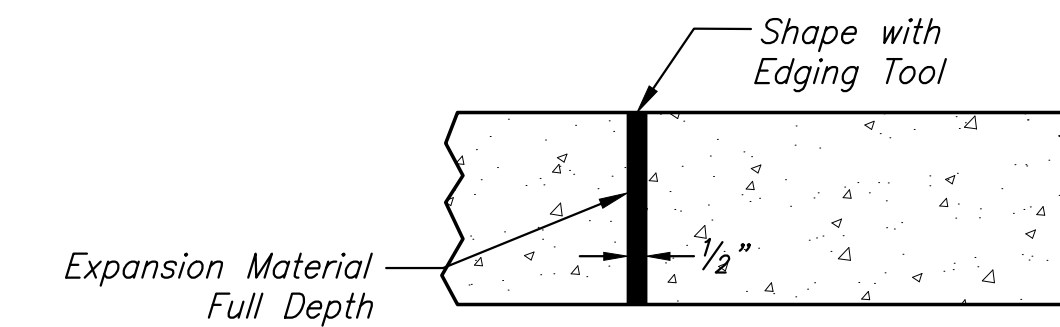

EXPANSION JOINT (E.J.)

Note: When sidewalks of varying thickness abut against each other, add expansion joint material.

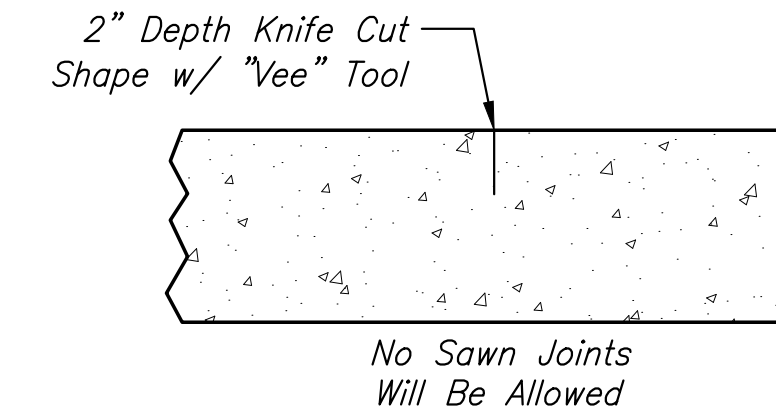

CONTRACTION JOINT (C.J.)

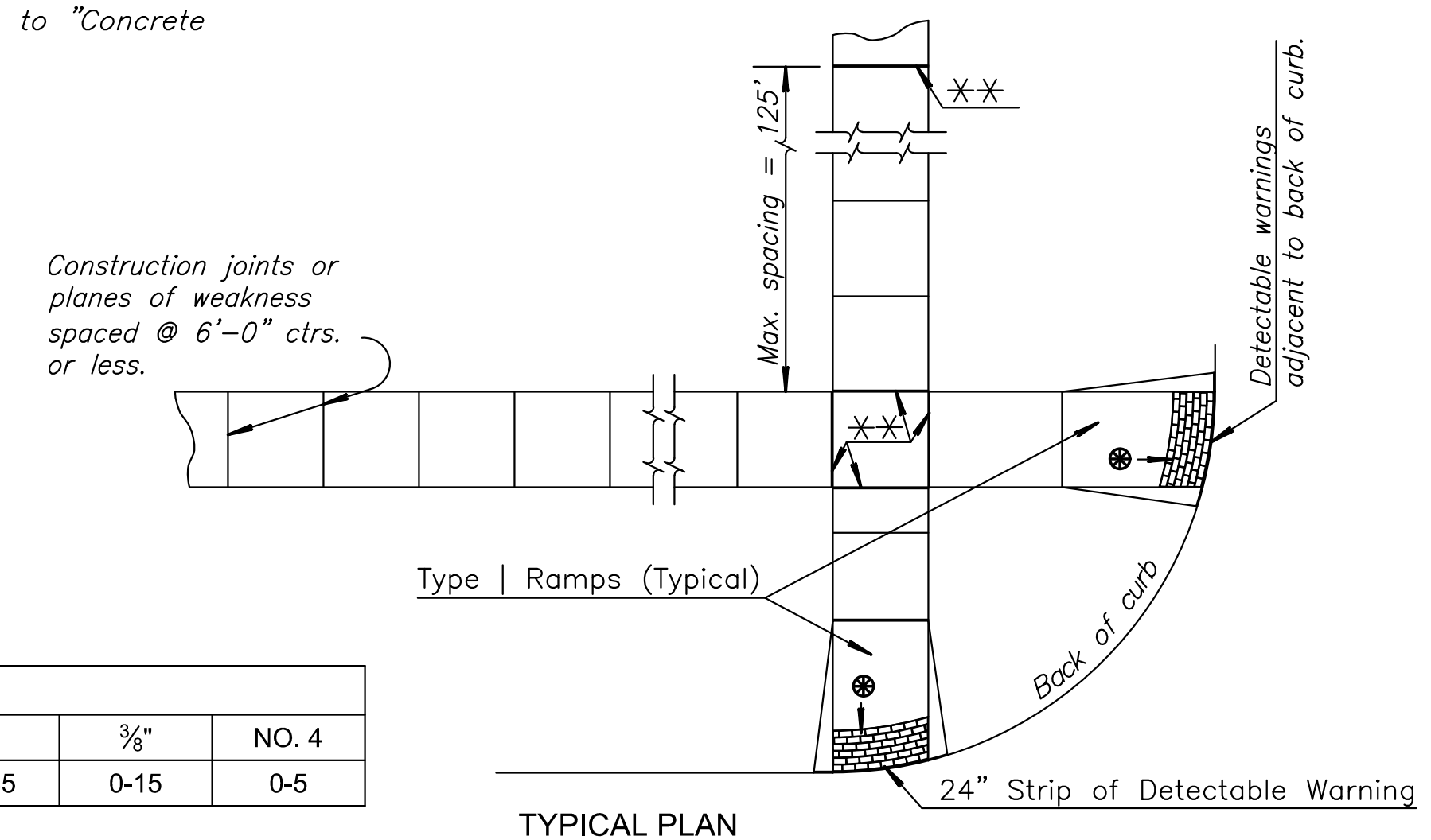

TYPICAL PLAN

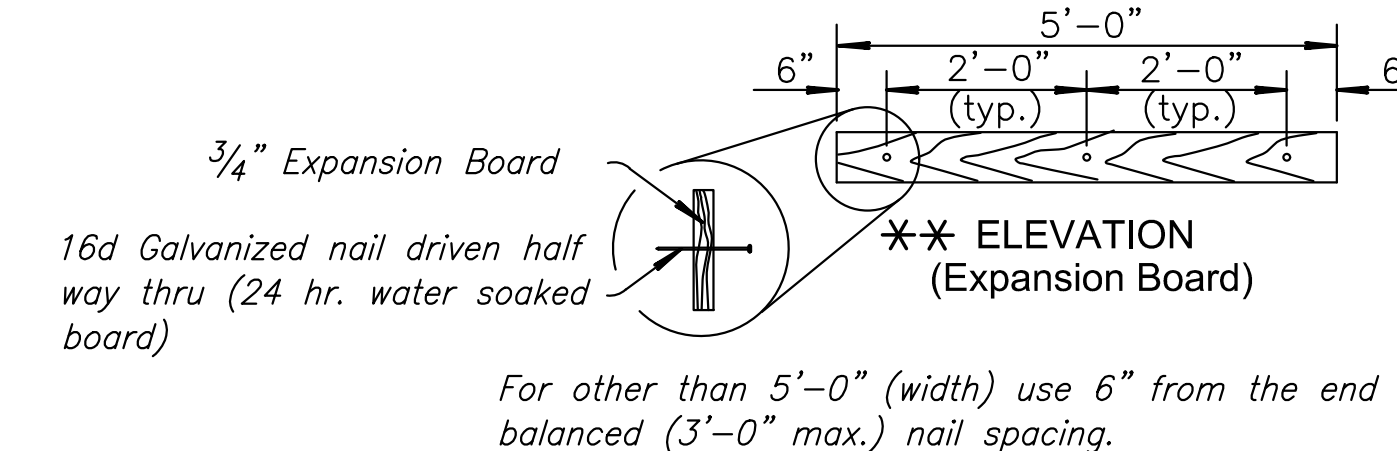

** ELEVATION (Expansion Board)

For other than 5'-0" (width) use 6" from the end and balanced (3'-0" max.) nail spacing.

** Expansion joint (3/4" board) located as shown.

⊗ Detectable warning installation is typical and required on Sidewalk Ramps Type 1, Type 2, Type 3, median ramp crossings and other locations as shown in the plans. See plan and ramp detail sheet.

TYPICAL SIDEWALK PLAN AND DETAILS



PAVING PLANS FOR
17TH STREET SIDEWALK AT RR CROSSING 009266P
WICHITA, KANSAS

GENERAL NOTES

PROJECT NO.

472-2025-086149

SCALE

NTS

DRAWN DESIGNED CHECKED

RAM JRA

NO. REVISION DATE

SHEET NO.

2 OF 16