

# LATERAL 10, MAIN 7 OF THE NORTHWEST INTERCEPTOR SEWER IN THE CITY OF WICHITA

OCA NO. 744219  
CITY OF WICHITA PROJECT NO. 468-83882  
JAMES L. ARMOUR, P.E. - CITY ENGINEER

**INDEX OF SHEETS**

SHEET NO. 1	TITLE SHEET
SHEET NO. 2	KEY MAP AND GENERAL NOTES
SHEET NO. 3	PLAT
SHEET NO. 4-6	PLAN/PROFILE
SHEET NO. 7	TYPE "P" MANHOLE DETAILS
SHEET NO. 8	FRAME & COVER DETAILS
SHEET NO. 9	RISER DETAILS
SHEET NO. 10	MANHOLE ADJUSTMENT DETAILS
SHEET NO. 11-14	SOIL EROSION BMP DETAILS

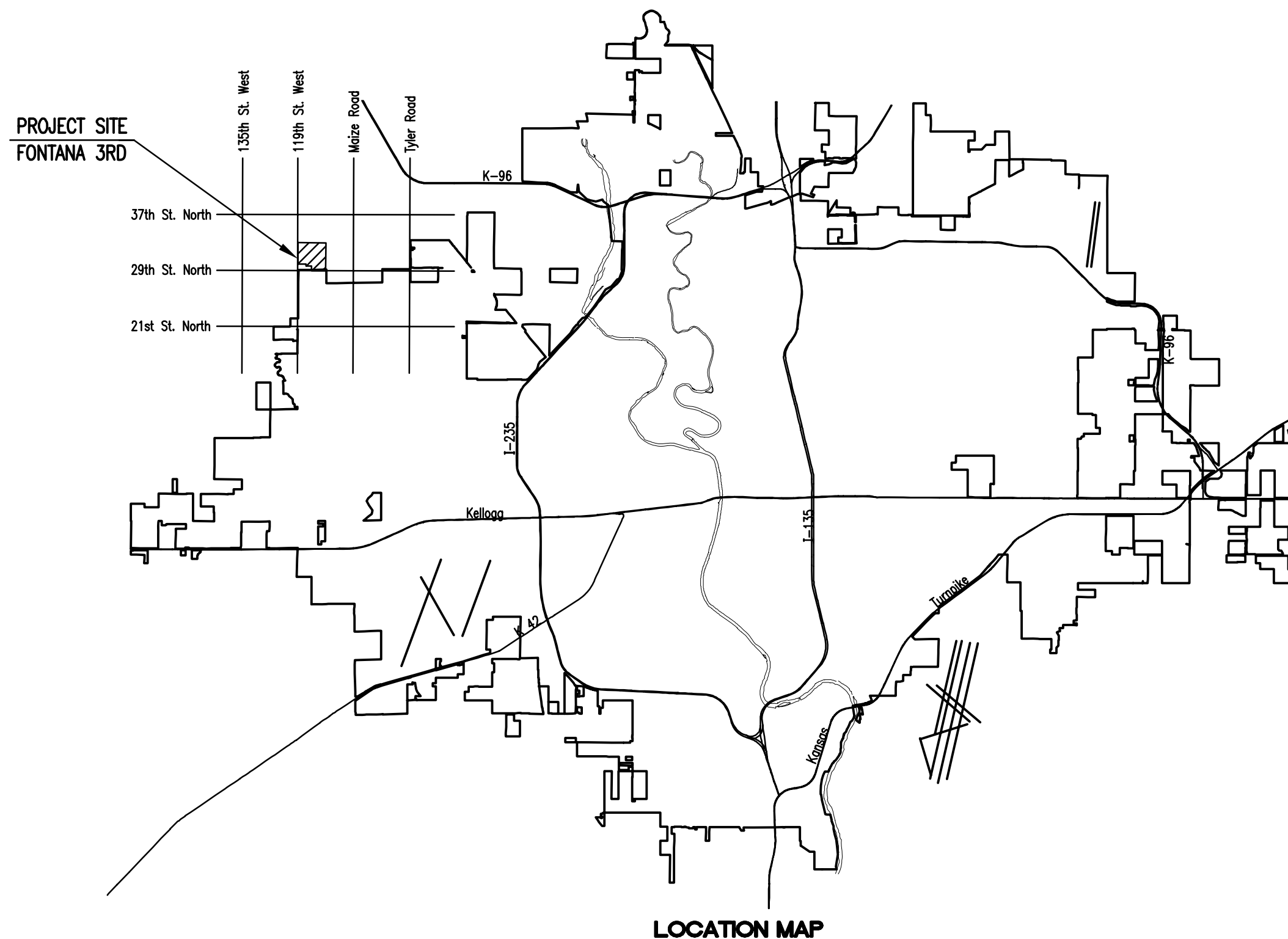

LOCATION MAP

**McCullough Excavation, Inc. - Contractor**  
**Weigant, City - Inspector**  
 Released 8/2/07  
 As-Built  
 Risers  
 .pdf by JDL 9/19/07

**CONSTRUCTION SCHEDULE/SEQUENCE**

THE CONTRACTOR FOR EACH OF THE FOLLOWING FONTANA 3RD PROJECTS SHALL COORDINATE THEIR EFFORTS WITH OTHER CONTRACTORS PERFORMING WORK IN THIS AREA SUCH THAT ANY NECESSARY SIMULTANEOUS CONSTRUCTION CAN PROCEED CONCURRENTLY WITHOUT CAUSING UNDUE DELAYS SO THAT CONSTRUCTION CAN BE COMPLETED WITHIN THE TIME FRAMES AS NOTED.

**SANITARY SEWER (468-83882)**  
THE CONTRACTOR SHALL COMPLETE LINE NO. 1 IN ITS ENTIRETY PRIOR TO COMMENCING WITH WORK ON THE REMAINDER OF THE PROJECT. THE CONTRACTOR SHALL SEQUENCE HIS WORK TO COMPLETE, INCLUDING TESTING AND ACCEPTANCE, BY MAY 23, 2007.

**WATER DISTRIBUTION SYSTEM (448-90004)**  
THE CONTRACTOR SHALL COMPLETE FONTANA 3RD WATERLINE CONSTRUCTION BY JUNE 6, 2007. THE CONTRACTOR SHALL COORDINATE INSTALLATION OF WATERLINES WITH THE STORM WATER DRAIN AND PAVING CONTRACTOR SO THAT STORM SEWERS CROSSING BELOW PROPOSED WATERLINES WILL BE INSTALLED PRIOR TO WATERLINE CONSTRUCTION. THE CONTRACTOR SHALL COORDINATE HIS WORK EFFORTS WITH THE CONTRACTOR FOR THE WATER SUPPLY LINE (BY OTHERS) FOR CONNECTION TO THE SUPPLY LINE AND BLOWING OFF/TESTING OF THE PROPOSED WATERLINES.

**STREETS/DRAINAGE (472-84091)**  
THE CONTRACTOR SHALL COMPLETE FONTANA 3RD STREETS/DRAINAGE CONSTRUCTION BY JULY 6, 2007.

## MARCH 2007

PLANS PREPARED BY  
**PROFESSIONAL ENGINEERING CONSULTANTS, P.A.**  
ENGINEERS  
WICHITA, KANSAS