

STREET IMPROVEMENTS FOR

FAIRVIEW

N. L. 25TH ST. NO. TO S.L. 26TH ST. NO.

PROJECT NO. 472-76-245-81322-000-000-001

GENERAL NOTES

1. CONTRACTOR TO CONTACT KANSAS ONE CALL AND SOUTHWESTERN BELL TELEPHONE COMPANY FOR ANY UNDERGROUND UTILITY LOCATIONS AND ALSO TO VERIFY THE SERVICE LINE LOCATIONS WHICH CROSS THE STREET.
2. THE CONTRACTOR SHALL CONTACT THE WATER DEPARTMENT TO COORDINATE THE RELOCATION OF THE WATER CANS AND METERS TO CLEAR THE PROPOSED PAVEMENT ALIGNMENT.
3. MAILBOXES WITHIN THE LIMITS OF THIS PROJECT SHALL BE REMOVED AND REPLACED BY THE CONTRACTOR OF THIS PROJECT AS APPROVED BY THE ENGINEER. THE CONTRACTOR SHALL BE REQUIRED TO MAKE SATISFACTORY ARRANGEMENTS FOR MAIL DELIVERY TO THE PROPERTIES AFFECTED BY THE CONSTRUCTION OF THIS PROJECT.
4. THE COST OF ENTRANCE PIPE HEADWALL REMOVAL SHALL BE INCIDENTAL TO THE BID ITEM "PIPE REMOVED".
5. FENCE REMAINING IN PUBLIC RIGHT-OF-WAY AT THE TIME OF CONSTRUCTION SHALL BE REMOVED AND SALVAGED BY CONTRACTOR AND GIVEN TO THE ADJACENT PROPERTY OWNERS. IN THE EVENT THAT THE PROPERTY OWNER DOES NOT WANT THE FENCE MATERIAL, THE CONTRACTOR SHALL DISPOSE OF SAME IN A MANNER ACCEPTABLE TO THE FIELD ENGINEER. CONTRACTOR SHALL NOTIFY PROPERTY OWNER FORTY-EIGHT (48) HOURS IN ADVANCE OF ANY FENCE REMOVAL.



26TH ST.		No.	
46	45	46	
48	47	48	
50	49	50	
52	51	52	
54	53	54	
56	55	56	
58	57	58	
60	59	60	
62	61	62	
64	63	64	
66	65	66	
68	67	68	
70	69	70	
72	71	72	
74	73	74	
76	75	76	
78	77	78	
80	79	80	
82	81	82	
84	83	84	
86	85	86	
88	87	88	
90	89	90	
92	91	92	
94	93	94	
96	95	96	
25TH ST.		No.	

BENEFIT DISTRICT

BENCH MARKS
 B.M. Elev. 127.63 City Standard Disc 40' S. & 32' W. of CL of Arkansas & 25th St. No.
 B.M. Elev. 123.49 'x' cut in pavement at the CL of Fairview and 25th St. No.

CITY OF WICHITA, KS.
MIKE E. LINDEBAK CITY ENGINEER

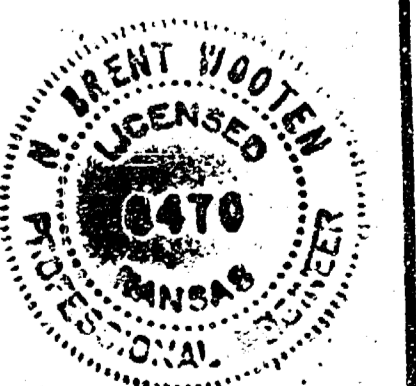

APRIL 1985

TYPICAL 3' PAVEMENT DETAILS

TRANSVERSE SECTION

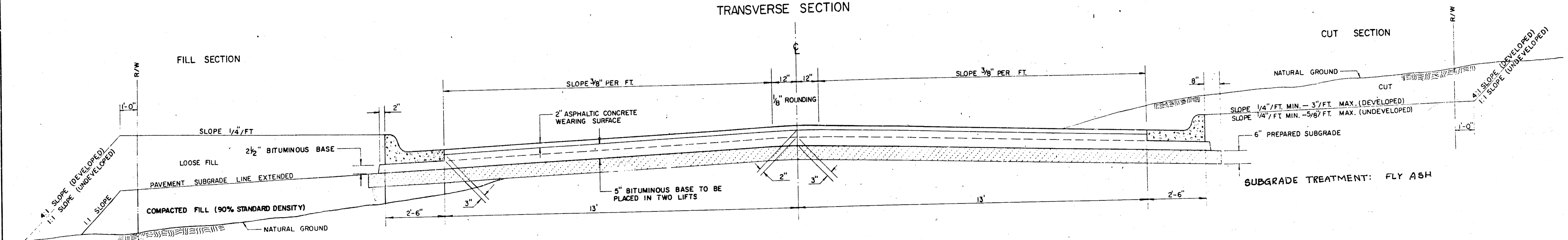

ELEVATION OFFSETS

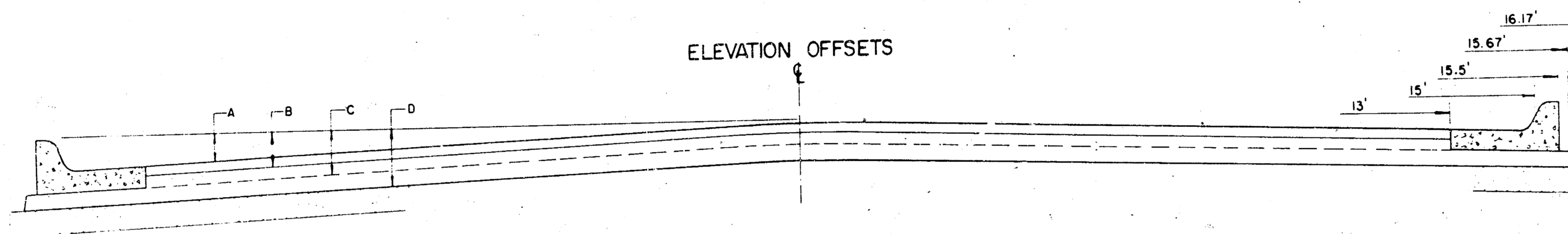

	DISTANCE FROM CENTERLINE (LT. & RT.)											
	0'	2'	4'	6'	7.5'	10'	12'	13'	15'	15.5'	15.67'	16.17'
A: TOP OF CURBS TO TOP OF SURFACE LIFT	0.10	0.14	0.21	0.27	0.32	0.39	0.46	0.49	—	—	—	—
B: TOP OF CURBS TO TOP OF UPPER BASE LIFT	0.27	0.31	0.38	0.44	0.49	0.56	0.63	0.66	—	—	—	—
C: TOP OF CURBS TO TOP OF LOWER BASE LIFT	0.44	0.49	0.57	0.64	0.70	0.79	0.87	0.90	0.98	1.00	1.00	—
D: TOP OF CURBS TO TOP OF SUBGRADE	0.69	0.73	0.80	0.87	0.93	1.01	1.08	1.12	1.19	1.21	1.21	1.23

COMBINED CURB & GUTTER

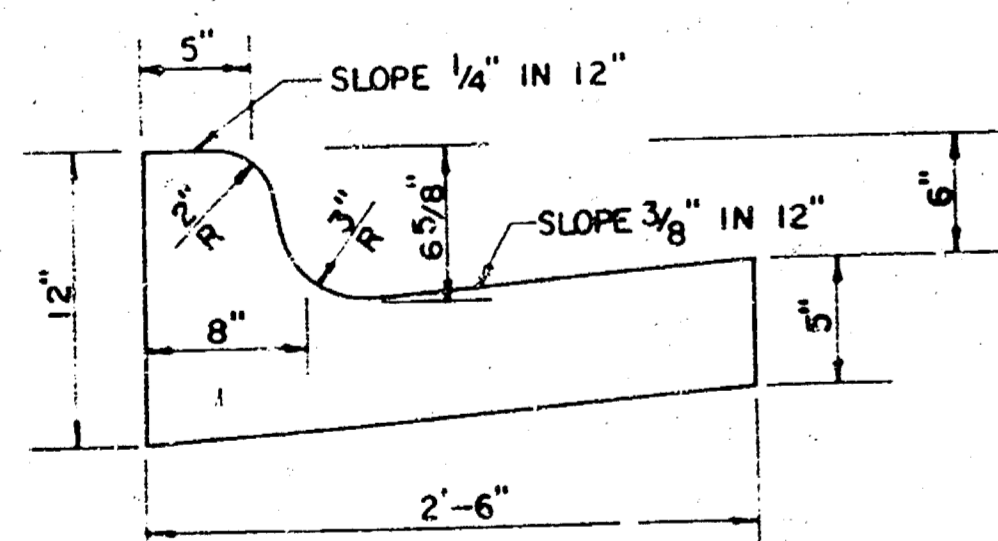

GENERAL NOTES

- 1) THE ASPHALTIC CONCRETE PAVEMENT BETWEEN THE COMBINED CURB AND GUTTER SHALL BE PAID AS SQUARE YARDS OF 7" ASPHALTIC CONCRETE (5" BITUMINOUS BASE).
- 2) THE BITUMINOUS BASE UNDER AND BEHIND THE COMBINED CURB AND GUTTER SHALL BE PAID AS SQUARE YARDS OF 2 1/2" BITUMINOUS BASE.
- 3) A TACK COAT OF EMULSIFIED ASPHALT (SC-1H OR CSS-1H) SHALL BE APPLIED AT AN APPROXIMATE RATE OF 0.05 GALLONS PER SQUARE YARD BETWEEN EACH LIFT OF ASPHALTIC MATERIAL.
- 4) BITUMINOUS BASE AND ASPHALTIC CONCRETE WEARING SURFACE SHALL BE PLACED WITH A LAYDOWN MACHINE HAVING AUTOMATIC CONTROLS FOR LINE AND GRADE.
- 5) CONSTRUCTION JOINTS IN EACH LIFT SHALL BE STAGGERED A MINIMUM DISTANCE OF ONE (1) FOOT FROM JOINTS IN PRECEDING LIFTS AND PLACED SO THAT A JOINT WILL BE CONSTRUCTED ON THE CENTERLINE OF THE TOP LIFT.
- 6) CONTRACTOR TO BID ONLY ONE SUBGRADE TREATMENT ALTERNATE WHEN ALTERNATES ARE PROVIDED IN THE PROPOSAL AND CONTRACT. THE ALTERNATE CHOSEN BY THE SUCCESSFUL BIDDER SHALL BE USED IN CONSTRUCTING THIS PROJECT.

TRANSVERSE CONSTRUCTION JOINTS

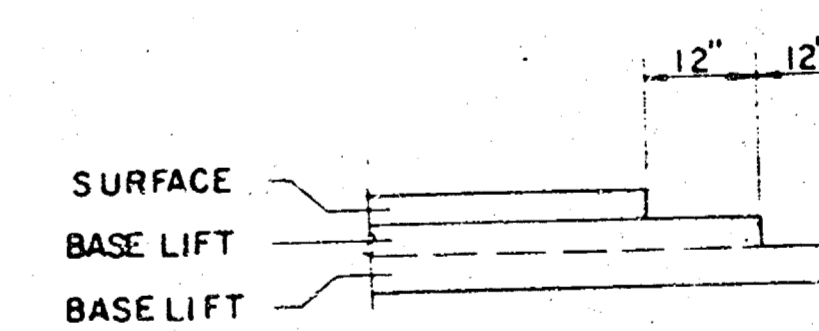

TRANSVERSE CONSTRUCTION JOINTS SHALL BE CONSTRUCTED AT THE EXISTING CURB AND GUTTER AND AT THE EXISTING CURB AND GUTTER. ALL COSTS ASSOCIATED WITH THE CONSTRUCTION OF THE TRANSVERSE JOINT SHALL BE INCLUDED IN THE BID PRICE FOR SQUARE YARDS 7" ASPHALTIC CONCRETE (5" BITUMINOUS BASE).

7 INCH RESIDENTIAL ASPHALTIC CONCRETE PAVEMENT WITH 5 INCH BITUMINOUS BASE
CITY OF WICHITA, KANSAS
 PROJECT NUMBER
472-76-245-81322-000-000-001

BENCH MARK: CITY DISC 40'S AND 30' W
OF 4'S ARKANSAS AND 25TH STREET
NORTH. ELE = 127.63 CITY DATUM

BENCH MARK: "X" CUT AT INTERSECTION OF 4'S
AT 25TH STREET & FAIRVIEW
ELE = 123.49 CITY DATUM

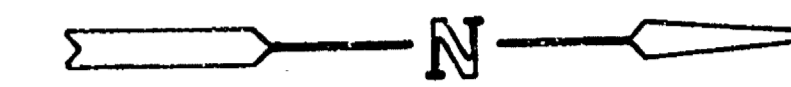

SCALE: 1" = 20'

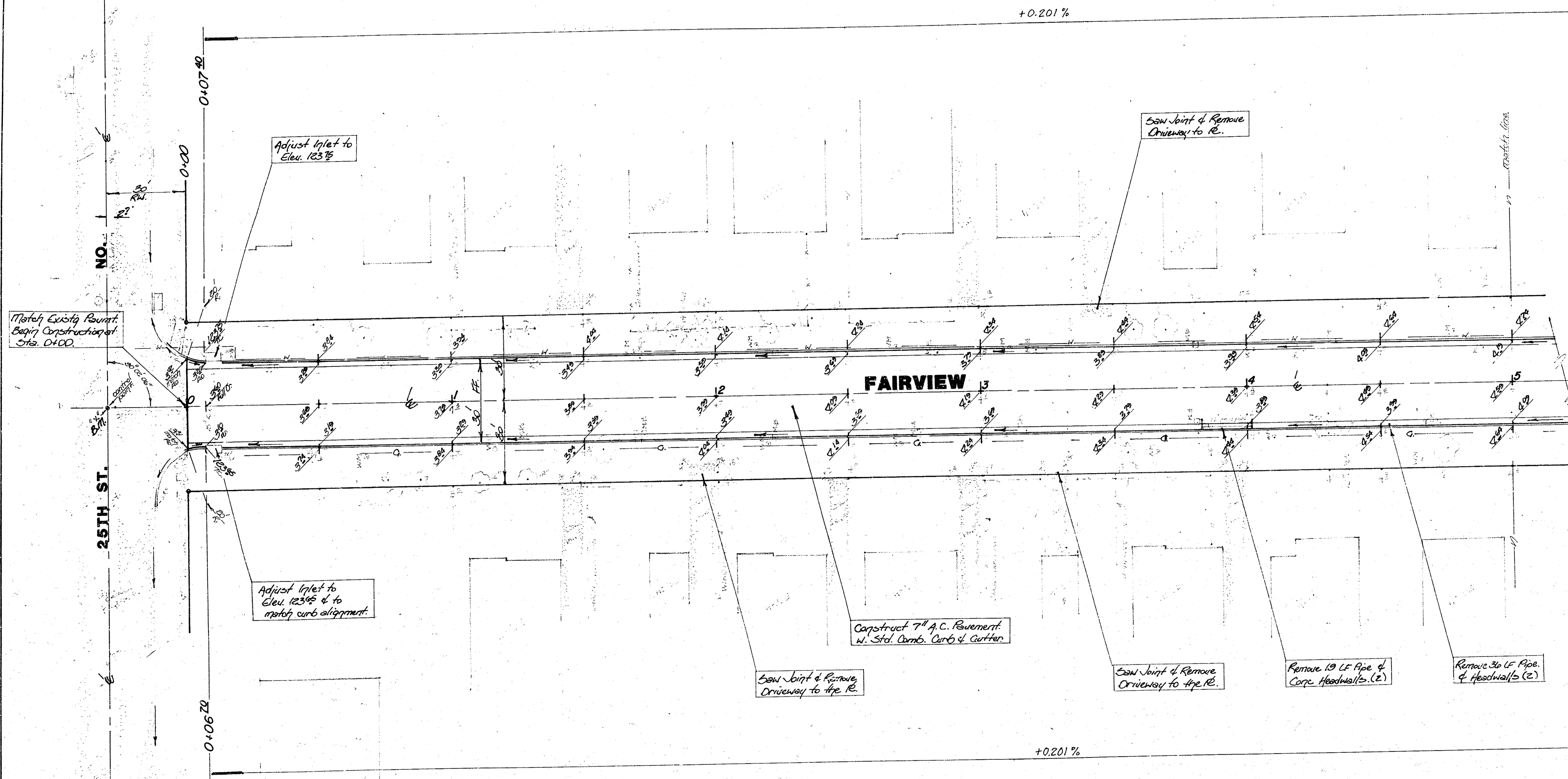

Symbols

- N — Indicates Water Line
- a — Indicates Gas Line
- T — Indicates Telephone Line
- — Indicates Removal

EARTHWORK QUANTITIES

EXCAVATION = 912 CY COMPACTED FILL = 0 CY MANIPULATION = 2156 SY
 +10 s = 91 CY
 TOTAL = 1003 CY

FAIRVIEW

472-76-245-81322-000-000-001

BAUGHMAN COMPANY, P.A.
 SURVEYING & ENGINEERING
 316/262-7271 • 330 LAURA • WICHITA, KANSAS 67211

3/6

BENCH MARK: CITY DEK 40' S. AND 32' W.
OF E'S ARKANSAS AND 25TH STREET
NORTH. ELEV = 127.63 CITY DATUM



SCALE: 1" = 20'

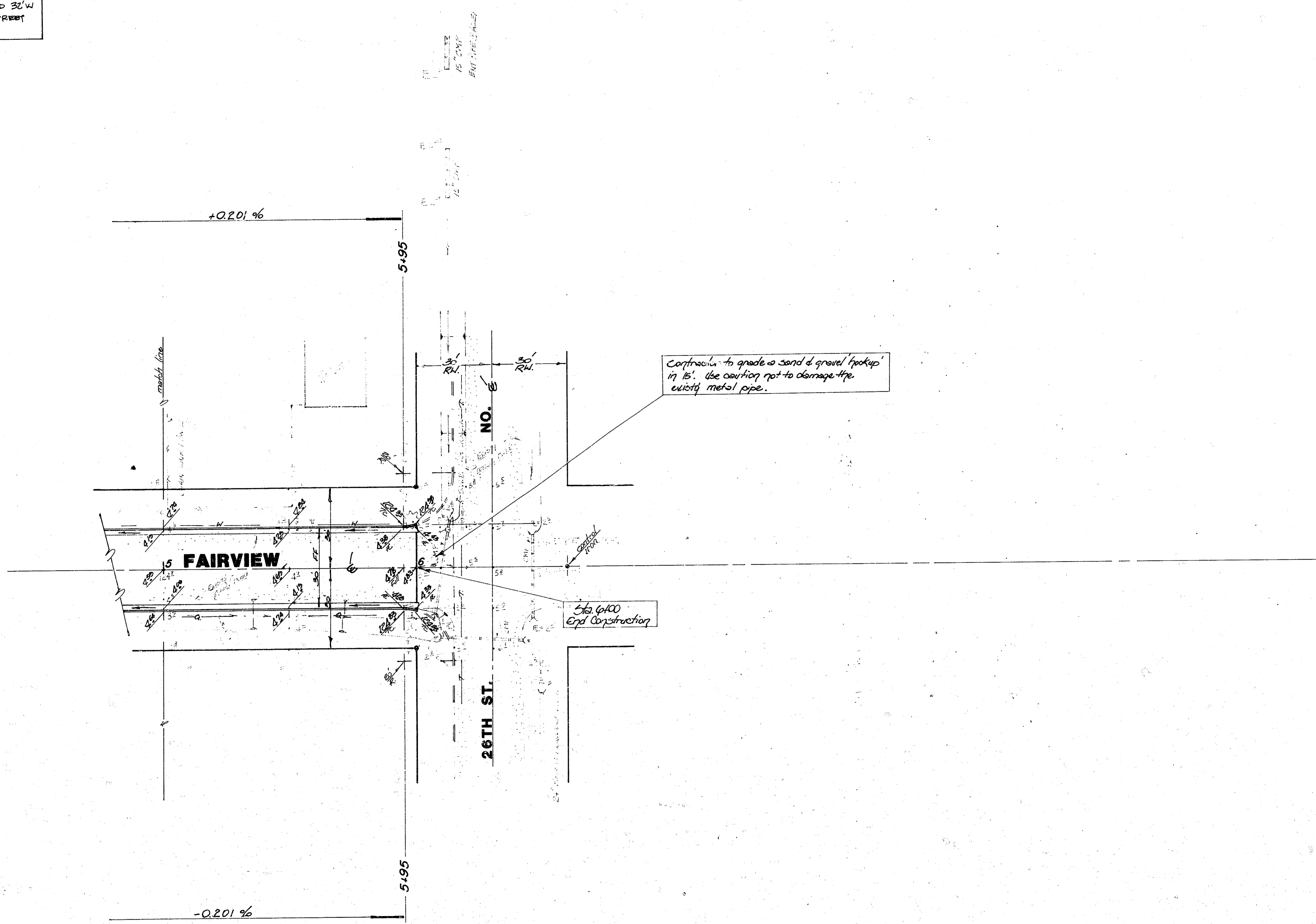

FAIRVIEW
472-76-245-81322-000-000-001

BAUGHMAN COMPANY, P.A.
SURVEYING & ENGINEERING
316/262-7271 • 330 LAURA • WICHITA, KANSAS 67211

125
120
125
120
125
120
125
120

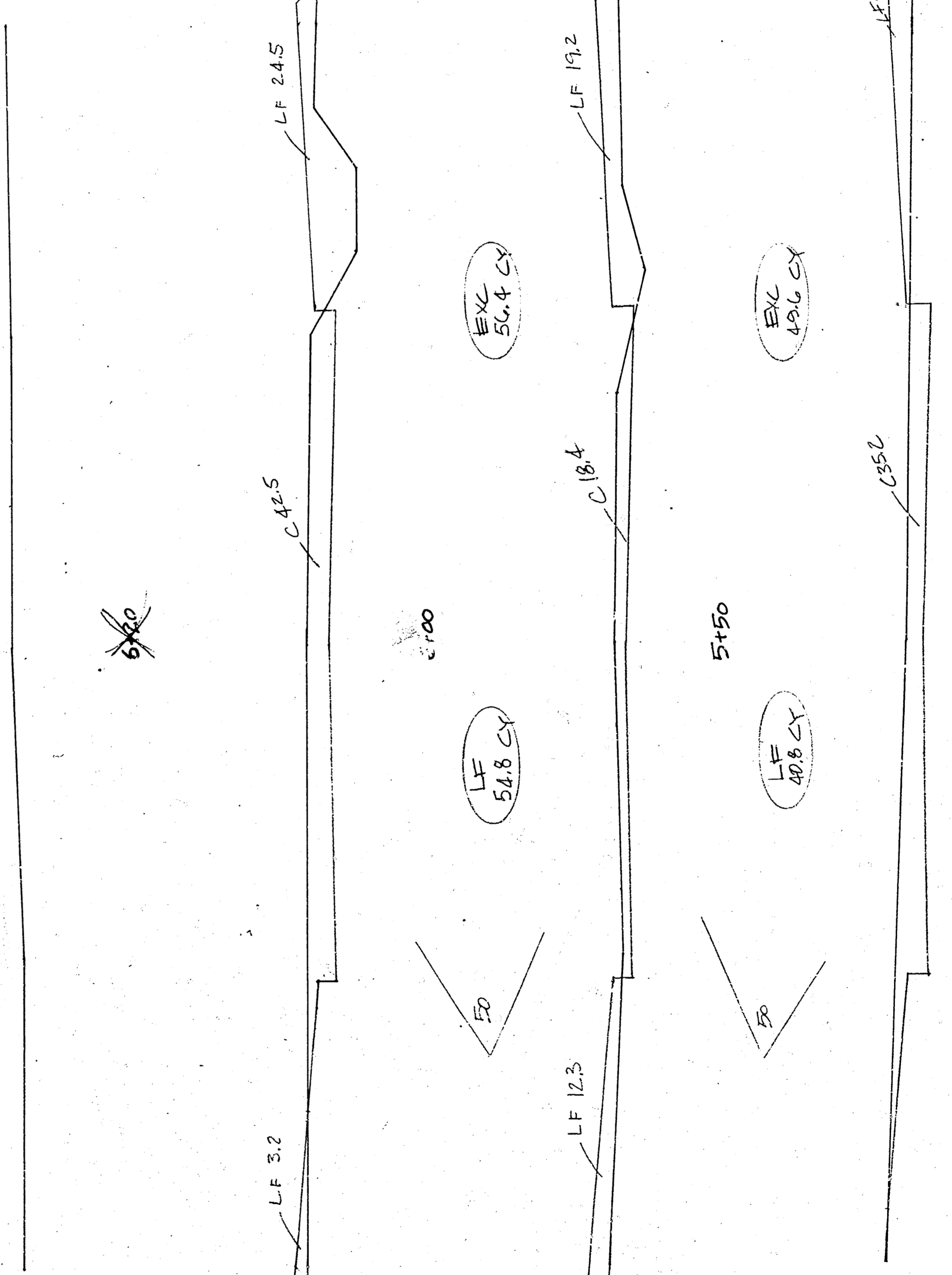

30	20	10	0	10	20	30
RW			±			RW

SHEET TOTALS
 EXC = 173.2 CY
 FILL = 115.5 CY

7/10/19