

B.M. 19876 SW Corner concrete porch
House No. 2228 Farmstead

Note: Contractor to grade parking, clear
right-of-way and compact fill for proposed
sidewalk. Sidewalk to be constructed by others.

Stationing along left
property line.

Scale 1" = 20'

Runway
Exc. 5/10/67
Checked 5/11/67

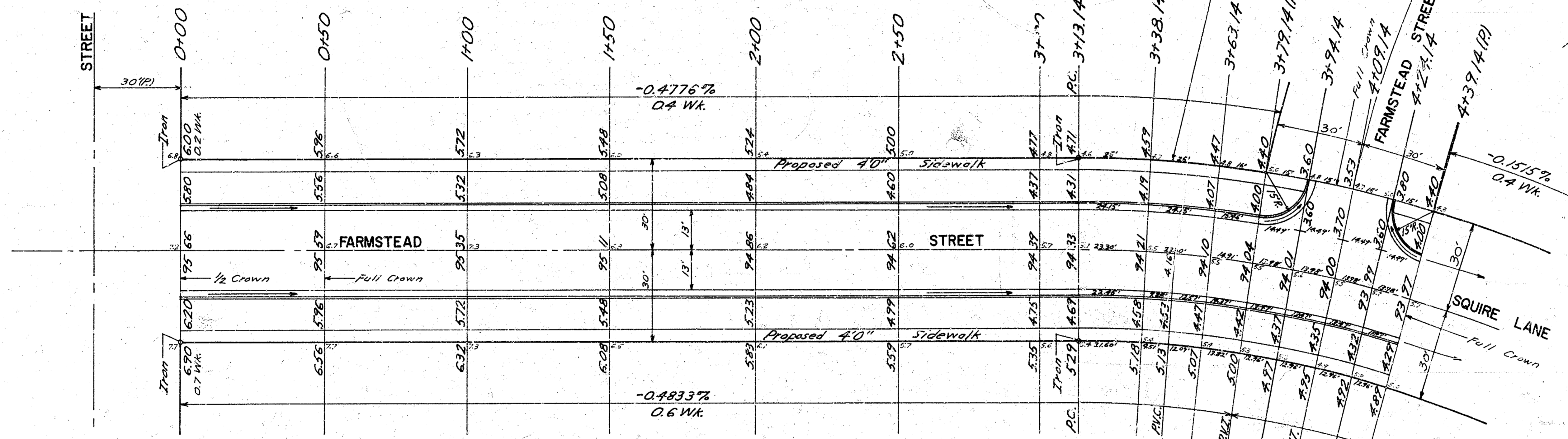

Baseline Curve Data (Left Prop. Line)
PI Sta 0+88.57
Δ = 51°52'30"
R = 441.20'
D = 12.5811"
T = 214.59'
L = 379.46'
375.87 Min./Ft. of Arc 8' offset face left curb.
4.4278 Min./Ft. of Arc 8' offset face right curb.

Station	Deflection Arc	Chord	Arc	Chord
2+73.46 RT.	25°56'15"	23.07'	23.07'	20.64'
2+50	24°24'52"	24.60'	24.60'	22.00'
2+25	22°47'28"	24.60'	24.60'	22.00'
2+00	21°10'04"	24.60'	24.60'	22.00'
1+75	19°32'40"	24.60'	24.60'	22.00'
1+50	17°55'16"	24.60'	24.60'	22.00'
1+25	16°17'52"	24.60'	24.60'	22.00'
1+00	14°40'28"	24.60'	24.60'	22.00'
0+75	13°3'05"	24.60'	24.60'	22.00'
0+50	11°25'41"	24.60'	24.60'	22.00'
0+25	9°48'17"	24.60'	24.60'	22.00'
4+39.14 BLK = 0+00 Ah	8°10'53"	14.76'	14.76'	13.20'
4+24.14	7°12'27"	14.76'	14.76'	13.20'
4+09.14	6°14'00"	14.76'	14.76'	13.20'
3+79.14	5°15'34"	14.76'	14.76'	13.20'
3+49.14	4°17'08"	15.75'	15.75'	14.09'
3+19.14	3°14'48"	13.78'	13.78'	12.32'
3+49.14	2°20'15"	10.83'	10.83'	9.68'
3+38.14	1°37'24"	24.60'	24.60'	22.00'
3+13.14 PC.				

Property	Exc.	Camp. Fill	City
	932 Cu. Yds.	37 Cu. Yds.	92 Cu. Yds.
+10%	93 Cu. Yds.	0.4 Cu. Yds.	9 Cu. Yds.
	1025 Cu. Yds.	4.1 Cu. Yds.	101 Cu. Yds.

FARMSTEAD STREET
N. L. LAMSON STREET TO
W. L. LOT 21, BLK. 3, CRESTVIEW
HEIGHTS 3rd. ADDN.
26-2-30 ASPH. CONC.
B. E. SMITH CITY ENGINEER
CITY OF WICHITA, KANSAS
DATE: July 1967
PROJ. NO. C 19-137

