

B.M. 117.39 8" in Bell Ctr. Wk. No. - 2<sup>nd</sup> Block N. of N.L. Franklin N.W. Cor. Porter & Franklin  
 B.M. 121.19 S.E. Cor. Port. Wall N.W. Cor. Litchfield & Franklin.  
 B.M. 115.61 Standard N.W. Bull. Form & Franklin.  
 37a D.n. &

**NOTE: To Field Eng. & Contractor**  
 All Conc. Base To Be Paid By The Cu. Yds.  
 All Alley Returns & Intersection Porter & Franklin  
 To Be Paid By The Sp. Yds.

Rebuild These Three Catch Basin  
 Openings At Same Location, Using 2'x2'  
 Grate Openings.

Intersection Of Porter & Franklin  
 Remove & Replace Full Intersection  
 & C.V.S. All 4' Radius To Be Rebuilt  
 To 15' Radius. Replace Pavt. With 8" Conc. Pavt.  
 With Int. Curb.

REMOVE EXISTING PVT. & R.R. TIES  
 REPLACE WITH 7" CONC. BASE ON  
 SAND CUSHION 7" GRADE OF  
 EXISTING PVT.

**NOTE TO CONTRACTOR & FIELD ENG.**  
 TILE DRAINS IN EXISTING CB THAT ARE  
 ACTIVE TO BE RELOCATED IN NEW CB. WHERE  
 CB & STR. IS REPLACED.

Sect. Of Street Is Higher Than Gr.  
 Remove & Replace With  
 6" Conc. To Existing Pavt. Grade

Remove & Replace  
 Alley Return With  
 6" Conc. 1' Incl.

Remove & Replace  
 C.V.S. As Shown

To Eliminate Hump At Intersection  
 Remove & Replace With  
 6" Conc. To Existing Pavt. Grade  
 & Surface With Asphalt

Remove & Replace Alley  
 Return With 6" Conc. 1' Incl.

Remove & Replace Alley  
 Return With 6" Conc. 1' Incl.

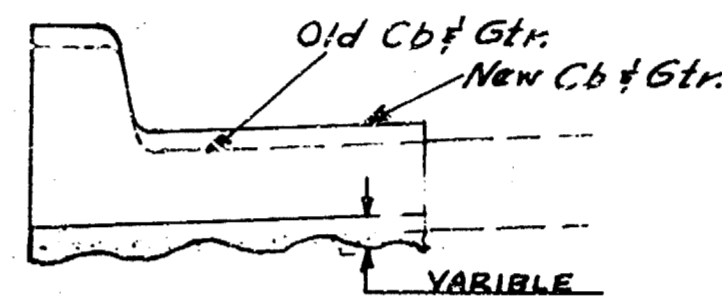

DETAIL OF OLD & NEW CB & STR.  
 NOTE: AREA BELOW NEW CB & STR. TO  
 BE SAND FILLED. ANY EXCAVATION  
 BELOW BOTTOM OF EXISTING CB & STR. TO  
 BE A NON PAY ITEM. ONLY SAND FILL FROM  
 BOTTOM OF NEW CB & STR. TO 2" BELOW OLD CB & STR.  
 TO BE A PAY ITEM.

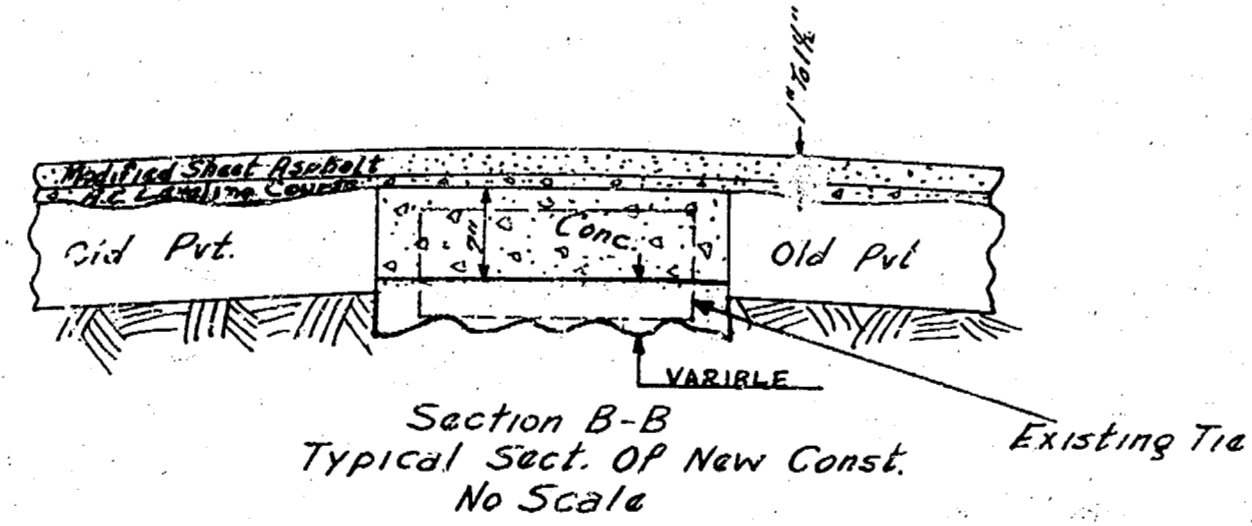

NOTE: AREA BELOW NEW 7" BASE  
 TO BE SAND FILLED. ANY EXCAVATION  
 BELOW BOTTOM OF TIES TO BE A NON  
 PAY ITEM. ONLY SAND FILL FROM BOTTOM  
 OF NEW SLAB. TO 2" BELOW TIE TO BE A PAY ITEM

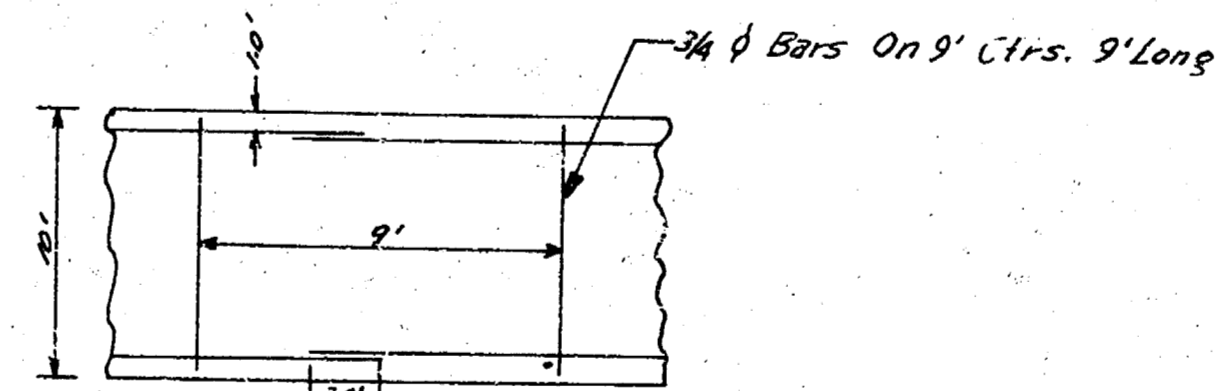

Reinf. Steel Pattern  
 For Center Strip of 7" Conc.



**FRANKLIN**  
 E.L. PORTER TO EL. NIMS  
 RESURFACE & REPAIR  
 CITY OF WICHITA KAN.  
 B. E. SMITH CITY ENGINEER  
 APRIL 1956 Proj. No. C15-47

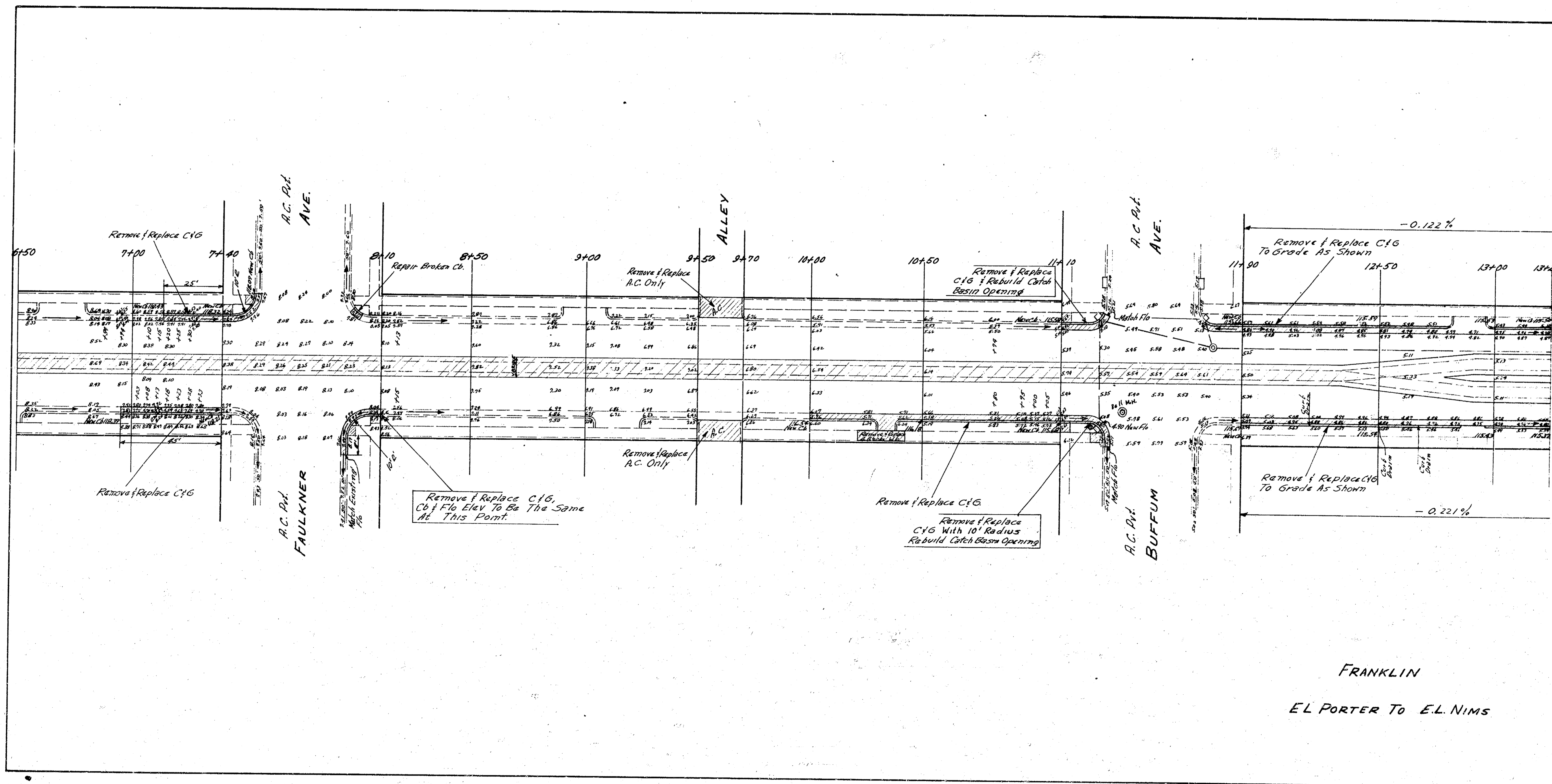

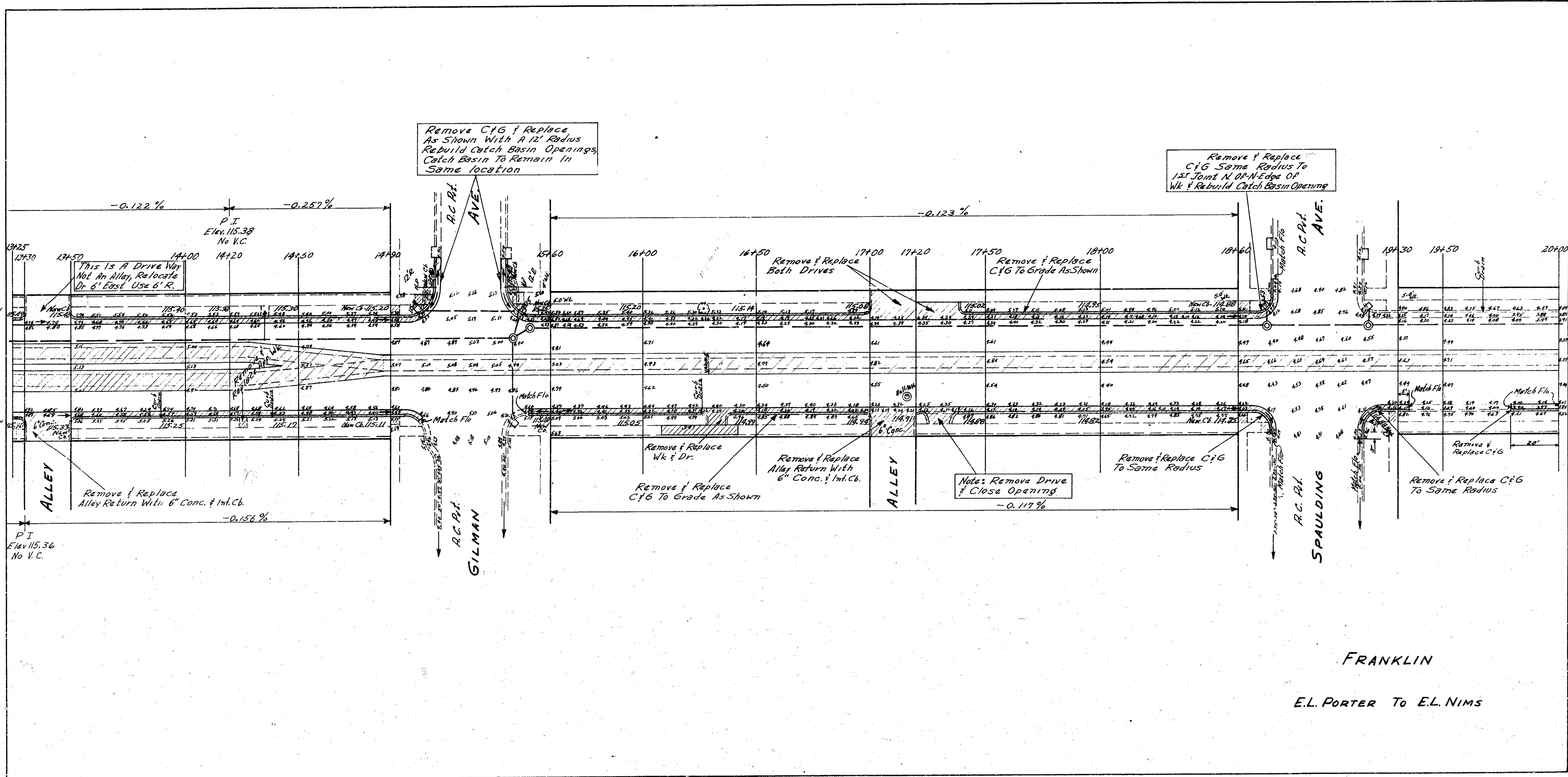

FRANKLIN  
E.L. PORTER TO E.L. NIMS

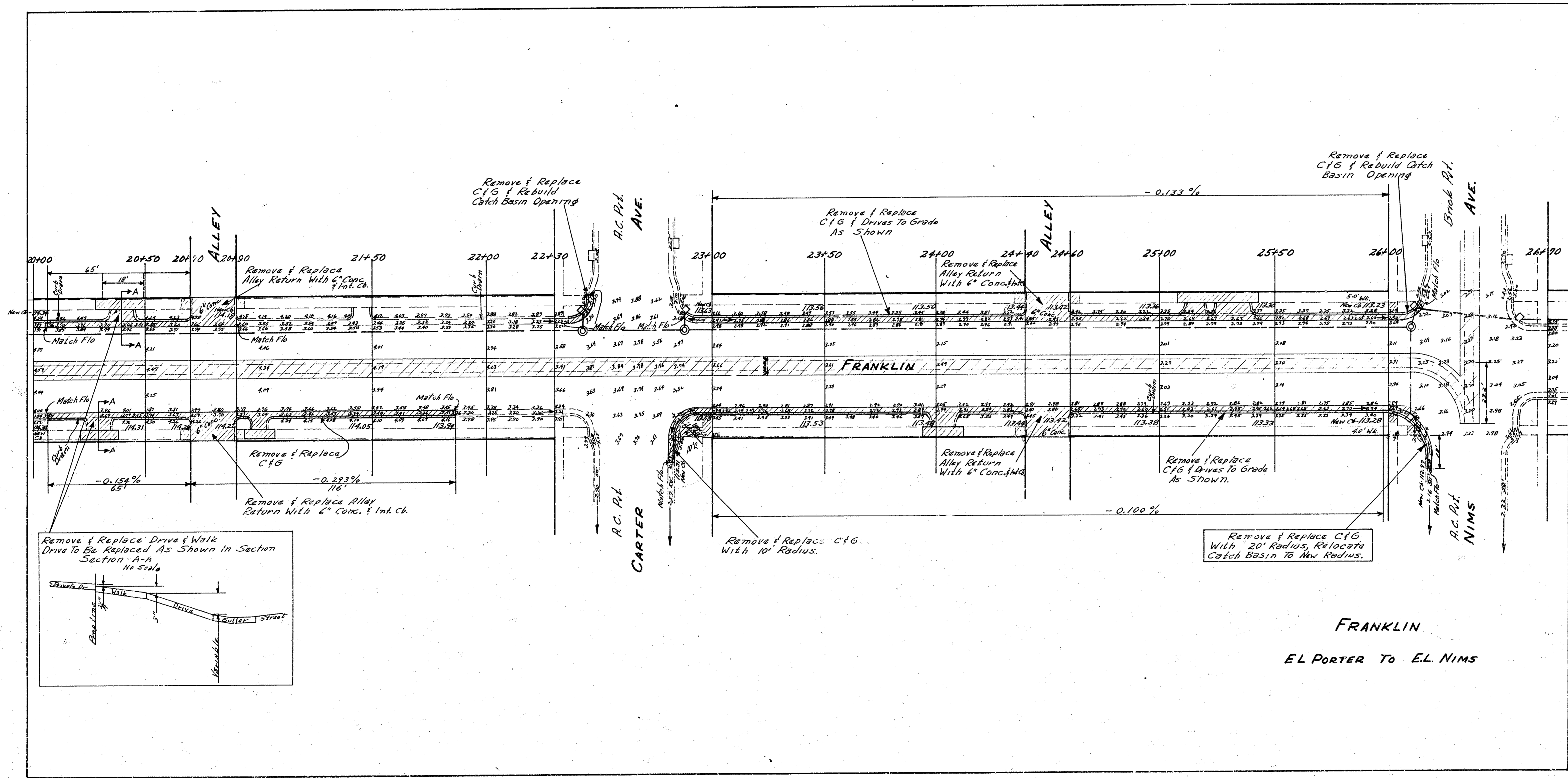

FRANKLIN  
EL PORTER TO EL NIMS