

S-4

BM. 102.88 "M" in Mueller Top Hyd. U.S. Minnesota NS. Funston  
BM. 100.66 Top ab NS. Funston & W.L. Swan

Prop.	C.F.
30.7	14.2
33.9	+108 1.4
27.7	15.6
25.9	
25.3	
31.1	
179.5	
+10% 17.9	
197.4	

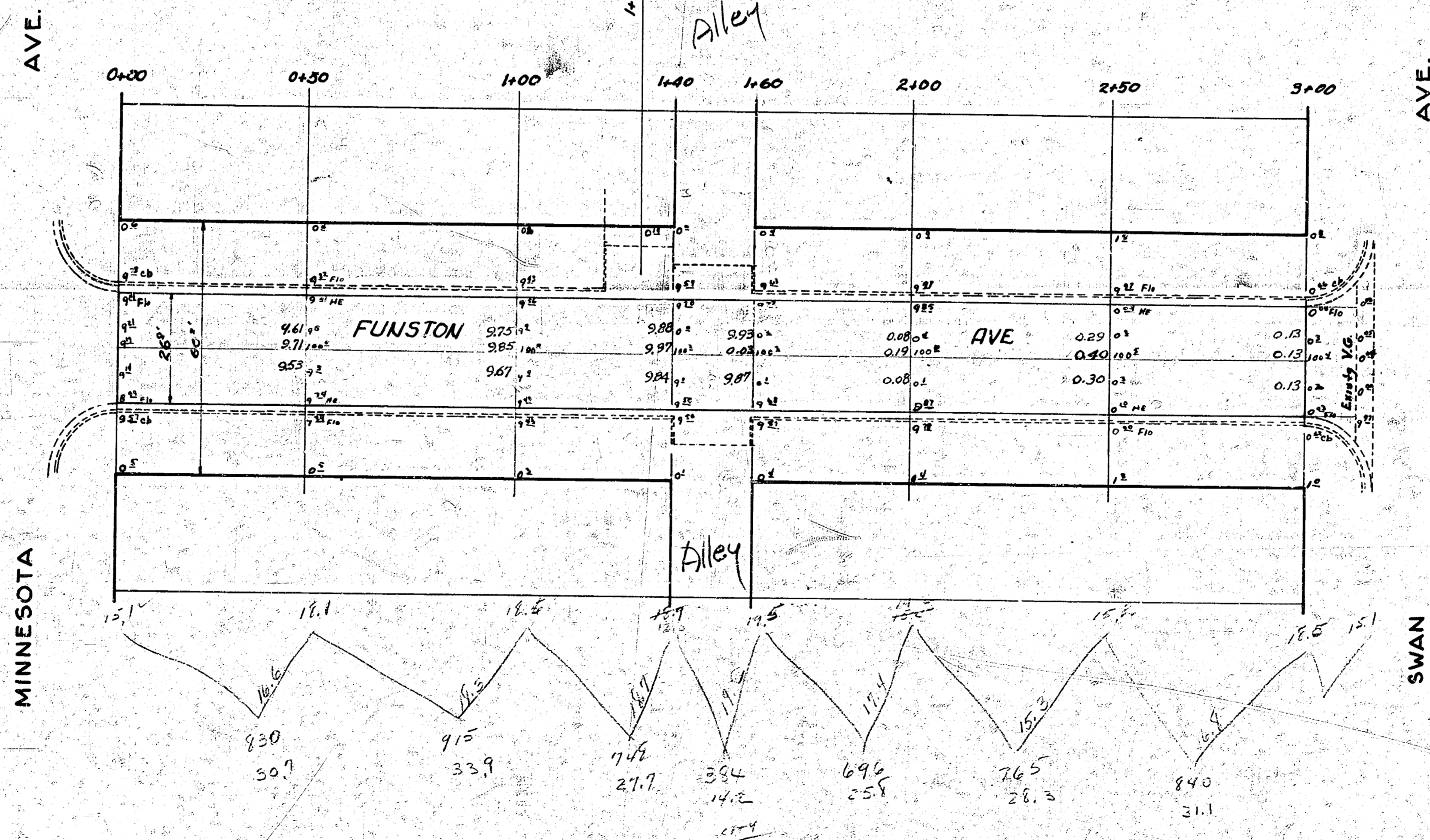
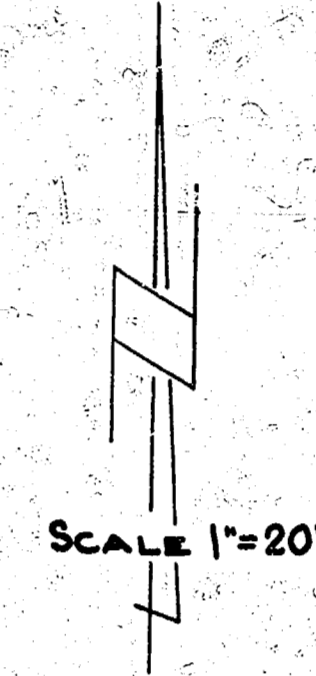

Section Surface 588 SW 11-28-57  
Plan 11-28-57

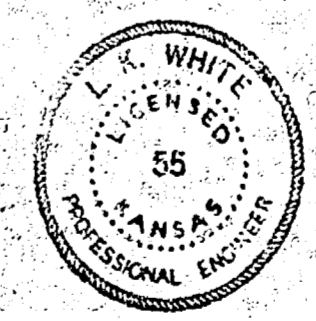

FUNSTON ST.  
 EL. MINNESOTA AVE. TO W.L. SWAN AVE  
 26' A.C.  
 CITY OF WICHITA, KANSAS  
 LKWHITE CITY ENGINEER  
 OCTOBER, 1951 PROJ. NO. C 11-138

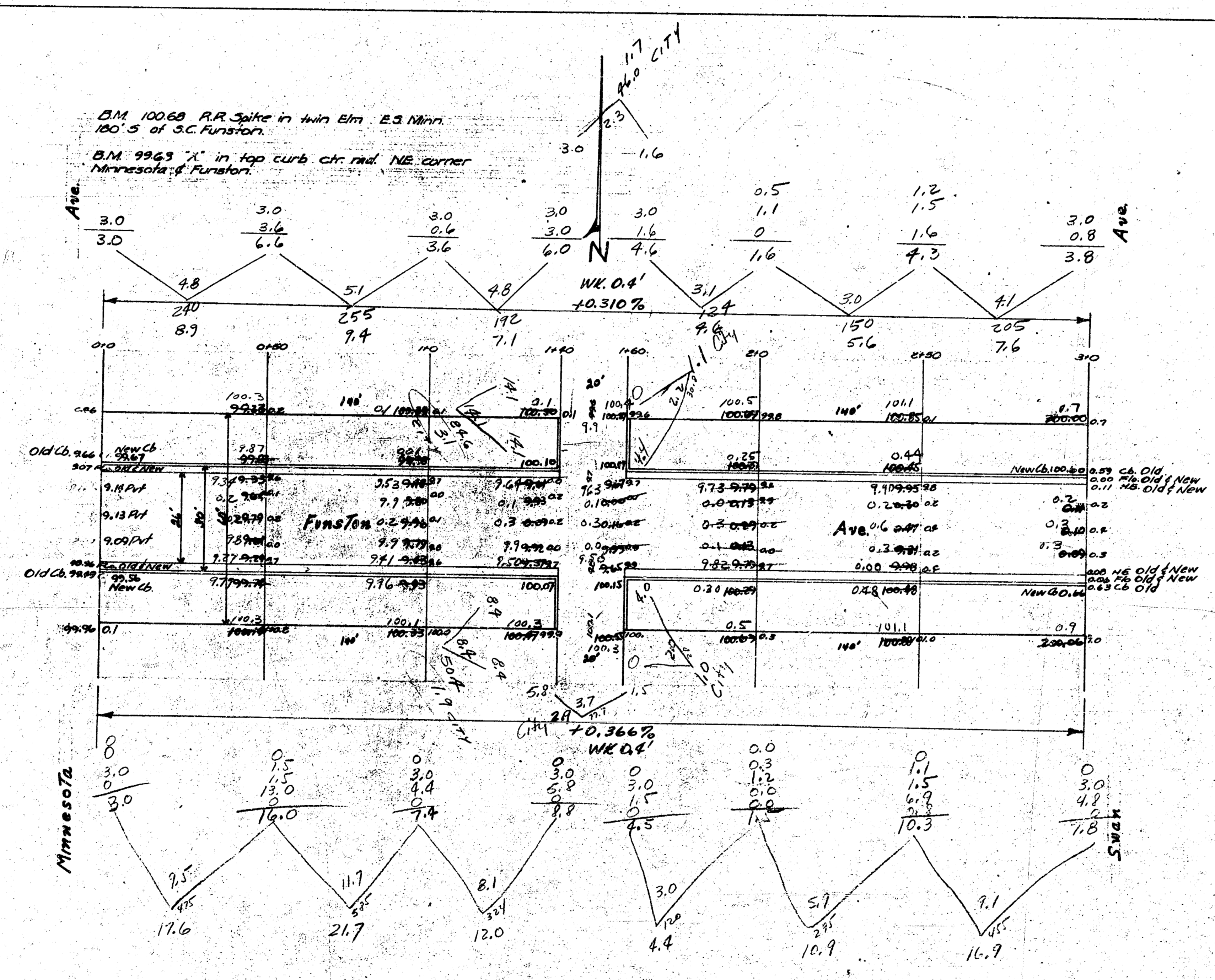

PROP	CITY
17.6	2.9
21.7	1.0
12.0	1.1
4.4	5.0
15.9	
16.9	
83.5	
Total 97.9 Ccu Yds	

PROP	CITY	TOT
8.9	1.7	
9.4	1.7	
7.1	3.1	
5.6	6.7	
7.6		
43.2		TOT

43.2 PROP  
6.7 CITY  
49.9 TOT

Funston Ave.  
 EL. Minnesota → W.L. Swan  
 Cb + Gf.  
 City of Wichita, Kansas  
 L.K. White City Engineer  
 May 1948 Project C18-47

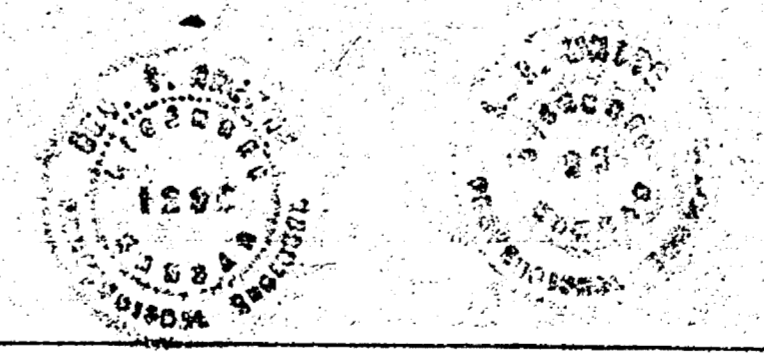

B.M. 10063 P.R. Spike in twin Elm - E.S. Minn.  
100' S. of S.C. Funston.

B.M. 9963 'X' in top curb ctr. road. NE corner  
Minnesota & Funston.

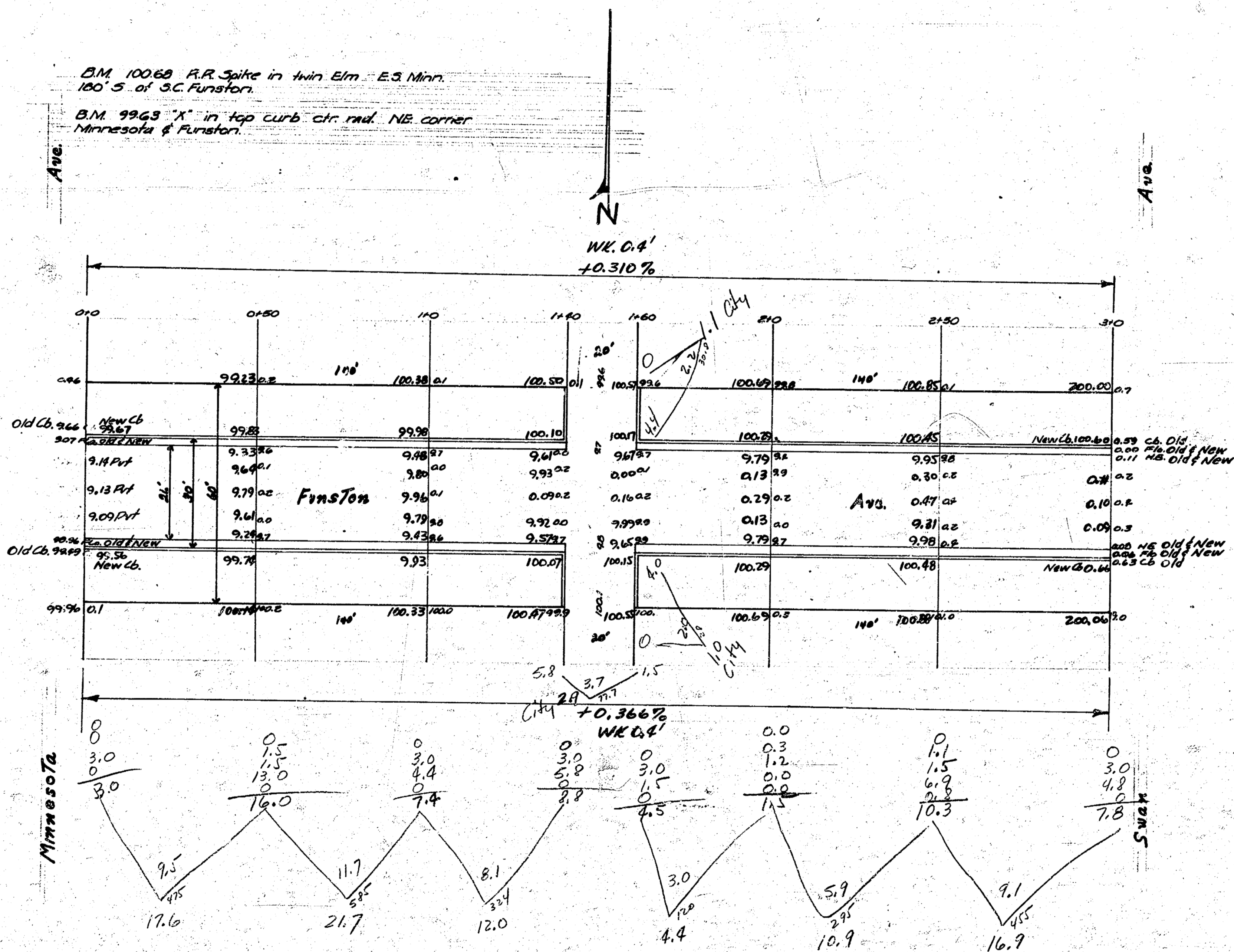

Prop.	City
17.6	2.9
21.7	1.0
12.0	1.1
4.4	5.0
10.9	+10%
16.9	Total 5.5 Cu Yds
83.5	
+10%	
Total 91.9 Cu Yds	

Funston Ave.  
E.L. Minnesota - W.L. Swan  
C.B. & G.F.  
City of Wichita, Kansas  
L.K. White City Engineer  
May 1948 Project C18-48

4 13 3 15