

B.M. 106.65 80° SPIKE, S.E. SIDE 14' ELM TREE, S.E. COR. GEO. WASH. & FUNSTON.

STATIONING ON 9' OFFSET FROM N.P.L. BASE LINE IS N.P.L.

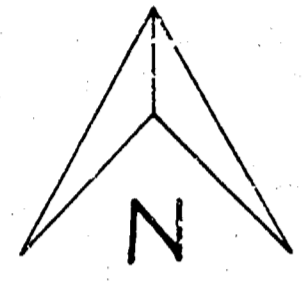

NOTE TO FIELD ENGR. & CONTRACTOR:
ALL ENTRANCE PIPES ARE TO BE DISPOSED OF IN ACCORDANCE WITH CITY DIRT CHECKER'S INSTRUCTIONS.

NOTE TO FIELD ENGR.:
TAKE NEW CROSS-SECTIONS & TOPO. NOTES PREVIOUS TO CONSTRUCTION.

NOTE: INSTALL 15" R.C.P. IN DITCH TO ALLOW FLO SOUTH. SHARP ASPHALT HOOD-UP FOR FLO INTO DITCH.

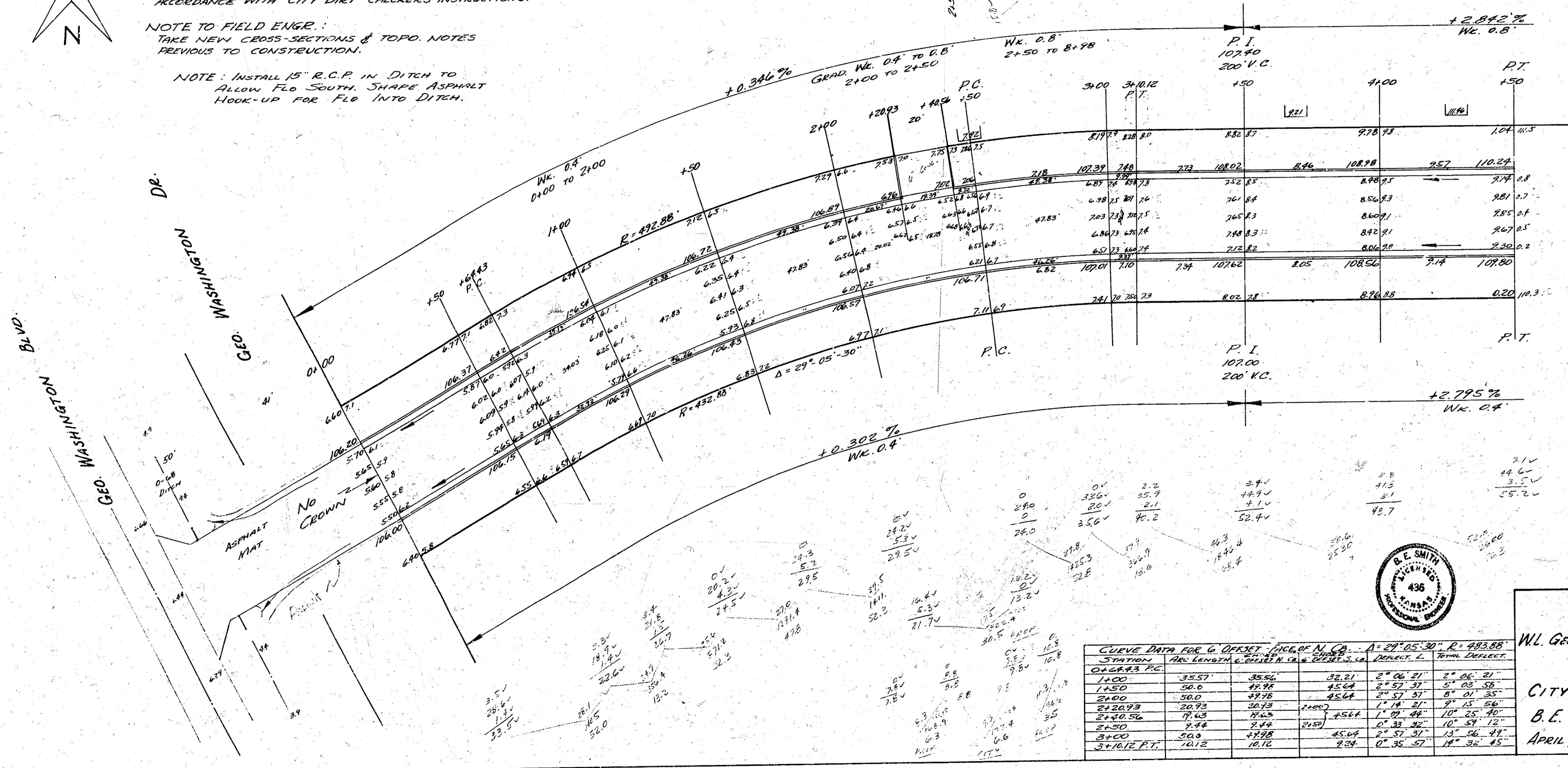

Survey by Bk West
Checked JH

CURVE DATA FOR 9' OFFSET - HIGH OF AL. CO. - Δ = 27° 05' 30" - R = 432.88

| STATION | 20' LONG. CHORD IN LINE | 20' LONG. CHORD TO DEFLECT. L | DEFLECT. L | FORM DEFLECT. |
|--------------|-------------------------|-------------------------------|------------|---------------|
| 0+66.43 P.C. | 35.57 | 35.56 | 32.21 | 2° 06' 21" |
| 1+00 | 50.0 | 49.96 | 45.64 | 2° 57' 37" |
| 1+50 | 50.0 | 49.96 | 45.64 | 2° 57' 37" |
| 2+00 | 50.0 | 49.96 | 45.64 | 2° 57' 37" |
| 2+30 | 74.3 | 74.3 | 68.64 | 4° 06' 21" |
| 2+50 | 74.3 | 74.3 | 68.64 | 4° 06' 21" |
| 3+00 | 50.0 | 49.96 | 45.64 | 2° 57' 37" |
| 3+16.12 P.T. | 12.12 | 12.12 | 11.12 | 0° 35' 57" |



FUNSTON
W.L. GEO. WASH. DE. TO E.L. CLIFTON
26-2-30 A.C.
CITY OF WICHITA, KANSAS
B.E. SMITH - CITY ENGINEER
APRIL, 1955 PROJ. C 13-12

1/3

