

B.M. 10321 7m W Edge of part of Geo Wash Blvd. S.L. Aloma
 Note: Stationing is on E.P.L.

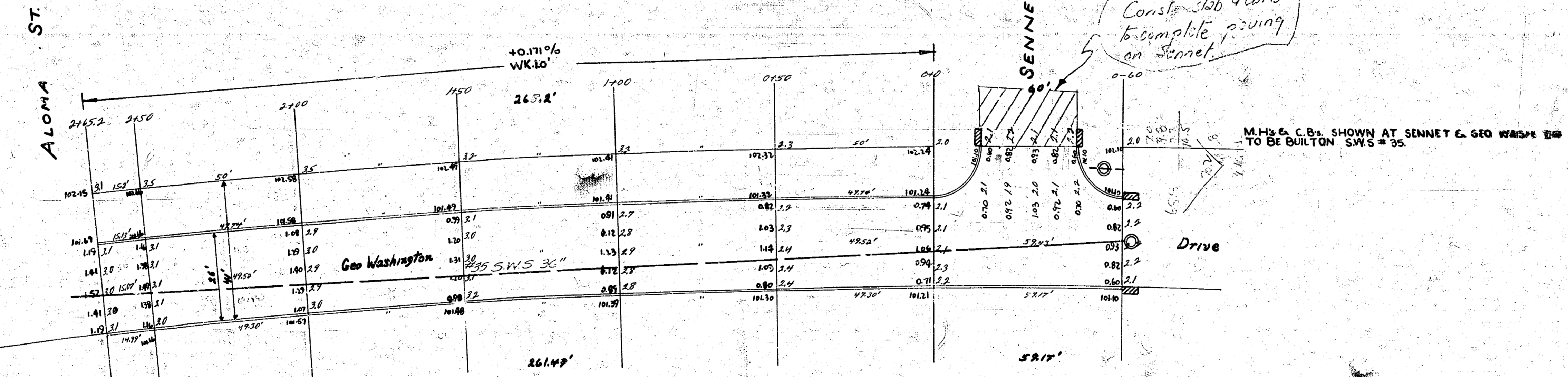

Note:
 2" extra thickness over
 sewer ditch 30' wider than
 ditch.
 3/4" bars @ 40' c.s.

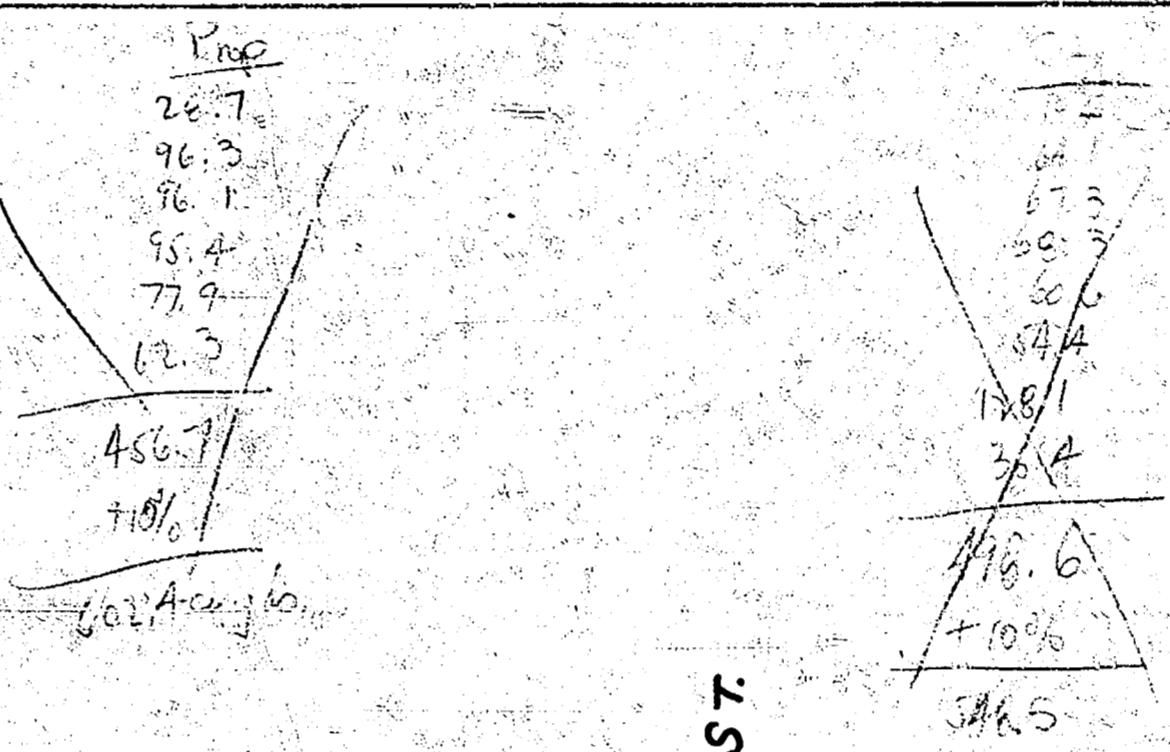
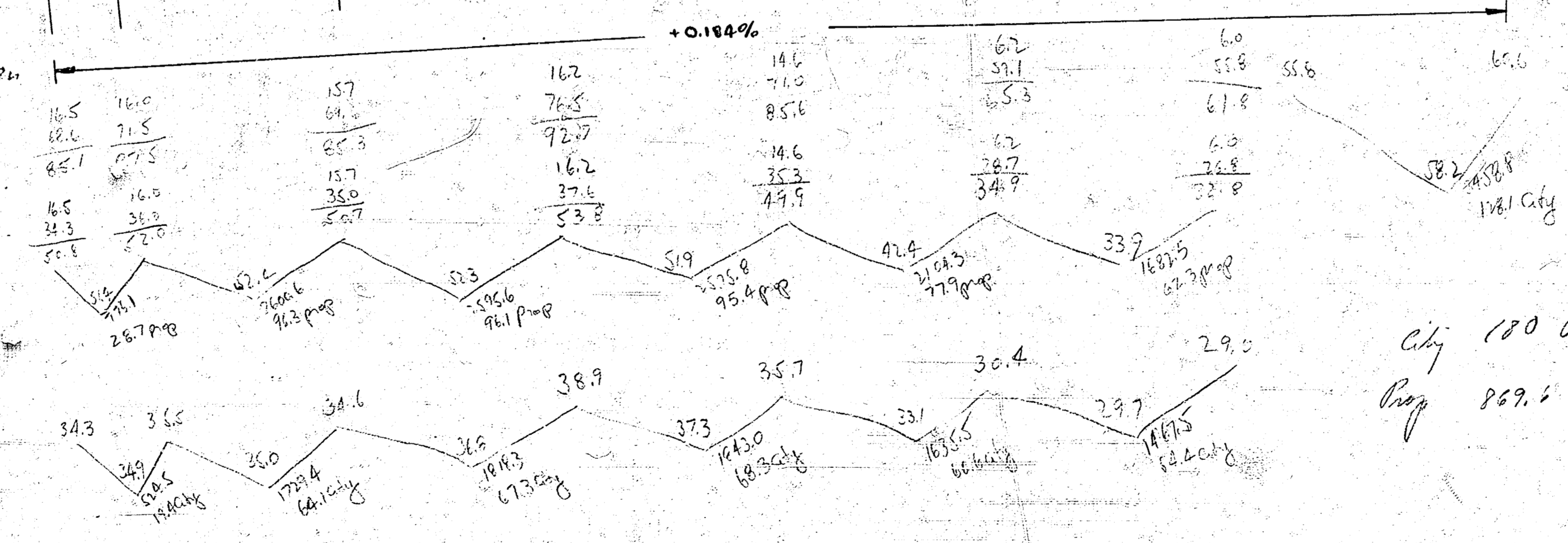

GEO. WASHINGTON DR.
 S.L. ALOMA ~ S.L. SENNET.
 26' CONC' CB.
 CITY OF WICHITA, KANSAS
 L. K. WHITE CITY ENGINEER
 JUNE 1943 PROJ. NO. 19-87