

B.M. 10393 "X" on S. End W. Headwall Conc. Box Across G.W. Blvd. 200' N. of Harry

Sta. on S.E. R.

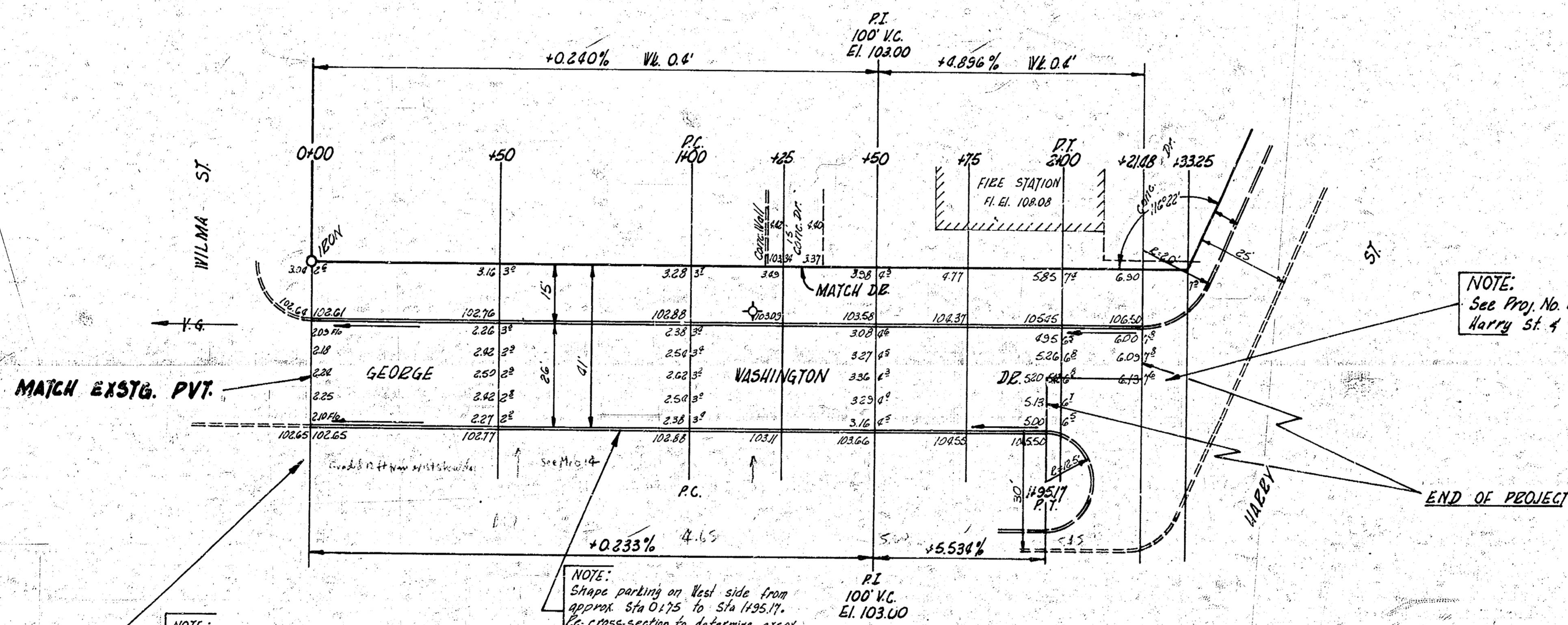

NOTE:
See Proj. No. C11-6 for widening of
Harry St. & Geo. Wash Intersection.

NOTE:
The earth excavated on this project
to fill in ditches on West side of
Geo. Wash Blvd.

NOTE:
Shape parking on West side from
approx Sta 0+175 to Sta 1+35.71.
See cross-section for determine excor.

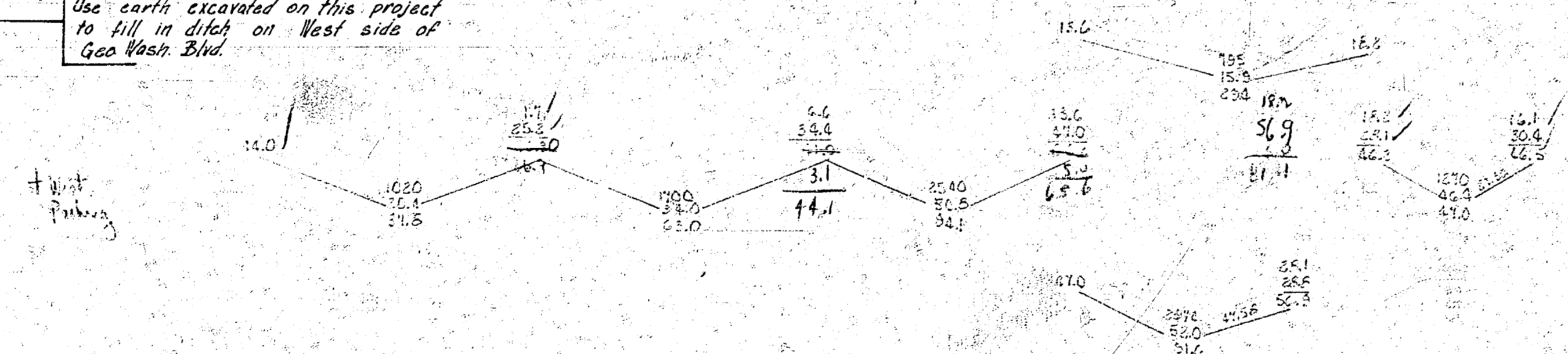

TOTAL PROP. EXCAV
342.0
+10% 37.6
379.6 Cu.Yd.

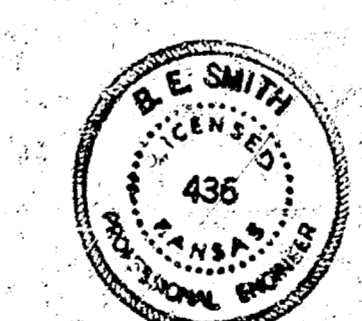

GEORGE WASHINGTON DR.
S. WILMA - N. HARRY
26' CONC & CB.
CITY OF WICHITA, KANS.
B.E. SMITH CITY ENGINEER
APRIL, 1955 PROJ. NO. C14-301

10 4 1