

$158.5 + 1.070 = 159.57$
 $159.57 - 158.5 = 1.070$
 $1.070 \times 1000 = 1070$
 $1070 \div 7.5 = 142.67$
 Curb = 142.67'

Curb + Gutter on Glendale

B.M. Elev. 158.93 "North curb at Kellogg bet. Elroy & Glendale"

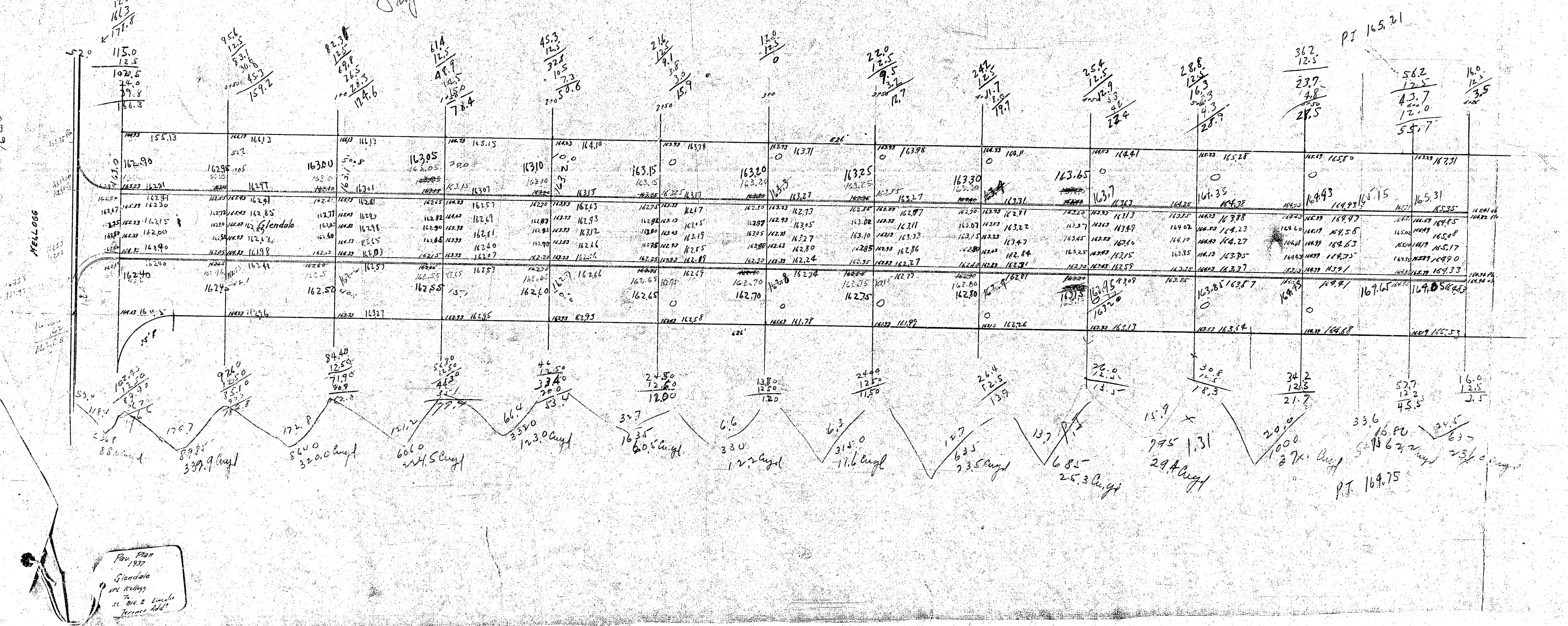

Plan View
 1937
 Glendale
 at Kellogg
 bet. Elroy & Glendale