

Survey Dubois
 Plans Prepared
 Exp
 Checked

EARTHWORK

Excavation	Compacted Fill
City 0	City 0
+10% 0	+10% 0
Property 508.2 cu yd	Property 5 cu yds
+10% 560 cu yd	+10% 6 cu yds

West Curb Curve Data	East Curb Curve Data
R: 65'	R: 90'
Δ: 30°56'09"	Δ: 50°56'09"
L: 57.78'	L: 84.45'
T: 30.96'	T: 45.25'
C: 55.90'	C: 81.70'
D: 88°08'50"	D: 60°18'41"

Staking Data Based on E Prop Line R=110', Δ=25°28'04"

BL Sta	BL Length	Chord Length	Chord Deflection	Total Deflection
5+32	—	—	0'00"00"	0'00"00"
5+50	18'	16.84'	9.32"	4°41'16"
5+75	25'	23.36'	12.93"	2°30'39"
6+00	25'	23.36'	12.93"	2°30'39"
6+27.79	27.79'	27.81'	15.39"	2°28'04"

Notes: Baseline is East Property Line
 All Curve Data Given to Face of Curb
 NOTE: CONTRACTOR TO CLEAR RIGHT OF WAY, GRADE PARKINGS, AND CONSTRUCT COMPACTED FILL IN SIDEWALK AREAS WHERE NECESSARY. SIDEWALK TO BE CONSTRUCTED BY OTHERS.
 NOTE: FIELD ENGINEER IS TO DETERMINE THE TYPE OF SUBGRADE TREATMENT WHICH IS TO BE USED. SUBGRADE TREATMENT MAY CONSIST OF LIME TREATED SUBGRADE, CEMENT TREATED SUBGRADE, RE-CONSTRUCTION OF EXISTING SUBGRADE MATERIAL AS SPECIFIED IN STANDARD SPECIFICATIONS, OR ANY COMBINATION OF THESE.

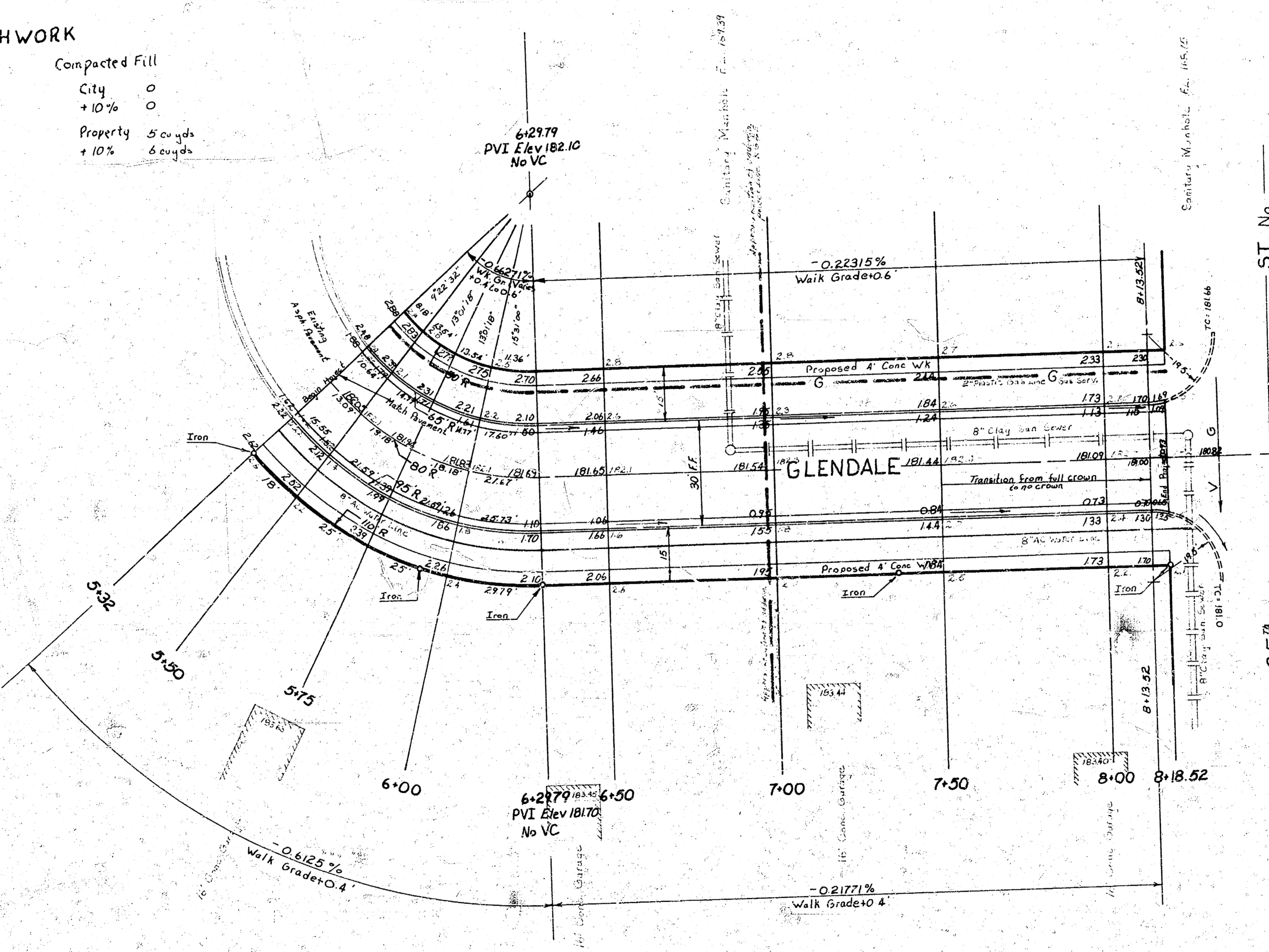

BM 74.49 Std @ NW Corner Oliver & 25th St

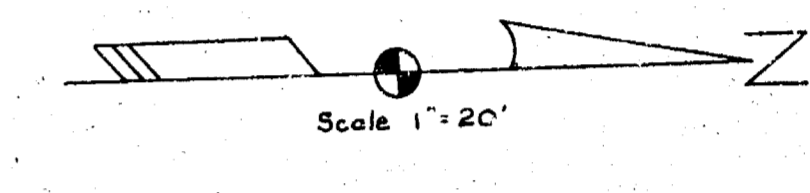

NOTE: CONTRACTOR TO GRADE 25th STREET NORTH TO MATCH NEW PAVEMENT ON GLENDALE AND SUCH THAT STORM WATER WILL DRAIN EAST IN 25th STREET NORTH RIGHT OF WAY. COST TO BE INCIDENTAL TO PROJECT.

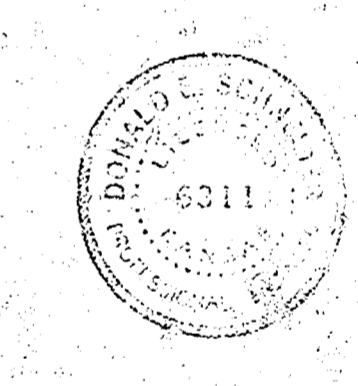

GLENDALE ST
 EL Lot 7, Block 2, Prairie Hills Addition
 to SL 25th ST
26-2-30 Asphaltic Concrete
 City of Wichita, Kansas
 RW Linn, City Engineer
 Project No DAKS 559100
 Date: APRIL 1974

1/2