

B.M. 95.447 1st. 2° W. NE. cor. Iron Glenn & 31st St So.
 B.M. 98.044 1st. 6° E. & 2° S. of SW. cor. Glenn & 31st St So.
 244

PROP. EXCAV.
 831.0 Cu Yd

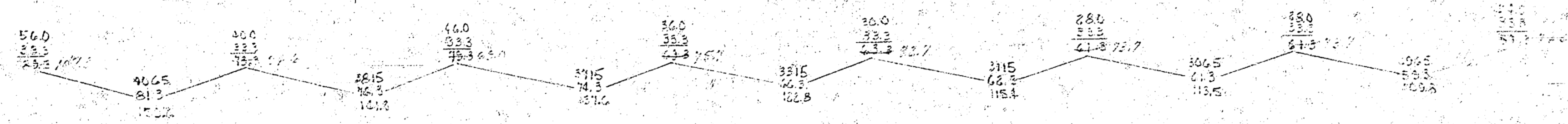

B.E. SMITH
 CIVIL ENGINEER
 436
 WICHITA, KANSAS
 1912-1927

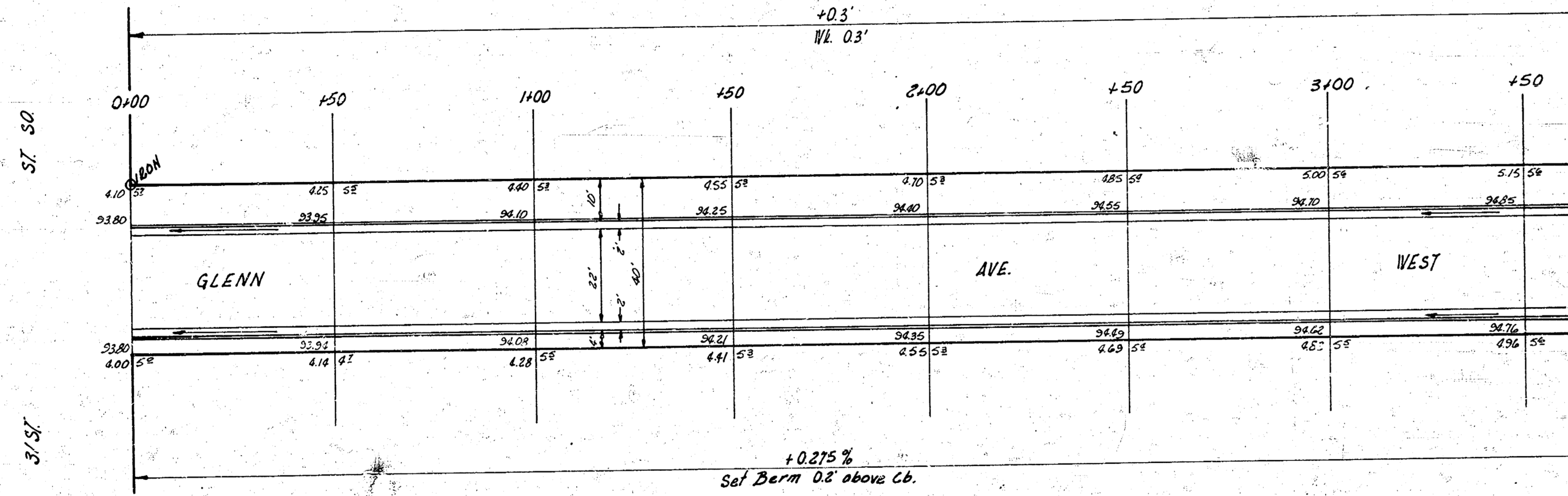

NOTE TO FIELD ENGINEER—
 RE - X - SECTION JOB AT TIME OF STAKING.

TOTAL EXCAV.	
831.0	CITY
275.5	252.5
107.5	107.5
252.5	252.5



GLENN AVE. WEST
 NL. 31ST ST SO. - NL. 30TH ST SO.
 22'-2" AC
 CITY OF WICHITA, KANS.
 B.E. SMITH CITY ENGINEER
 PROJ. NO. C15-48

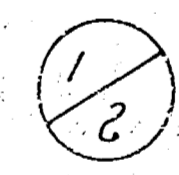

E. K. J. V.
Peop City
P.O. Box 2511, Calif

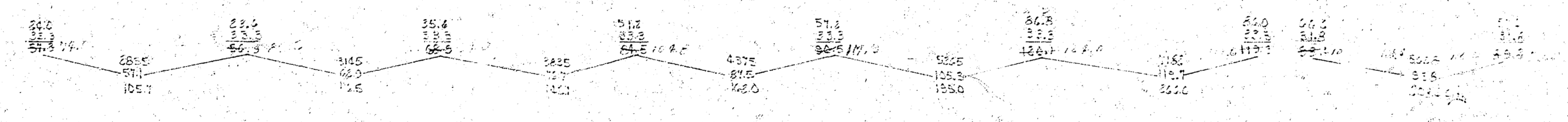
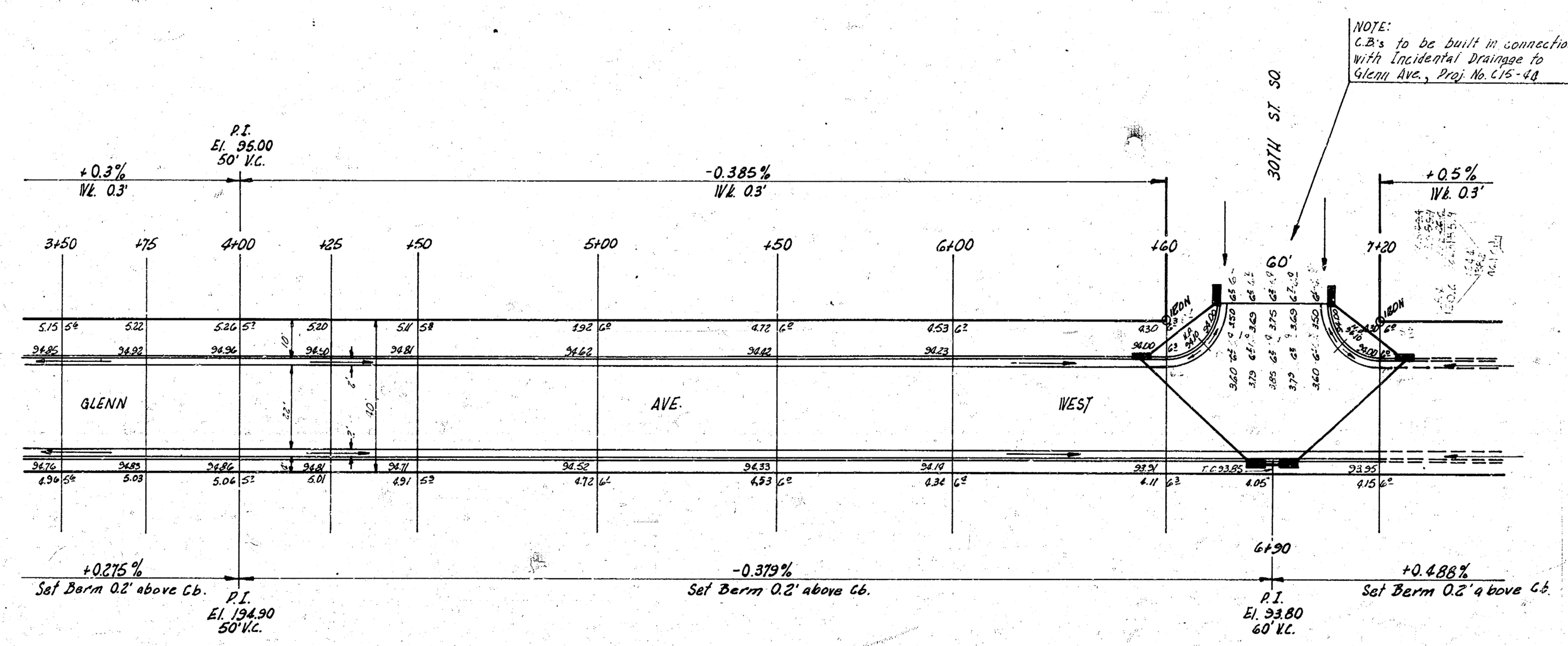

2/2

GLENN AVE WEST
PROJ. NO. C15-48