

B.M. 98.67 + on Headwall 30' S of N.L. Jennings Add. E.L. K-15
 B.M. 35.81 S.E. corner bottom step S.S. house on NW corner Glen Oaks & Minnesota

Chaining from W. to E. on N.E.

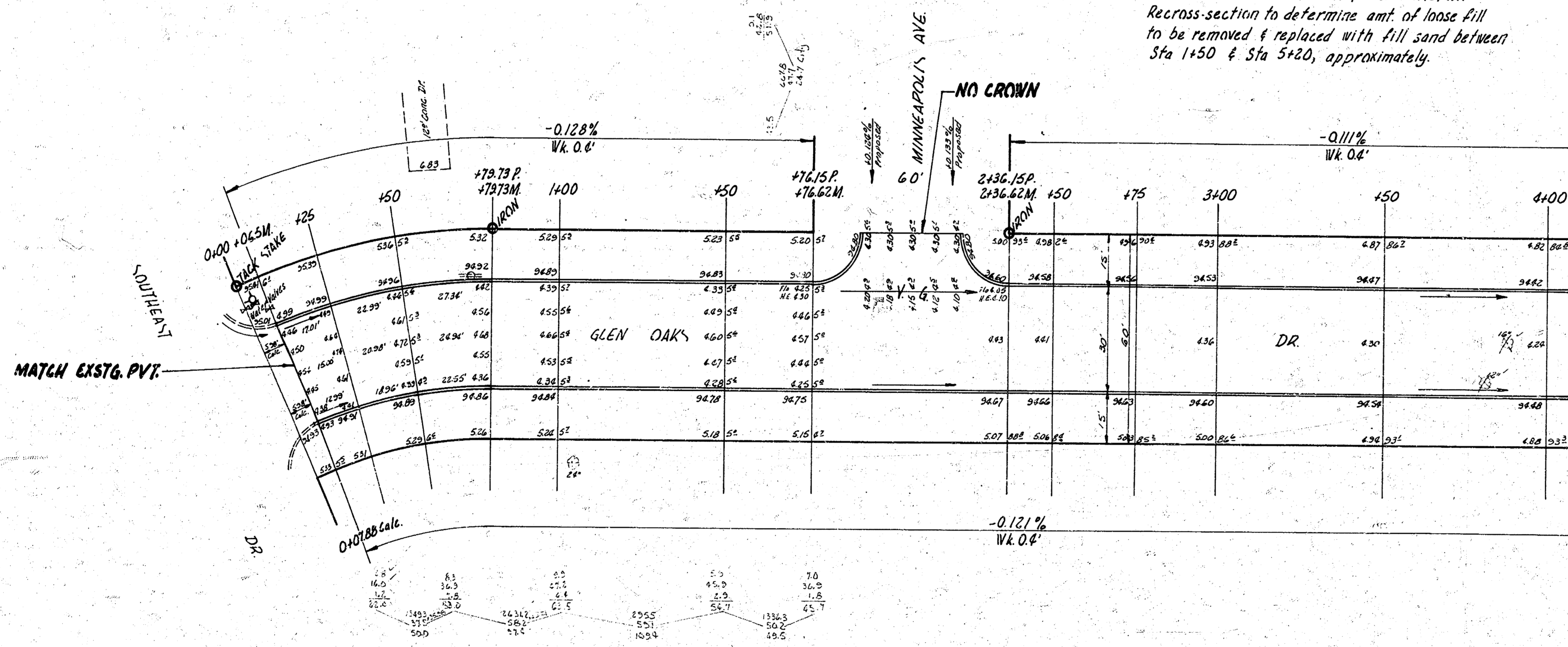

NOTE TO FIELD ENGINEER & CONTRACTOR
 Recross-section to determine amt. of loose fill
 to be removed & replaced with fill sand between
 Sta 1+50 & Sta 5+20, approximately.



Curve Data from Sta 0+00 to Sta 0+79.73
 Sta on N.E., R=186.38', Δ=23°30'40"

Sta	Changpt on Proposed H.C.	Changpt on 6" Ch. 186.38'	Deflection Angle	Tangent to P.T. from P.C.
0+00				
0+65			0° 59' 57"	3' 23" 07"
+25	7.20	14.23	2° 50' 37"	3' 50" 34"
+50	22.37	38.25	8° 50' 34"	4' 47" 08"
0+79.73	47.81	76.53	18° 34' 17"	12' 15" 19"

TOTAL FILL
 Prop. 4910.5
 City 43.5
 5405.0 Cu Yds. 2.6 Cu Yds.

TOTAL EXCAV.
 Prop. 7821.6
 City 25.3
 7846.9 Cu Yds. 54.5 Cu Yds.



GLEN OAKS DR.
 EL. SOUTHEAST DR. - W.L. MINNESOTA
 30' CONC. & CB.
 CITY OF WICHITA, KANS.
 B.E. SMITH CITY ENGINEER
 MARCH 1952 PROJ. C15-62

1/3

