

B.M. #1 96.35 1/4" Spike in E. face of 10" tree 30' S. of the W. Line of Gold
 B.M. #2 94.39 S.W. Corner of Concrete house walk at house S.E. Corner Gold & 347th St.
 B.M. #3 95.36 N.W. Corner Concrete Porch House S.E. Corner Gold & 332P.

F.X.G.A.Y.
 PROP. CITY
 1593.7 CuYd 275.1 CuYd.

Chaining From S. to N. on E. PL.

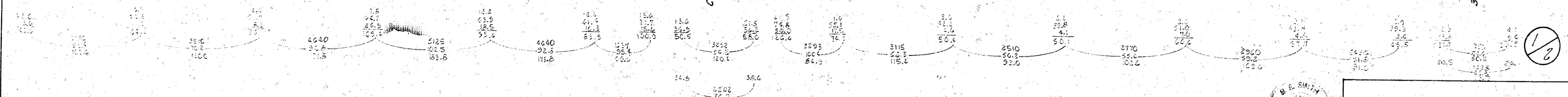
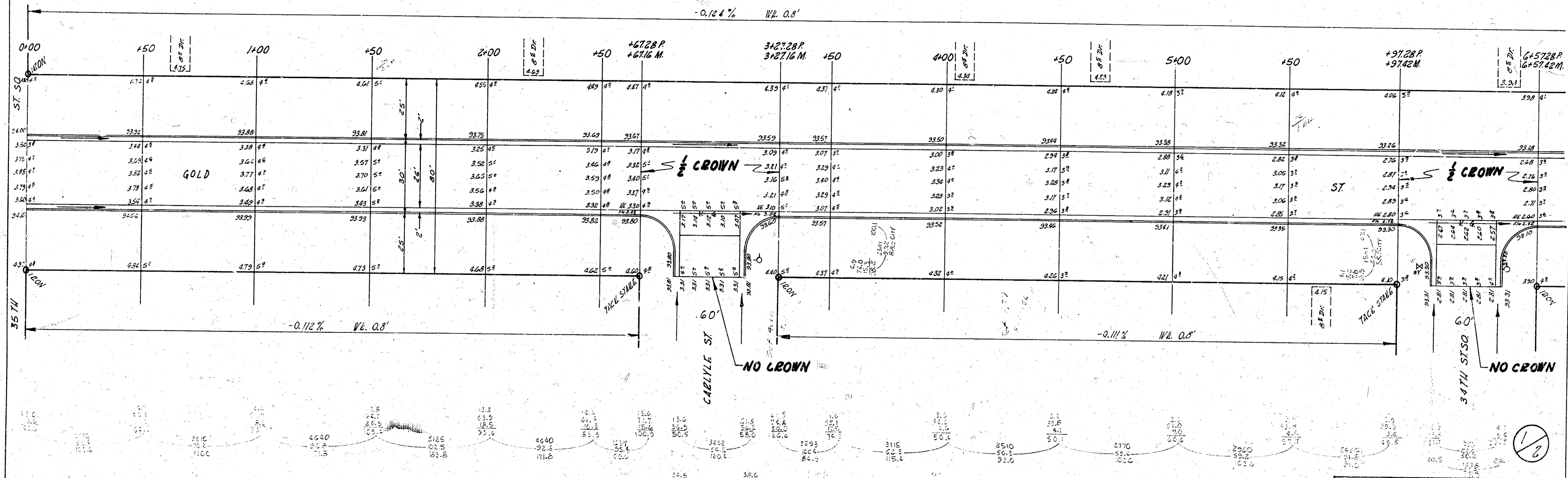

GOLD ST.
 S.L. 332D ST. 50 - N.L. 35TH ST. 50.
 26-2-30 A.C.
 CITY OF WICHITA, KANS.
 B.E. SMITH CITY ENGINEER
 AUG. 1956 PROJ. NO. C14-72

TOTAL EXCAVATION
 1593.7 CuYd
 TOTAL FILL
 275.1 CuYd

