

B.M. #1 95.06 Step Bench in E. Face of Tel. Pole W.S. E.P. 100' N of 34th St
 B.M. #2 95.36 N.W. corner Concrete Porch House on S.E. corner Gold of 33rd
 B.M. #3 95.98 S.E. corner Concrete Porch House 33rd South Gold
 B.M. #4 96.55 "M" in Mueller Fire Plug 3rd S. of S.L. 31st 15th W. of E.L. Gold

E. X. C. A. V.
 PROP. CITY
 1267.8 Cu. Yd. 57.3 Cu. Yd.

Chaining from S. to N. on E. R.

NOTE: MATCH ALL DRIVES

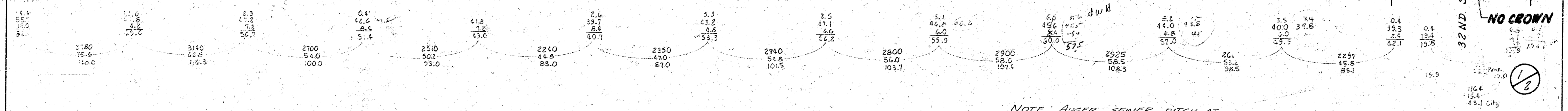
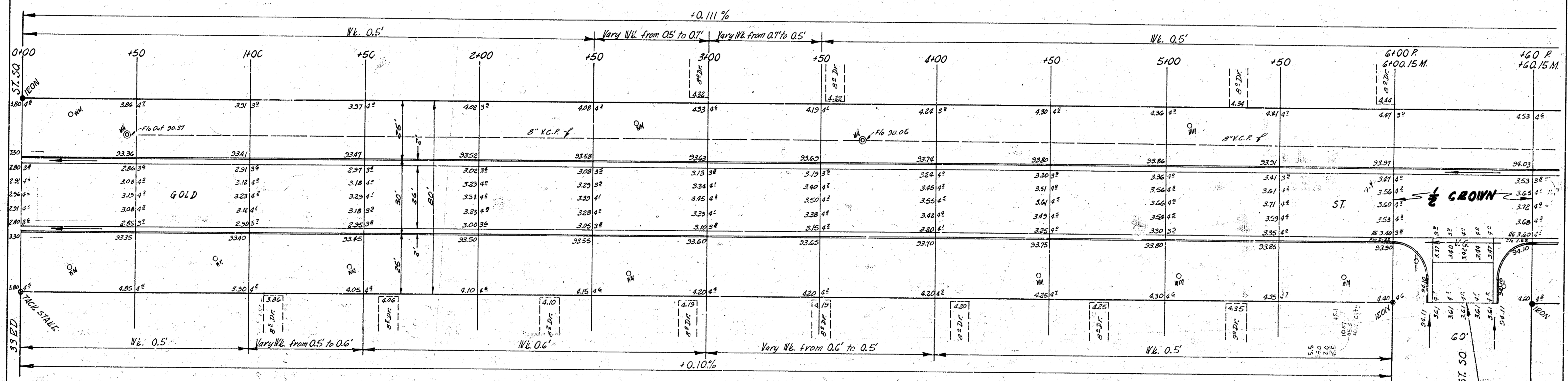

NOTE: ANGER SENSE DITCH AT DRIVEWAYS IF THERE IS LAAGER OF SETTLEMENT USE EXTRA STEEL IN DRIVES.

TOTAL EXCAV.
 PROP. 1545.5
 CITY 10.8
 1556.3
 101.1
 111.9 Cu. Yd.



GOLD ST.
 N.L. 33RD ST. SO.-S.L. 31ST ST. SO.
 26-2-30 A.C.
 CITY OF WICHITA, KANS.
 B.E. SMITH CITY ENGINEER
 AUG., 1956 PROJ. NO. C14-71

