

BENCH MARKS:
 117.89 G^m Globe, E. end of S.E. rad., Gordon & St. Louis
 116.52 Iron in thimble, ctr. Gordon & 3rd

Prop. City
 23.9
 27.9
 31.8
 30.9
 29.6
 30.2
 30.2
 29.6
 32.2
 32.6
 28.5
 24.8
 4.6
 350.8
 35.7
 +10%
 392.5 cu. yd

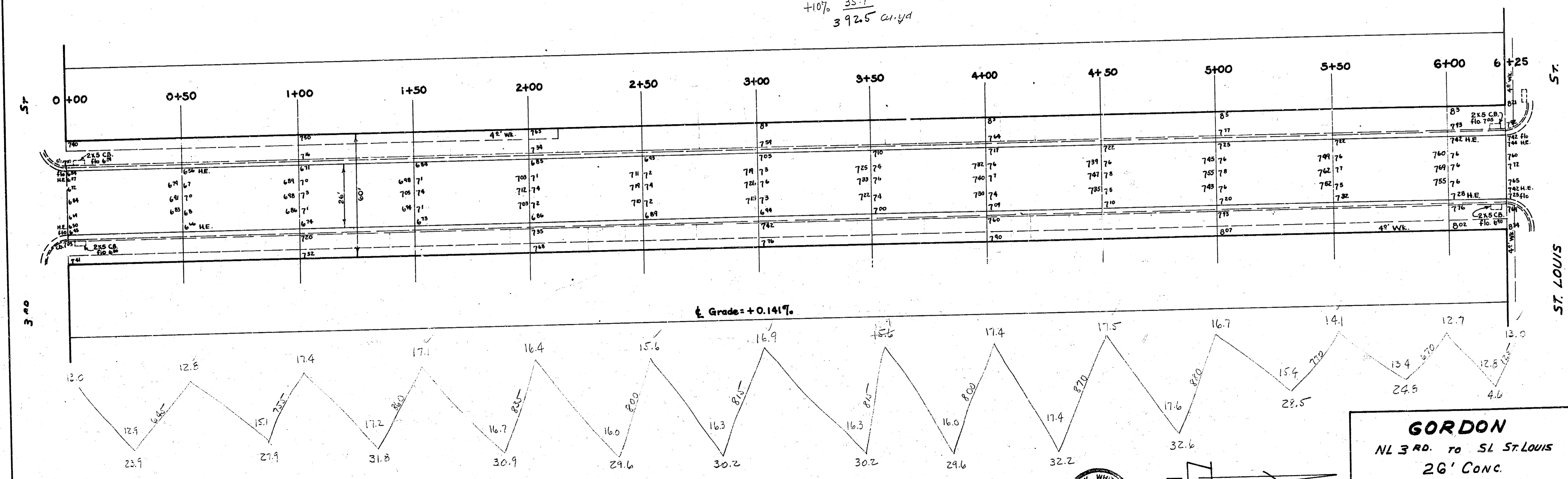

SURVEY - MCGOUGH
 DRAWN - BROWN
 NOTES - BROWN - JWH

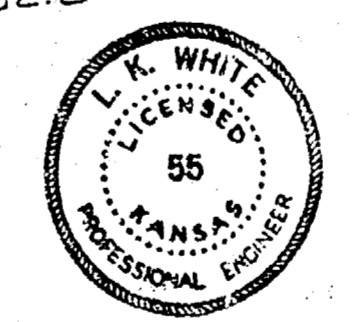

SCALE 1" = 20'

GORDON
 N.E. 3RD. TO S.L. ST. LOUIS
 26' CONC.
 CITY OF WICHITA
 L.K. WHITE CITY ENGINEER
 JAN 1952 Proj. No. C11-288

PAVING PLAN 1944
GORDON AVE N.L. 3RD. ST. TO S.L. ST LOUIS ST.
COMB. CURB & GUTTER & EXC.

