

PLOTTED: Friday, August 01, 2025 @ 09:46AM

J:\PROJECTS\2023\20230810\10431\_COW\_WDG\_BRIDGE REPLACEMENT AT 15TH STREET\100\_230431\_CADD\SHS\08\_CIVIL\SWS\230431\_SWS PLANNING

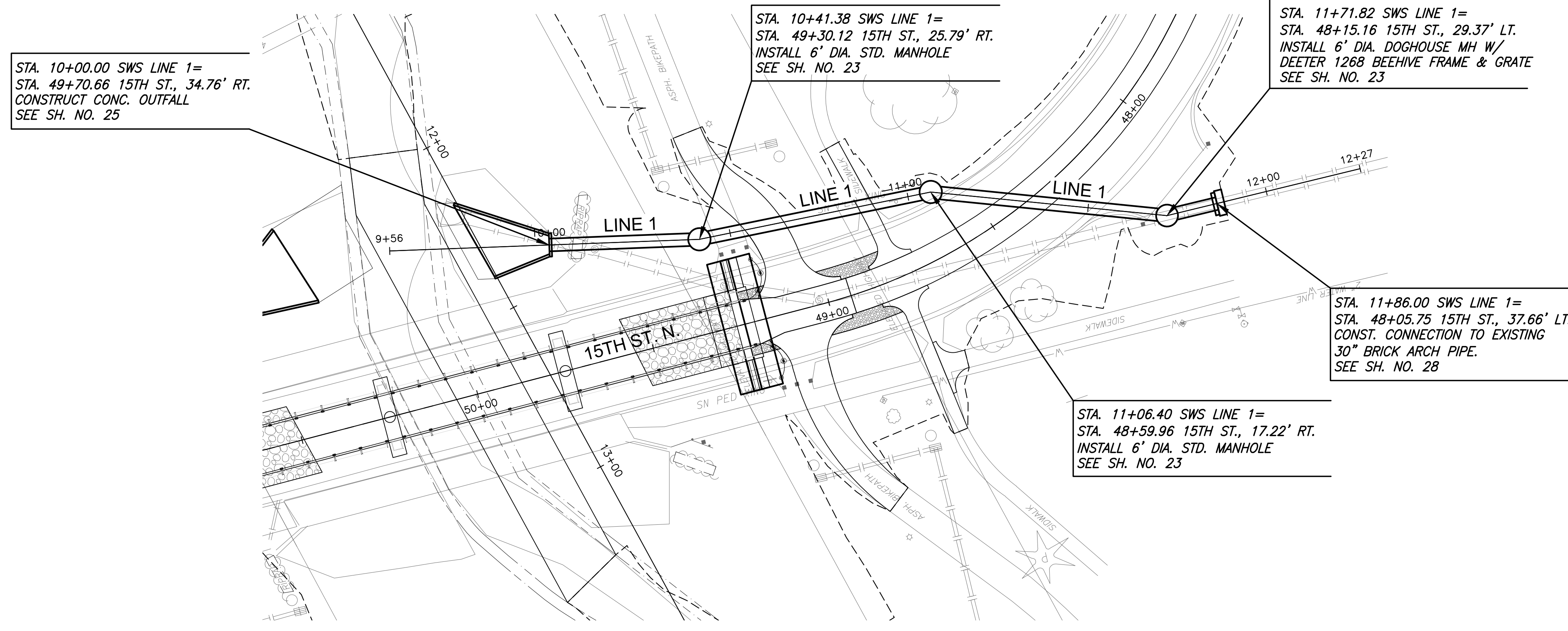

STA. 10+00.00 SWS LINE 1=  
STA. 49+70.66 15TH ST., 34.76' RT.  
CONSTRUCT CONC. OUTFALL  
SEE SH. NO. 25

STA. 10+41.38 SWS LINE 1=  
STA. 49+30.12 15TH ST., 25.79' RT.  
INSTALL 6' DIA. STD. MANHOLE  
SEE SH. NO. 23

STA. 11+71.82 SWS LINE 1=  
STA. 48+15.16 15TH ST., 29.37' LT.  
INSTALL 6' DIA. DOGHOUSE MH W/  
DEETER 1268 BEEHIVE FRAME & GRATE  
SEE SH. NO. 23

STA. 11+06.40 SWS LINE 1=  
STA. 48+59.96 15TH ST., 17.22' RT.  
INSTALL 6' DIA. STD. MANHOLE  
SEE SH. NO. 23

STA. 11+86.00 SWS LINE 1=  
STA. 48+05.75 15TH ST., 37.66' LT.  
CONST. CONNECTION TO EXISTING  
30" BRICK ARCH PIPE.  
SEE SH. NO. 28

PLAN SWS 1  
PROFILE SWS 1

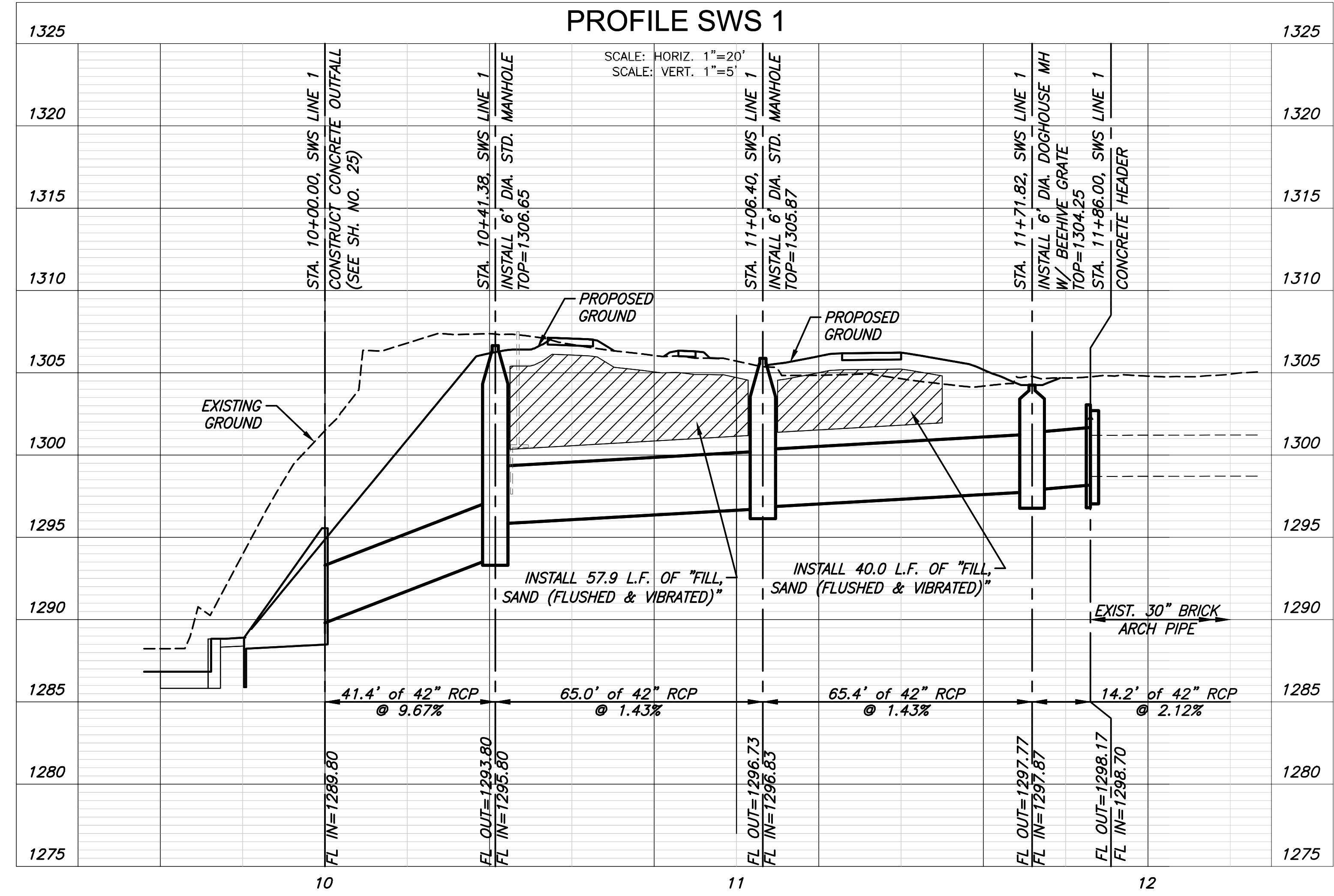
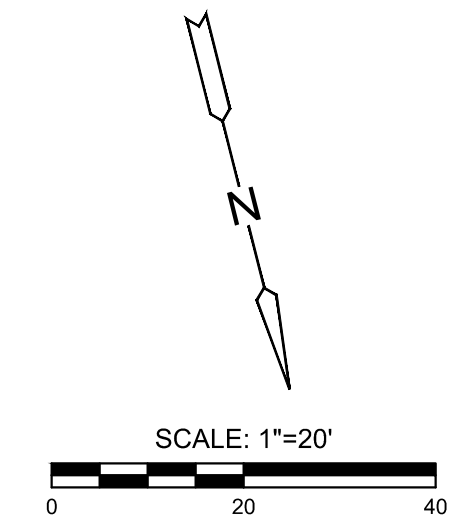

IMPROVEMENT PLANS FOR  
**15TH STREET BRIDGE OVER THE  
WICHITA DRAINAGE CANAL**  
WICHITA, KS

STORM SEWER PLAN & PROFILE LINE 1		
PROJECT NO.	472-2023-085864	
SCALE	1"=20'	
DRAWN	DESIGNED	CHECKED
ZSS	JRA	JRA
NO.	REVISION	DATE
0	ISSUED FOR CONSTRUCTION	8-1-2025
SHEET NO. 12 OF 114		

©2025 MKEC ENGINEERING, INC. ALL RIGHTS RESERVED. WWW.MKEC.COM. THESE DRAWINGS AND THEIR CONTENTS, INCLUDING, BUT NOT LIMITED TO, ALL CONCEPTS, DESIGNS, & DETAILS ARE THE EXCLUSIVE PROPERTY OF MKEC ENGINEERING, INC. (MKEC), AND MAY NOT BE USED OR REPRODUCED IN ANY WAY WITHOUT THE EXPRESS CONSENT OF MKEC.