

B.M. 130.50 6" in globe on Wk. S.S. Drive @ 2002 N Grove
 B.M. 153.02 S.E. Cor. Conc. Parch. Hb. 2011 N. Grove

Sta. on \pm

EXCOV.	
PROP	CITY
22.8	3.6
29.0	16.2
29.3	19.8
29.8	2.0
31.6	
31.0	
18.5	
24.8	
23.5	
14.5	
18.8	
253.0	
1197.25.3	
Total	21.8 cu.yd.

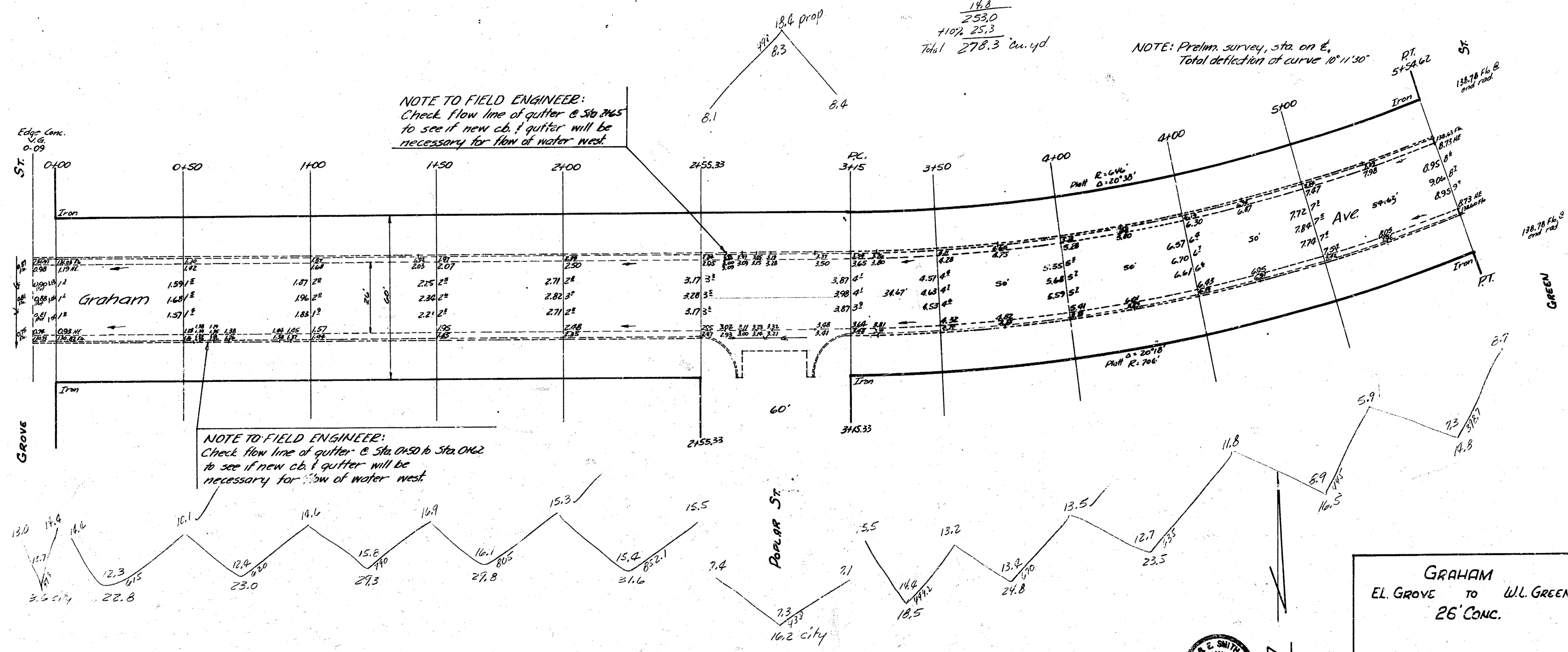

Surveyed by
 B.E. Smith
 Checked by
 B.E. Smith

GRAHAM
 EL. GROVE TO W.L. GREEN
 26" CONC.
 CITY OF WICHITA, KANSAS
 B.E. SMITH CITY ENGINEER
 JAN. 23, 1953 Proj. No. CIP-225

