

BK 52Y

Property

16.8
74.2
53.0
41.9
50.7
114.2
105.9
50.7
600
45.5
73.7

Property	893.7	Property	17.3
	339.5		1.7
	1233.2	Total	19.0 cu yds fill
Total	1356.5 cu yds cut		

BM. 10.74 Step bench 60" Nail sz. 18" Elm Ws Geo Washington Dr - & Grail East.

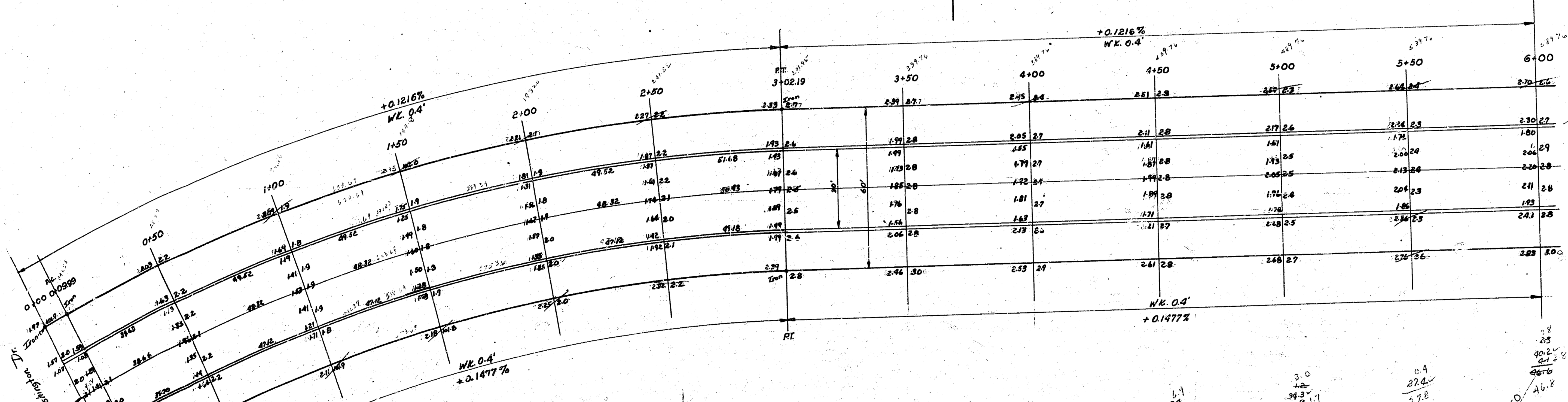
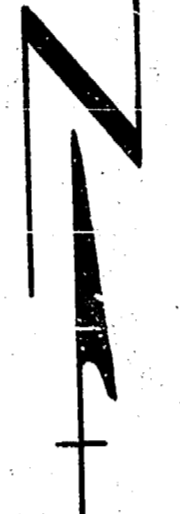

Curve Data
 $R = 62488'$
 $\Delta = 28' 48''$
 $L = 292.20'$
 Δ per ft = 8.7515"
 $30'$ Arc correction = 49.99'

Sta. 0+99.9 = PC
 0+50 = 1' 50" 05"
 1+00 = 4' 07" 40"
 1+50 = 6' 33" 15"

Sta. 2+00 = 8' 40" 50"
 2+50 = 10' 58" 25"
 3+02.19 = 13' 24" = PT

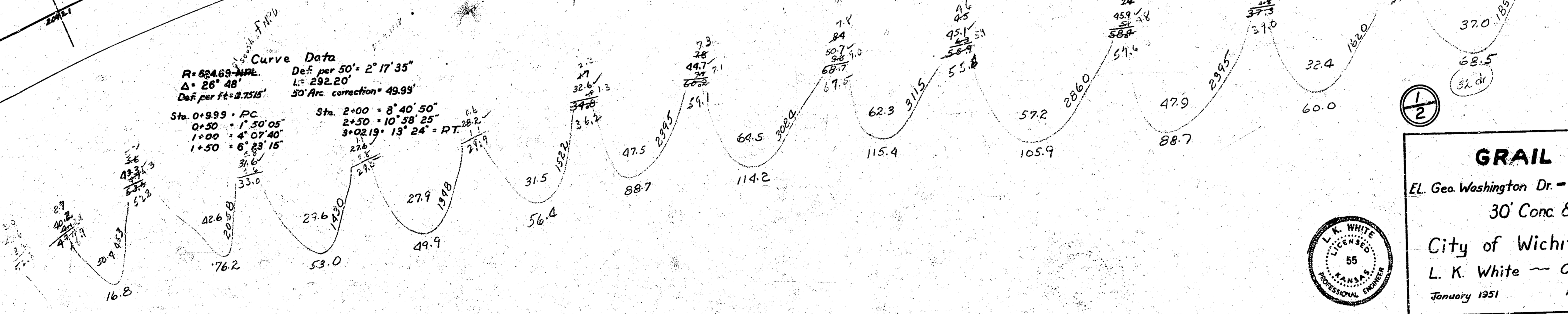

GRAIL ST.
 EL. Geo Washington Dr - WL Hillside Ave.
 30' Conc & Cb
 City of Wichita, Kansas
 L. K. White - City Engineer
 January 1951 Proj. No. C10-115

BK 52Y

Property
54.6
75.4
69.3
59.3
37.6
526.0
12.8
339.5

