

B.M. '39.81 "a" Top N.E. Cor. E Hwdl. Triple R.C.B. Culvt. 400'S of Turnpike on Rock Rd.

NOTE TO FIELD ENGINEER CONTRACTOR

Contractor to Compact Fill in bottom of ditch North of Grail along East Side Rock Rd. to new ditch grade. Field Engr. to take Original Final Cross Sections. Ditch at -0.500% from existing pipe at Zimmerman's South. Field Engr. shall Recross-section Comp. Fill Area after all animal and vegetable matter is removed.

Survey done by J.H. Smith
 11/28/22
 C.E. Smith
 Checked

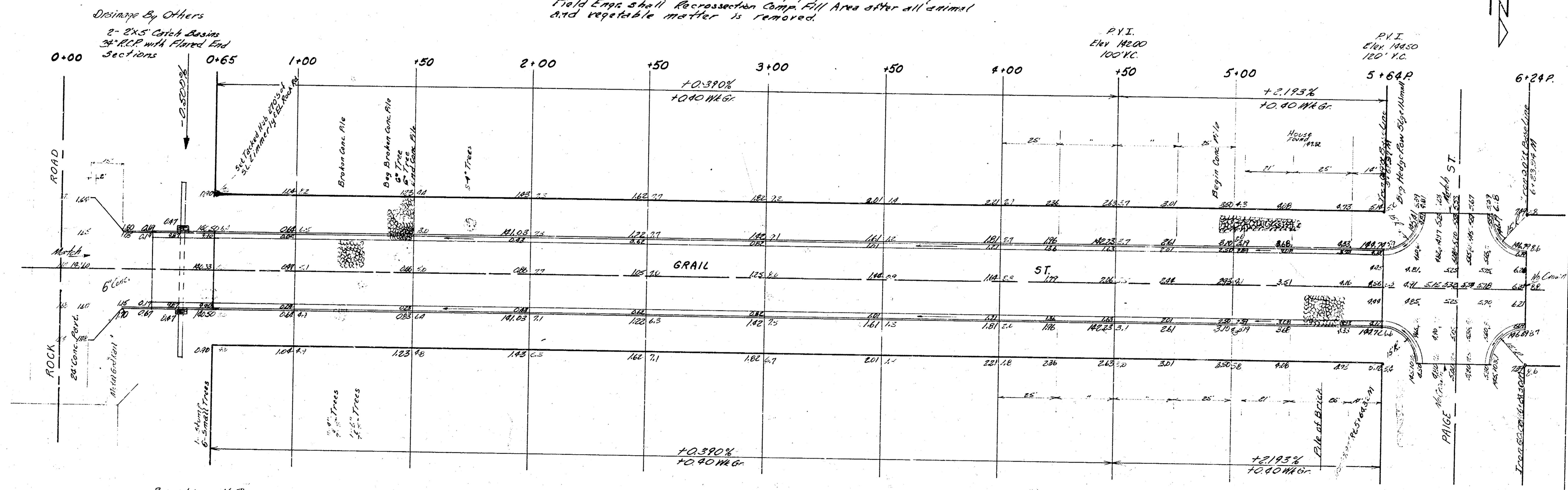

Base Line N.E.

NOTE:
 All Broken Conc. & Brick in RW to be used as Riprap along 10c of Slope from Sta. 0+150 to 1+00 South Side. Cost to be subsidiary to Item Comp. Fill

Excavation Property	City	Comp. Fill Property	City
5980 CY	283.4 CY	1487.8 CY	370.4 CY
59.9 +10%	283.3 +10%	1488.8 +10%	370.0 +10%
658.9 CY Total	311.7 CY Total	1581.6 CY Total	407.4 CY Total

GRAIL ST.
 EL. Rock Rd. to EL. Paigge St
26' - 2" - 30' A.C.
 City of Wichita, Kansas
 B.E. SMITH City Engineer
 Date NOV. 22, 1922 Proj. No. C-18-174

